

WINDROSE

DATA SOURCE: SITKA-JAPCNSKI STATION
PERIOD: APRIL 1957 TO MAY 1961
16 KNOT CROSSWIND COVERAGE 98.3%

AIRPORT DATA		
ITEM	EXISTING	ULTIMATE
AIRPORT ELEVATION M.S.L.	20.78'	SAME
AIRPORT REFERENCE POINT (ARP) NAD83	LAT 57° 02' 50.8" LONG 135° 21' 38.2"	SAME
MEAN MAX. TEMP.	62° F	SAME
AIRPORT APPROACH CATEGORY	C	SAME
AIRPLANE DESIGN GROUP	III	SAME
SERVICE LEVEL	TRANSPORT	SAME
BUILDING RESTRICTION LINE	825'NE/750'SW	SAME
AIRPORT & TERMINAL NAV AIDS	VORTAC, NDB, LOCALIZER	SAME + GPS
RAMP LIGHTING	EDGE & FLOODLIGHTING	SAME
TAXIWAY LIGHTING & MARKING	MEDIUM INTENSITY	SAME
TAXIWAY WIDTH	75'	75'
TAXIWAY LENGTH	3,000'	6,500'
TAXIWAY SAFETY AREA WIDTH	118'	SAME
TAXIWAY OBJECT FREE AREA WIDTH	186'	SAME
RUNWAY-TAXIWAY SEPARATION	400'	SAME
APRON DIMENSIONS	IRREGULAR	
AIRCRAFT PARKING LIMIT	500' FROM R/W ☐	500' FROM R/W ☐

RUNWAY DATA		
ITEM	EXISTING	ULTIMATE
EFFECTIVE GRADIENT %	0.03	SAME
% WIND COVERAGE	98.3	SAME-R/W 11
INSTRUMENT RUNWAY	NO	YES
PAVEMENT STRENGTH	400,000 DT	SAME
RUNWAY SURFACE	ASPHALT CONCRETE	SAME
APPROACH SURFACE RUNWAY 11/29	34:1 / 20:1	50:1 / 20:1
RUNWAY LIGHTING	HIGH INTENSITY	SAME + MALSR
RUNWAY MARKING	PRECISION	SAME
VISUAL/INST NAVAIDS R/W 11	LOC,DME,REIL,VASI	SAME + MALSR, GPS
VISUAL/INST NAVAIDS R/W 29	REIL,VASI	SAME + GPS
APPROACH VISIBILITY MINIMUMS R/W 29	NOT LESS THAN 2 MILES 700' ABOVE MSL	SAME
APPROACH VISIBILITY MINIMUMS R/W 11	NOT LESS THAN 1 MILE 400' ABOVE MSL	1/2 MILE 200' ABOVE MSL
RUNWAY DIMENSIONS	6,500' X 150'	SAME
RUNWAY SAFETY AREA	6,900' X 195'	8,500' X 500'
RUNWAY OBJECT FREE AREA	8,500' X 800'	8,500' X 800'
RUNWAY OBSTACLE FREE ZONE	6,900' X 400'	6,900' X 400'
RUNWAY TRUE BEARING	N 44°28'16.50" W	SAME
RUNWAY END COORDINATES	RUNWAY 11 N 57°03'12.51024" W 135°22'22.90774" RUNWAY 29 N 57°02'26.80643" W 135°21'00.58631"	SAME
NAD 83		SAME

NON-STANDARD CONDITIONS			
ITEM	STANDARD	EXISTING	ULTIMATE
RUNWAY SAFETY AREA LENGTH	8,500'	6,900'	8,500'
RUNWAY SAFETY AREA WIDTH	500'	195'	500'

INDEX OF SHEETS	
SHEET NO.	DESCRIPTION
	NARRATIVE REPORT: SITKA ROCKY GUTIERREZ AIRPORT MASTER PLAN REPORT, APRIL 1999
1	TITLE SHEET
2	EXISTING AIRPORT LAYOUT DRAWING
3	ULTIMATE AIRPORT LAYOUT DRAWING
4	TERMINAL PHOTO
5-6	TERMINAL DRAWINGS
7-8	AIRSPACE DRAWINGS
9	APPROACH SURFACE PROFILES DRAWING
10	INNER PORTION OF APPROACH TO RUNWAY 11 DRAWING
11-12	RUNWAY PRIMARY & TRANSITIONAL SURFACES DRAWINGS
13	INNER PORTION OF APPROACH TO RUNWAY 29 DRAWING
14	AIRPORT LAND USE DRAWING
15	AIRPORT PROPERTY MAP

LEGEND		
ITEM	EXISTING	ULTIMATE
AIRPORT PROPERTY LINE	APL	APL
BUILDING RESTRICTION LINE	BRL	BR
RUNWAY OBJECT FREE ZONE	ROFZ	ROFZ
RUNWAY OBJECT FREE AREA	ROFA	ROFA
RUNWAY SAFETY AREA	RSA	URSA
TAXIWAY OBJECT FREE AREA	TOFA	TOFA
TAXIWAY SAFETY AREA	TSA	UTSA
AIRPORT REFERENCE POINT (ARP)		
RUNWAYS		
ROADWAYS		
SHORELINE		
LEASELOTS		
VASI		
OMNI-DIRECTIONAL REIL		
ROTATING BEACON		
LIGHTED WINDCONE		
THRESHOLD		
TREE		
TREELINE		
FENCE		
CONTOURS		
BUILDING		
DITCH		
SURVEY MONUMENTS		
SEGMENTED CIRCLE		
HOLD LINE		
TOWER		

PLANNED: V.S.
DRAWN: V.S.
CHECKED:

STATE OF ALASKA
DEPARTMENT OF TRANSPORTATION
AND PUBLIC FACILITIES
SOUTHEAST REGION PLANNING

PREVIOUS REVISION DATE: JULY 18, 2000
APPROVED: *Verne Skagerberg* DATE: 4/15/06
VERNE SKAGERBERG, TRANSPORTATION PLANNER, FOR
ANDY HUGHES, CHIEF OF PLANNING

FAA AIRSPACE REVIEW NO: 2006-AAL-100-NRA
FAA APPROVAL DATE: 8/24/06
BY: *8/24/06*
FAA AIRPORT DESIGN, ALASKA REGION, AAL-600
SUBJECT TO CONDITIONS IN LETTER DATED: 8/24/06
PREVIOUS ALP FAA APPROVAL DATE: AUGUST 8, 2000

SITKA ROCKY GUTIERREZ AIRPORT
AIRPORT LAYOUT PLAN

SHEET
1 OF
15

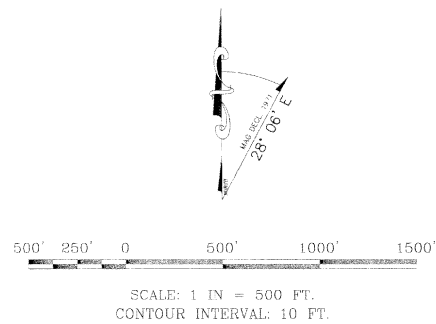

BUILDING & FACILITIES TABLE			
Item No.	Elevation (MSL)	Description	Recommendation
9	EL. 25	LOCALIZER	REMAIN
32	EL. 43	TOWER	REMAIN
33	EL. 41	TOWER	REMAIN
34	EL. 47	TOWER	REMAIN
55	EL. 69	AWOS	REMAIN
56	EL. 71	TOWER	REMAIN
104	EL. 46	COAST GUARD BUILDING	REMAIN
105	EL. 65	COAST GUARD HANGER	REMAIN
107	EL. 58	ARF & SRE	REMAIN
108	EL. 43	AERO SERVICES	REMAIN
110	EL. 50	ALASKA AIRLINES FREIGHT	REMAIN
111	EL. 55	AIRPORT TERMINAL	REMAIN
112	EL. 56	MOUNTAIN AVIATION HANGER	REMAIN
113	EL. 63	FAA BUILDING	REMAIN
114	EL. 61	HANGER	REMAIN
115	EL. 51	HANGER	REMAIN
116	EL. 50	BUILDING	REMAIN
119	EL. 28	ELECTRICAL EQUIPMENT BLDG.	REMAIN
120	EL. 26	BUILDING	REMAIN
130	EL. 31	HANGER	REMAIN

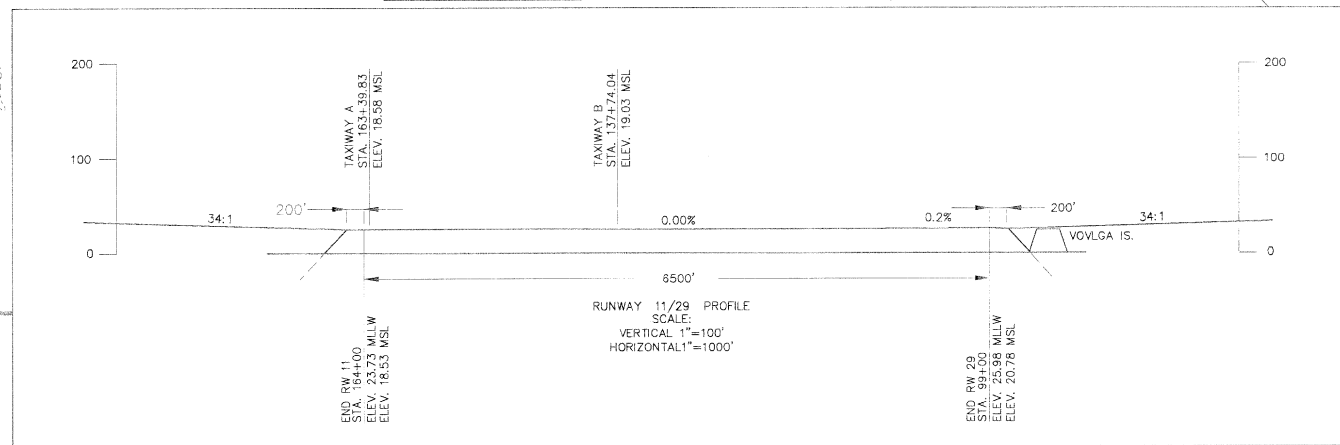
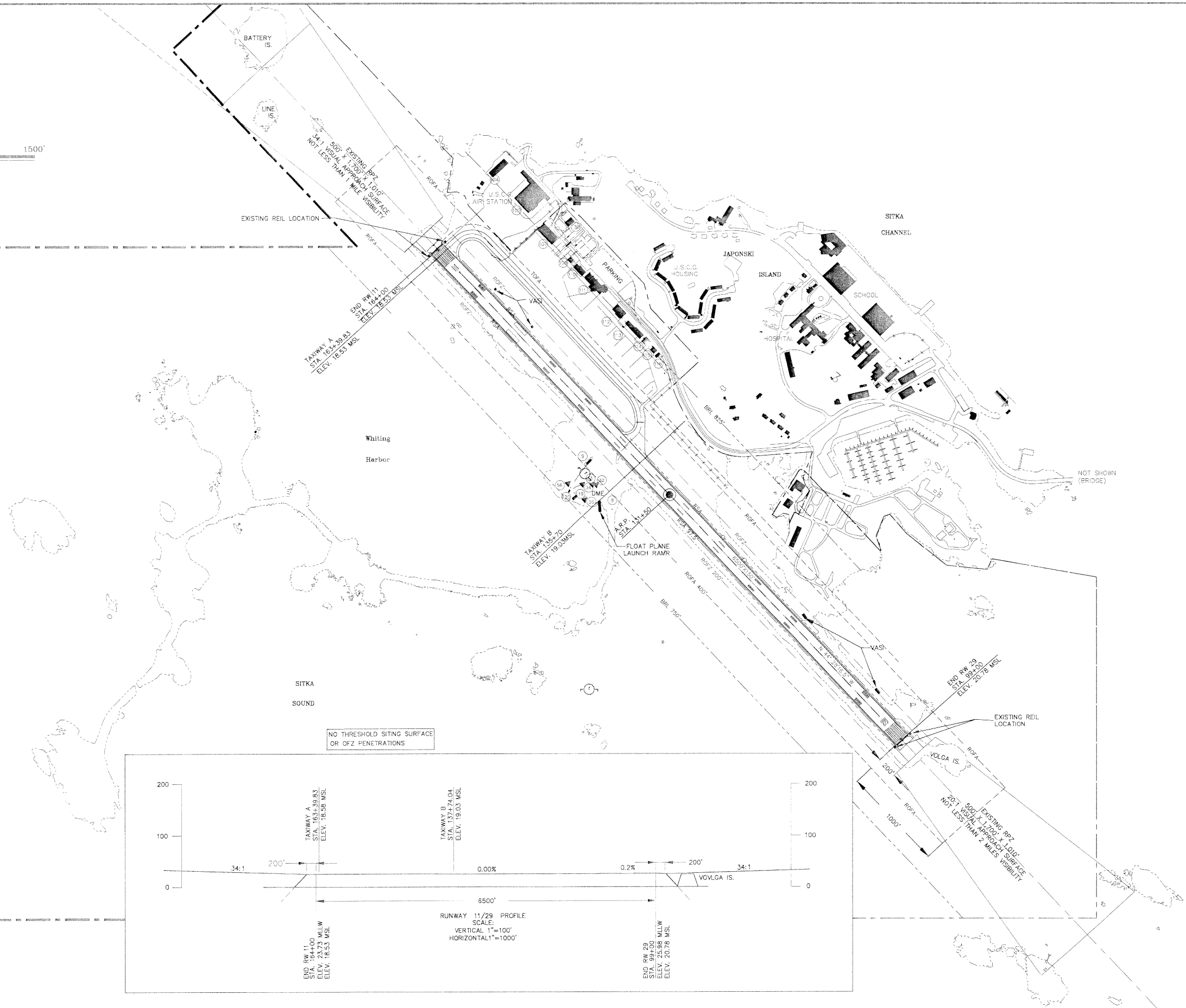

PLANNED: V.S.
 DRAWN: V.S.
 CHECKED:

STATE OF ALASKA
 DEPARTMENT OF TRANSPORTATION
 AND PUBLIC FACILITIES
 SOUTHEAST REGION PLANNING

PREVIOUS REVISION DATE: JULY 18, 2000
 APPROVED:

Verne Skagerberg
 VERNE SKAGERBERG, TRANSPORTATION PLANNER, for
 ANDY HUGHES, CHIEF OF PLANNING
 DATE: 6/15/06

FAA AIRSPACE REVIEW NO: 2006-AAL-100-NRA

FAA APPROVAL DATE: 8/24/06

BY: *John J. Smith*
 FAA AIRPORT DIVISION, ALASKA REGION, AAL-600
 SUBJECT TO CONDITIONS IN LETTER DATED: 8/24/06

PREVIOUS ALP FAA APPROVAL DATE: AUGUST 8, 2000

SITKA ROCKY GUTIERREZ AIRPORT
 EXISTING AIRPORT LAYOUT DRAWING

SHEET
 2
 OF
 15

Q:\Sit\ALP\ALP_2006\3uloplan.dwg

BUILDING & FACILITIES TABLE			
Item No.	Elevation (MSL)	Description	Recommendation
9	EL. 25	LOCALIZER	REMAIN
30	EL. 35	BUILDING	REMOVE
32	EL. 43	TOWER	REMAIN
33	EL. 41	TOWER	REMAIN
34	EL. 47	TOWER	REMAIN
55	EL. 69	AWOS	REMAIN
56	EL. 71	TOWER	REMAIN
104	EL. 46	COAST GUARD BUILDING	REMAIN
105	EL. 65	COAST GUARD HANGER	REMAIN
107	EL. 58	ARF & SRE	REMAIN
106	EL. 43	AERO SERVICES	REMAIN
109	EL. 52	AIR CARGO/FBO	REMAIN
110	EL. 50	ALASKA AIRLINES FREIGHT	REMAIN
111	EL. 55	AIRPORT TERMINAL	REMAIN
112	EL. 56	MOUNTAIN AVIATION HANGER	REMAIN
113	EL. 63	FAA BUILDING	REMAIN
114	EL. 61	HANGER	REMAIN
115	EL. 51	HANGER	REMAIN
116	EL. 50	BUILDING	REMAIN

BUILDING & FACILITIES TABLE			
Item No.	Elevation (MSL)	Description	Recommendation
119	EL. 28	ELECTRICAL EQUIPMENT BLDG.	REMAIN
120	EL. 26	BUILDING	REMAIN
124	EL. 31	SEWAGE TREATMENT PLANT	REMAIN
125	EL. 35	SEWAGE TREATMENT PLANT	REMAIN
126	EL. 36	ABANDONED BUILDING	REMOVE
127	EL. 45	ABANDONED BUILDING	REMOVE
128	EL. 46	ABANDONED BUILDING	REMOVE
129	EL. 46	BUILDING (ABANDONED)	REMOVE
130	EL. 31	HANGER	REMAIN

SITKA CHANNEL

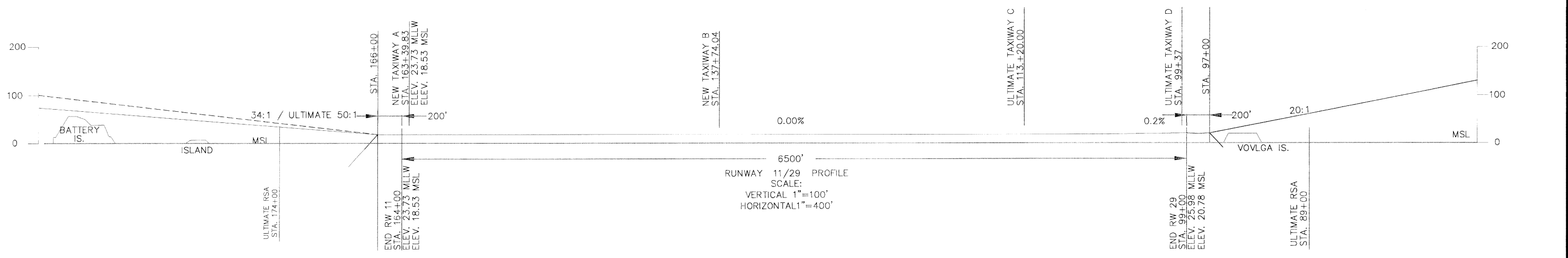
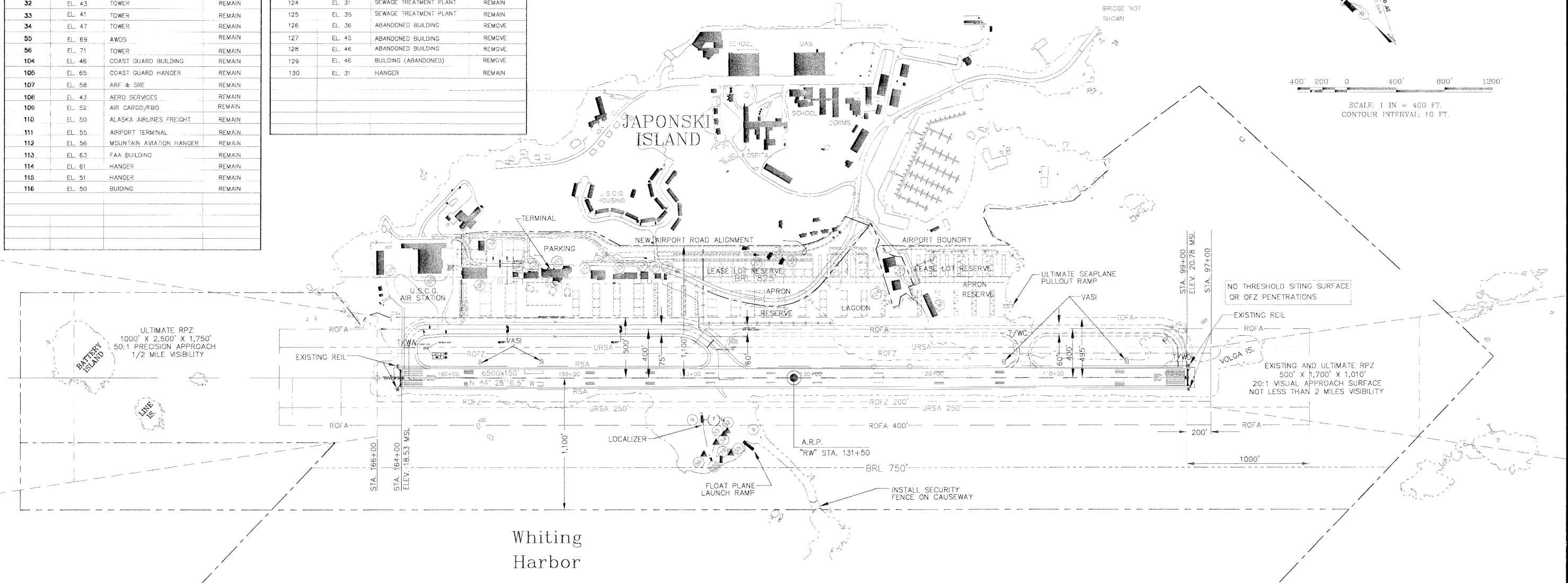

PLANNED: V.S.
DRAWN: V.S.
CHECKED:

STATE OF ALASKA
DEPARTMENT OF TRANSPORTATION
AND PUBLIC FACILITIES
SOUTHEAST REGION PLANNING

PREVIOUS REVISION DATE: JULY 18, 2000
APPROVED: *Verne Skagerberg* DATE: 6/15/06
VERNE SKAGERBERG, TRANSPORTATION PLANNER for
ANDY HUGHES, CHIEF OF PLANNING

FAA AIRSPACE REVIEW NO: 2006-AAL-100-NRA
FAA APPROVAL DATE: 8/24/06
BY: *8/24/06*
FAA AIRPORT DIVISION ALASKA REGION, AAL-600
SUBJECT TO CONDITIONS IN LETTER DATED: 8/24/06
PREVIOUS ALP FAA APPROVAL DATE: AUGUST 8, 2000

SITKA ROCKY GUTIERREZ AIRPORT
ULTIMATE AIRPORT LAYOUT DRAWING

SHEET 3 OF 15

Q:\Sit\ALP\ALP_2006\4_TermPhoto.dwg

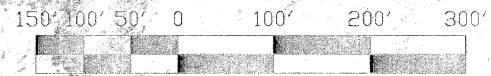
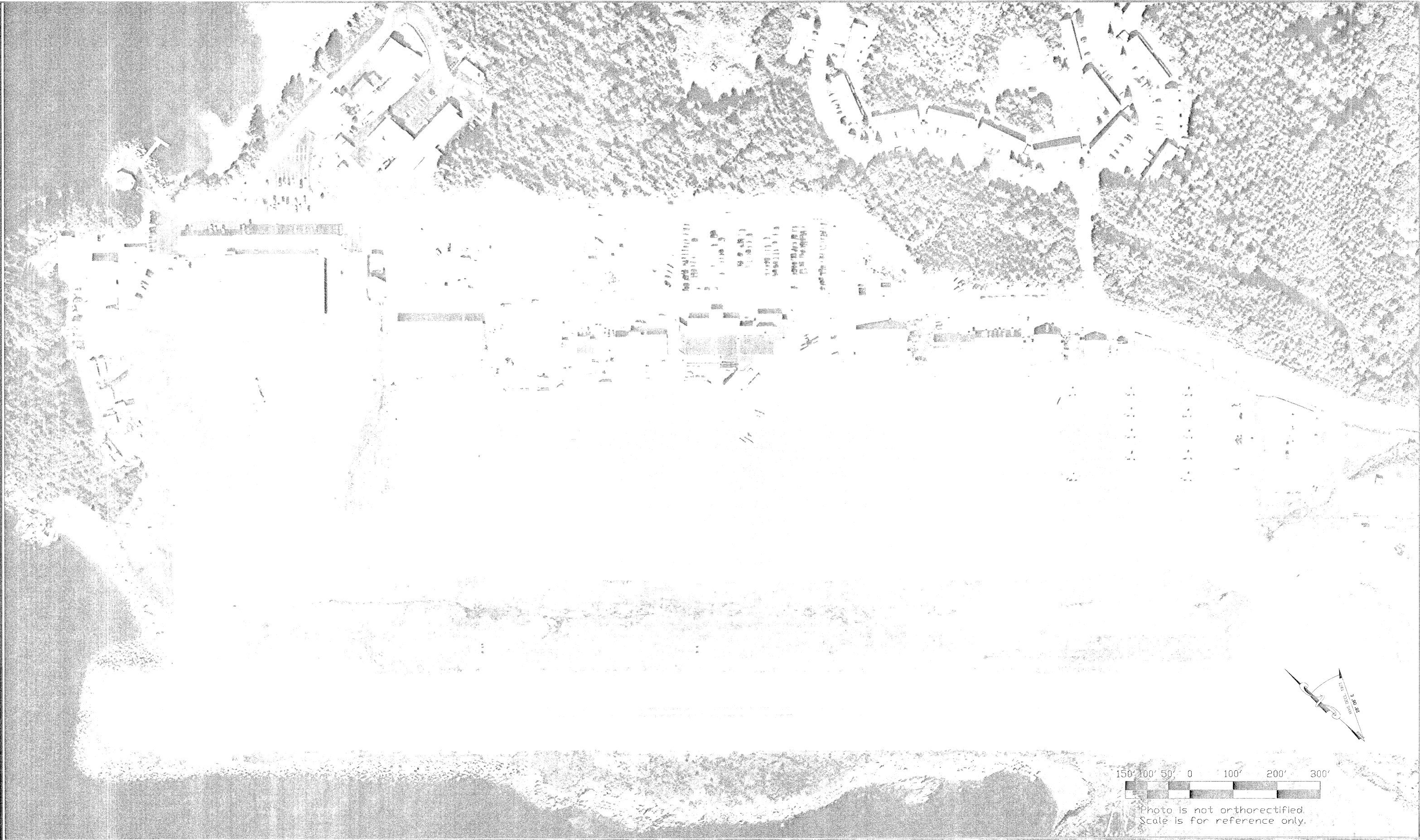
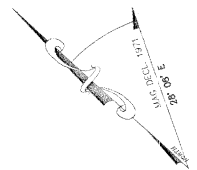

Photo is not orthorectified.
Scale is for reference only.



PLANNED: V.S.
DRAWN: V.S.
CHECKED:

STATE OF ALASKA
DEPARTMENT OF TRANSPORTATION
AND PUBLIC FACILITIES
SOUTHEAST REGION PLANNING

PREVIOUS REVISION DATE: JULY 18, 2000

APPROVED:

Verne Skagfberg DATE: 6/15/06
VERNE SKAGFBERG, TRANSPORTATION PLANNER for
ANDY HUGHES, CHIEF OF PLANNING

FAA AIRSPACE REVIEW NO: 2006-AAL-100-NRA

FAA APPROVAL DATE: 8/24/06

BY: *Andy Hughes*
FAA AIRPORT DIVISION, ALASKA REGION, AAL-600
SUBJECT TO CONDITIONS IN LETTER DATED: 8/24/06

PREVIOUS ALP FAA APPROVAL DATE: AUGUST 8, 2000

SITKA ROCKY GUTIERREZ AIRPORT
TERMINAL AREA PHOTO

SHEET
4
OF
15

0' 50' 0 100' 200' 300'

SCALE: 1 IN = 100 FT.
CONTOUR INTERVAL: 2 FT.
SEE SHEET 1 OF 10 FOR NOTES & LEGEND

BUILDING & FACILITIES TABLE			
Description	Elevation (MSL)	DESCRIPTION	Recommendation
104. BUILDING	EL. 45	COAST GUARD BUILDING	REMAIN
105. BUILDING	EL. 65	COAST GUARD HANGER	REMAIN
107. BUILDING	EL. 58	ARF & SRE	REMAIN
108. BUILDING	EL. 43	AERO SERVICES	RELOCATE
109. BUILDING	EL. 52	AIR CARGO/FBO	REMAIN
110. BUILDING	EL. 50	ALASKA AIRLINES FREIGHT	REMAIN
111. BUILDING	EL. 55	AIRPORT TERMINAL	REMAIN
112. BUILDING	EL. 56	MOUNTAIN AVIATION HANGER	REMAIN
113. BUILDING	EL. 63	FAA BUILDING	REMAIN
114. BUILDING	EL. 61	HANGER	REMAIN
115. BUILDING	EL. 51	HANGER	REMAIN
116. BUILDING	EL. 50	BUILDING	REMAIN
128. BUILDING		BUILDING (ABANDONED)	REMOVE
129. BUILDING		BUILDING (ABANDONED)	REMOVE
130. BUILDING	EL. 31	HANGER	REMAIN

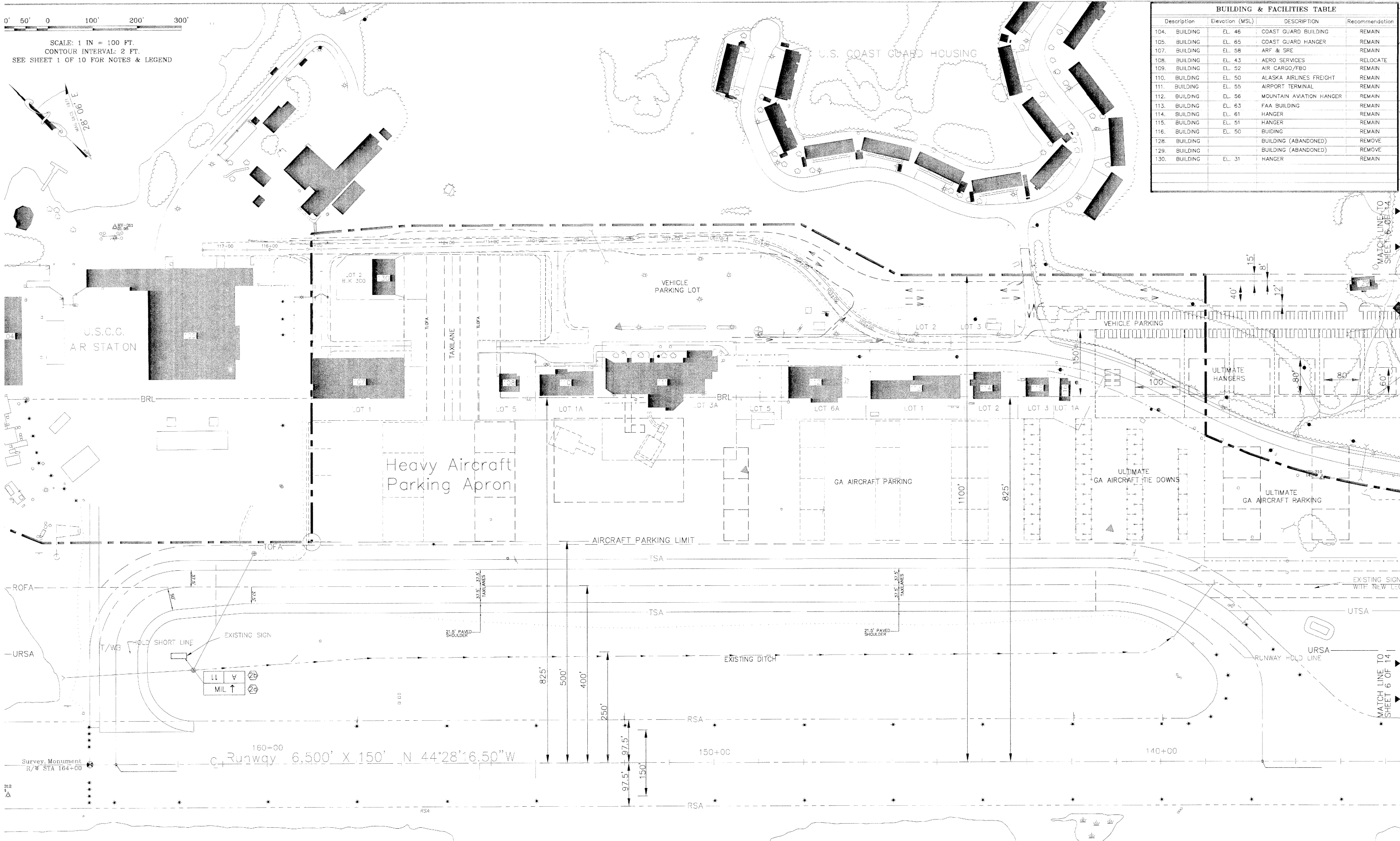

IN: V.S.
FN: V.S.
KED:

STATE OF ALASKA
DEPARTMENT OF TRANSPORTATION
AND PUBLIC FACILITIES
SOUTHEAST REGION PLANNING

PREVIOUS REVISION DATE: JULY 18, 2000
APPROVED: *[Signature]* DATE: 6/15/06
VERNE SKAGERBERG, TRANSPORTATION PLANNER for
ANDY HUGHES, CHIEF OF PLANNING

FAA AIRSPACE REVIEW NO: 2006-AAL-100-NRA
FAA APPROVAL DATE: 8/24/06
BY: *[Signature]*
FAA AIRPORT DIVISION, ALASKA REGION, AAL-600
SUBJECT TO CONDITIONS IN LETTER DATED: 8/24/06
PREVIOUS ALP FAA APPROVAL DATE: AUGUST 8, 2000

SITKA ROCKY GUTIERREZ AIRPORT
TERMINAL DRAWING - NW

SHEET
5
OF
15

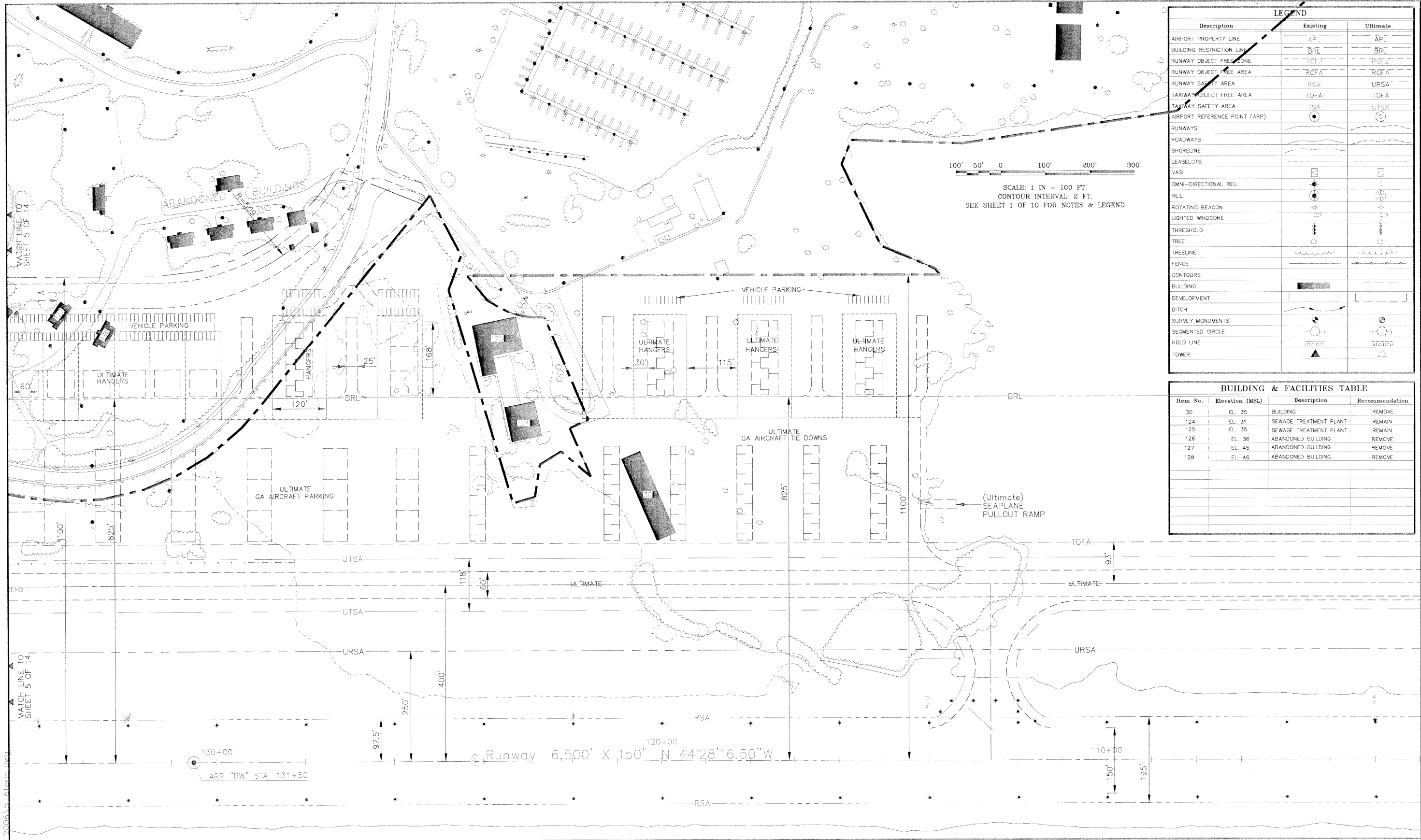

LEGEND		
Description	Existing	Ultimate
AIRPORT PROPERTY LINE	APL	APL
BUILDING RESTRICTION LINE	BRL	BRL
RUNWAY OBJECT FREE ZONE	ROFZ	ROFZ
RUNWAY OBJECT FREE AREA	ROFA	ROFA
RUNWAY SAFETY AREA	RSA	URSA
TAXIWAY OBJECT FREE AREA	TOFA	TOFA
TAXIWAY SAFETY AREA	TSA	UTSA
AIRPORT REFERENCE POINT (ARP)	(Symbol)	(Symbol)
RUNWAYS	(Symbol)	(Symbol)
ROADWAYS	(Symbol)	(Symbol)
SHORELINE	(Symbol)	(Symbol)
LEASELOTS	(Symbol)	(Symbol)
VASI	(Symbol)	(Symbol)
OMNI-DIRECTIONAL REIL	(Symbol)	(Symbol)
REIL	(Symbol)	(Symbol)
ROTATING BEACON	(Symbol)	(Symbol)
LIGHTED WINDCONE	(Symbol)	(Symbol)
THRESHOLD	(Symbol)	(Symbol)
TREE	(Symbol)	(Symbol)
TREELINE	(Symbol)	(Symbol)
FENCE	(Symbol)	(Symbol)
CONTOURS	(Symbol)	(Symbol)
BUILDING	(Symbol)	(Symbol)
DEVELOPMENT	(Symbol)	(Symbol)
DITCH	(Symbol)	(Symbol)
SURVEY MONUMENTS	(Symbol)	(Symbol)
SEGMENTED CIRCLE	(Symbol)	(Symbol)
HOLD LINE	(Symbol)	(Symbol)
TOWER	(Symbol)	(Symbol)

BUILDING & FACILITIES TABLE			
Item No.	Elevation (MSL)	Description	Recommendation
30	EL. 35	BUILDING	REMOVE
124	EL. 31	SEWAGE TREATMENT PLANT	REMAIN
125	EL. 35	SEWAGE TREATMENT PLANT	REMAIN
126	EL. 36	ABANDONED BUILDING	REMOVE
127	EL. 45	ABANDONED BUILDING	REMOVE
128	EL. 46	ABANDONED BUILDING	REMOVE

U:\SITKA\ALP_ZUOB\FAK111.dwg

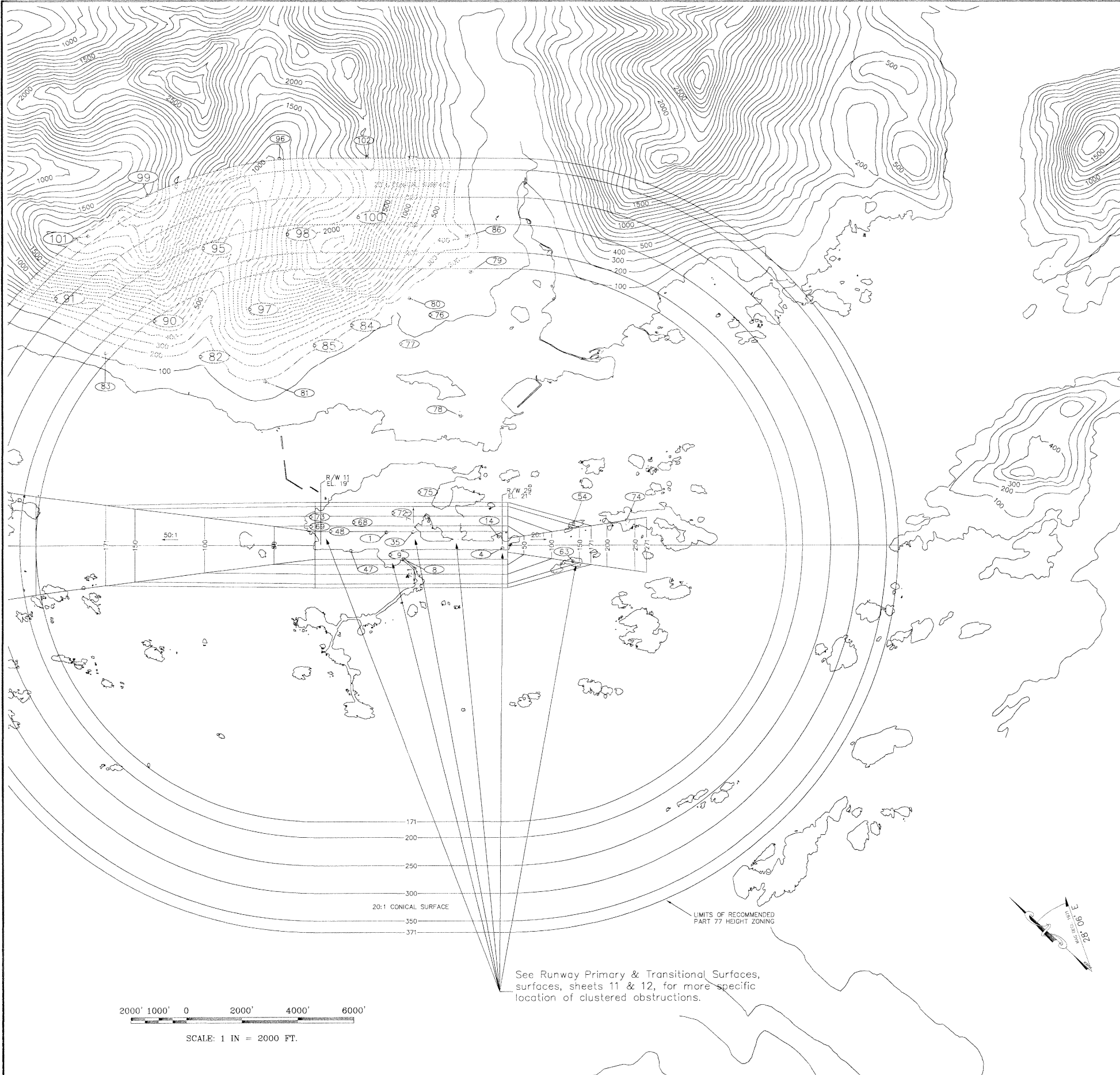

OBSTRUCTION TABLE					OBSTRUCTION TABLE				
Description	Elevation (MSL)	Obstruction	Recommend	FAA Airspace Determination	Description	Elevation (MSL)	Obstruction	Recommend	FAA Airspace Determination
1. TREE	EL. 22	4' obstruction to the Primary Surface	REMOVE		71. TREE	EL. 131	9' obstruction to 7:1 Transitional Surface	REMOVE	
2. TREE	EL. 82	3' obstruction to 7:1 Transitional Surface	REMAIN		72. TREE	EL. 129	13' obstruction to 7:1 Transitional Surface	REMOVE	
4. RUNWAY LIGHT	EL. 24	3' obstruction to the Primary Surface	REMAIN		73. TREE	EL. 116	22' obstruction to 7:1 Transitional Surface	REMOVE	
5. RUNWAY LIGHT	EL. 25	4' obstruction to the Primary Surface	REMAIN		74. TREE	EL. 197	46' obstruction to 20:1 CONICAL SURFACE	REMAIN	
8. PILE	EL. 23	4' obstruction to the Primary Surface	REMOVE		75. TANK	EL. 178	6' obstruction to the Horizontal Surface	REMAIN	
9. LOCALIZER	EL. 25	8' obstruction to the Primary Surface	REMAIN		76. TREE	EL. 205	34' obstruction to the Horizontal Surface	REMAIN	
10. POST	EL. 25	8' obstruction to the Primary Surface	REMOVE		77. TREE	EL. 203	32' obstruction to the Horizontal Surface	REMAIN	
11. TREE	EL. 53	5' obstruction to 7:1 Transitional Surface	REMOVE		78. TREE	EL. 197	26' obstruction to the Horizontal Surface	REMAIN	
13. WINDSOCK	EL. 36	16' obstruction to the Primary Surface	REMAIN		79. TREE	EL. 215	45' obstruction to the Horizontal Surface	REMAIN	
30. BUILDING	EL. 35	14' obstruction to 7:1 Transitional Surface	REMOVE		80. TREE	EL. 238	67' obstruction to the Horizontal Surface	REMAIN	
32. TOWER	EL. 43	25' obstruction to the Primary Surface	REMAIN		81. BUILDING	EL. 264	93' obstruction to the Horizontal Surface	REMAIN	
33. TOWER	EL. 41	22' obstruction to the Primary Surface	REMAIN		82. TREE	EL. 241	70' obstruction to the Horizontal Surface	REMAIN	
34. TOWER	EL. 47	23' obstruction to 7:1 Transitional Surface	REMAIN		83. TREE	EL. 243	64' obstruction to 20:1 Conical Surface	REMAIN	
35. TREE	EL. 31	12' obstruction to the Primary Surface	REMOVE		84. TREE	EL. 345	174' obstruction to the Horizontal Surface	REMAIN	
36. POLE	EL. 41	17' obstruction to 7:1 Transitional Surface	REMOVE		85. TREE	EL. 329	158' obstruction to the Horizontal Surface	REMAIN	
37. TREE	EL. 29	10' obstruction to the Primary Surface	REMOVE		86. TREE	EL. 475	245' obstruction to 20:1 Conical Surface	REMAIN	
38. TREE	EL. 28	10' obstruction to the Primary Surface	REMOVE		90. TREE	EL. 690	520' obstruction to the Horizontal Surface	REMAIN	
39. POLE	EL. 39	4' obstruction to 7:1 Transitional Surface	REMOVE		91. TREE	EL. 669	354' obstruction to 20:1 Conical Surface	REMAIN	
40. POLE	EL. 53	7' obstruction to 7:1 Transitional Surface	REMOVE		95. TREE	EL. 1056	8 12' obstruction to 20:1 Conical Surface	REMAIN	
41. POLE	EL. 54	10' obstruction to 7:1 Transitional Surface	REMOVE		96. TREE	EL. 1168	795' obstruction to 20:1 Conical Surface	REMAIN	
42. POLE	EL. 51	9' obstruction to 7:1 Transitional Surface	REMOVE		97. TREE	EL. 1211	1040' obstruction to the Horizontal Surface	REMAIN	
43. TREE	EL. 36	14' obstruction to 7:1 Transitional Surface	REMOVE		98. TREE	EL. 1690	1456' obstruction to 20:1 Conical Surface	REMAIN	
44. POLE	EL. 52	4' obstruction to 7:1 Transitional Surface	REMOVE		99. TREE	EL. 1725	1354' obstruction to 20:1 Conical Surface	REMAIN	
45. TREE	EL. 116	13' obstruction to 7:1 Transitional Surface	REMOVE		100. TREE	EL. 2018	1755' obstruction to 20:1 Conical Surface	REMAIN	
46. TREE	EL. 79	1' obstruction to 7:1 Transitional Surface	REMOVE		101. TREE	EL. 2132	1771' obstruction to 20:1 Conical Surface	REMAIN	
47. ROCK	EL. 21	2' obstruction to the Primary Surface	REMOVE		102. TREE	EL. 2168	1796' obstruction to 20:1 Conical Surface	REMAIN	
48. SIGN	EL. 25	5' obstruction to 7:1 Transitional Surface	REMAIN						
49. BRUSH	EL. 23	4' obstruction to the Primary Surface	REMOVE						
50. TREE	EL. 66	4' obstruction to 7:1 Transitional Surface	REMOVE						
51. WINDSOCK	EL. 39	22' obstruction to the Primary Surface	RELOCATE						
52. POLE	EL. 47	12' obstruction to 7:1 Transitional Surface	REMOVE						
53. TREE	EL. 88	5' obstruction to 7:1 Transitional Surface	REMOVE						
54. TREE	EL. 103	14' obstruction to 20:1 Nonprecision Approach	REMOVE						
55. TOWER	EL. 69	33' obstruction to 7:1 Transitional Surface	REMAIN						
56. TOWER	EL. 71	33' obstruction to 7:1 Transitional Surface	REMAIN						
57. TREE	EL. 84	19' obstruction to 7:1 Transitional Surface	REMOVE						
58. TREE	EL. 89	32' obstruction to 7:1 Transitional Surface	REMOVE						
59. TREE	EL. 152	13' obstruction to 20:1 Nonprecision Approach	REMOVE						
60. TREE	EL. 122	28' obstruction to 20:1 Nonprecision Approach	REMOVE						
61. TREE	EL. 131	40' obstruction to 20:1 Nonprecision Approach	REMOVE						
62. TREE	EL. 131	42' obstruction to 20:1 Nonprecision Approach	REMOVE						
63. TREE	EL. 123	35' obstruction to 20:1 Nonprecision Approach	REMOVE						
64. TREE	EL. 119	28' obstruction to 20:1 Nonprecision Approach	REMOVE						
65. TREE	EL. 86	26' obstruction to 50:1 Precision Approach	REMOVE						
66. TREE	EL. 90	20' obstruction to 7:1 Transitional Surface	REMOVE						
67. POLE	EL. 77	10' obstruction to 7:1 Transitional Surface	REMOVE						
68. POLE	EL. 77	10' obstruction to 7:1 Transitional Surface	REMOVE						
69. TREE	EL. 92	48' obstruction to 7:1 Transitional Surface	REMOVE						
70. TREE	EL. 86	22' obstruction to 7:1 Transitional Surface	REMOVE						

Q:\SIT\ALP\ALP_2006\8PART77.dwg

OBSTRUCTION TABLE				
Description	Elevation (MSL)	Obstruction	Recommendation	FAA Airspace Determination
87. TREE	EL. 660	26' obstruction to 40:1 Precision Approach	REMOVE	
88. TREE	EL. 673	39' obstruction to 40:1 Precision Approach	REMOVE	
89. TREE	EL. 673	64' obstruction to 40:1 Precision Approach	REMOVE	
91. TREE	EL. 669	354' obstruction to 20:1 Conical Surface	REMOVE	
92. TREE & GROUND	EL. 830	215' obstruction to 40:1 Precision Approach	REMOVE	
93. TREE & GROUND	EL. 840	239' obstruction to 40:1 Precision Approach	REMOVE	
94. TREE & GROUND	EL. 877	272' obstruction to 40:1 Precision Approach	REMOVE	

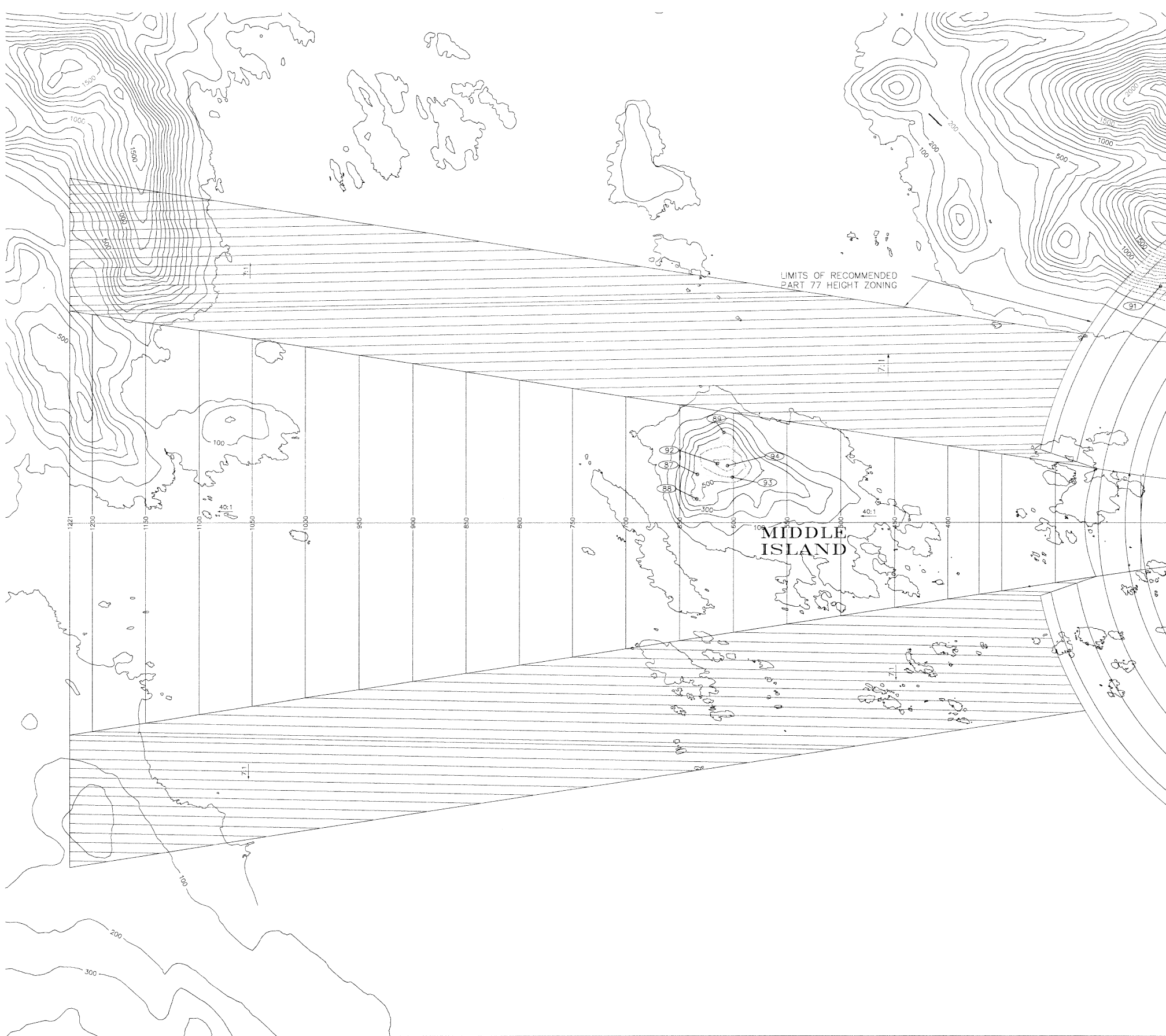

PLANNED: V.S.
DRAWN: V.S.
CHECKED:

STATE OF ALASKA
DEPARTMENT OF TRANSPORTATION
AND PUBLIC FACILITIES
SOUTHEAST REGION PLANNING

PREVIOUS REVISION DATE: JULY 18, 2000
APPROVED: *[Signature]* DATE: 4/15/06
VERNE SKAGERBERG, TRANSPORTATION PLANNER for
ANDY HUGHES, CHIEF OF PLANNING

FAA AIRSPACE REVIEW NO: 2006-AAL-100-NRA
FAA APPROVAL DATE: 8/24/06
BY: *[Signature]*
FAA AIRPORT DIVISION, ALASKA REGION, AAL-600
SUBJECT TO CONDITIONS IN LETTER DATED: 6/24/06
PREVIOUS ALP FAA APPROVAL DATE: AUGUST 8, 2000

SITKA ROCKY GUTIERREZ AIRPORT
PART 77 AIRSPACE DRAWING

SHEET
8
OF
15

Q:\Sit\ALP\ALP_2006\9appspr.dwg

RUNWAY 11

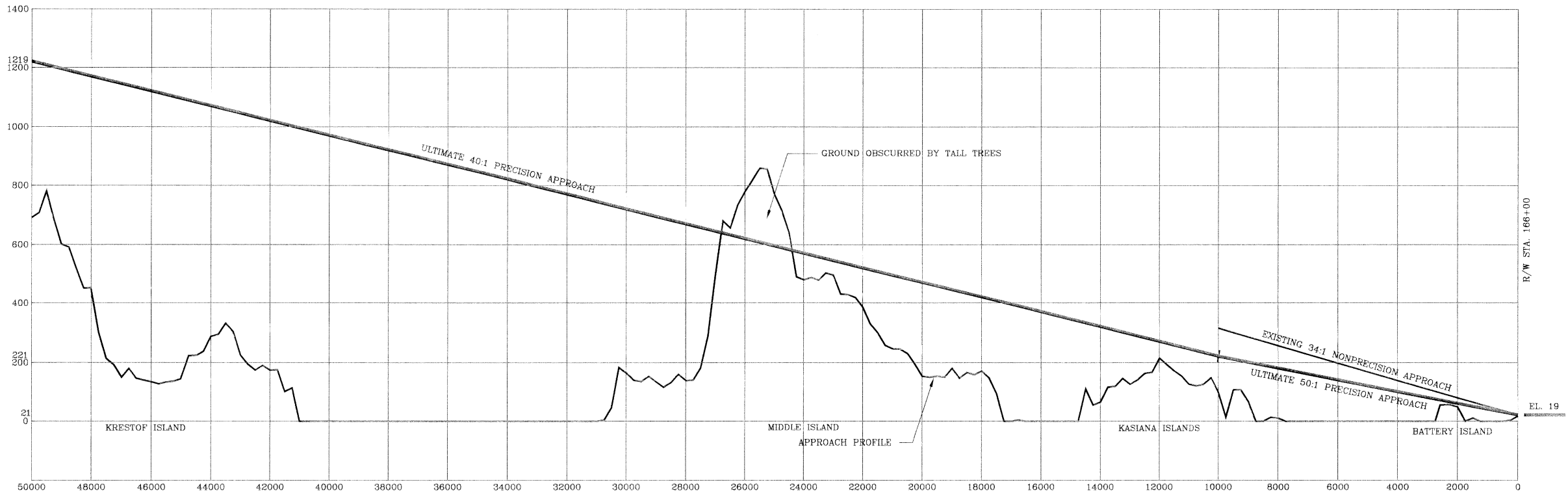

Notes:
APPROACH PROFILE IS A COMPOSITE PROFILE OF HIGHEST TERRAIN & VEGETATION ALONG APPROACH SURFACE.
PROFILE DATA COMPILED USING PHOTOGRAMMETRIC PROCEDURES USING PHOTOGRAPHY DATED SEPTEMBER 14, 1997.

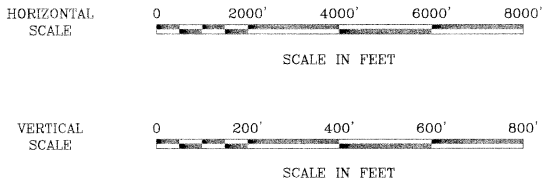

OBSTRUCTION TABLE				
Description	Elevation (MSL)	Obstruction	Recommendation	FAA Airspace Determination
48. SIGN	EL. 25	3' obstruction to 7:1 Transitional Surface	REMAIN	
49. BRUSH	EL. 23	2' obstruction to the Primary Surface	REMOVE	
51. WINDSOCK	EL. 39	21' obstruction to the Primary Surface	RELOCATE	
52. POLE	EL. 47	10' obstruction to 7:1 Transitional Surface	REMOVE	
69. TREE	EL. 92	46' obstruction to 7:1 Transitional Surface	REMOVE	
70. TREE	EL. 86	20' obstruction to 7:1 Transitional Surface	REMOVE	
73. TREE	EL. 116	20' obstruction to 7:1 Transitional Surface	REMOVE	
87. TREE	EL. 660	26' obstruction to 40:1 Precision Approach	REMOVE	
88. TREE	EL. 673	39' obstruction to 40:1 Precision Approach	REMOVE	
89. TREE	EL. 673	64' obstruction to 40:1 Precision Approach	REMOVE	
91. TREE	EL. 669	354' obstruction to 20:1 Conical Surface	REMOVE	
92. TREE & GROUND	EL. 830	215' obstruction to 40:1 Precision Approach	REMOVE	
93. TREE & GROUND	EL. 840	239' obstruction to 40:1 Precision Approach	REMOVE	
94. TREE & GROUND	EL. 877	272' obstruction to 40:1 Precision Approach	REMOVE	

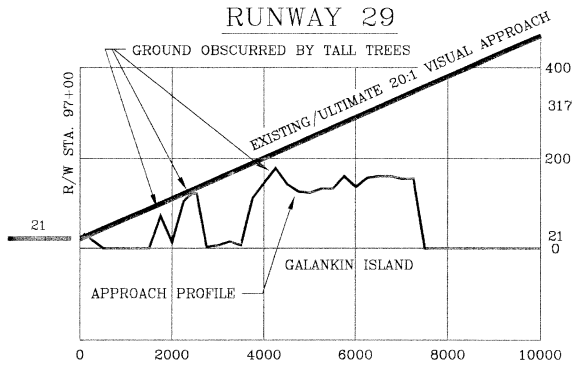

PLANNED: V.S.
DRAWN: V.S.
CHECKED:

STATE OF ALASKA
DEPARTMENT OF TRANSPORTATION
AND PUBLIC FACILITIES
SOUTHEAST REGION PLANNING

PREVIOUS REVISION DATE: JULY 18, 2000
APPROVED: *Verne Skagerberg* DATE: 6/15/06
VERNE SKAGERBERG, TRANSPORTATION PLANNER for
ANDY HUGHES, CHIEF OF PLANNING

FAA AIRSPACE REVIEW NO: 2006-AAL-100-NRA
FAA APPROVAL DATE: 8/24/06
BY: *John J. Hughes*
FAA AIRPORT DIVISION, ALASKA REGION, AAL-600
SUBJECT TO CONDITIONS IN LETTER DATED: 8/24/06
PREVIOUS ALP FAA APPROVAL DATE: AUGUST 6, 2000

SITKA ROCKY GUTIERREZ AIRPORT
APPROACH SURFACE
PROFILES DRAWING

SHEET
9
OF
15

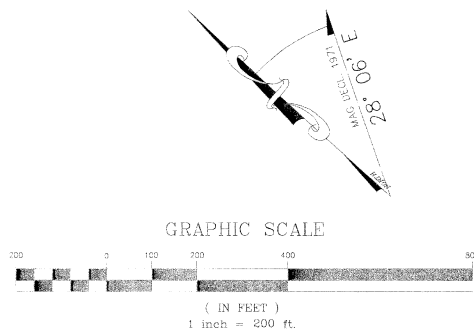

OBSTRUCTION TABLE				
Description	Elevation (MSL)	Obstruction	Recommendation	FAA Airspace Determination
48. SIGN	EL. 25	3' obstruction to 7:1 Transitional Surface	REMAIN	
49. BRUSH	EL. 23	2' obstruction to the Primary Surface	REMOVE	
51. WINDSOCK	EL. 39	21' obstruction to the Primary Surface	RELOCATE	
52. POLE	EL. 47	10' obstruction to 7:1 Transitional Surface	REMOVE	
69. TREE	EL. 92	46' obstruction to 7:1 Transitional Surface	REMOVE	
70. TREE	EL. 86	20' obstruction to 7:1 Transitional Surface	REMOVE	
73. TREE	EL. 116	20' obstruction to 7:1 Transitional Surface	REMOVE	

RWY 11 TOUCHDOWN ZONE ELEVATION = 18.6' MSL

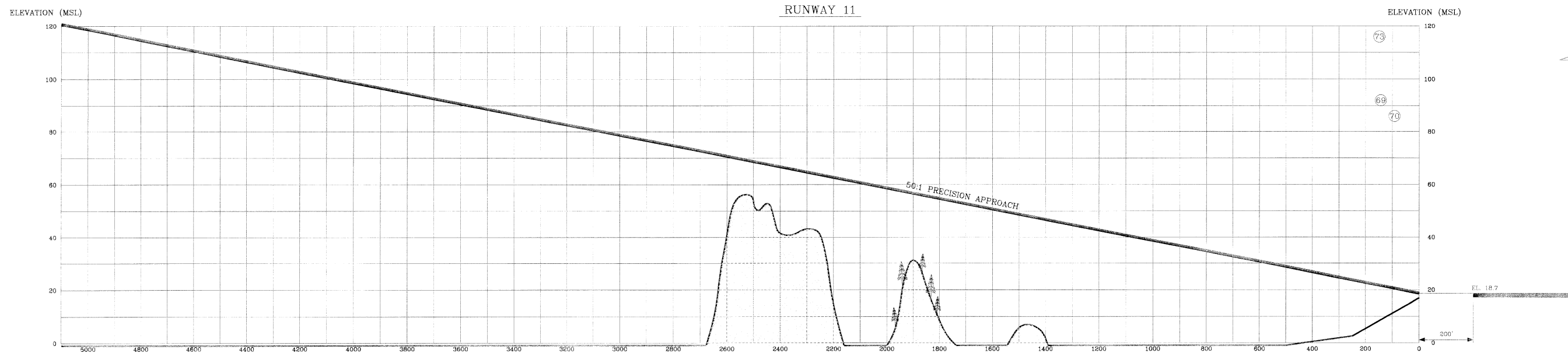

PLANNED: V.S.
DRAWN: V.S.
CHECKED:

STATE OF ALASKA
DEPARTMENT OF TRANSPORTATION
AND PUBLIC FACILITIES
SOUTHEAST REGION PLANNING

PREVIOUS REVISION DATE: JULY 18, 2000
APPROVED: *[Signature]* DATE: 4/15/06
VERNE SKAGERBERG, TRANSPORTATION PLANNER for
ANDY HUGHES, CHIEF OF PLANNING

FAA AIRSPACE REVIEW NO: 2006-AAL-100-NRA
FAA APPROVAL DATE: 5/24/06
BY: *[Signature]*
FAA AIRPORT DIVISION, ALASKA REGION, AAL-600
SUBJECT TO CONDITIONS IN LETTER DATED: 5/24/06
PREVIOUS ALP FAA APPROVAL DATE: AUGUST 8, 2000

SITKA ROCKY GUTIERREZ AIRPORT
RUNWAY 11 INNER APPROACH
SURFACE DRAWING

SHEET
10
OF
15

Q:\SIT\ALP\ALP_2006\11_12pts.dwg

LEGEND

H

△

Horizontal Control

V

○

Vertical Control

HV

△

Horizontal Vertical Control

●

●

Utility Pole

○

○

Guy Wire Anchor

●

●

Pole

☀

☀

Light Pole

☀

☀

Runway Light

○

○

Post

⑤

⑤

Sign

○

○

Mailbox

⚓

⚓

Windsock

Ⓐ

Ⓐ

Antenna

✱

✱

Rock

○

○

Misc. Object

○

○

Manhole

○

○

Fire Hydrant

○

○

Gate

—

—

Culvert

—

—

Guardrail

—

—

Fence

—

—

Swamp

Notes:

This map was prepared in conformance with National Map Accuracy Standards.

This map was checked by two check profiles in non-vegetated areas, and was found to conform to National Map Accuracy Standards.

Contours in vegetated areas may not meet National Map Accuracy Standards. Contours in dense tree areas will not meet National Map Accuracy Standards.

Ground control data provided by DOT/PF - SE Region, Locations Branch. Coordinates are Alaska State Plane Coordinate System of 1983, Zone 1 as expressed in U.S. Survey Feet.

Elevations are based on a Mean Sea Level Value of 16.21 feet for station "Sitka-ARP, 1967". Vertical data for this map was extended by GPS combined with NGS GEOID93-Alaska 94 geoid height model from DOT/PF control.

Mapping was prepared from aerial photography acquired by AeroMap, U.S. on September 14, 1997 at a nominal photo scale of 1:3,600 (1" = 400').

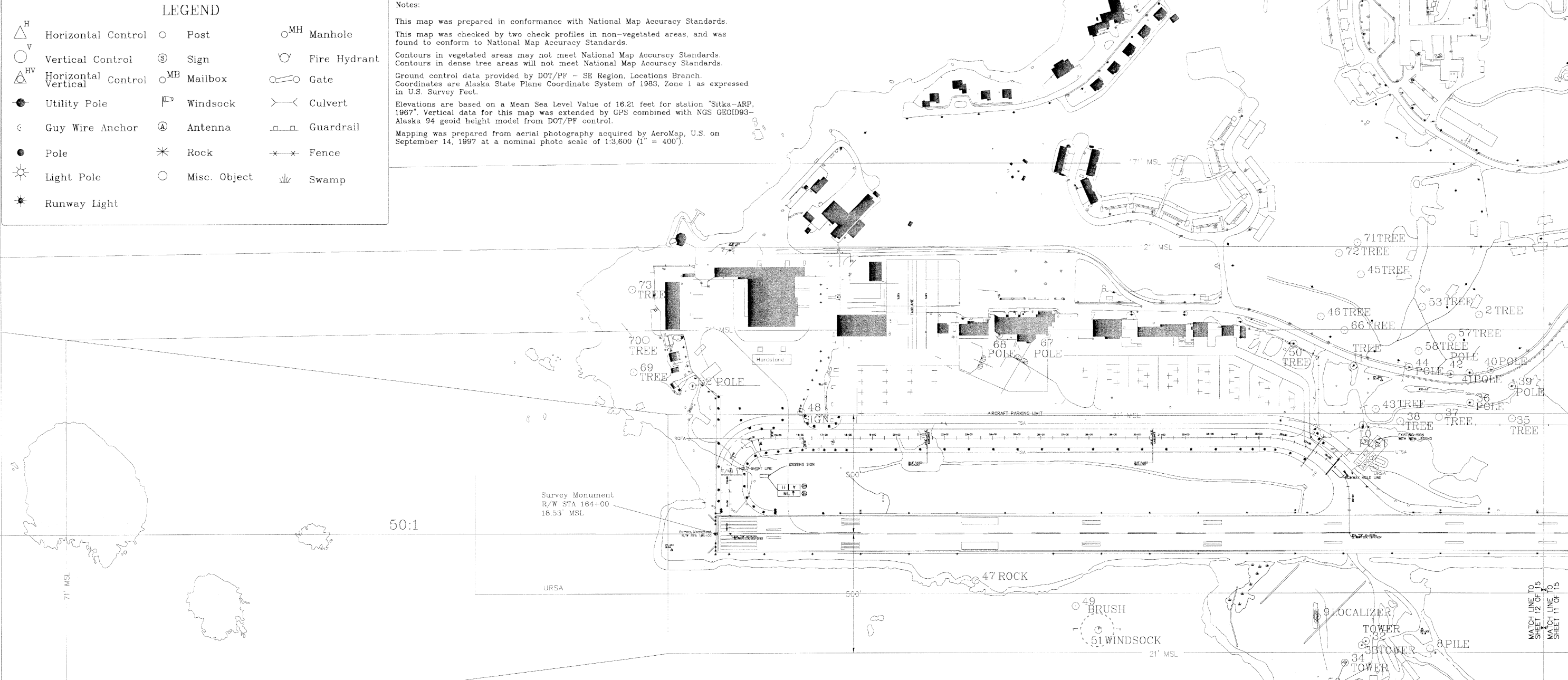

OBSTRUCTION TABLE					OBSTRUCTION TABLE					OBSTRUCTION TABLE				
Description	Elevation (MSL)	Obstruction	Recommendation	FAA Airspace Determination	Description	Elevation (MSL)	Obstruction	Recommendation	FAA Airspace Determination	Description	Elevation (MSL)	Obstruction	Recommendation	FAA Airspace Determination
2. TREE	EL. 82	3' obstruction to 7:1 Transitional Surface	REMAIN		40. POLE	EL. 53	7' obstruction to 7:1 Transitional Surface	REMOVE		57. TREE	EL. 84	19' obstruction to 7:1 Transitional Surface	REMOVE	
8. PILE	EL. 23	4' obstruction to the Primary Surface	REMOVE		41. POLE	EL. 54	10' obstruction to 7:1 Transitional Surface	REMOVE		58. TREE	EL. 89	32' obstruction to 7:1 Transitional Surface	REMOVE	
9. LOCALIZER	EL. 25	8' obstruction to the Primary Surface	REMAIN		42. POLE	EL. 51	9' obstruction to 7:1 Transitional Surface	REMOVE		66. TREE	EL. 90	20' obstruction to 7:1 Transitional Surface	REMOVE	
10. POST	EL. 25	8' obstruction to the Primary Surface	REMOVE		43. TREE	EL. 36	14' obstruction to 7:1 Transitional Surface	REMOVE		67. POLE	EL. 77	10' obstruction to 7:1 Transitional Surface	REMOVE	
11. TREE	EL. 53	5' obstruction to 7:1 Transitional Surface	REMOVE		44. POLE	EL. 52	4' obstruction to 7:1 Transitional Surface	REMOVE		68. POLE	EL. 77	10' obstruction to 7:1 Transitional Surface	REMOVE	
32. TOWER	EL. 43	25' obstruction to the Primary Surface	REMAIN		45. TREE	EL. 116	13' obstruction to 7:1 Transitional Surface	REMOVE		69. TREE	EL. 92	48' obstruction to 7:1 Transitional Surface	REMOVE	
33. TOWER	EL. 41	22' obstruction to the Primary Surface	REMAIN		46. TREE	EL. 79	1' obstruction to 7:1 Transitional Surface	REMOVE		70. TREE	EL. 86	22' obstruction to 7:1 Transitional Surface	REMOVE	
34. TOWER	EL. 47	23' obstruction to 7:1 Transitional Surface	REMAIN		47. ROCK	EL. 21	2' obstruction to the Primary Surface	REMOVE		71. TREE	EL. 131	9' obstruction to 7:1 Transitional Surface	REMOVE	
35. TREE	EL. 31	12' obstruction to the Primary Surface	REMOVE		48. SIGN	EL. 25	5' obstruction to 7:1 Transitional Surface	REMAIN		72. TREE	EL. 129	13' obstruction to 7:1 Transitional Surface	REMOVE	
36. POLE	EL. 41	17' obstruction to 7:1 Transitional Surface	REMOVE		49. BRUSH	EL. 23	4' obstruction to the Primary Surface	REMOVE		73. TREE	EL. 116	22' obstruction to 7:1 Transitional Surface	REMOVE	
37. TREE	EL. 29	10' obstruction to the Primary Surface	REMOVE		50. TREE	EL. 66	4' obstruction to 7:1 Transitional Surface	REMOVE						
38. TREE	EL. 28	10' obstruction to the Primary Surface	REMOVE		51. WINDSOCK	EL. 39	22' obstruction to the Primary Surface	RELOCATE						
39. POLE	EL. 39	4' obstruction to 7:1 Transitional Surface	REMOVE		52. POLE	EL. 47	12' obstruction to 7:1 Transitional Surface	REMOVE						
					53. TREE	EL. 88	4' obstruction to 7:1 Transitional Surface	REMOVE						
					55. TOWER	EL. 71	33' obstruction to 7:1 Transitional Surface	REMAIN						
					56. TOWER	EL. 71	33' obstruction to 7:1 Transitional Surface	REMAIN						

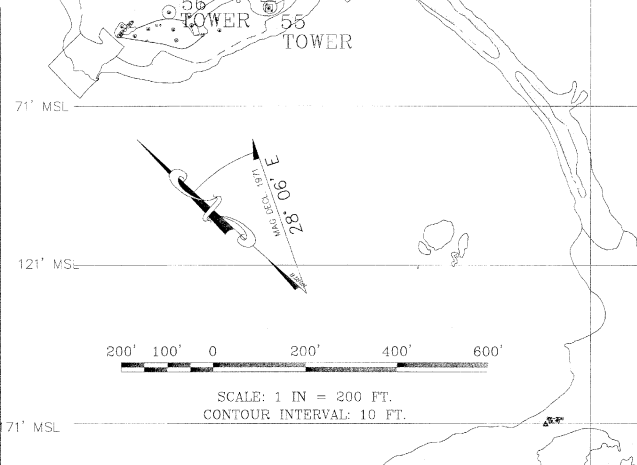

PLANNED: V.S.

DRAWN: V.S.

CHECKED:

STATE OF ALASKA
DEPARTMENT OF TRANSPORTATION
AND PUBLIC FACILITIES
SOUTHEAST REGION PLANNING

PREVIOUS REVISION DATE: JULY 18, 2000

APPROVED: DATE: 6/15/06

VERNE SKAGERBERG, TRANSPORTATION PLANNER for
ANDY HUGHES, CHIEF OF PLANNING

FAA AIRSPACE REVIEW NO: 2006-AAL-100-NRA

FAA APPROVAL DATE: 8/24/06

BY:

SUBJECT TO CONDITIONS & LETTER DATED: 8/24/06

PREVIOUS ALP FAA APPROVAL DATE: AUGUST 8, 2000

SITKA ROCKY GUTIERREZ AIRPORT
RUNWAY PRIMARY & TRANSITIONAL
SURFACES DRAWING

SHEET
11
OF
15

Q:\SIT\ALP\ALP_2006\11_12pts.dwg

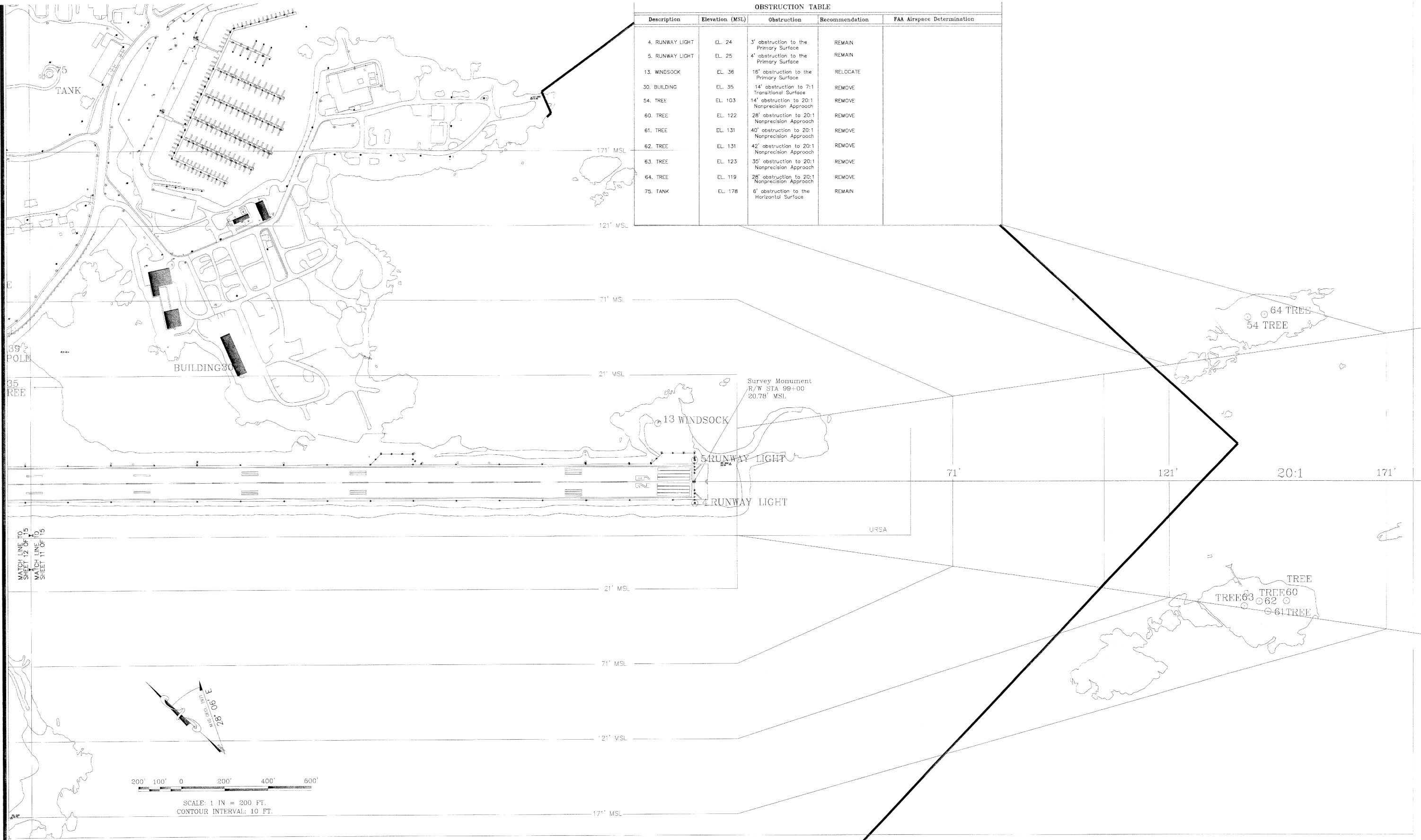

OBSTRUCTION TABLE				
Description	Elevation (MSL)	Obstruction	Recommendation	FAA Airspace Determination
4. RUNWAY LIGHT	EL. 24	3' obstruction to the Primary Surface	REMAIN	
5. RUNWAY LIGHT	EL. 25	4' obstruction to the Primary Surface	REMAIN	
13. WINDSOCK	EL. 36	16' obstruction to the Primary Surface	RELOCATE	
30. BUILDING	EL. 35	14' obstruction to 7:1 Transitional Surface	REMOVE	
54. TREE	EL. 103	14' obstruction to 20:1 Nonprecision Approach	REMOVE	
60. TREE	EL. 122	28' obstruction to 20:1 Nonprecision Approach	REMOVE	
61. TREE	EL. 131	40' obstruction to 20:1 Nonprecision Approach	REMOVE	
62. TREE	EL. 131	42' obstruction to 20:1 Nonprecision Approach	REMOVE	
63. TREE	EL. 123	35' obstruction to 20:1 Nonprecision Approach	REMOVE	
64. TREE	EL. 119	28' obstruction to 20:1 Nonprecision Approach	REMOVE	
75. TANK	EL. 178	6' obstruction to the Horizontal Surface	REMAIN	

G:\Sit\ALP\ALP_2006\13pp29.dwg

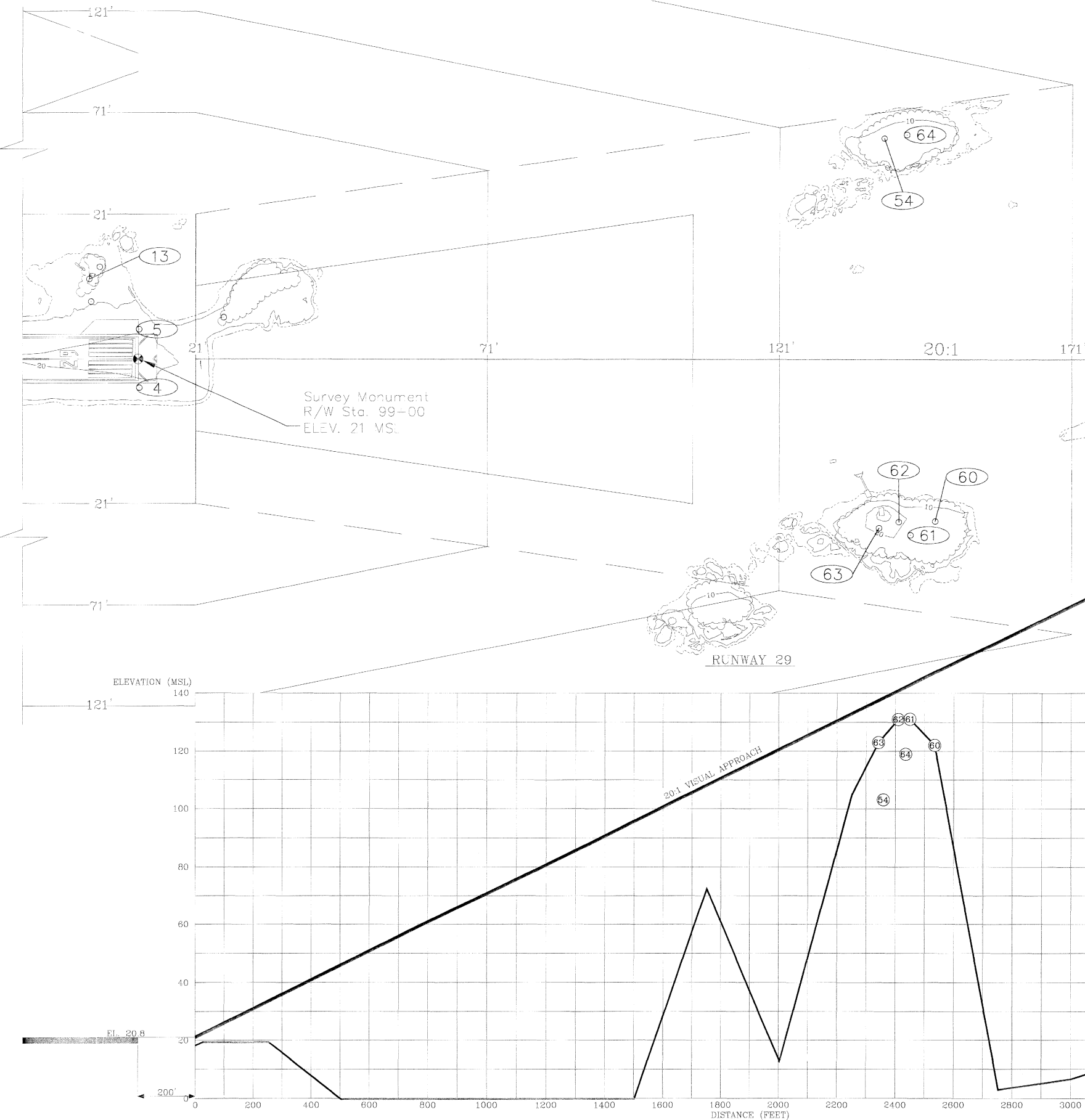

OBSTRUCTION TABLE				
Description	Elevation (MSL)	Obstruction	Recommendation	FAA Airspace Determination
4. RUNWAY LIGHT	EL. 24	5' obstruction to the Primary Surface	REMAIN	
5. RUNWAY LIGHT	EL. 25	6' obstruction to the Primary Surface	REMAIN	
13. WINDSOCK	EL. 36	18' obstruction to the Primary Surface	RELOCATE	
54. TREE	EL. 103	Not an obstruction to 20:1 Visual Approach	REMAIN	
60. TREE	EL. 122	Not an obstruction to 20:1 Visual Approach	REMAIN	
61. TREE	EL. 131	Not an obstruction to 20:1 Visual Approach	REMAIN	
62. TREE	EL. 131	Not an obstruction to 20:1 Visual Approach	REMAIN	
63. TREE	EL. 123	Not an obstruction to 20:1 Visual Approach	REMAIN	
64. TREE	EL. 119	Not an obstruction to 20:1 Visual Approach	REMAIN	

RWY 29 TOUCHDOWN ZONE ELEVATION = 20.8' MSL

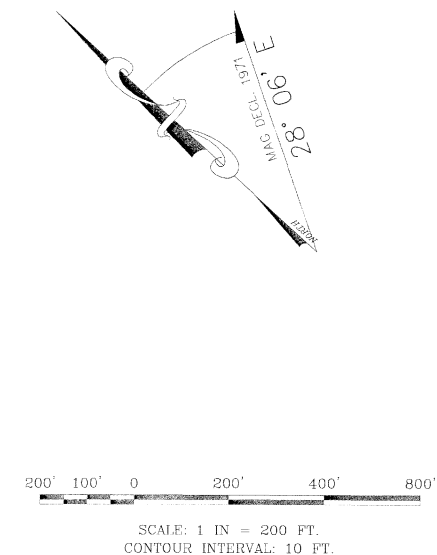

PLANNED: V.S.
DRAWN: V.S.
CHECKED:

STATE OF ALASKA
DEPARTMENT OF TRANSPORTATION
AND PUBLIC FACILITIES
SOUTHEAST REGION PLANNING

PREVIOUS REVISION DATE: JULY 18, 2000
APPROVED:  DATE: 8/15/06
VERNE SKAGERBERG, TRANSPORTATION PLANNER for
ANDY HUGHES, CHIEF OF PLANNING

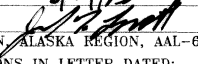
FAA AIRSPACE REVIEW NO: 2006-AAL-100-NRA
FAA APPROVAL DATE: 8/24/06
BY: 
FAA AIRPORT DIVISION, ALASKA REGION, AAL-600
SUBJECT TO CONDITIONS IN LETTER DATED: 8/24/06
PREVIOUS ALP FAA APPROVAL DATE: AUGUST 8, 2000

SITKA ROCKY GUTIERREZ AIRPORT
RUNWAY 29 INNER APPROACH
SURFACE DRAWING

SHEET
13
OF
15

Q:\Sit\ALP\ALP_2006\14Induse.dwg

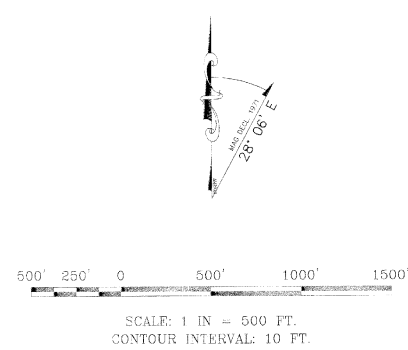

LEGEND		
Runway Light	Windsock	Manhole
Swamp	Antenna	Fire Hydrant
Fence	Rock	Gate
Brush	Misc. Object	Culvert
		Guardrail

LAND USE LEGEND	
A	AVIATION USE
AC	AIR CARRIER TERMINAL AREA
C	CARGO SUPPORT
GA	GENERAL AVIATION
G	GOVERNMENT
U.S.C.G.	UNITED STATES COAST GUARD
HA	HEAVY AIRCRAFT
LA	LIGHT AIRCRAFT
FBO	FIXED BASE OPERATION
P	VEHICLE PARKING
MP	MARINE PARK (TO BE RELEASED TO ADN)

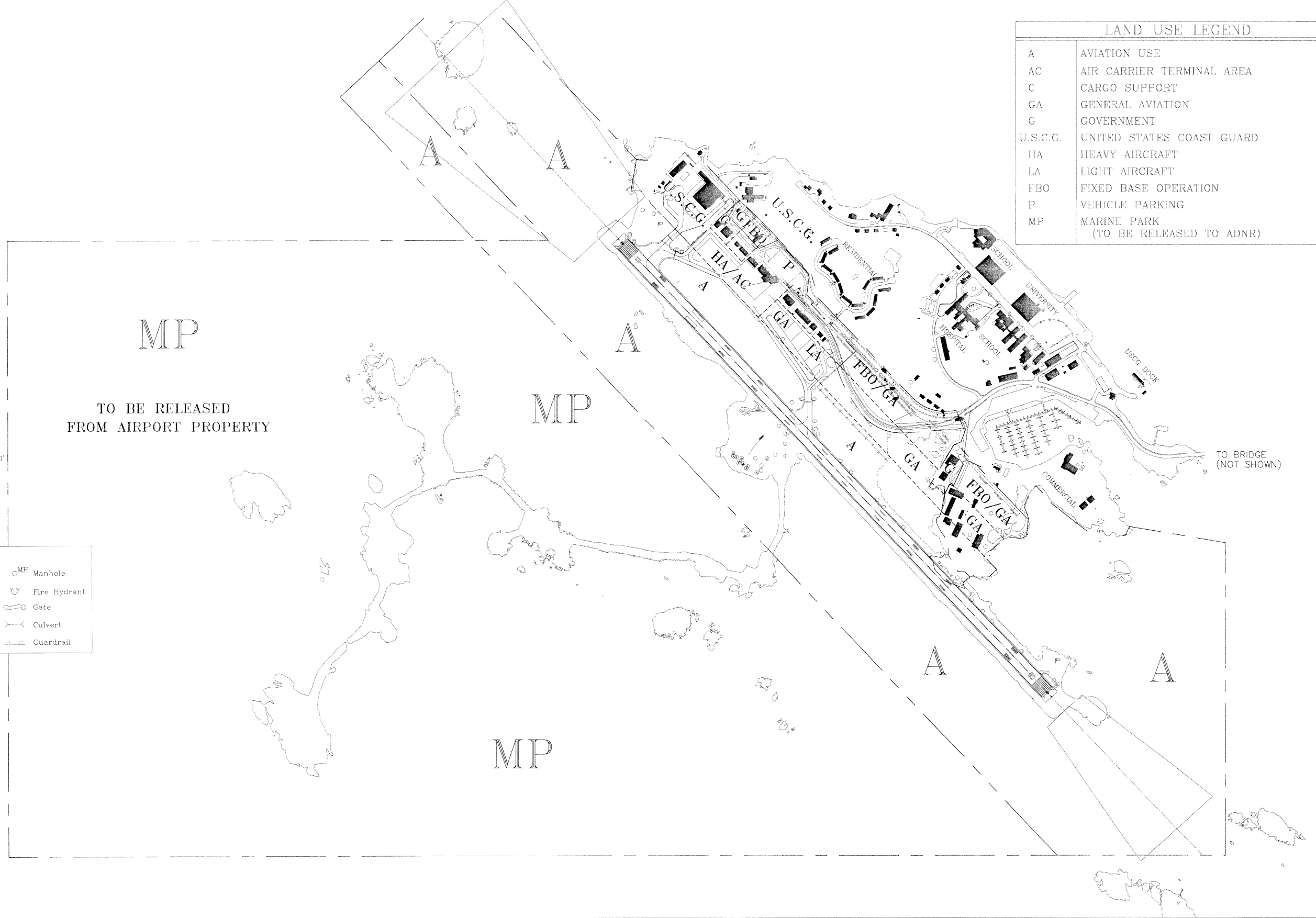

PLANNED: V.S.
DRAWN: V.S.
CHECKED:

STATE OF ALASKA
DEPARTMENT OF TRANSPORTATION
AND PUBLIC FACILITIES
SOUTHEAST REGION PLANNING

PREVIOUS REVISION DATE: JULY 18, 2000
APPROVED:
DATE: 6/15/06
VERNE SKAGERBERG, TRANSPORTATION PLANNER for
ANDY HUGHES, CHIEF OF PLANNING

FAA AIRSPACE REVIEW NO: 2006-AAL-100-NRA
FAA APPROVAL DATE: 8/24/06
BY:
FAA AIRPORT DIVISION, ALASKA REGION, AAL-600
SUBJECT TO CONDITIONS IN LETTER DATED: 8/24/06
PREVIOUS ALP FAA APPROVAL DATE: AUGUST 8, 2000

SITKA ROCKY GUTIERREZ AIRPORT
LANDUSE PLAN DRAWING

SHEET
14 OF 15

PROPERTY STATUS					
TRACT	PARCEL	ADA/AIP No.	AREA	INTEREST ACQUIRED	DATE ACQUIRED
I	A	10355a A.D.L. 20877	1570+-ac.	(Tide & submerged lands) I.L.M.A.	5/14/63 AM. 2/28/72
I	AA		1182.073 ac.	Portion of A.D.L. 20877 To be released to DNR	See Above
I	A-1		29.975 ac.	I.L.M.A. To be acquired	
I	B	10355b A.D.L. 21670	70.68 ac.	(Islands within USS 3926) Quitclaim Deed from ADL	4/13/71
I	C	10355c A.D.L. 21670	14.99 ac.	(Filled lots within USS 3926) I.L.M.A.	8/11/67
II		10357	67.67+-ac.	Fee Simple Title, QCD from G.S.A.	9/10/73
III	A1	3-02-0268-0800	2.93 ac.	Fee Simple Title, QCD from USCG	7/1/2005
	A2	10864	1.18 ac.	Fee Simple Title, QCD from USCG	7/1/2005
	A3	3-02-0268-0800	1.36 ac.	Fee Simple Title, QCD from USCG	7/1/2005
	A4	3-02-0268-0800	3.01 ac.	Fee Simple Title, QCD from USCG	7/1/2005
	B	10864	1+ ac.	Fee Simple Title, QCD from USCG	6/27/80
IV		11376 A.D.L. 101042	0.79 ac.	Permit avigation & hazard easement from ADL (ATS 1042)	5/14/63
V		3-02-0268-0800	0.56ac.	Fee Simple Title, QCD from GSA	2/20/2004
VI	A	3-02-0268-0900	13.319 ac.	Fee Simple, BK 152, PG 916	1/14/2002
VI	B	3-02-0268-0900	1.90 ac.	Fee Simple, BK 152, PG 916	1/14/2002
VII	B		5.475 ac.	Fee Simple to be acquired	

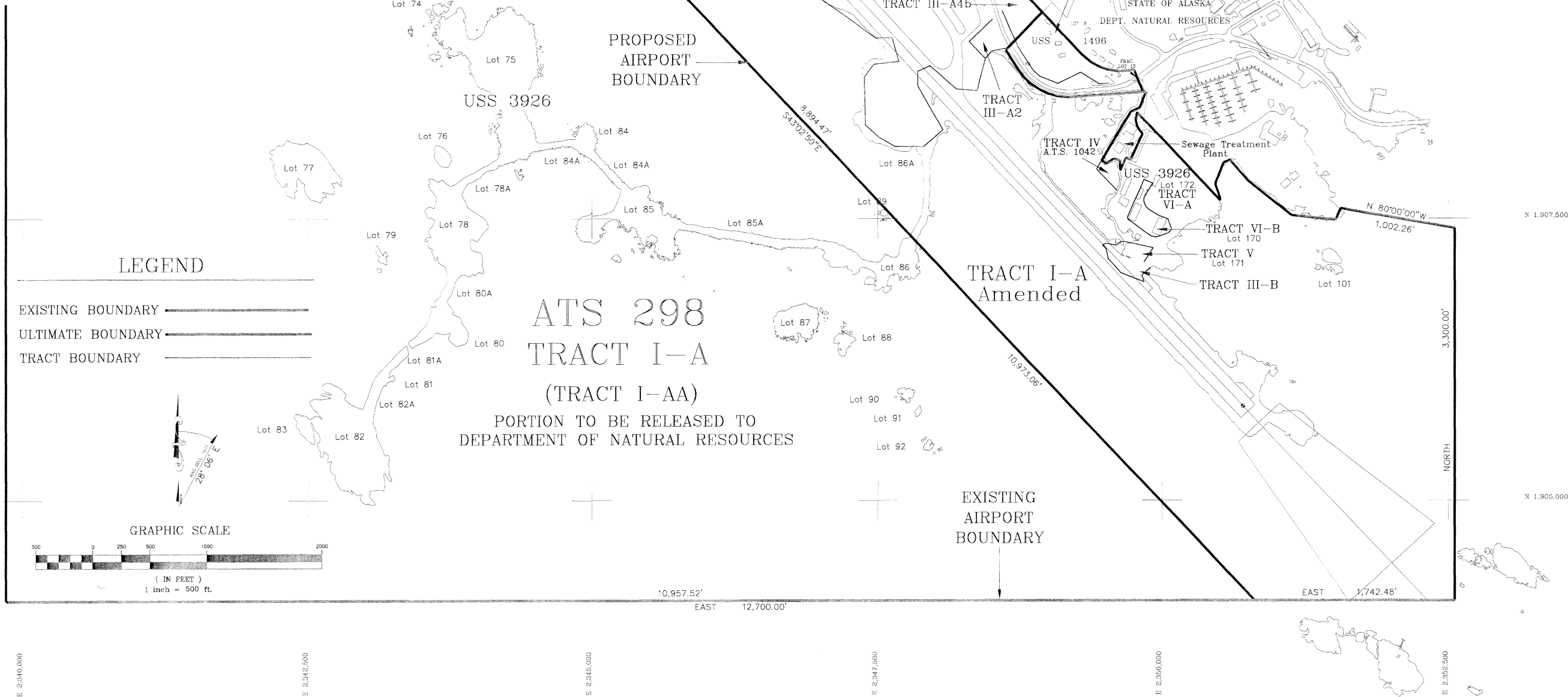

PATH: IMPERIAL 1=500(F) OR 1=1000(H) PLANNED: _____ DRAWN: JLH CHECKED: AH		STATE OF ALASKA DEPARTMENT OF TRANSPORTATION AND PUBLIC FACILITIES SOUTHEAST REGION PLANNING		PREVIOUS REVISION DATE: APRIL 9, 1999 APPROVED: <i>[Signature]</i> DATE: 6/15/06 ANDY HUGHES, CHIEF OF PLANNING		FAA AIRSPACE REVIEW NO: 2006-AAL-100-NRA FAA APPROVAL DATE: 5/24/06 BY: <i>[Signature]</i> SUBJECT TO CONDITIONS IN LETTER DATED: 6/24/06 PREVIOUS AIP FAA APPROVAL DATE: APRIL 11, 1983		SITKA ROCKY GUTIERREZ AIRPORT PROPERTY PLAN		SHEET 15 OF 15	
---	--	---	--	--	--	--	--	--	--	-------------------------	--