

LOCATION MAP
NO SCALE

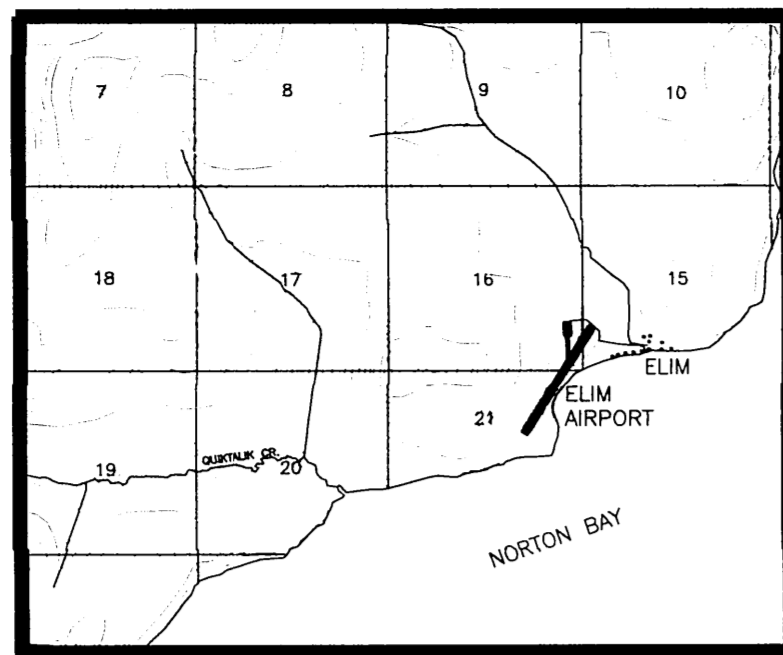

VICINITY MAP
SEC. 25, 35 & 36 T9S, R18W
KATEEL RIVER MERIDIAN
U.S.G.S. SOLOMON (C-1)
NO SCALE

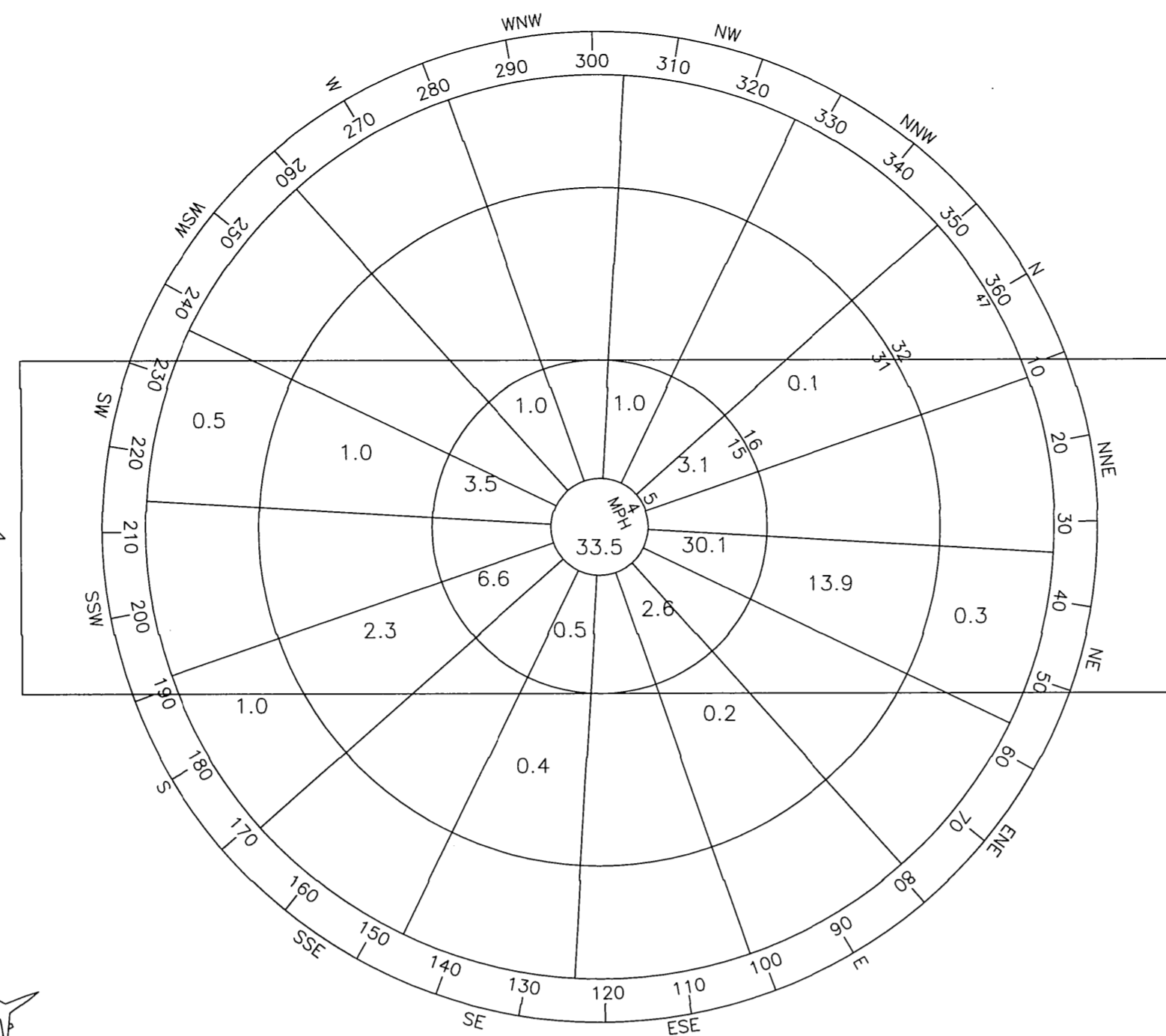

WIND ROSE
15 MPH
WIND DATA
PERCENT WIND COVERAGE
RUNWAY 1-19: 98.28%
U.S. ARMY CORPS OF ENGINEERS
WIND DATA PERIOD: OCT. 1937 THRU JUNE 1939

AIRPORT DATA		
	EXISTING	ULTIMATE
NATIONAL AIRPORT IDENTIFIER = ELI		
AIRPORT ELEVATION (NAVD 88)	159.4'	SAME
AIRPORT REFERENCE CODE	B-II	SAME
MEAN DAILY MAX. TEMP. HOTTEST MONTH (JULY)	60.9°F	SAME
TAXIWAY LIGHTING	MILT	SAME
RAMP LIGHTING	NONE	SAME
NAVIGATION AIDS	ROTATING BEACON	GPS
COMMUNICATION AIDS	NONE	SAME
WEATHER FACILITIES	NONE	SAME

NON STANDARD CONDITIONS	
CONDITION	DISPOSITION
RUNWAY 19 PAPI LOCATED ON RIGHT SIDE	TO REMAIN

AIRPORT SURVEY CONTROL				
POINT	NAD 83 LATITUDE (N)	ALASKA STATE PLANE ZONE 7 (F) LONGITUDE (W)	NORTHING	NAVD 88 ELEVATION
ELI P	64°36'58.224"	162°16'16.847"	3879716.21	155.8 (ft)
ELI B	64°36'50.324"	162°16'15.555"	3878913.46	1597874.63
STA 102+04.00	64°36'36.757"	162°16'36.254"	3877539.00	1596965.97
STA 141+96.24	64°37'11.064"	162°15'51.628"	3881016.03	1598926.82

RUNWAY DATA		
	RUNWAY 1-19	
	EXISTING	ULTIMATE
INSTRUMENT RUNWAY	NON-PRECISION	SAME
% WIND COVERAGE	98.28% @ 15 MPH	SAME
RUNWAY SURFACE TYPE	GRAVEL	SAME
PAVEMENT STRENGTH	N/A	SAME
APPROACH SURFACES	20:1	34:1
APPROACH VISIBILITY MINIMUMS	≥1 MILE	SAME
RUNWAY LIGHTING	MIRL	SAME
RUNWAY MARKING	NONE	SAME
VISUAL APPROACH AIDS	NONE	PAPI, REIL
R/W DIMENSIONS	3400'x75'	SAME
R/W SAFETY AREA (RSA)	4000'x1500'	SAME
R/W OBJECT FREE AREA (ROFA)	4000'x5000'	SAME
R/W OBSTACLE FREE ZONE (ROFZ)	3800'x4000'	SAME
R/W PROTECTION ZONE (RPZ)	1700'x1010'x500'	SAME
R/W 1 TOUCHDOWN ZONE ELEV.	159.4'	SAME
R/W 19 TOUCHDOWN ZONE ELEV.	156.2'	SAME

LEGEND		
	EXISTING	ULTIMATE
PROPERTY LINE	---	---
BUILDING RESTRICTION LINE (B.R.L.)	B.R.L.	B.R.L.
DEVELOPMENT	□	□
WIND CONE & SEGMENTED CIRCLE	☼	☼
BUILDING	□	■
ROADWAY	==	==
AIRPORT REFERENCE POINT	⊙	⊙
ROTATING BEACON	⊙	⊙
ANTENNA/TOWER	⊙	⊙
PRIMARY MONUMENT	⊙	⊙
10' ELEVATION CONTOURS	⊙	⊙
SHORELINE/WATERLINE	~	~
TREELINE	~	~
THRESHOLD	---	---
OVERHEAD POWER	⊙	⊙
PAPI	⊙	⊙

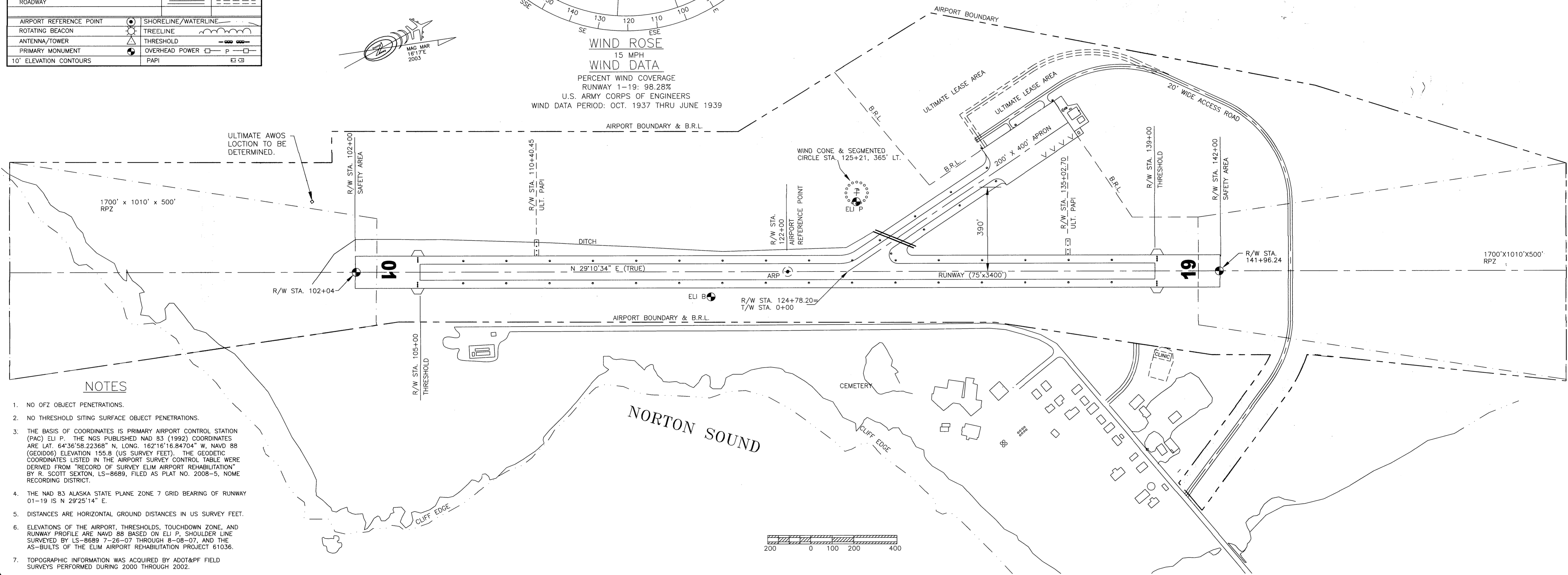

- NOTES
- NO OFZ OBJECT PENETRATIONS.
 - NO THRESHOLD SITING SURFACE OBJECT PENETRATIONS.
 - THE BASIS OF COORDINATES IS PRIMARY AIRPORT CONTROL STATION (PAC) ELI P. THE NGS PUBLISHED NAD 83 (1992) COORDINATES ARE LAT. 64°36'58.22368" N, LONG. 162°16'16.84704" W, NAVD 88 (GEOID06) ELEVATION 155.8 (US SURVEY FEET). THE GEODETIC COORDINATES LISTED IN THE AIRPORT SURVEY CONTROL TABLE WERE DERIVED FROM "RECORD OF SURVEY ELIM AIRPORT REHABILITATION" BY R. SCOTT SEXTON, LS-8689, FILED AS PLAT NO. 2008-5, NOME RECORDING DISTRICT.
 - THE NAD 83 ALASKA STATE PLANE ZONE 7 GRID BEARING OF RUNWAY 01-19 IS N 29°25'14" E.
 - DISTANCES ARE HORIZONTAL GROUND DISTANCES IN US SURVEY FEET.
 - ELEVATIONS OF THE AIRPORT, THRESHOLDS, TOUCHDOWN ZONE, AND RUNWAY PROFILE ARE NAVD 88 BASED ON ELI P. SHOULDER LINE SURVEYED BY LS-8689 7-26-07 THROUGH 8-08-07, AND THE AS-BUILTS OF THE ELIM AIRPORT REHABILITATION PROJECT 61036.
 - TOPOGRAPHIC INFORMATION WAS ACQUIRED BY ADOT&PF FIELD SURVEYS PERFORMED DURING 2000 THROUGH 2002.

T:\00 Aviation & Community Rds & Buildings\Elim\02_ALP_File\08asbuil\ALP_Elim08asbuil\ALP-01psht1

DESIGN	LMR
DRAWN	CAT
CHECKED	CML
BY	DATE
DATE	REVISIONS
2/20/07	AS-BUILT
1/29/03	FAA APPROVED

STATE OF ALASKA
DEPARTMENT OF TRANSPORTATION AND PUBLIC FACILITIES
NORTHERN REGION - DESIGN AND ENGINEERING SERVICES

APPROVED: *Patricia D. Miller* DATE: 8/26/08
PATRICIA D. MILLER, P.E. DESIGN GROUP CHIEF

AIRPORT LAYOUT PLAN APPROVED
BY LETTER DATED: 9/11/08

[Signature]

AIRPORTS DIVISION, AAL-601
ALASKAN REGION 02AAL-29NRA

THIS ALP SUPERSEDES ALP SIGNED 1/29/03.
THIS ALP IS BASED ON THE AS-BUILTS DATED 2/20/07
ELIM AIRPORT REHABILITATION, 61036.

ELIM AIRPORT
AIRPORT LAYOUT PLAN

SHEET
1 OF
4

T:\00 Aviation & Community Rds & Buildings\Elim\0 General\02 ALP File\08asubuilALP\Elim08asubuilALP-opsht2

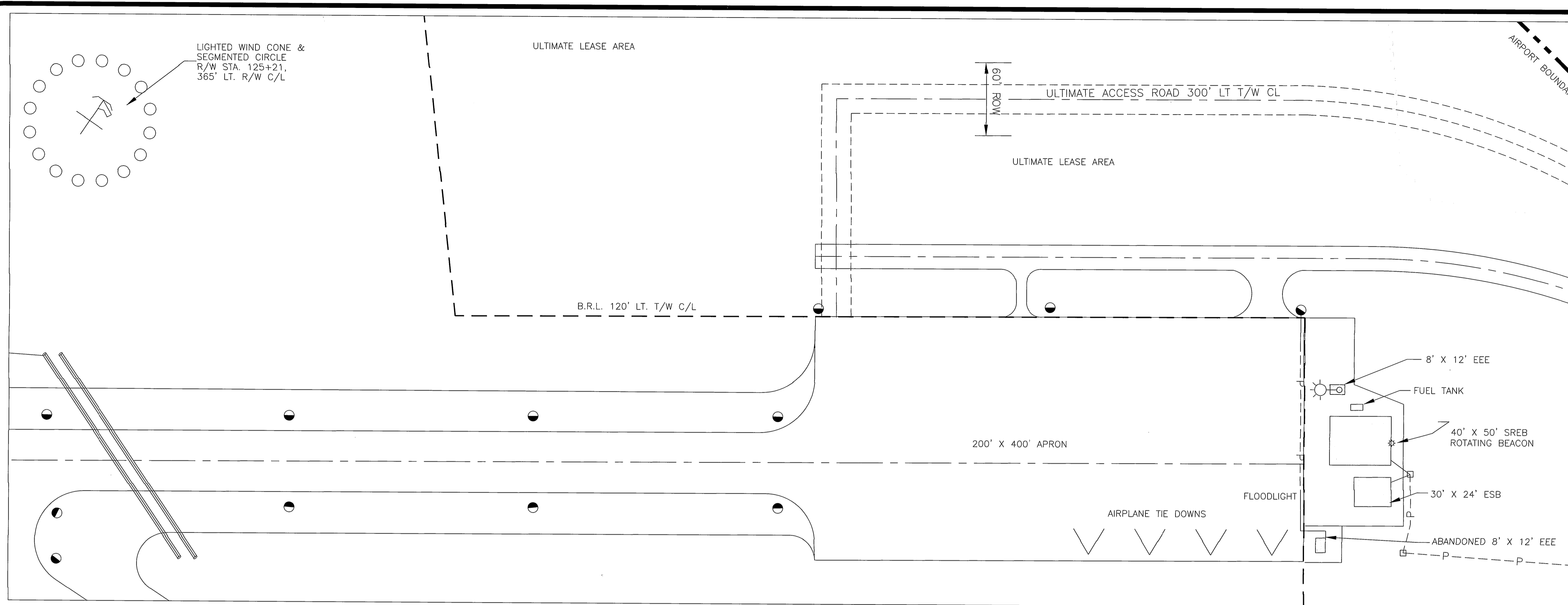

TAXIWAY DATA		
	RUNWAY 1-19	
	EXISTING	ULTIMATE
T/W WIDTH	50'	SAME
T/W LENGTH	800'	SAME
T/W SAFETY AREA WIDTH	120'	SAME
T/W OFA	186'	SAME

T/W IS BASED ON DESIGN GROUP III

BUILDING DATA		
	HEIGHT	TOP ELEV.
SREB	20'	160'
ESB	12'	152'
ABANDONED EEE	10'	150'
ROTATING BEACON	30'	170'
FLOOD LIGHT	38'	178'
ELECTRICAL EQUIPMENT ENCLOSURE (EEE)	9'	149'

TERMINAL PLAN

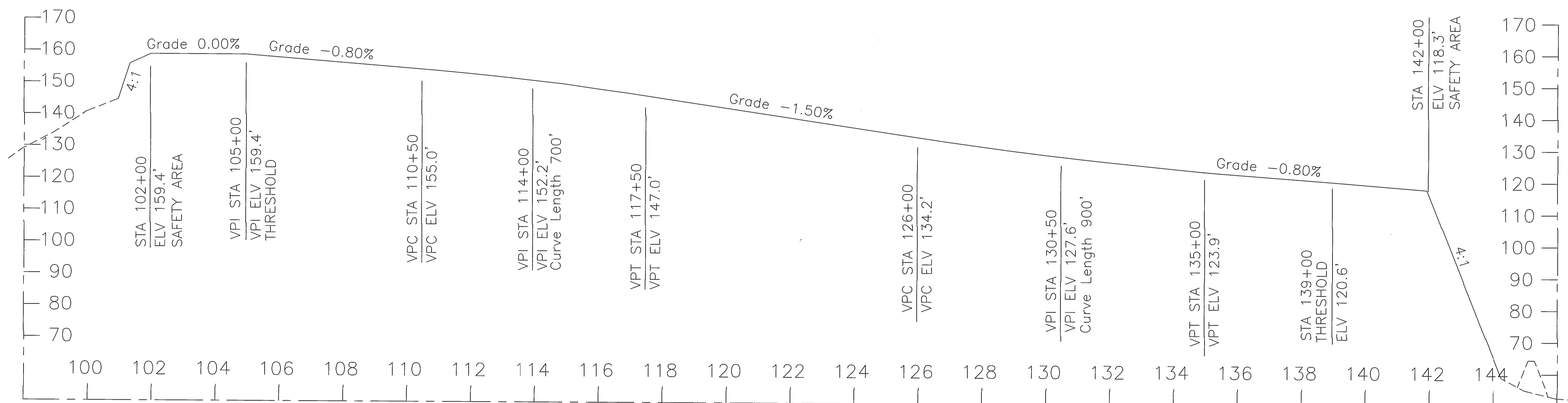

R/W 1-19 PROFILE

DESIGN	LMR
DRAWN	CAT
CHECKED	CML
BY	DATE
REVISIONS	
2/20/07	AS-BUILT
1/29/03	FAA APPROVED

STATE OF ALASKA
 DEPARTMENT OF TRANSPORTATION AND PUBLIC FACILITIES
 NORTHERN REGION - DESIGN AND ENGINEERING SERVICES

APPROVED: *Patricia D. Miller* DATE: 8/26/08
 PATRICIA D. MILLER, P.E. DESIGN GROUP CHIEF

AIRPORT LAYOUT PLAN APPROVED
 BY LETTER DATED: 9/11/08

[Signature]

AIRPORTS DIVISION, AAL-601
 ALASKAN REGION 02AAL-29NRA

THIS ALP SUPSEDES ALP SIGNED 1/29/03.
 THIS ALP IS BASED ON THE AS-BUILTS DATED 2/20/07
 ELIM AIRPORT REHABILITATION, 61036.

ELIM AIRPORT
 TERMINAL PLAN
 RUNWAY PROFILE

SHEET
 2 OF 4

T:\00 Aviation & Community Rds & Buildings\Elim\0 General\02 ALP File\08Asbuilt\ALP\Elim08AsbuiltALP - gipahk3

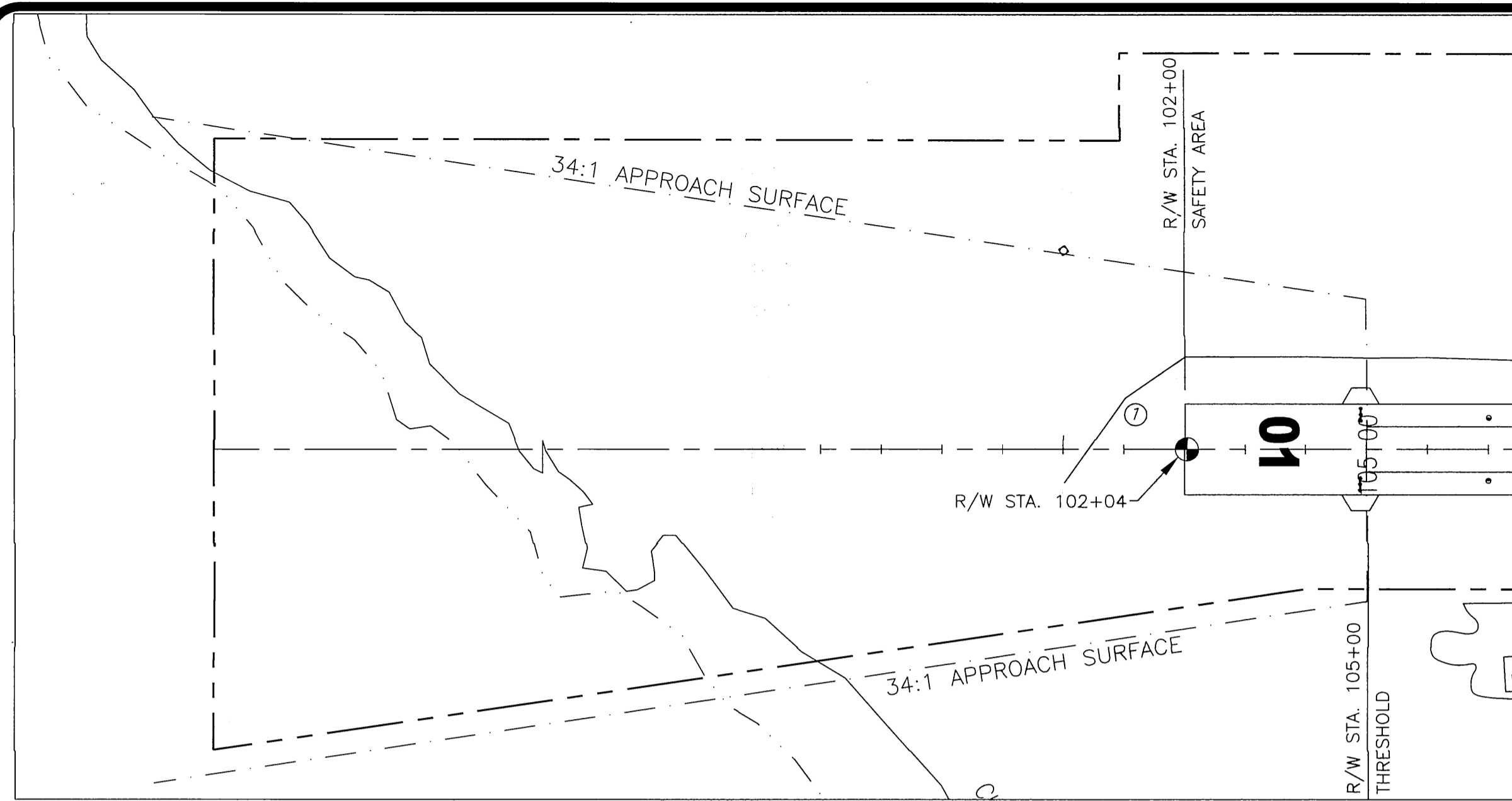

APPROACH SURFACE 1 PLAN

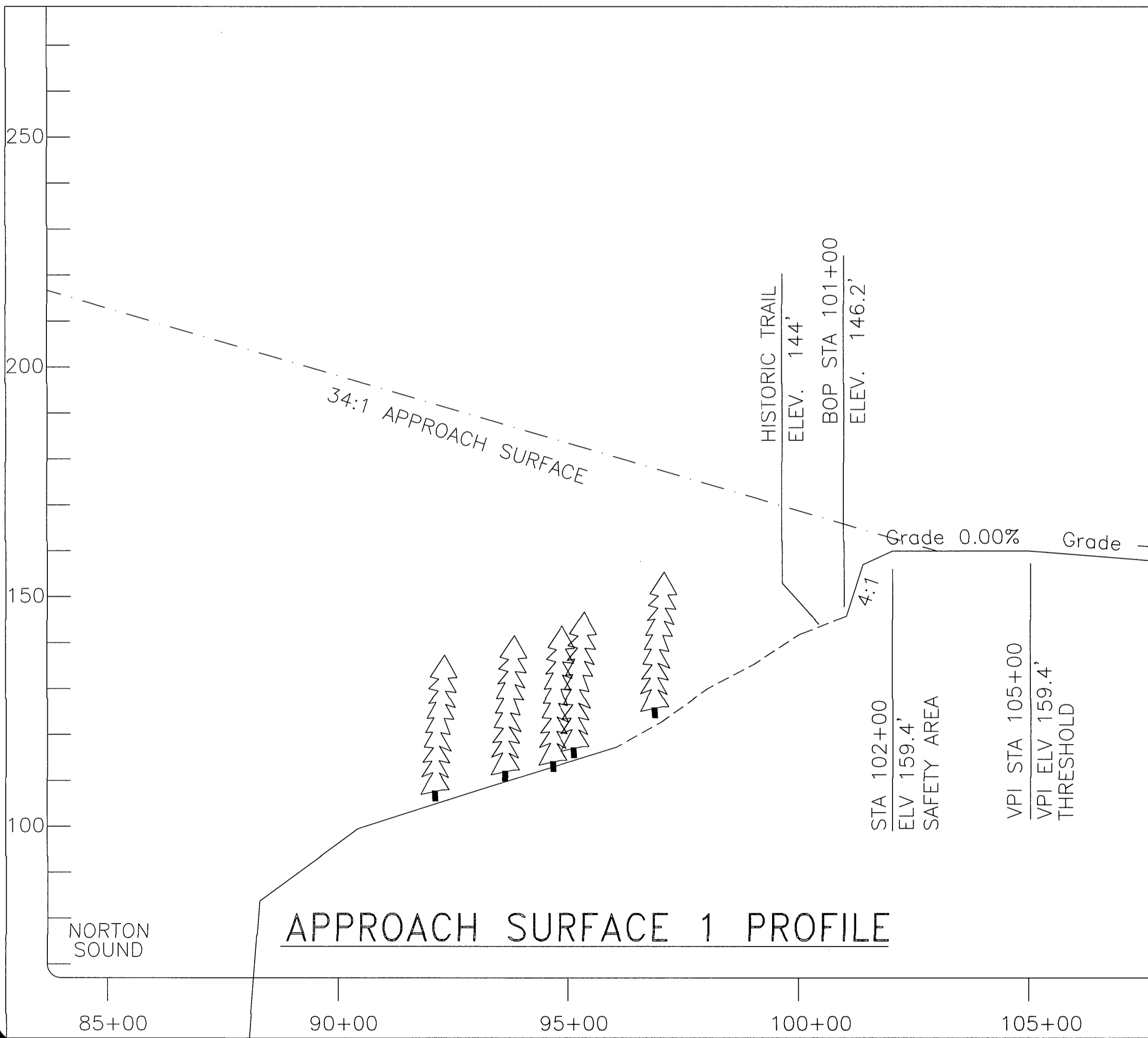

APPROACH SURFACE 1 PROFILE

OBSTRUCTION TABLE: R/W (01) APPROACH

#	STRUCTURE NAME	TOP ELEV.	APPROACH SURFACE PENETRATION	PROPOSED DISPOSITION OF OBSTRUCTION
1	HISTORIC TRAIL	144'	-21'	NONE

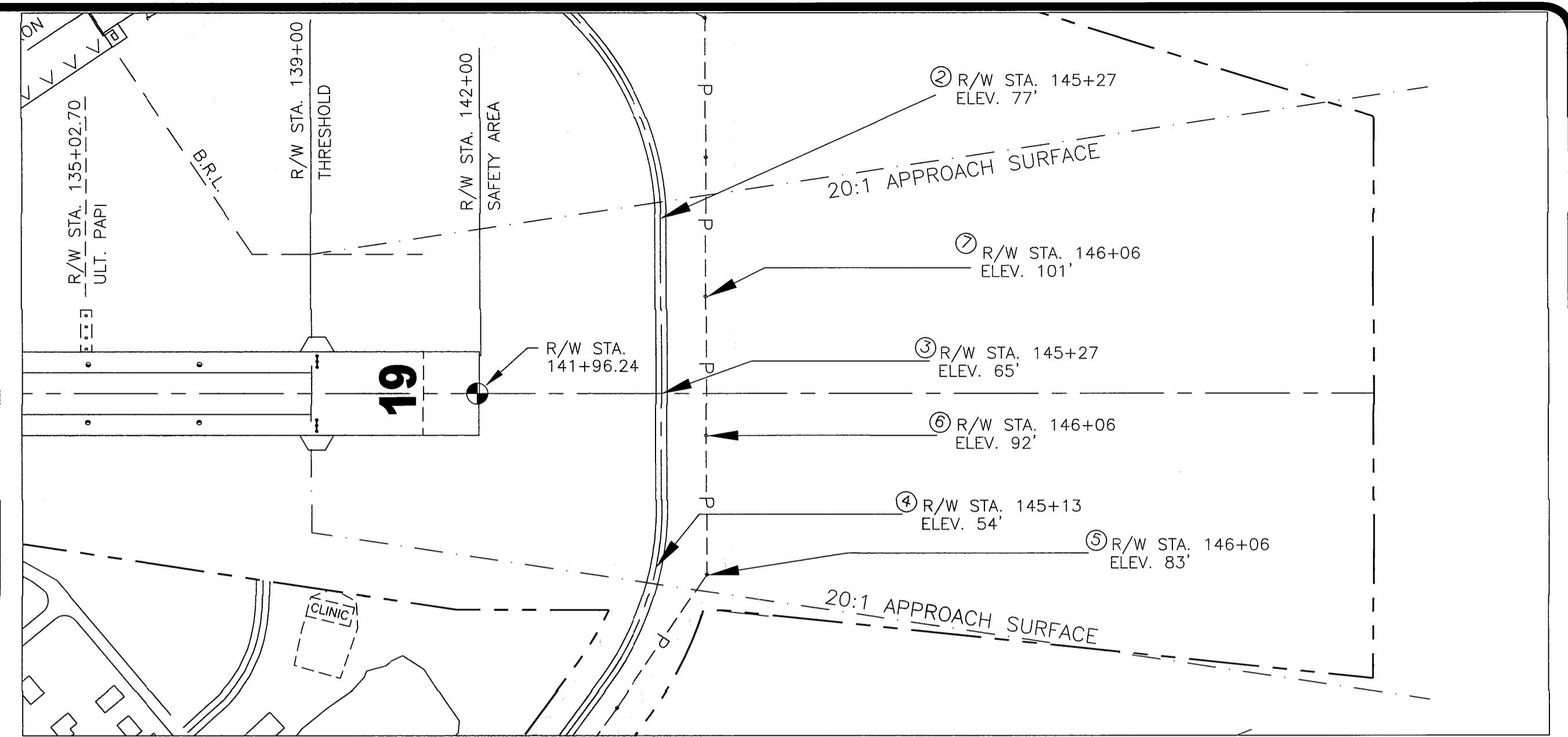
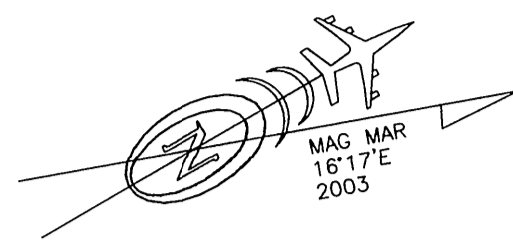

APPROACH SURFACE 19 PLAN

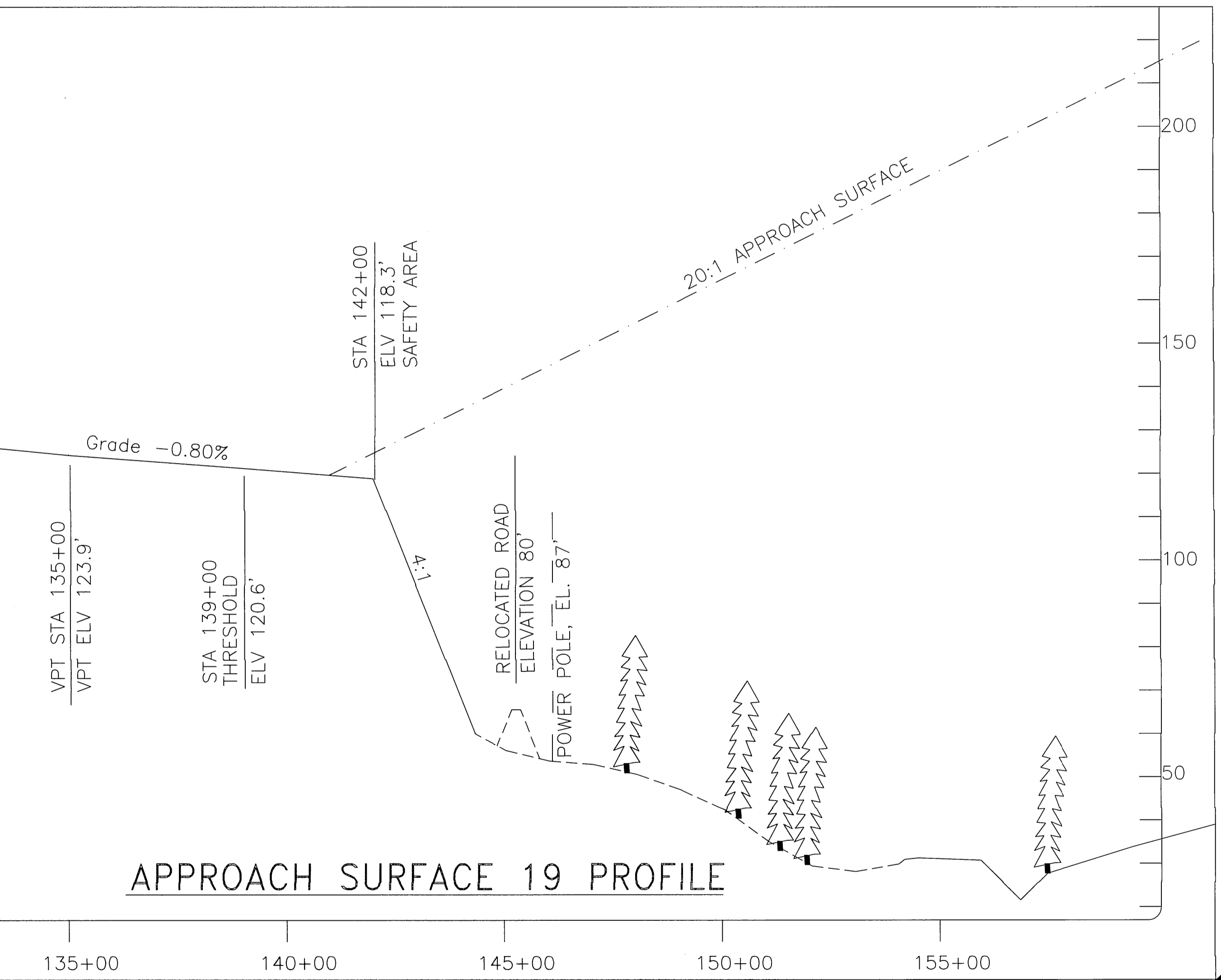

APPROACH SURFACE 19 PROFILE

OBSTRUCTION TABLE: R/W (19) APPROACH

#	STRUCTURE NAME	TOP ELEV.	APPROACH SURFACE PENETRATION	PROPOSED DISPOSITION OF OBSTRUCTION
2	ACCESS ROAD C/L	77'	-84'	NONE
3	ACCESS ROAD C/L	85'	-78'	NONE
4	ACCESS ROAD C/L	54'	-74'	NONE
5	OVERHEAD POWER LINE	83'	-62'	NONE
6	OVERHEAD POWER LINE	92'	-53'	NONE
7	OVERHEAD POWER LINE	101'	-44'	NONE

DESIGN_LMR

DRAWN_CAT

CHECKED_CML

BY	DATE	REVISIONS

STATE OF ALASKA
DEPARTMENT OF TRANSPORTATION AND PUBLIC FACILITIES
NORTHERN REGION - DESIGN AND ENGINEERING SERVICES

APPROVED *Patricia D. Miller* DATE 8/26/08
PATRICIA D. MILLER, P.E. DESIGN GROUP CHIEF

AIRPORT LAYOUT PLAN APPROVED
BY LETTER DATED: 9/11/08

[Signature]
AIRPORTS DIVISION, AAL-601
ALASKAN REGION 02AAL-29NRA

THIS ALP SUPSEDES ALP SIGNED 1/29/03.
THIS ALP IS BASED ON THE AS-BUILTS DATED 2/20/07
ELIM AIRPORT REHABILITATION, 61036.

ELIM AIRPORT
INNER PORTION OF APPROACH
SURFACE PLAN & PROFILE

SHEET
3 OF 4

F:\00 Aviation & Community Rds & Buildings\Elim\0 General\02 ALP File\08asbuilt\ALP_Elim08asbuilt\ALP_alpsht4

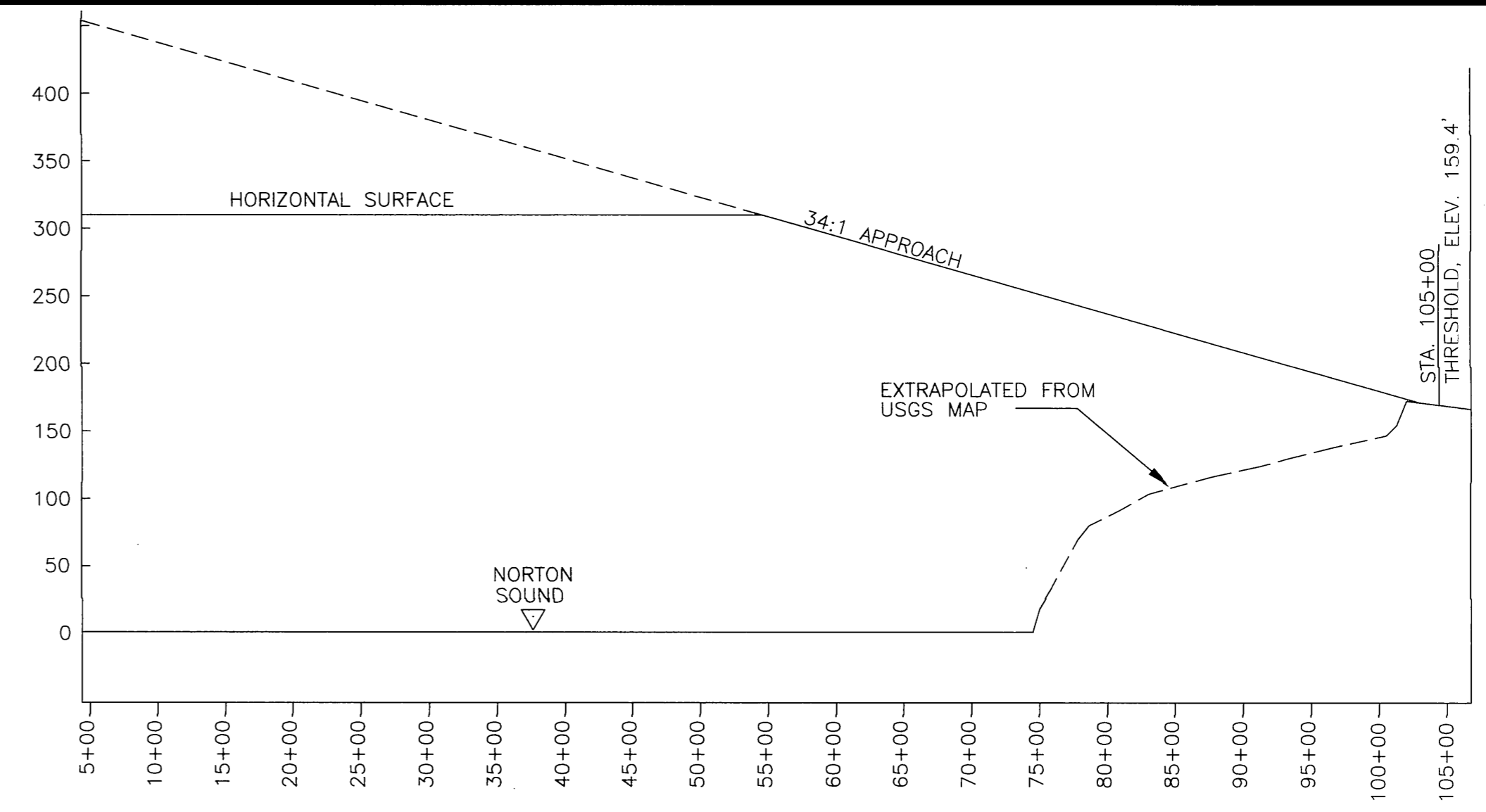
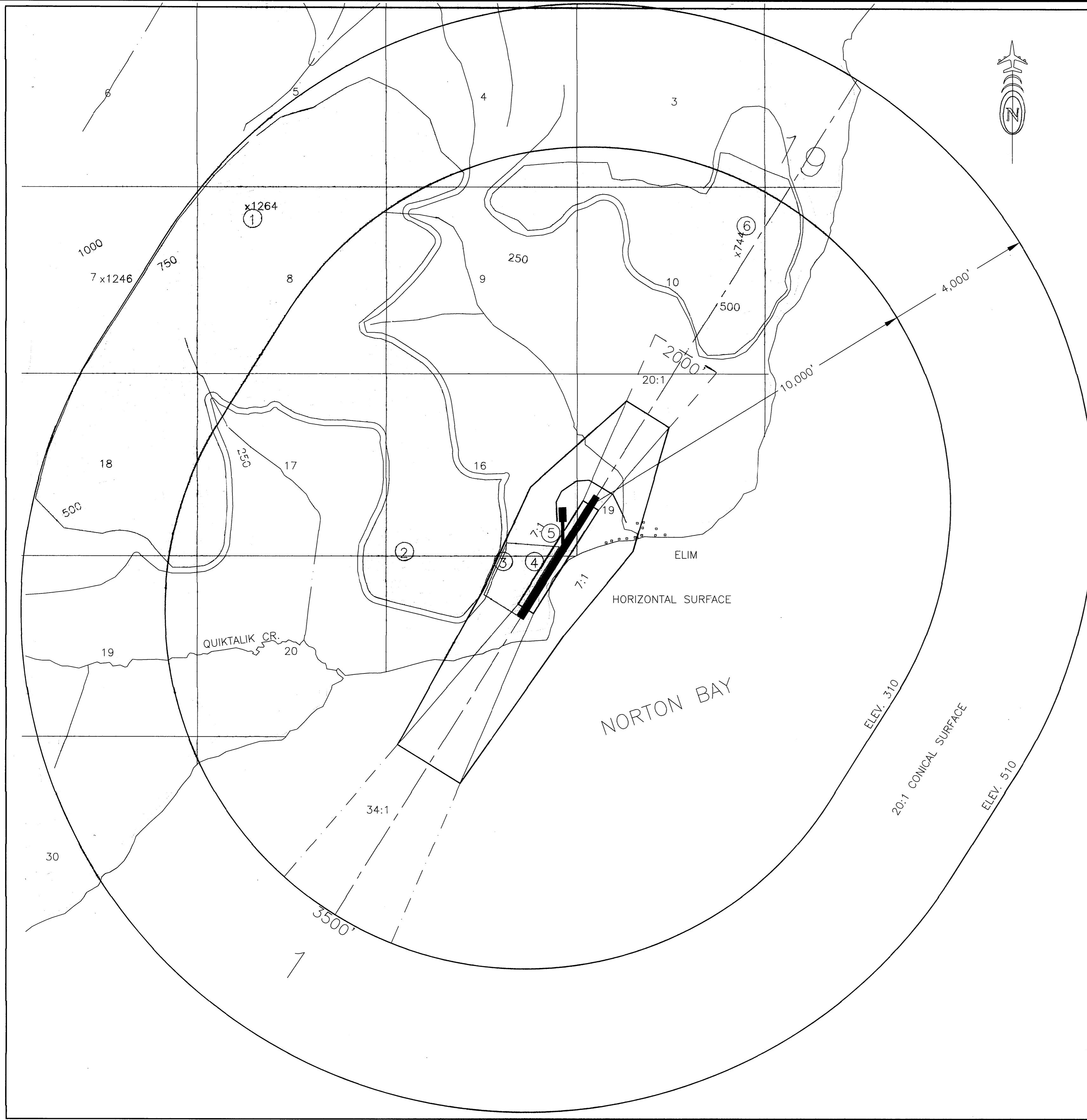

R/W 1 COMPOSITE ORIGINAL GROUND PROFILE

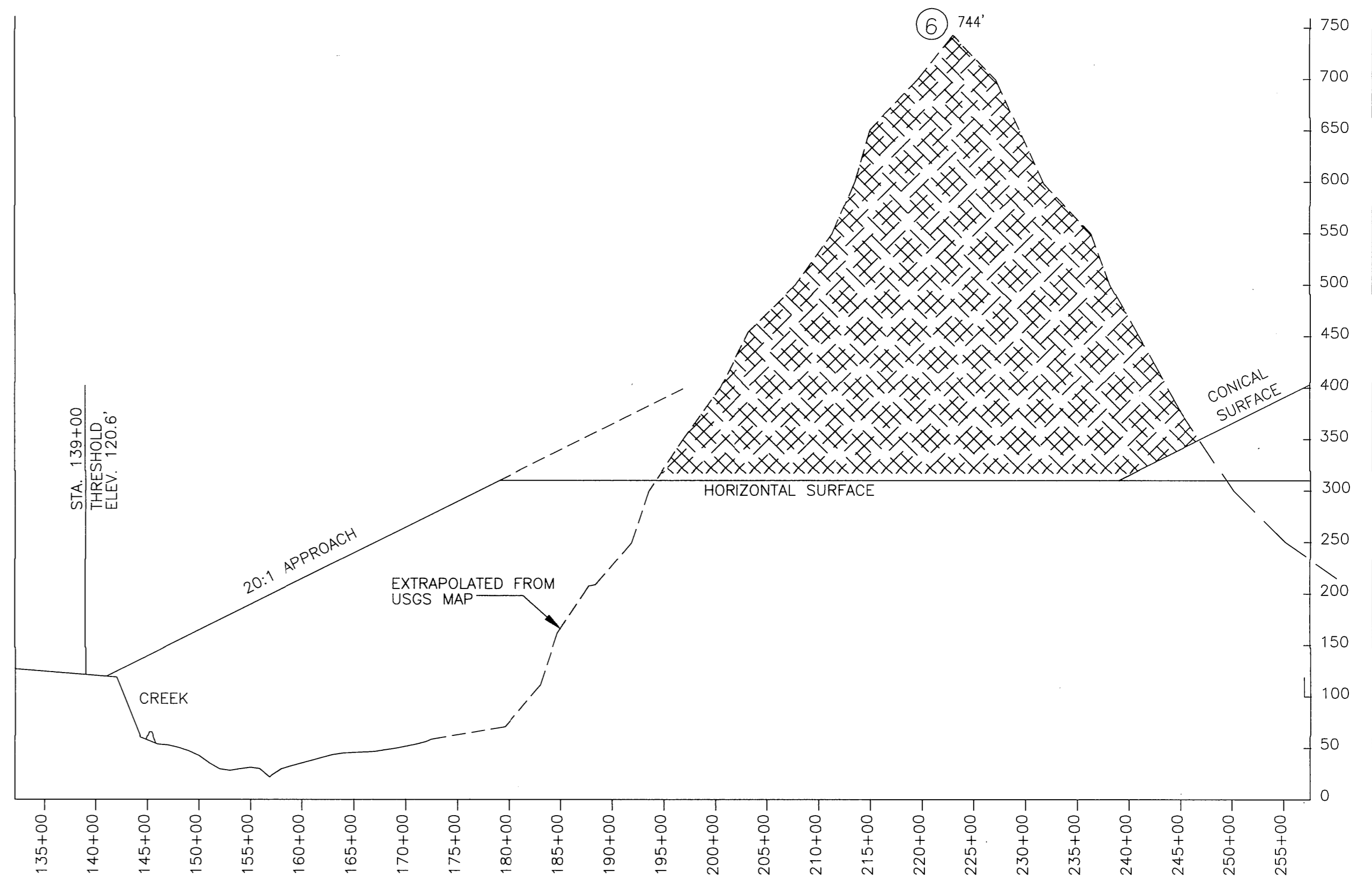

R/W 19 COMPOSITE ORIGINAL GROUND PROFILE

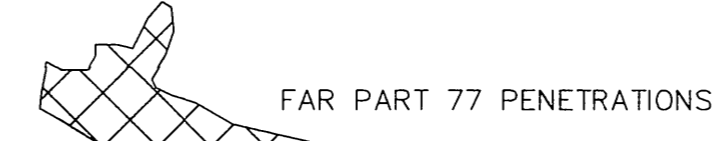

NOTES:
REFER TO THE INNER PORTION OF THE APPROACH SURFACE PLAN VIEW DETAILS FOR CLOSE-IN OBSTRUCTIONS.

OBSTRUCTION TABLE				
#	STRUCTURE NAME	TOP ELEV.	SURFACE PENETRATION	PROPOSED DISPOSITION OF OBSTRUCTION
1	HILL WEST OF RUNWAY	1,264'	CONICAL: TO +821	NONE
2	HILL WEST OF RUNWAY	697'	HORIZONTAL: +350	NONE
3	HILL WEST OF RUNWAY	268'	7:1 SURFACE: +50	NONE
4	HILL WEST OF RUNWAY	180'	PRIMARY: TO +20	EXCAVATE AND USE AS A MATERIAL SITE
5	TAXIWAY	136'	PRIMARY: +5	NONE
6	HILL NE OF RUNWAY	744'	CONICAL: TO +200	NONE

DESIGN_LMR	
DRAWN_CAT	
CHECKED_CML	
BY	DATE
	REVISIONS
	2/20/07 AS-BUILT
	1/29/03 FAA APPROVED

STATE OF ALASKA
DEPARTMENT OF TRANSPORTATION AND PUBLIC FACILITIES
NORTHERN REGION - DESIGN AND ENGINEERING SERVICES

APPROVED *Patricia D. Miller* DATE *8/26/08*
PATRICIA D. MILLER, P.E. DESIGN GROUP CHIEF

AIRPORT LAYOUT PLAN APPROVED
BY LETTER DATED: *9/4/08*

Patricia D. Miller
AIRPORTS DIVISION, AAL-601
ALASKAN REGION 02AAL-29NRA

THIS ALP SUPSEDES ALP SIGNED 1/29/03.
THIS ALP IS BASED ON THE AS-BUILTS DATED 2/20/07
ELIM AIRPORT REHABILITATION, 61036.

ELIM AIRPORT
AIRSPACE AND
COMPOSITE APPROACH PROFILES

SHEET
4 OF
4