

CONSTRUCTION PLANS FOR

SKAGWAY AIRPORT

RUNWAY & APRON IMPROVEMENTS

S.C. No. 81-377-01

1981

SPONSORED BY THE STATE OF ALASKA

ada

STATE OF ALASKA
DEPARTMENT OF TRANSPORTATION and PUBLIC FACILITIES
DIVISION OF AVIATION - DESIGN & CONSTRUCTION

APPROVED Clayton C. Hueners DATE 6/4/81
CLAYTON C. HUENERS DIRECTOR

AS - BUILT PLANS
CONTRACTOR - BERG CONSTRUCTION
PROJECT ENGINEER - LARRY GEISE
COMPLETION DATE - 1981

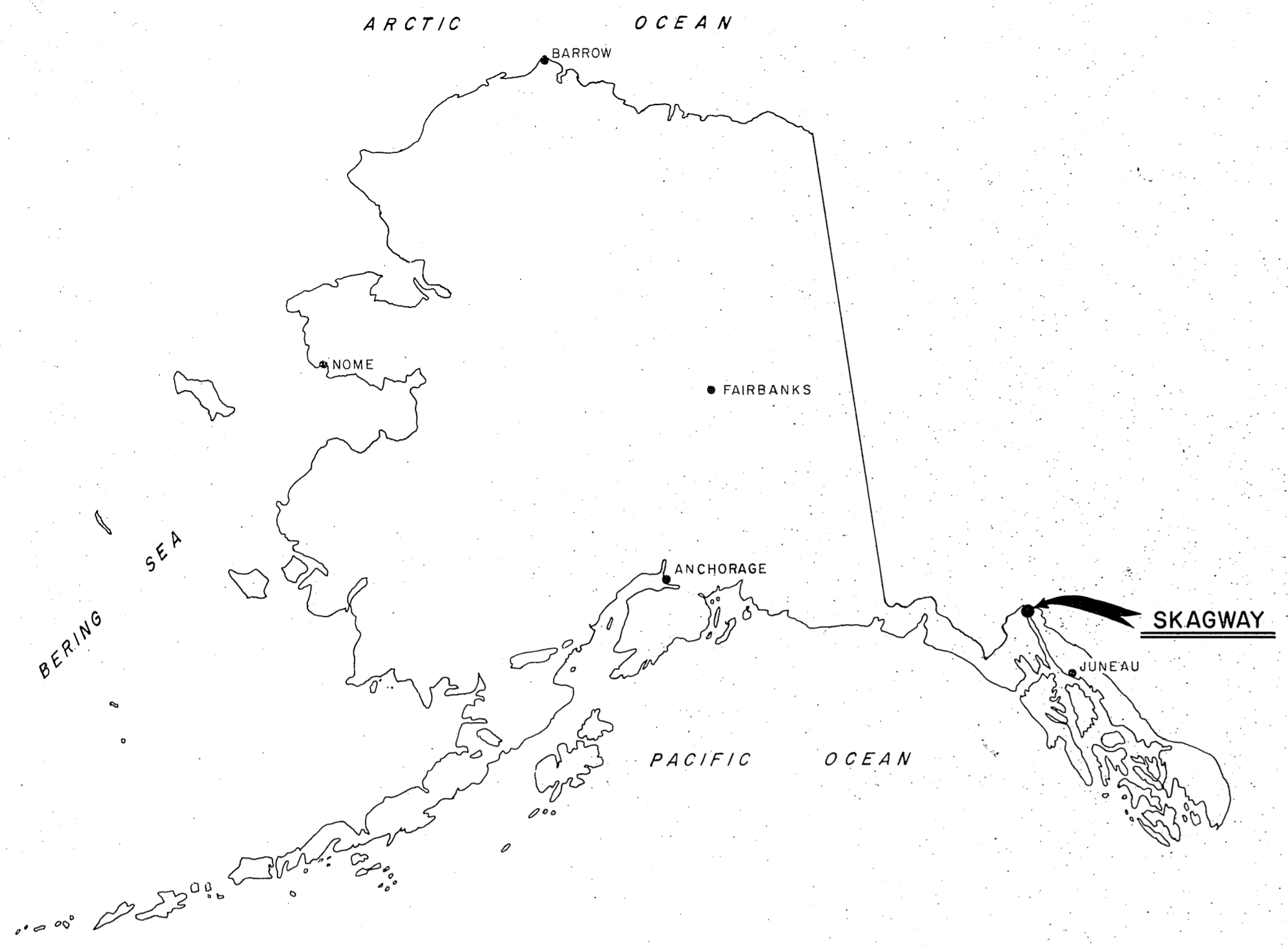

LOCATION MAP
NOT TO SCALE

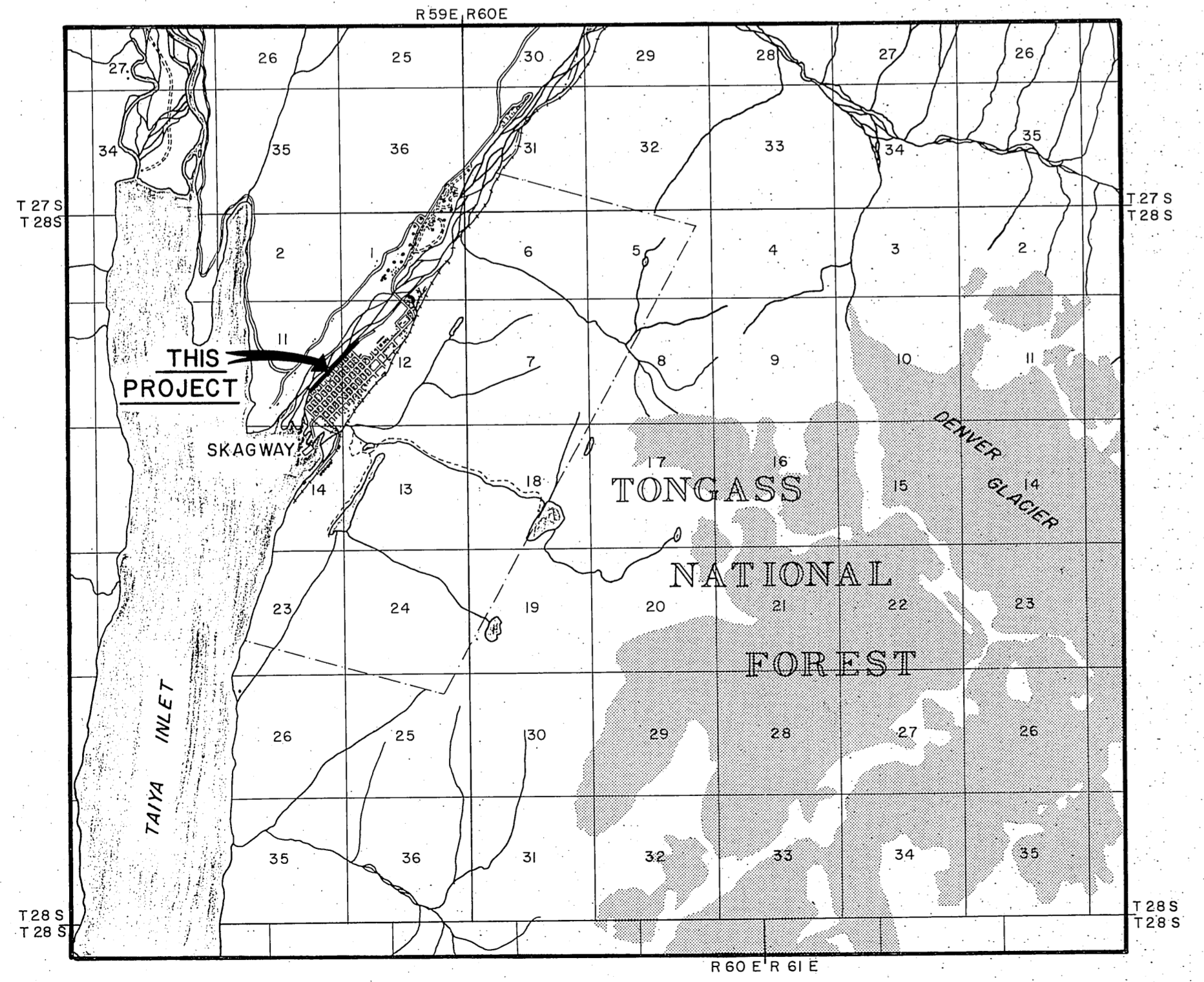

VICINITY MAP
SCALE: 1" = 1 MILE

ESTIMATED QUANTITIES

NO.	ITEM	QUANTITY	UNIT
100	MOBILIZATION & DEMOBILIZATION	ONE JOB	L.S.
130	ENGINEERS FIELD OFFICE	ONE JOB	L.S.
230	STRIPPING	5,165 5,532	C.Y.
240	RUNWAY RECONDITIONING	ONE JOB	L.S.
270	SURFACE PREPARATION	26,700 42,739	S.Y.
330d	BORROW EMBANKMENT	6,775 9,771	C.Y.
426	BUILDING RELOCATION AND UTILITY CONNECTION	ONE JOB	L.S.
510a	CRUSHED AGGREGATE BASE	9,000 15,048	TONS
600	BITUMINOUS PRIME COAT MC-30	28.2 31.48	TONS
650a	BITUMINOUS MATERIAL SURFACE TREATMENT	103 176.71	TONS
650b	AGGREGATE SURFACE TREATMENT	84 937	TONS
700	RUNWAY, TAXIWAY MARKINGS	ONE JOB	L.S.
722	WIND CONE & SEGMENTED CIRCLE RELOCATION	ONE JOB	L.S.
820	TIE-DOWN ANCHORS	36	EACH
3000	PETROLEUM ESCALATION	ALL REQ'D	P.C.S.
ADDITIVE ALTERNATE # 1			
109	PETROLEUM ESCALATION	ALL REQ'D	P.C.S.
115 (I)	TRAFFIC MAINTENANCE	ALL REQ'D	L.S.
304(I)	SUBBASE, GRADING "C"	10,617	TONS

INDEX

SHEET TITLE	SHEET NO.
TITLE SHEET	1
LOCATION AND VICINITY MAPS, ESTIMATED QUANTITIES AND INDEX	2
PROJECT LAYOUT PLAN	3
RUNWAY PLAN & PROFILE & TEST HOLE LOCATIONS	4
TYPICAL SECTIONS	5
APRON EXPANSION PLAN, TIE-DOWN RESTRAINTS & DETAILS	6
APRON EXPANSION CROSS SECTIONS	7
RUNWAY CROSS SECTIONS	8-12
RUNWAY, APRON MARKING PLAN	13

AS-BUILT PLANS







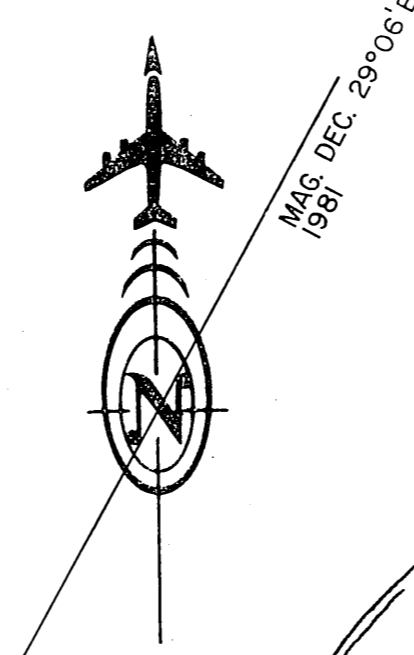
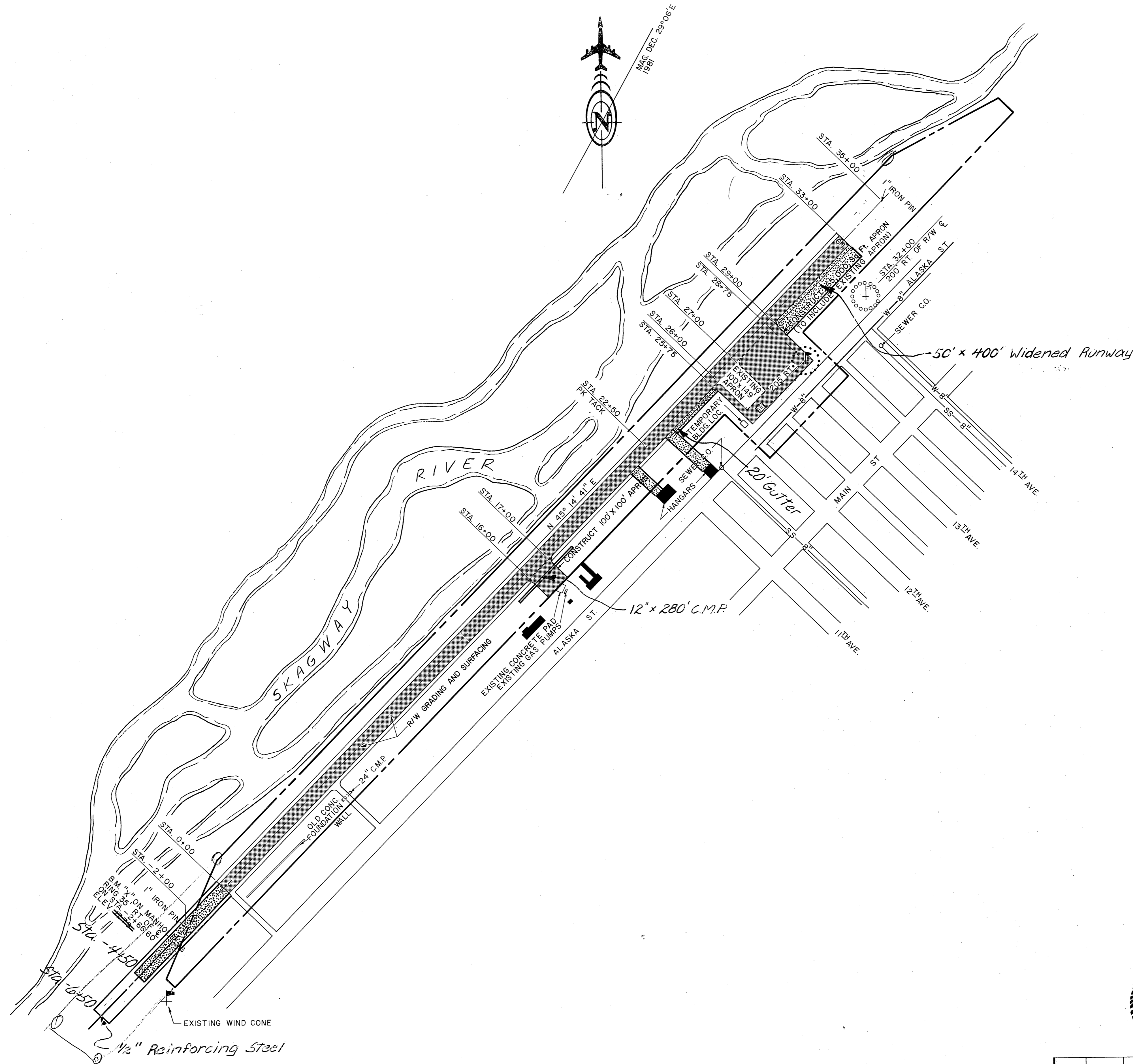

STATE OF ALASKA
DEPARTMENT OF TRANSPORTATION
AND PUBLIC FACILITIES
DIVISION OF AVIATION-DESIGN AND CONSTRUCTION

SKAGWAY AIRPORT
S.C. No. 81-377-01
LOCATION AND VICINITY MAPS,
ESTIMATED QUANTITIES AND INDEX

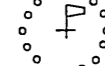
APPROVED	<i>William A. Allison</i>	WILLIAM A. ALLISON, P.E.	CHIEF DESIGN ENGINEER
APPROVED	<i>William Koester</i>	WILLIAM KOESTER, P.E.	SOUTHEASTERN REGION ENGINEER
BY	DATE	REVISIONS	
W.K.	6/1/81	DELETED, ITEM 250 REVISED QUANTITIES ITEM 330d ADDENDUM NO. 1	
SCALE	AS SHOWN	DESIGNED	DRAWN
		<i>W.K.</i>	<i>W.K.</i>
		CHECKED	DATE
		<i>W.K.</i>	6-3-81
			SHEET 2R OF 13



LEGEND

-  EXISTING WIND CONE & SEGMENTED CIRCLE
-  RELOCATE WIND CONE & SEGMENTED CIRCLE
-  EXISTING BUILDINGS
-  PROPOSED TERMINAL
-  8" WATER MAIN-DUCTILE IRON, BURIED ±7'
-  8" SANITARY SEWER-PVC, BURIED ±8'
-  REMOVE EXISTING BST, GRADE & RESURFACE RUNWAY, CONSTRUCT APRONS.
-  AIRPORT PROPERTY LINE

AS-BUILT PLANS



STATE OF ALASKA
 DEPARTMENT OF TRANSPORTATION
 AND PUBLIC FACILITIES
 DIVISION OF AVIATION-DESIGN AND CONSTRUCTION

SKAGWAY AIRPORT
 S.C. No 81-377-01
 PROJECT LAYOUT PLAN

APPROVED *William A. Allison*
 WILLIAM A. ALLISON, PE. CHIEF DESIGN ENGINEER

APPROVED *William Koester*
 WILLIAM KOESTER, PE. SOUTHEASTERN REGION ENGINEER

BY	DATE	CHANGE
REVISIONS		

SCALE 1"=200'
 DESIGNED *W.K.* DRAW *D.L.B.* AS-BUILT 3017
 CHECKED *W.K.* DATE 6-3-81 SHEET 3 OF 13

AS-BUILT PLANS

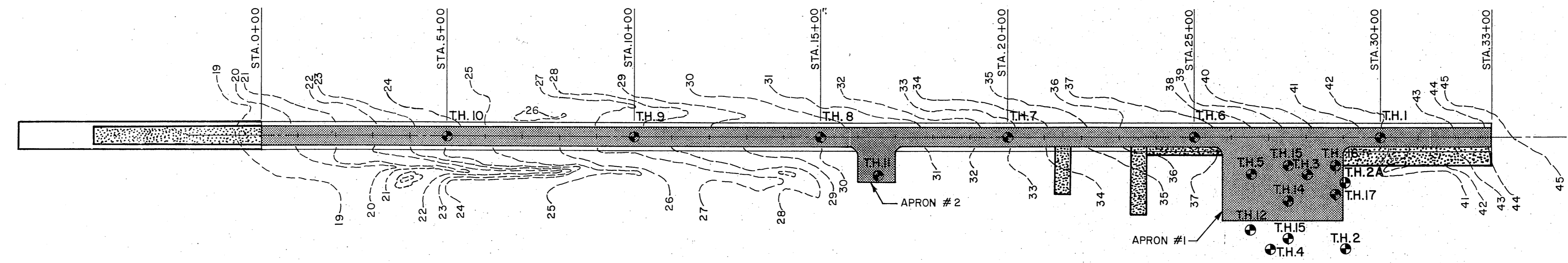
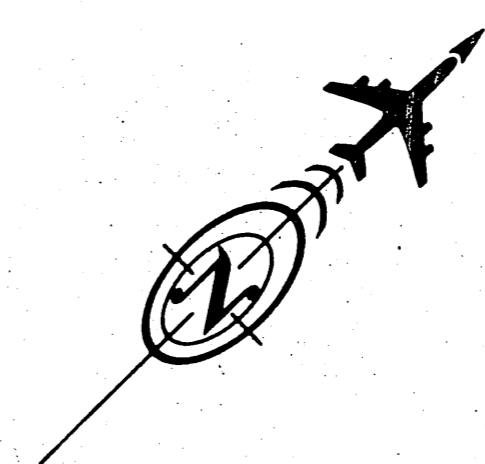

PLAN
SCALE 1" = 200'

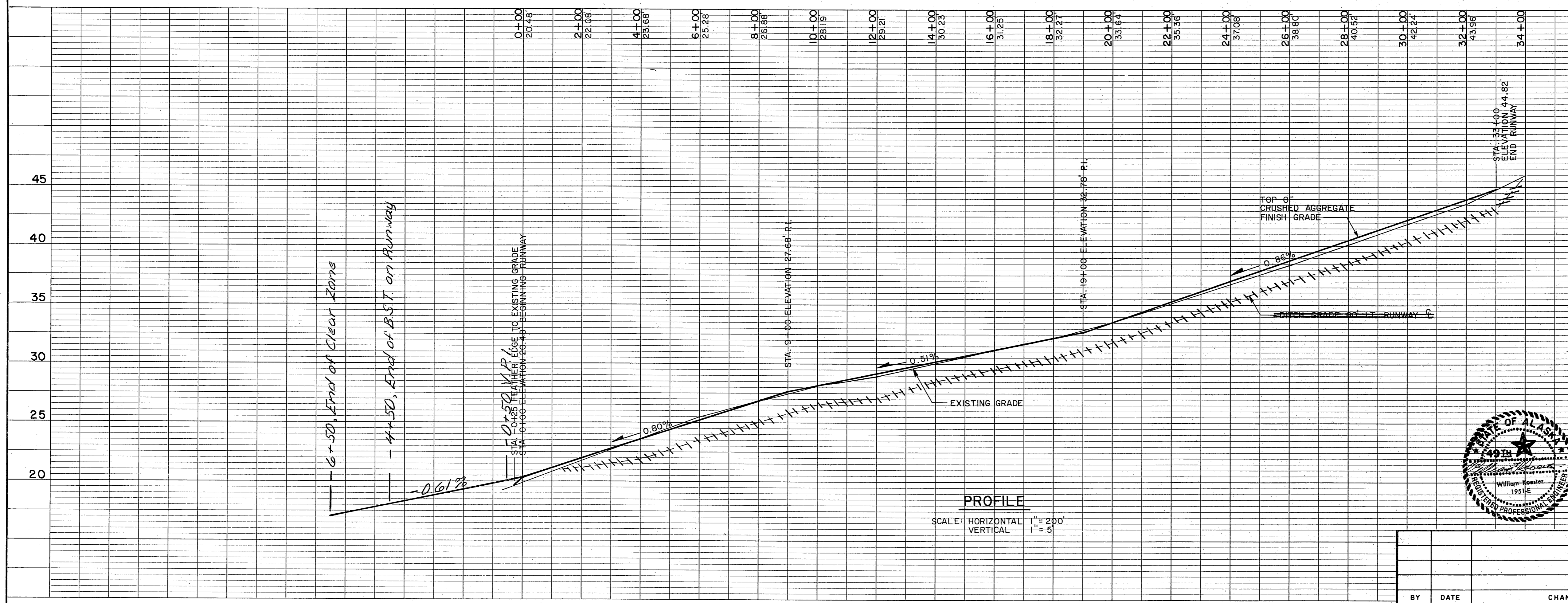

PROFILE
SCALE: HORIZONTAL 1" = 200'
VERTICAL 1" = 5'

NOTE
ELEVATIONS SHOWN ARE
TOP OF FINISHED CRUSHED
AGGREGATE BASE COURSE.

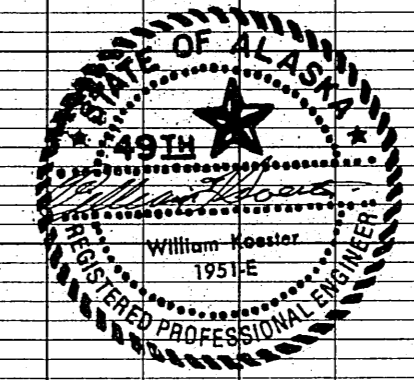

STATE OF ALASKA
DEPARTMENT OF TRANSPORTATION
AND PUBLIC FACILITIES
DIVISION OF AVIATION-DESIGN AND CONSTRUCTION

SKAGWAY AIRPORT
S.C. No. 81-377-01
PLAN & PROFILE AND
TEST HOLE LOCATION

APPROVED	<i>William A. Allison</i>		CHIEF DESIGN ENGINEER
APPROVED	<i>William Koester</i>		SOUTHEASTERN REGION ENGINEER
SCALE	DESIGNED	DRAWN	AS-BUILT 40' SHEET 4 OF 13
AS SHOWN	CHECKED	DATE 6-3-81	

BY	DATE	CHANGE

PLAN

DATE	
BY	
REVISIONS	
NOTED	
ALIGNMENT CHECKED	
RT. OF WAY CHECKED	
No.	

PROFILE

DATE	
BY	
REVISIONS	
NOTED	
GRADE CHECKED	
B. M.'S. NOTED	
PROF. LOCATIONS CHECKED	
No.	

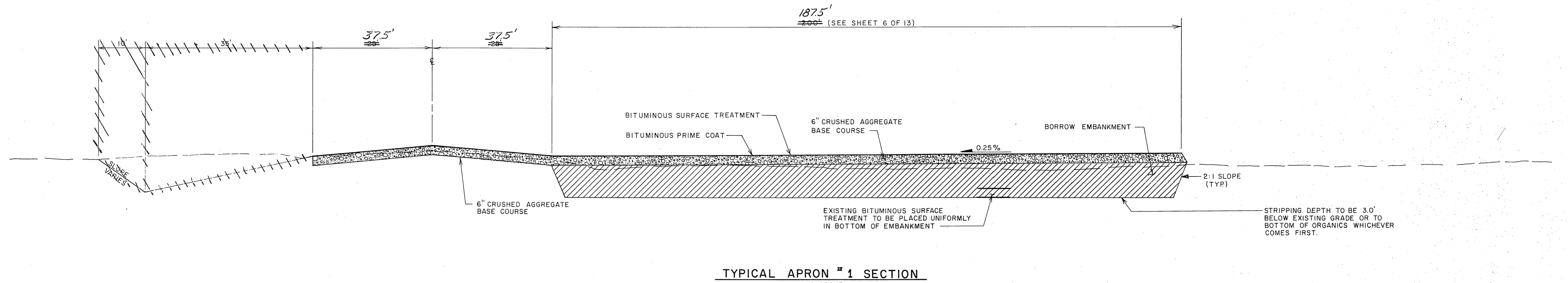

TYPICAL APRON # 1 SECTION
NO SCALE

NOTE:
6" OF EXISTING BASE TO BE REMOVED & PLACED AS BORROW EMBANKMENT IN APRON #1.

NOTE:
NO STRIPPING REQUIRED UNDER EXISTING PARKING APRON.

STRIPPING DEPTH TO BE 3.0' BELOW EXISTING GRADE OR TO BOTTOM OF ORGANICS WHICHEVER COMES FIRST.

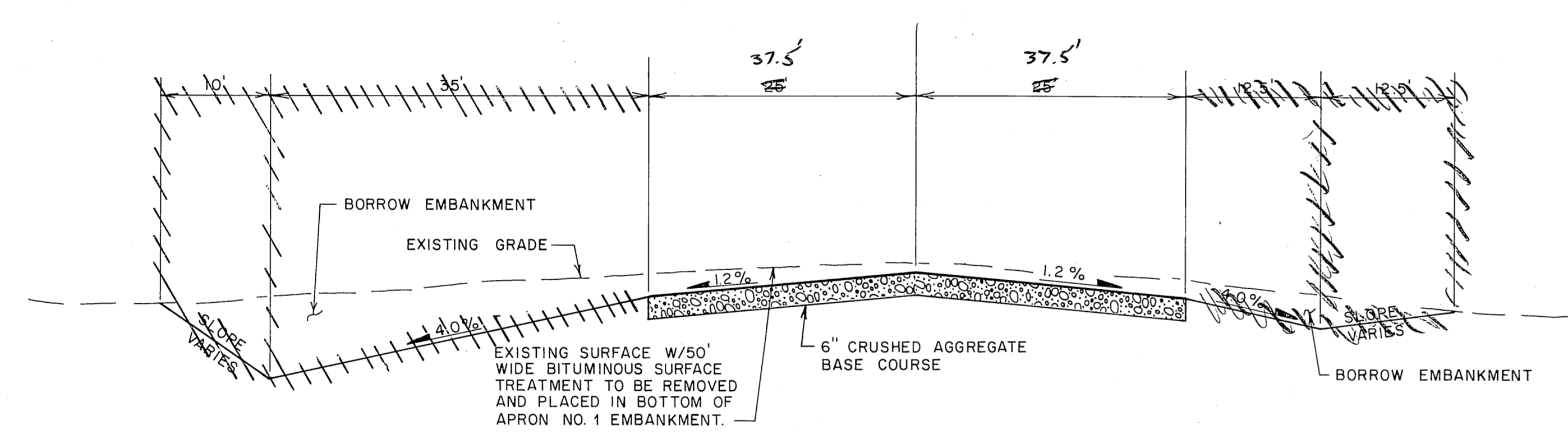

TYPICAL RUNWAY SECTION
BETWEEN STA. 5+00 TO 7+00 & STA. 18+00 TO 21+00
NO SCALE

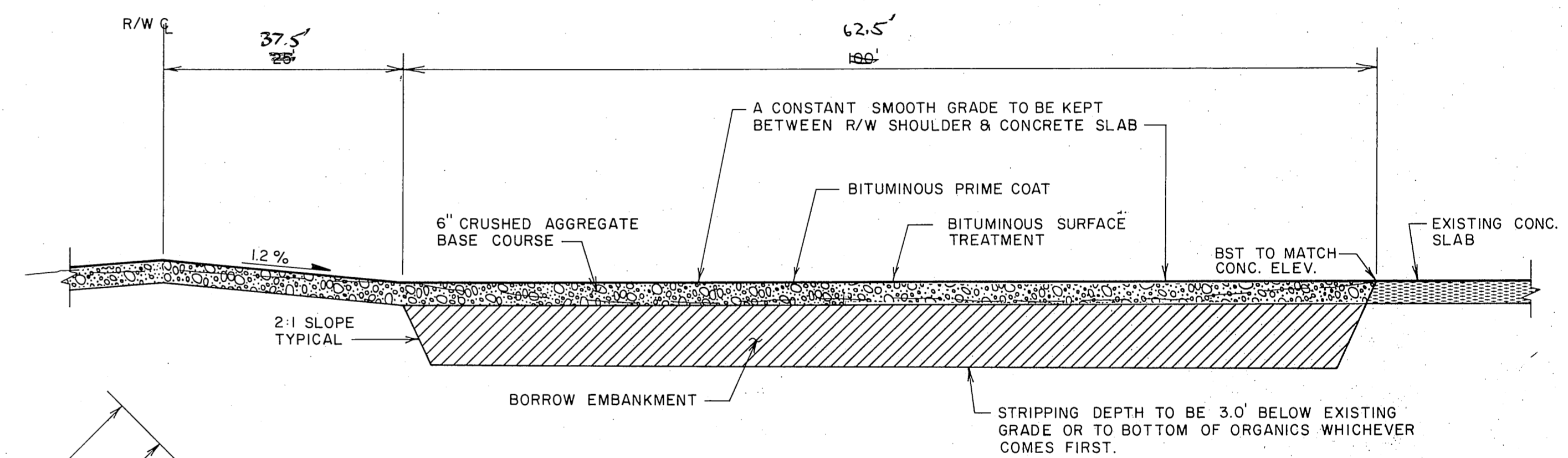

TYPICAL APRON # 2 SECTION
NO SCALE

STRIPPING DEPTH TO BE 3.0' BELOW EXISTING GRADE OR TO BOTTOM OF ORGANICS WHICHEVER COMES FIRST.

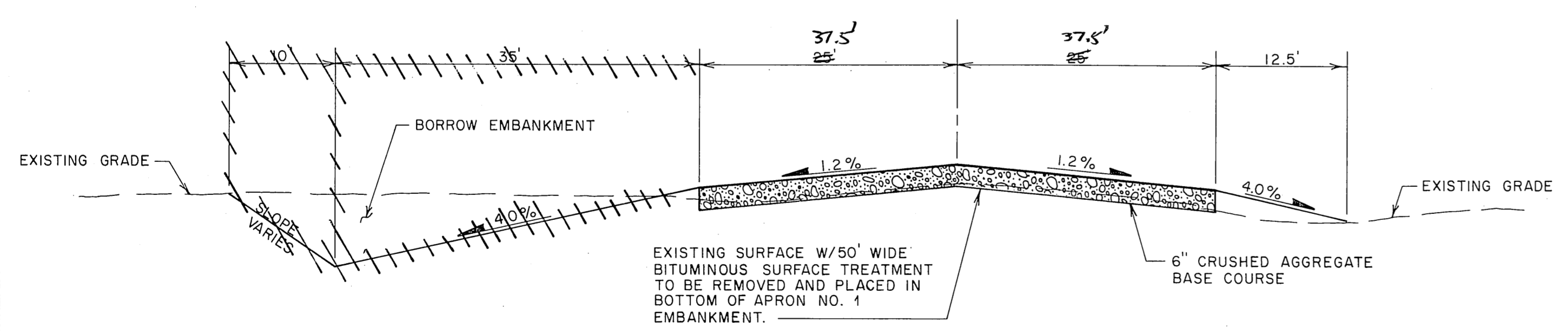

TYPICAL RUNWAY SECTION
NO SCALE

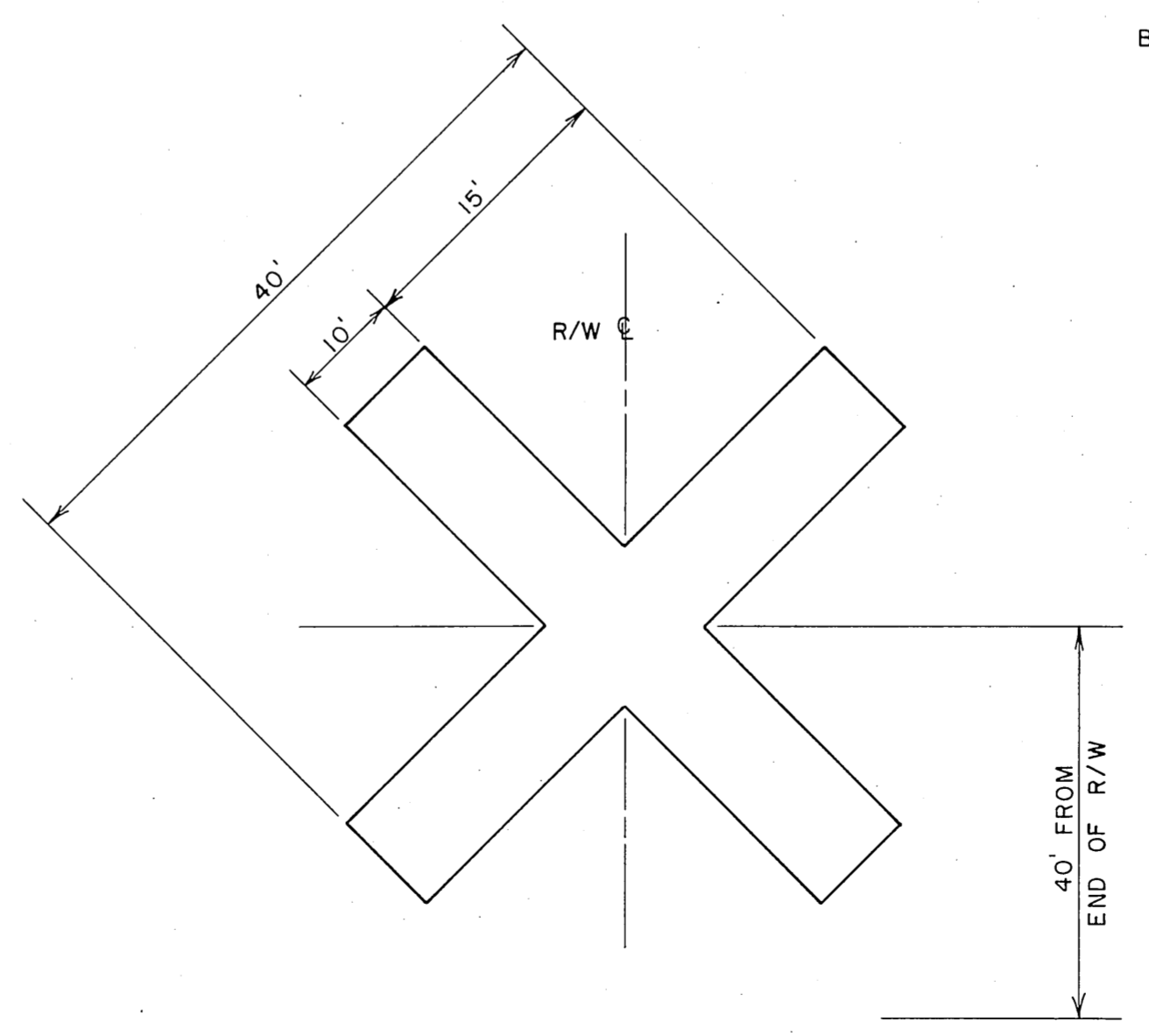

CLOSED R/W MARKING
NO SCALE

- NOTES:**
1. CROSSES SHALL BE WHITE IN COLOR, AND MAY BE CONSTRUCTED OF FABRIC, PLASTIC, PLYWOOD OR OTHER SUITABLE MATERIAL.
 2. CROSSES TO BE PLACED AT EACH END, AND MIDDLE OF CLOSED PORTION OF RUNWAY.

AS-BUILT PLANS

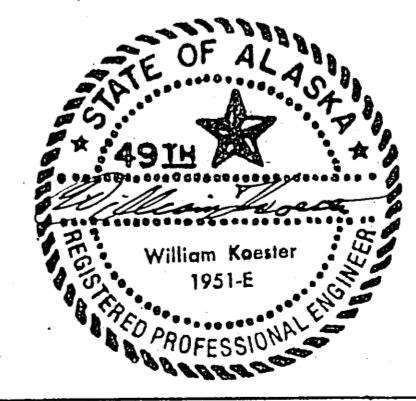

STATE OF ALASKA
DEPARTMENT OF TRANSPORTATION
AND PUBLIC FACILITIES
DIVISION OF AVIATION-DESIGN AND CONSTRUCTION

SKAGWAY AIRPORT
S.C. No. 81-377-01
TYPICAL SECTIONS & R/W
X-MARKINGS

APPROVED	<i>William A. Allison</i> WILLIAM A. ALLISON, P.E.		CHIEF DESIGN ENGINEER
APPROVED	<i>William Koester</i> WILLIAM KOESTER, P.E.		SOUTHEASTERN REGION ENGINEER
SCALE	DESIGNED	DRAWN	SHEET
NONE	BY <i>W.A.A.</i>	SW	AS-BILT. 5 of 7
REVISIONS	CHECKED	DATE	
	<i>W.A.A.</i>	6-3-81	

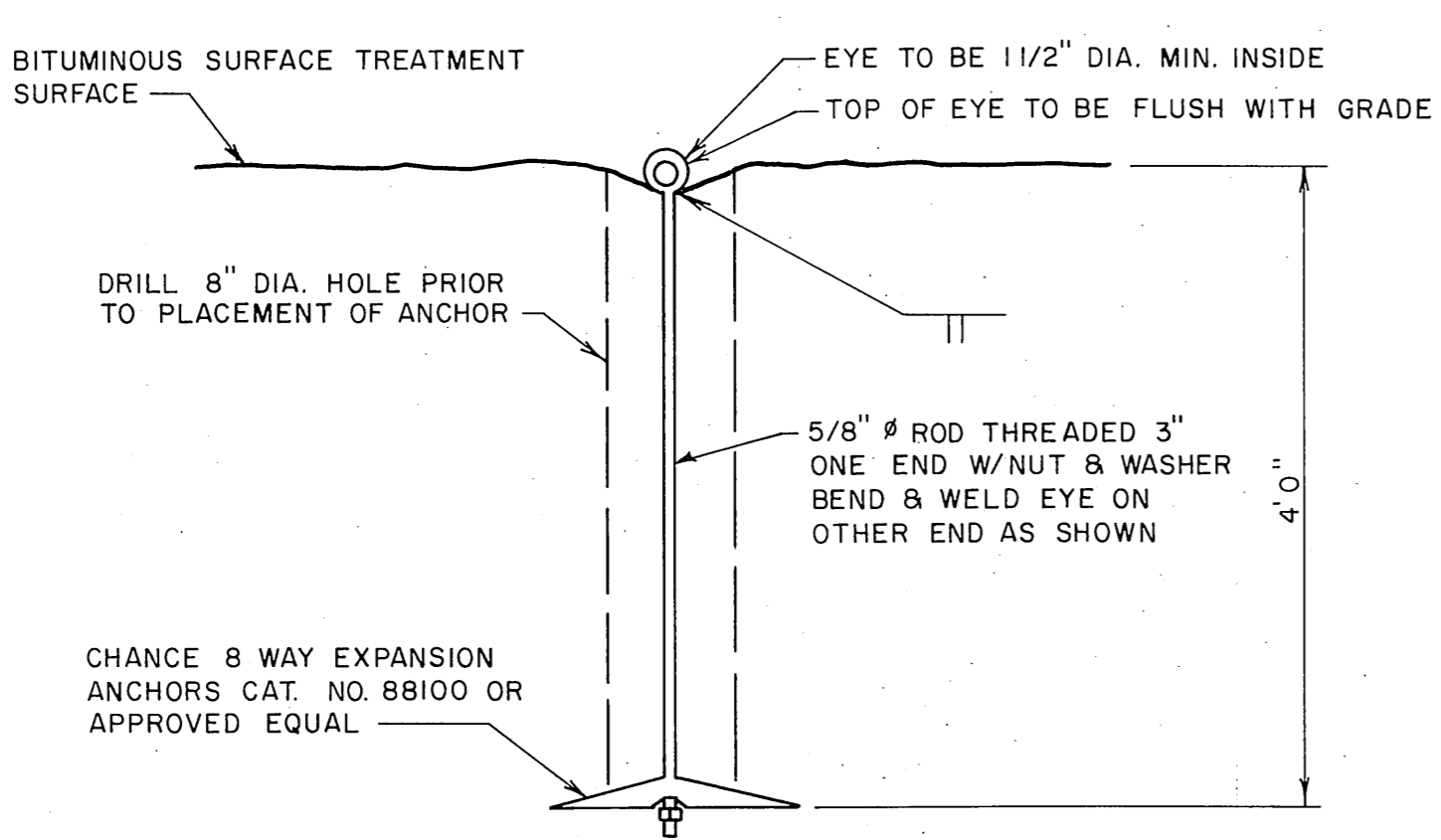
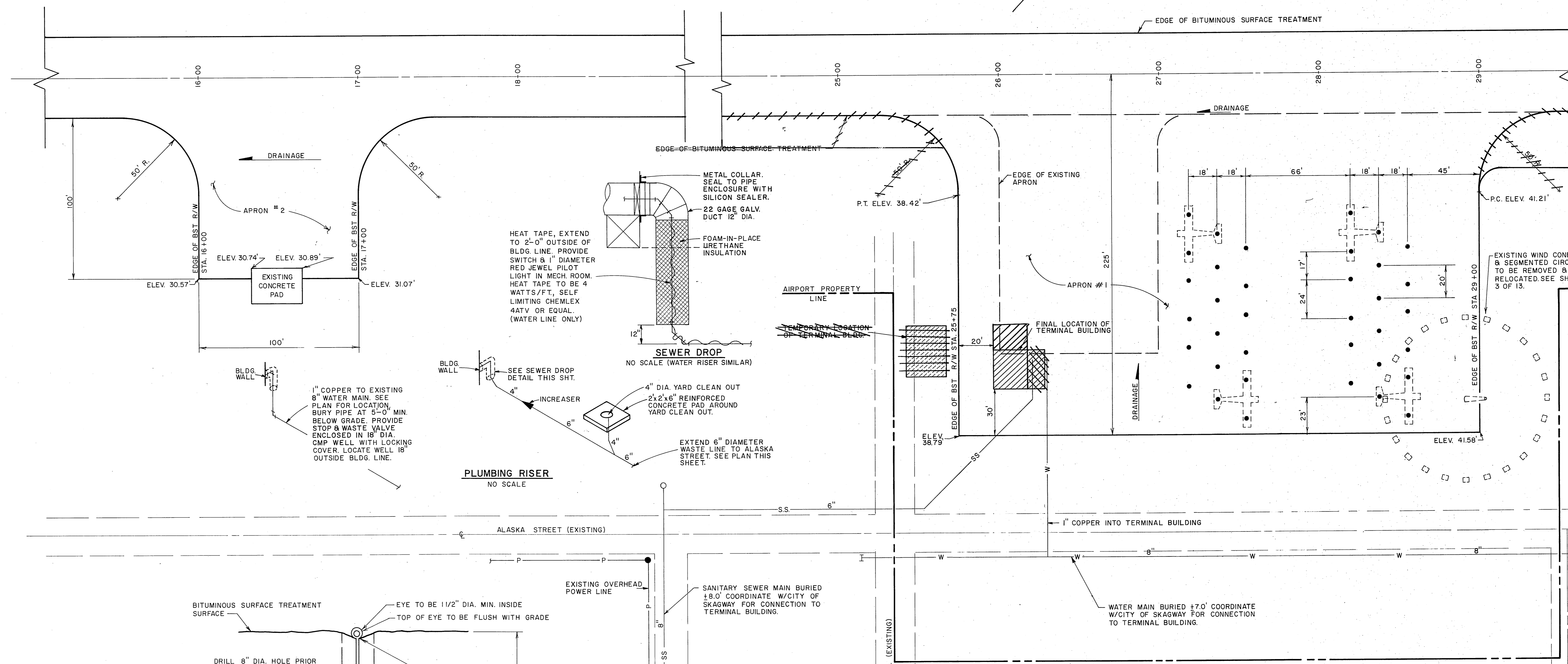
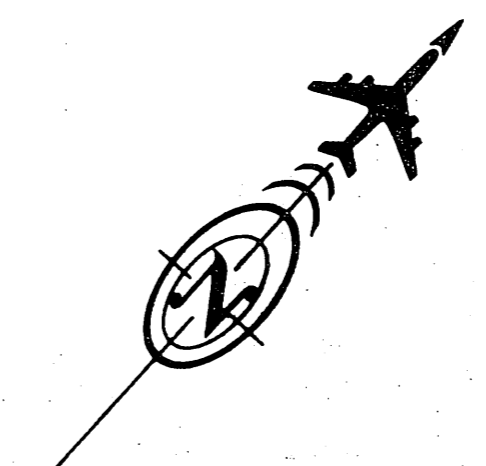

ANCHOR DETAIL
NO SCALE

PLUMBING RISER
NO SCALE

SEWER DROP
NO SCALE (WATER RISER SIMILAR)

NOTE:
1. 36 RODS REQUIRED, ALONG W/36-8 WAY EXPANSION ANCHORS INSTALLED AT THE DIMENSIONS SHOWN ON PLAN.
2. CONTRACTOR MAY BE REQUIRED TO DISMANTLE AND REATTACH RAMP & STAIRS ON TERMINAL BUILDING DURING RELOCATION.



AS-BUILT PLANS

STATE OF ALASKA
DEPARTMENT OF TRANSPORTATION AND PUBLIC FACILITIES
DIVISION OF AVIATION-DESIGN AND CONSTRUCTION

SKAGWAY AIRPORT
S.C. No. 81-377-01
APRON EXPANSION PLAN,
TIE-DOWN RESTRAINTS & DETAILS

APPROVED	<i>William A. Allison</i>	WILLIAM A. ALLISON, P.E.	CHIEF DESIGN ENGINEER
APPROVED	<i>William Koester</i>	WILLIAM KOESTER, P.E.	SOUTHEASTERN REGION ENGINEER
BY	DATE	CHANGE	SCALE
			1" = 30'
REVISIONS			DESIGNED <i>WKA</i> DRAWN <i>SW</i> AS-BUILT 6/20/77 CHECKED <i>WKA</i> DATE 5-3-81 SHEET 6 OF 13

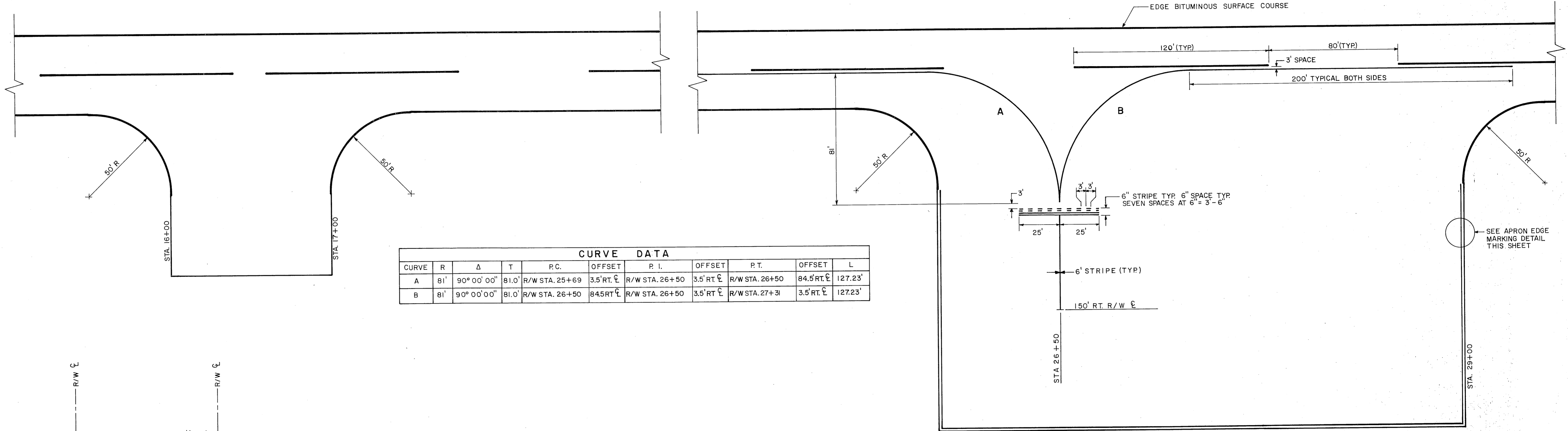
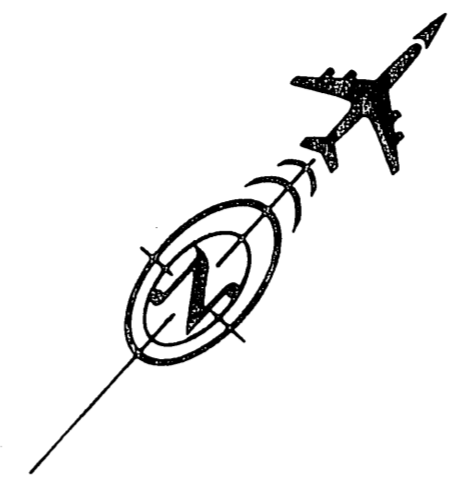
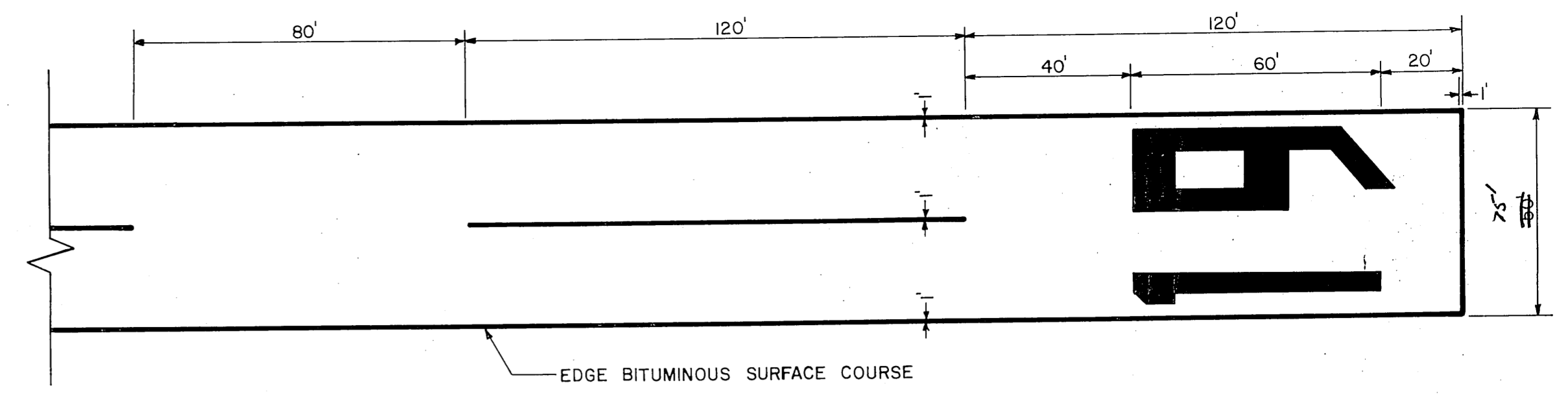
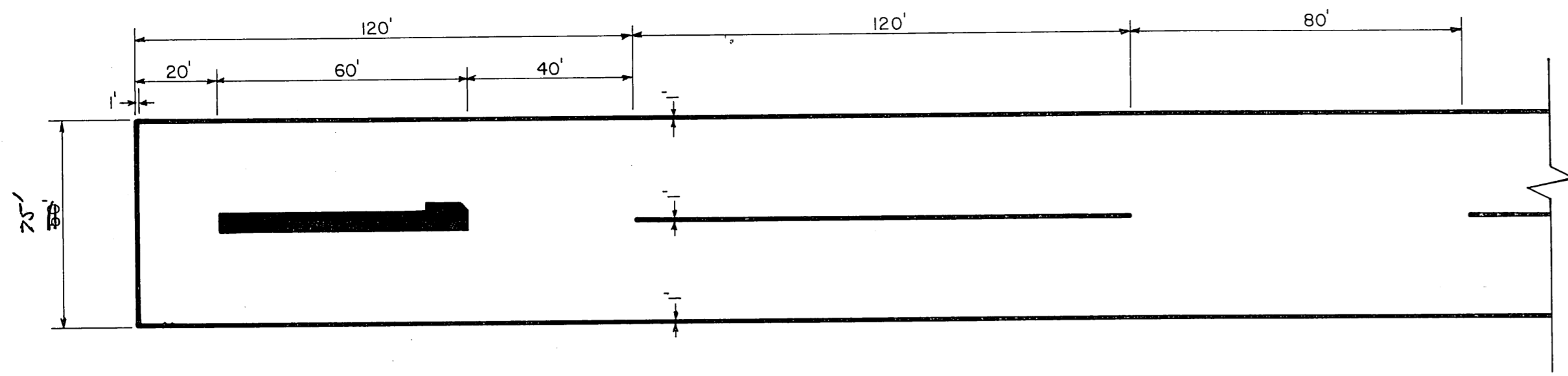

CURVE DATA										
CURVE	R	Δ	T	P.C.	OFFSET	P.I.	OFFSET	P.T.	OFFSET	L
A	81'	90° 00' 00"	81.0'	R/W STA. 25+69	3.5' RT CL	R/W STA. 26+50	3.5' RT CL	R/W STA. 26+50	84.5' RT CL	127.23'
B	81'	90° 00' 00"	81.0'	R/W STA. 26+50	84.5' RT CL	R/W STA. 26+50	3.5' RT CL	R/W STA. 27+31	3.5' RT CL	127.23'

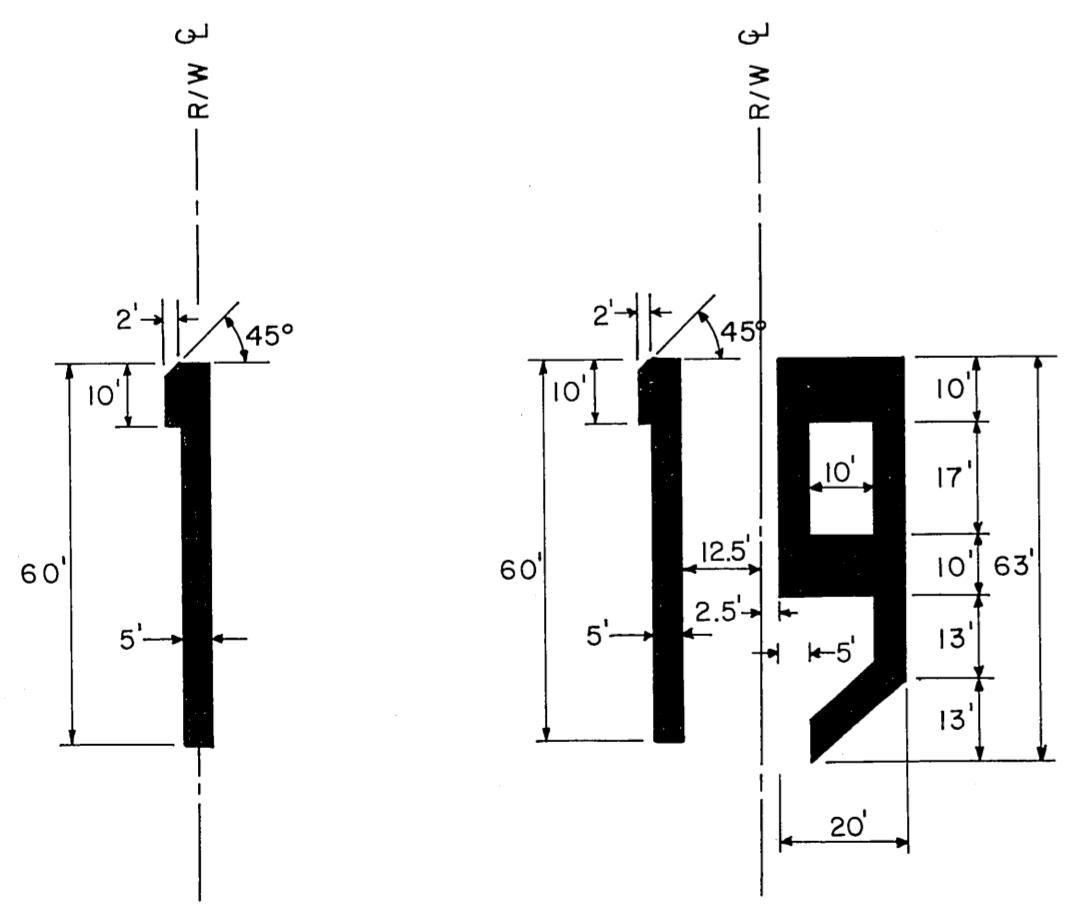

NUMERICAL MARKING DETAIL
SCALE 1" = 30'



APRON EDGE MARKING DETAIL
SCALE 1/8" = 1'

- NOTES**
- LAYOUT RUNWAY CENTERLINE SPACING FROM BOTH ENDS TOWARD CENTER.
 - ALL MARKING SHALL BE ACCOMPLISHED USING AVIATION YELLOW.
 - ALL CURVE RADII ARE MEASURED TO CENTERLINE OF STRIPE.



STATE OF ALASKA
DEPARTMENT OF TRANSPORTATION
AND PUBLIC FACILITIES
DIVISION OF AVIATION-DESIGN AND CONSTRUCTION

SKAGWAY AIRPORT
S.C. No. 81-377-01
AIRPORT MARKING PLAN

APPROVED	<i>William A. Allison</i> WILLIAM A. ALLISON, P.E.	CHIEF DESIGN ENGINEER
APPROVED	<i>William Koester</i> WILLIAM KOESTER, P.E.	SOUTHEASTERN REGION ENGINEER
SCALE	DESIGNED <i>RJR</i>	DRAWN <i>BJ</i>
1" = 30'	CHECKED <i>WKS</i>	DATE <i>6/3/54</i>
REVISIONS		