

CITY	MILES OF INSTALLATION
YAKUTAT	5.0
SKAGWAY	13.04
HAINES	44.09
JUNEAU	42.88 47.22
SITKA	10.25
WRANGELL	10.29
MITKOF	2.53
P.O.W.	27.12
KETCHIKAN	17.28
TOTAL:	172.48

STATE OF ALASKA
DEPARTMENT OF TRANSPORTATION
AND
PUBLIC FACILITIES
SOUTHEASTERN REGION
DESIGN AND CONSTRUCTION DIVISION



S. E. AK. REFLECTIVE
PAVEMENT MARKERS
FOR

YAKUTAT, SKAGWAY, HAINES,
JUNEAU, SITKA, PETERSBURG,
WRANGELL, KETCHIKAN, & PRINCE OF WALES ISLAND

F-000C (2) 70295

-AS BUILT PLANS-

THE MILLER COMPANY
 S. KREUZENSTEIN

6-13-91 to 10-25-91

INDEX OF SHEETS	
SHEET NO.	DESCRIPTION
1	TITLE SHEET
2	INDEX
3	ESTIMATE OF QUANTITIES
4-5	INSTALLATION DETAILS
6	YAKUTAT
7	SKAGWAY
8	HAINES
9-11	JUNEAU
12	SITKA
13	WRANGELL
14	PETERSBURG
15	CRAIG-KLAWOCK
16	KETCHIKAN
17	TRAFFIC CONTROL PLAN

THE FOLLOWING STANDARD DRAWINGS APPLY TO THIS PROJECT:
 A-1, C-01.03, C-02.01, & C-3.01

STATE OF ALASKA
DEPARTMENT OF TRANSPORTATION
AND
PUBLIC FACILITIES
SOUTHEASTERN REGION DESIGN SECTION

APPROVED
J. McNeill Date **9-14-90**
 S.E. Region Design Chief

APPROVED
E. W. Barnell Date **9-14-90**
 Director, S.E. Region Design & Construction

PROJECT NUMBER:	ENGINEER'S STAMP
DATE:	
SHEET 1 OF 17	

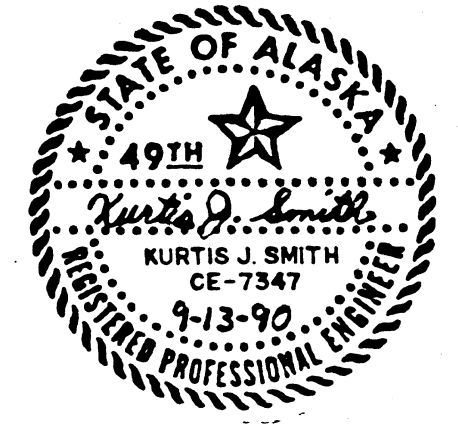
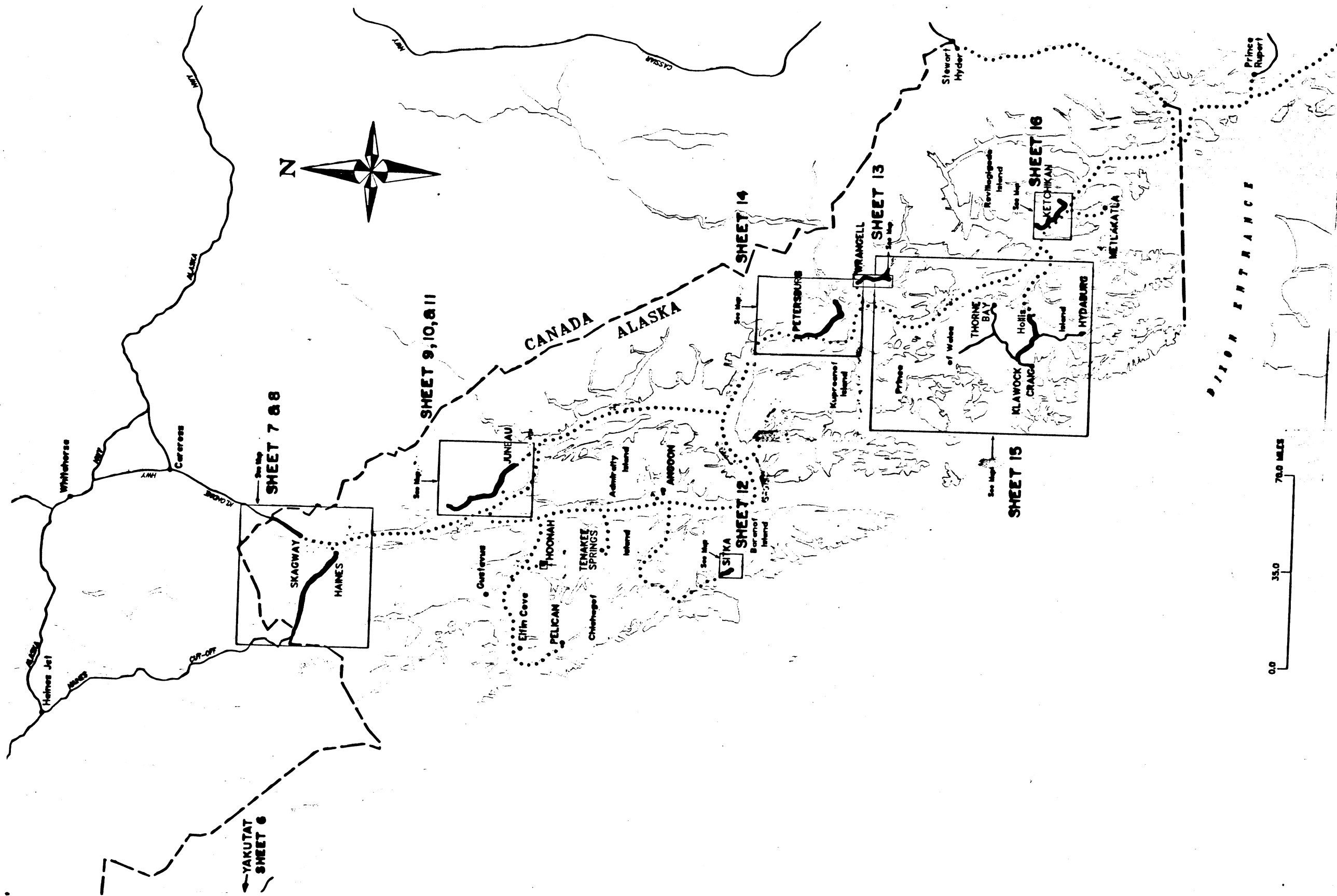

BY:	DATE:	DESCRIPTION OF CHANGE:

RECORD OF REVISIONS

STATE OF ALASKA
 DEPARTMENT OF TRANSPORTATION
 AND PUBLIC FACILITIES
 SOUTHEAST REGION DESIGN & CONSTRUCTION

S.E.AK. REFLECTIVE PAVEMENT MARKERS
 F-000C(2) 70295
 INDEX

NOTE: DO NOT SCALE FROM THESE PLANS—USE DIMENSIONS

DESIGNED BY:	R.P.	SCALE	N.A.
DRAWN BY:		DATE:	
CHECKED BY:	J.A.	SHEET	2 OF 17

ENGINEER'S SEAL

ESTIMATE OF QUANTITIES			
ITEM NO.	ITEM	UNIT	QUANTITY
120(1)	DBE Adjustment	C.S.	All Req'd
640(1)	Mobilization & Demobilization	L.S.	All Req'd
643(1)	Traffic Maintenance	L.S.	All Req'd
644(6)	Engineering Transportation (C.O. # 1)	L.S.	All Req'd
670(8)	Recessed Pavement Markers	Each	16500
670(20)	Removal of Reflective Markers	Each	3000
670(21)	No Passing Grooves	Each	1000
643(2A)	Additional Traffic Maintenance (C.O. # 2)	Each	All Req'd

16,215
2,828
582



NOTE: DO NOT SCALE FROM THESE PLANS—USE DIMENSIONS

NO.	DATE	DESCRIPTION OF CHANGE



RECORD OF REVISIONS

STATE OF ALASKA
DEPARTMENT OF TRANSPORTATION
AND PUBLIC FACILITIES
SOUTHEAST REGION DESIGN & CONSTRUCTION

S.E.A.K. REFLECTIVE PAVEMENT MARKERS
F-000C(2) 70295
ESTIMATE OF QUANTITIES

DESIGNED BY: R. P.	SCALE
DRAWN BY: B. A.	DATE:
CHECKED BY: J. A.	SHEET 3 OF 17

ENGINEER'S SEAL

KEY TO SYMBOLS	
	TWO SIDED YELLOW MARKER
	TWO SIDED MARKER, WHITE FACING TRAFFIC, RED AWAY FROM TRAFFIC

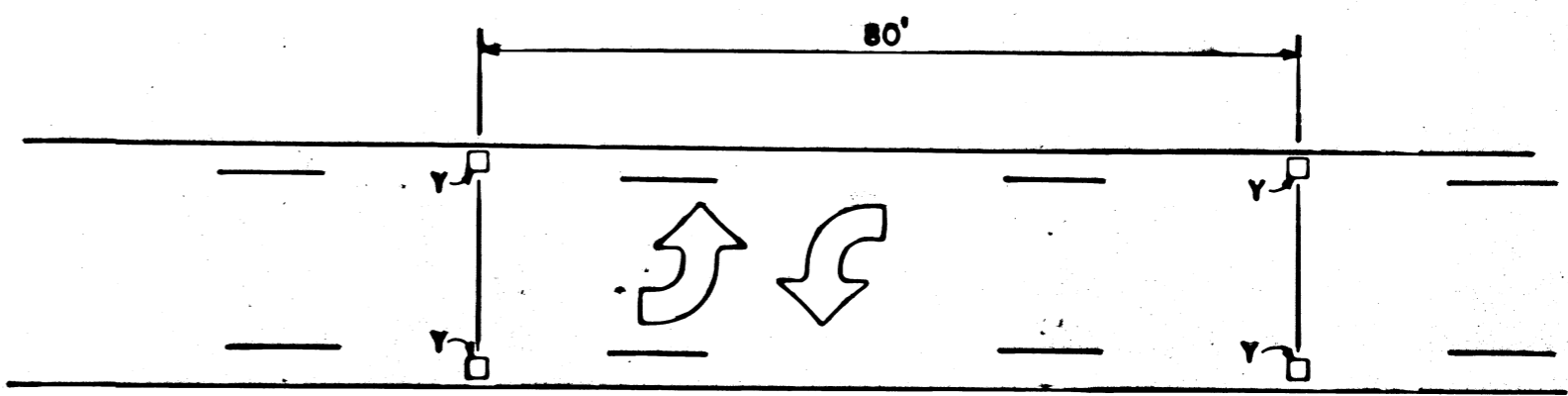
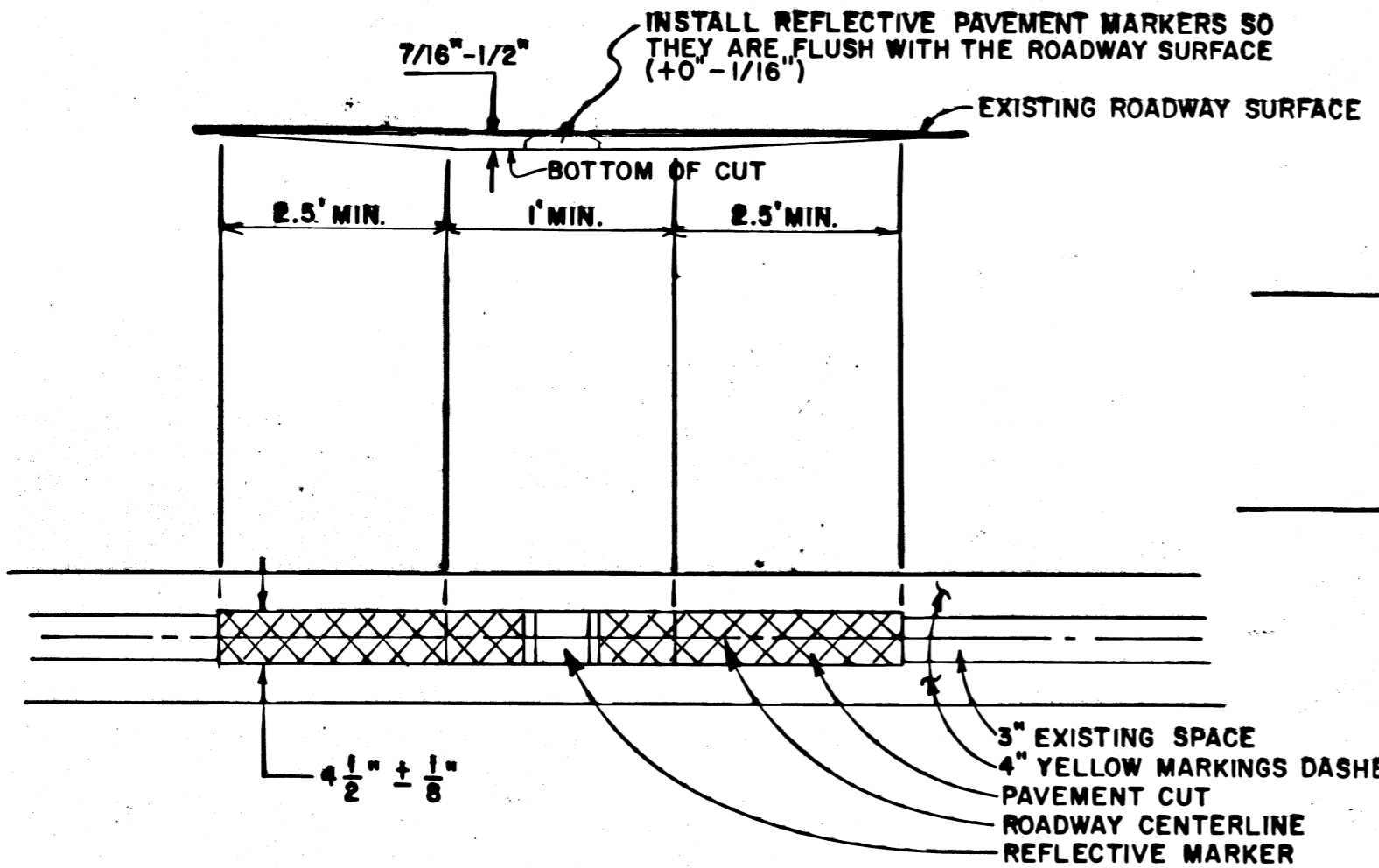

TWO WAY LEFT TURN LANE DETAIL

**PAVEMENT CUT DETAIL AND
TYPICAL MARKER PLACEMENT**
TWO-WAY TRAFFIC
TWO-LANE

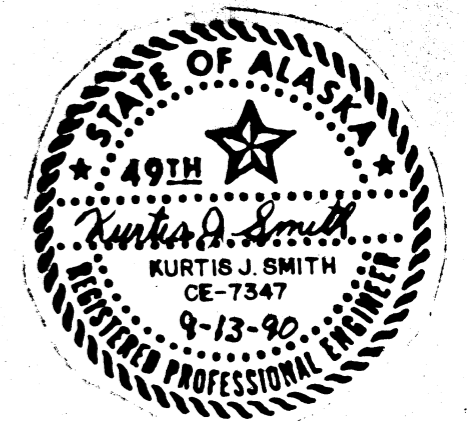

NOTE: DO NOT SCALE FROM THESE PLANS-USE DIMENSIONS

BY:	DATE:	DESCRIPTION OF CHANGE:

RECORD OF REVISIONS

STATE OF ALASKA
DEPARTMENT OF TRANSPORTATION
AND PUBLIC FACILITIES
SOUTHEAST REGION DESIGN & CONSTRUCTION

S.E.AK. REFLECTIVE PAVEMENT MARKERS
F-000C (2) 70295
INSTALLATION DETAILS

DESIGNED BY:	R.P.	SCALE	N.A.
DRAWN BY:	B.A.	DATE:	
CHECKED BY:	J.A.	SHEET	4 OF 17

ENGINEER'S SEAL

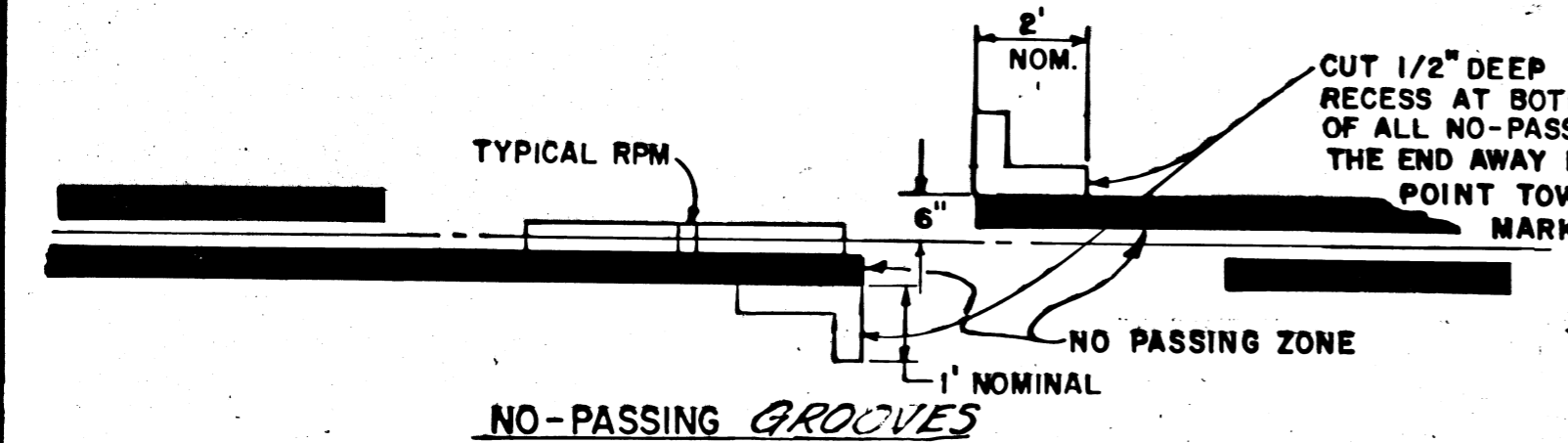
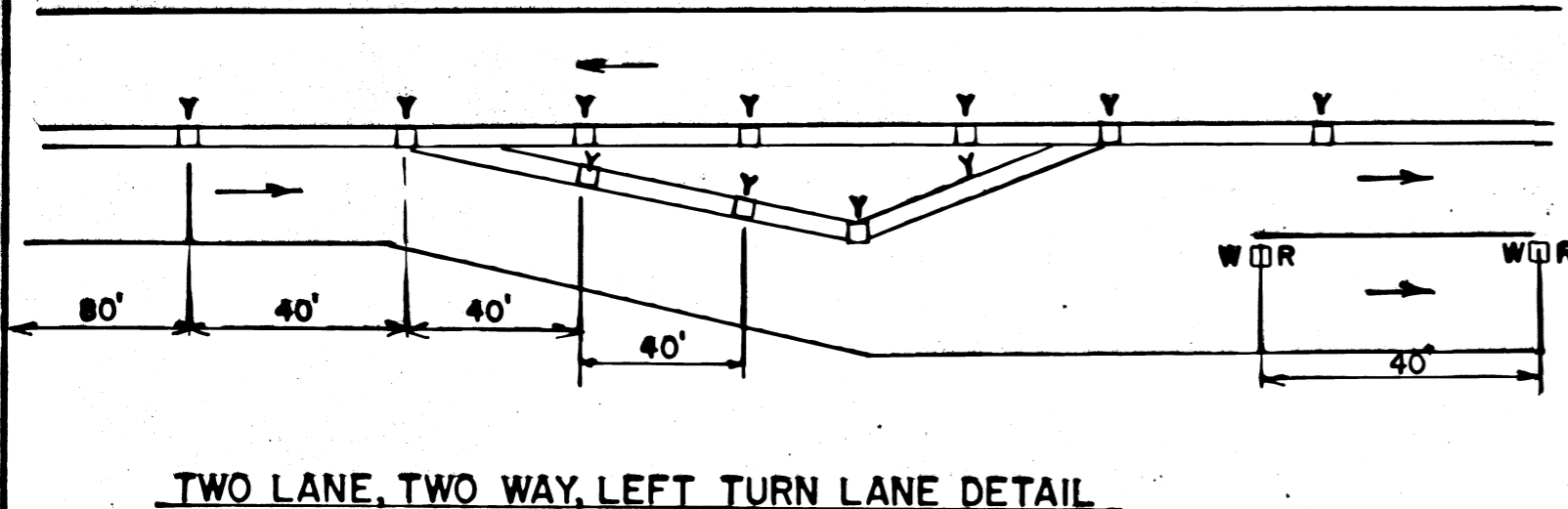
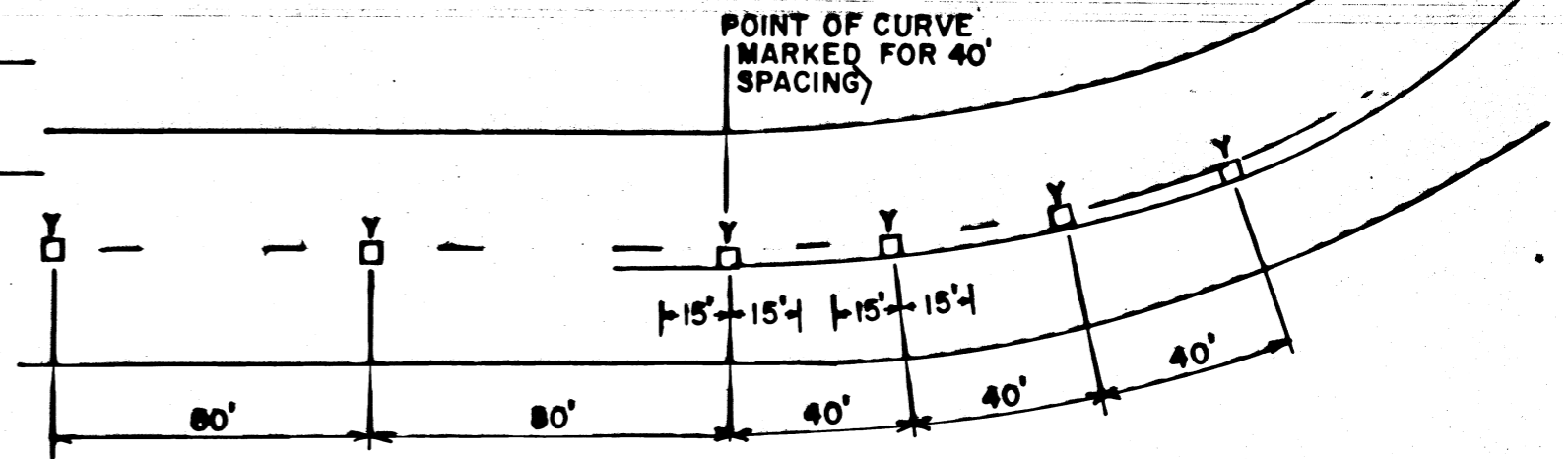
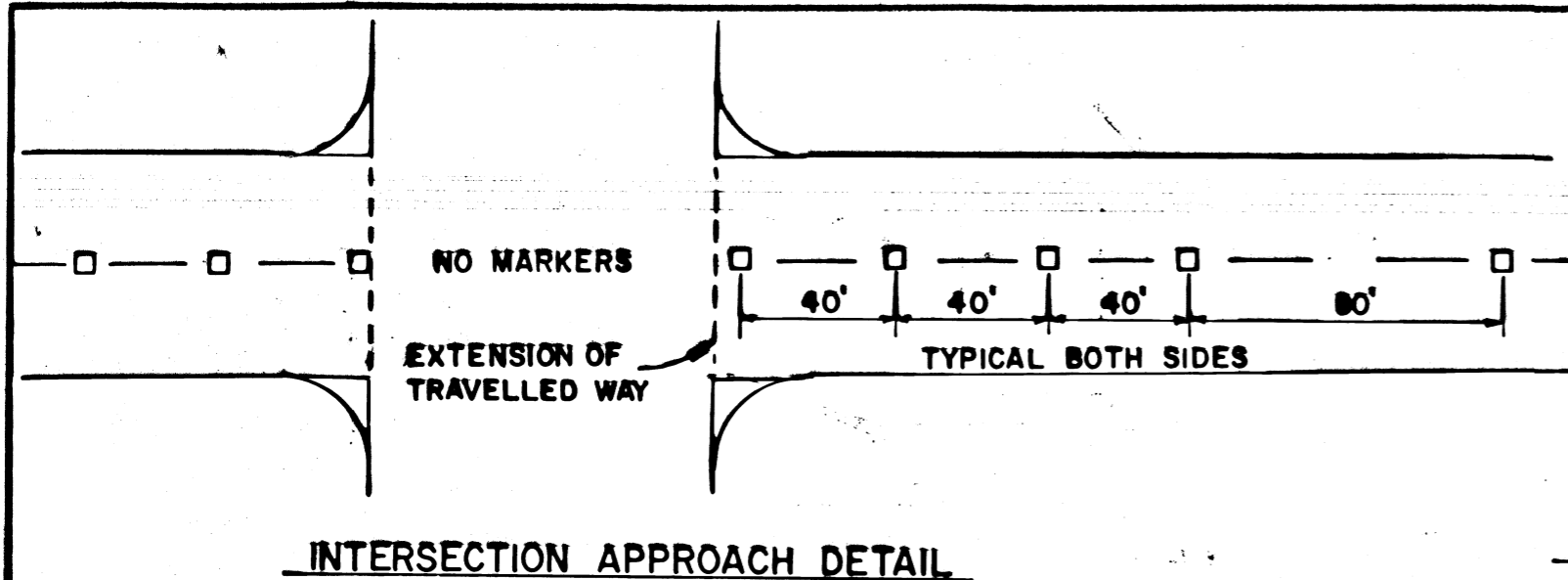

- NOTES:**
1. ALL MILEAGE POINTS ARE BASED ON THE STATE OF ALASKA, DOT/PF COORDINATED DATA SYSTEM (CDS).
 2. RECESSED MARKERS SHALL BE SPACED EVERY 80' EXCEPT ON SHARP CURVES (TO BE DESIGNATED BY DOT/PF) ON WHICH THE SPACING SHALL BE 40'.
 3. RPM QUANTITIES ARE ESTIMATED AND WILL VARY.
 - 3a. NO RPM'S ARE TO BE PLACED ON CONCRETE OR TIMBER BRIDGE DECKS.
 4. RPM'S SHALL NOT BE PLACED IN INTERSECTIONS WITH PUBLIC ROADWAYS. RPM SPACING SHALL START OVER AT THE INTERSECTION BOUNDARY.
 5. ONLY PUBLIC ROADWAYS WILL BE MARKED AS AN INTERSECTION APPROACH.
 6. LOCATIONS OF MARKERS IN SITUATIONS WITH UNUSUAL GEOMETRICS WILL BE DETERMINED BY THE PROJECT ENGINEER.
 7. MARKERS SHALL BE PLACED BETWEEN EXISTING MARKINGS ON SECTIONS WITH DOUBLE YELLOW OR SOLID YELLOW + INTERMITTENT MARKINGS. ON SECTIONS WITH INTERMITTENT MARKINGS, OR WHERE MARKINGS ARE MISSING MARKERS SHALL BE PLACED ON CENTERLINE OR THE LANE DIVIDING LINE.



NOTE: DO NOT SCALE FROM THESE PLANS—USE DIMENSIONS

BY:	DATE:	DESCRIPTION OF CHANGE:

RECORD OF REVISIONS

STATE OF ALASKA
 DEPARTMENT OF TRANSPORTATION
 AND PUBLIC FACILITIES
 SOUTHEAST REGION DESIGN & CONSTRUCTION

S.E.AK. REFLECTIVE PAVEMENT MARKERS
 F-000C (2) 70295
 INSTALLATION DETAILS

DESIGNED BY:	R.P.	SCALE	N.A.
DRAWN BY:	B.A.	DATE:	
CHECKED BY:	J.A.	SHEET	5 OF 17

ENGINEER'S SEAL

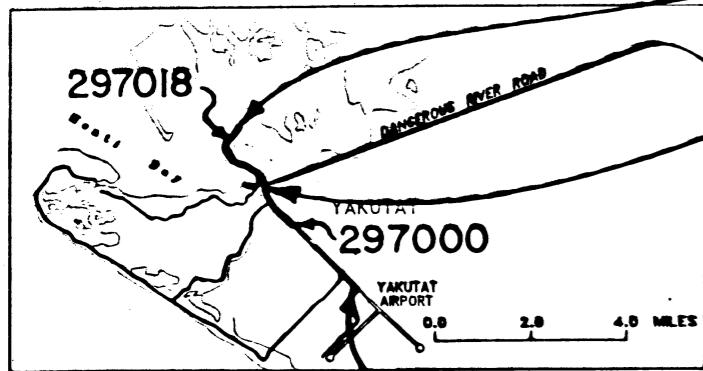

END RPM'S AT END OF ROAD, CDS 1.57

END RPM'S AT JCT. WITH DANGEROUS RIVER ROAD, CDS 3.560 =
 BEGIN RPM'S AT JCT. WITH DANGEROUS RIVER ROAD, CDS 0.00

BEGIN MARKERS AT CDS 0.13

Road	CDS Route	CDS Begin	CDS End	Miles	Markers		No Pass Grooves
					Yellow	White	
Yakutat/Alsek Road	297000	0.13	3.56	3.43	270	0	11
Boat Harbor Road	297018	0.00	1.57	1.57	165 171	0	7



YAKUTAT

NOTE: DO NOT SCALE FROM THESE PLANS—USE DIMENSIONS

BY:	DATE:	DESCRIPTION OF CHANGE:

RECORD OF REVISIONS

STATE OF ALASKA
 DEPARTMENT OF TRANSPORTATION
 AND PUBLIC FACILITIES
 SOUTHEAST REGION DESIGN & CONSTRUCTION

SE. AK. REFLECTIVE PAVEMENT MARKERS
 F-000C(2) 70295
 YAKUTAT/ALSEK RD., BOAT HARBOR RD.

DESIGNED BY: R.P.	SCALE N.A.
DRAWN BY:	DATE:
CHECKED BY: J.A.	SHEET 6 OF 17

ENGINEER'S SEAL

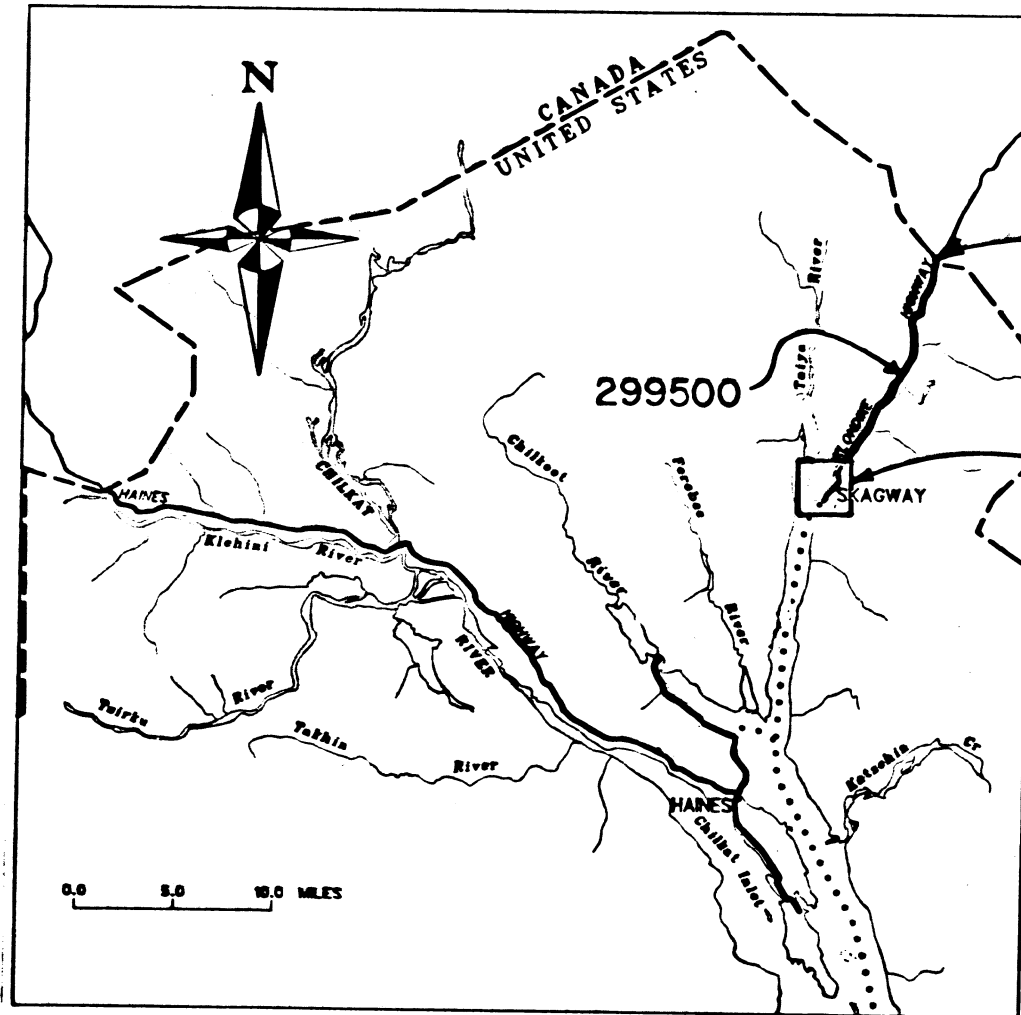

END RPM'S AT BORDER
CDS 14.73

SEE ENLARGEMENT

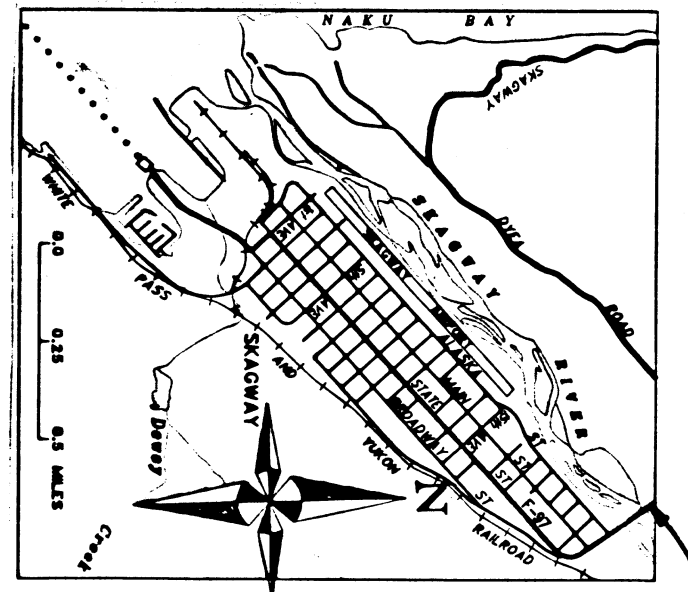

BEGIN RPM'S AT END OF BRIDGE
CDS 1.69

Road	CDS Route	CDS Begin	CDS End	Miles	Markers		No Pass Grooves
					Yellow	White	
Klondike Highway	299500	1.69	14.73	13.04	1549 1413	0	41

SKAGWAY



NOTE: DO NOT SCALE FROM THESE PLANS—USE DIMENSIONS

BY:	DATE:	DESCRIPTION OF CHANGE:

RECORD OF REVISIONS

STATE OF ALASKA
DEPARTMENT OF TRANSPORTATION
AND PUBLIC FACILITIES
SOUTHEAST REGION DESIGN & CONSTRUCTION

S.E. AK. REFLECTIVE PAVEMENT MARKERS
F-000C(2) 70295
KLONDIKE HIGHWAY

DESIGNED BY:	R.P.	SCALE	N.A.
DRAWN BY:		DATE:	
CHECKED BY:	J.A.	SHEET	7 OF 17

ENGINEER'S S

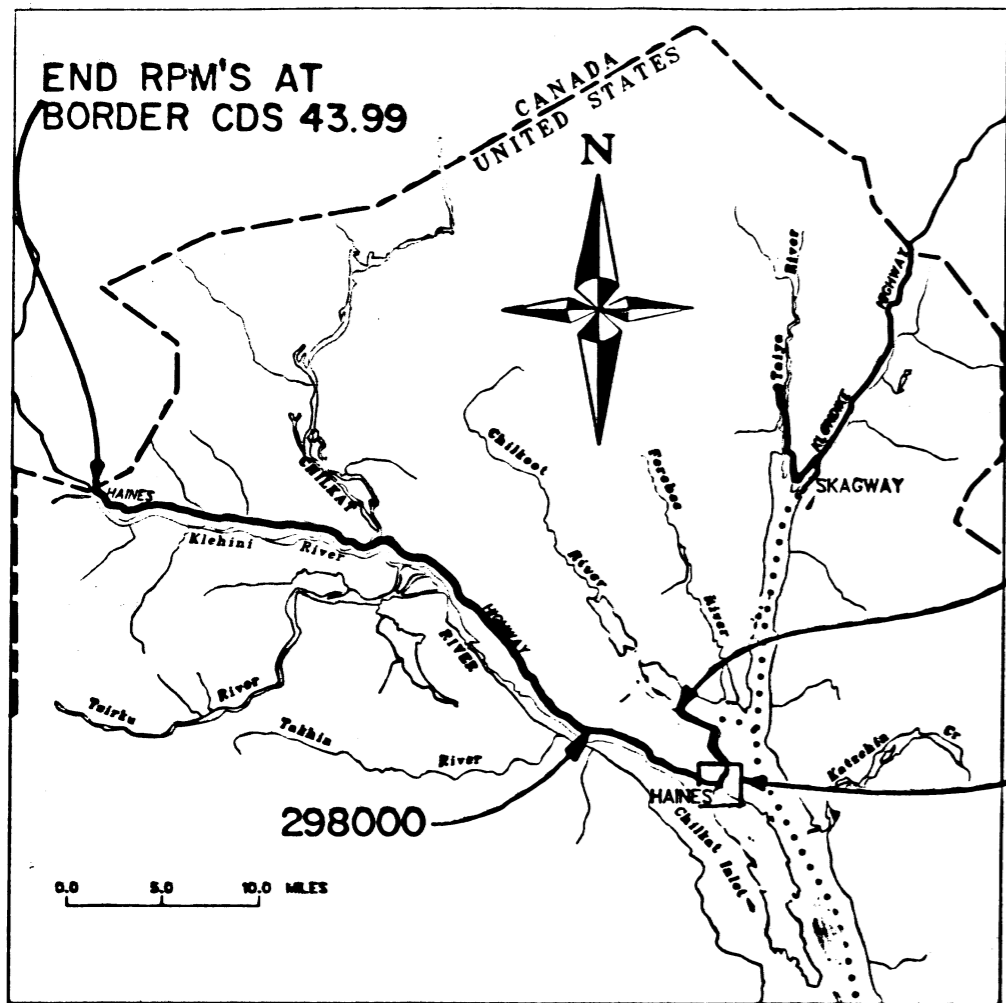

END RPM'S AT
BORDER CDS 43.99

BEGIN RPM'S AT
FERRY TERMINAL
CDS 0.00 HAINES HWY.

SEE ENLARGEMENT

298000

0.0 5.0 10.0 MILES

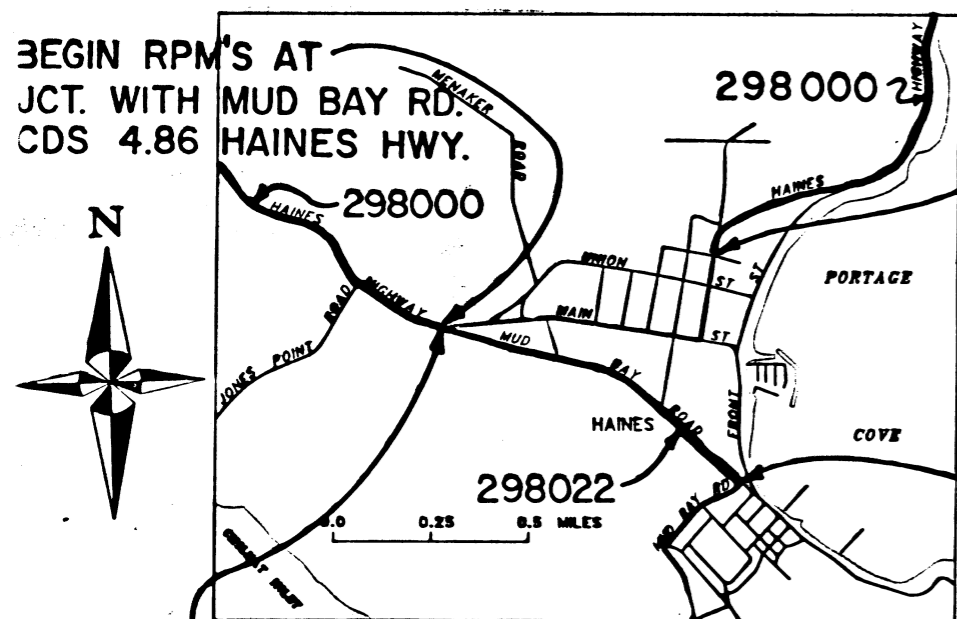

BEGIN RPM'S AT
JCT. WITH MUD BAY RD.
CDS 4.86 HAINES HWY.

END RPM'S AT
VIEW ST., CDS 3.97
HAINES HWY.

END RPM'S AT JCT. WITH
MUD BAY ROAD TURN,
CDS 0.99

BEGIN RPM'S AT JCT. WITH
HAINES HIGHWAY, CDS 0.00
MUD BAY ROAD

298000 2

298022

0.0 0.25 0.5 MILES

Road	CDS Route	CDS Begin	CDS End	Miles	Markers		No Pass Grooves
					Yellow	White	
Haines Highway	298000	0.00	3.97	3.97	454	0	18
		4.86	43.99	39.13	393	0	110
Mud Bay Road	298022	0.00	0.99	0.99	3873	0	4
					3354	0	

HAINES

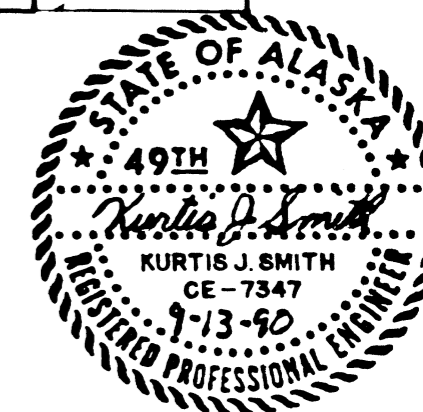

DATE:	DESCRIPTION OF CHANGE:

STATE OF ALASKA
DEPARTMENT OF TRANSPORTATION
AND PUBLIC FACILITIES
SOUTHEAST REGION DESIGN & CONSTRUCTION

S.E. AK. REFLECTIVE PAVEMENT MARKERS
F-000C(2) 70295
HAINES HIGHWAY/MUD BAY ROAD

NOTE: DO NOT SCALE FROM THESE PLANS—USE DIMENSIONS

DESIGNED BY:	R.P.	SCALE	N.A.
DRAWN BY:		DATE:	
CHECKED BY:	J.A.	SHEET	8 OF 17

ENGINEER'S SEAL

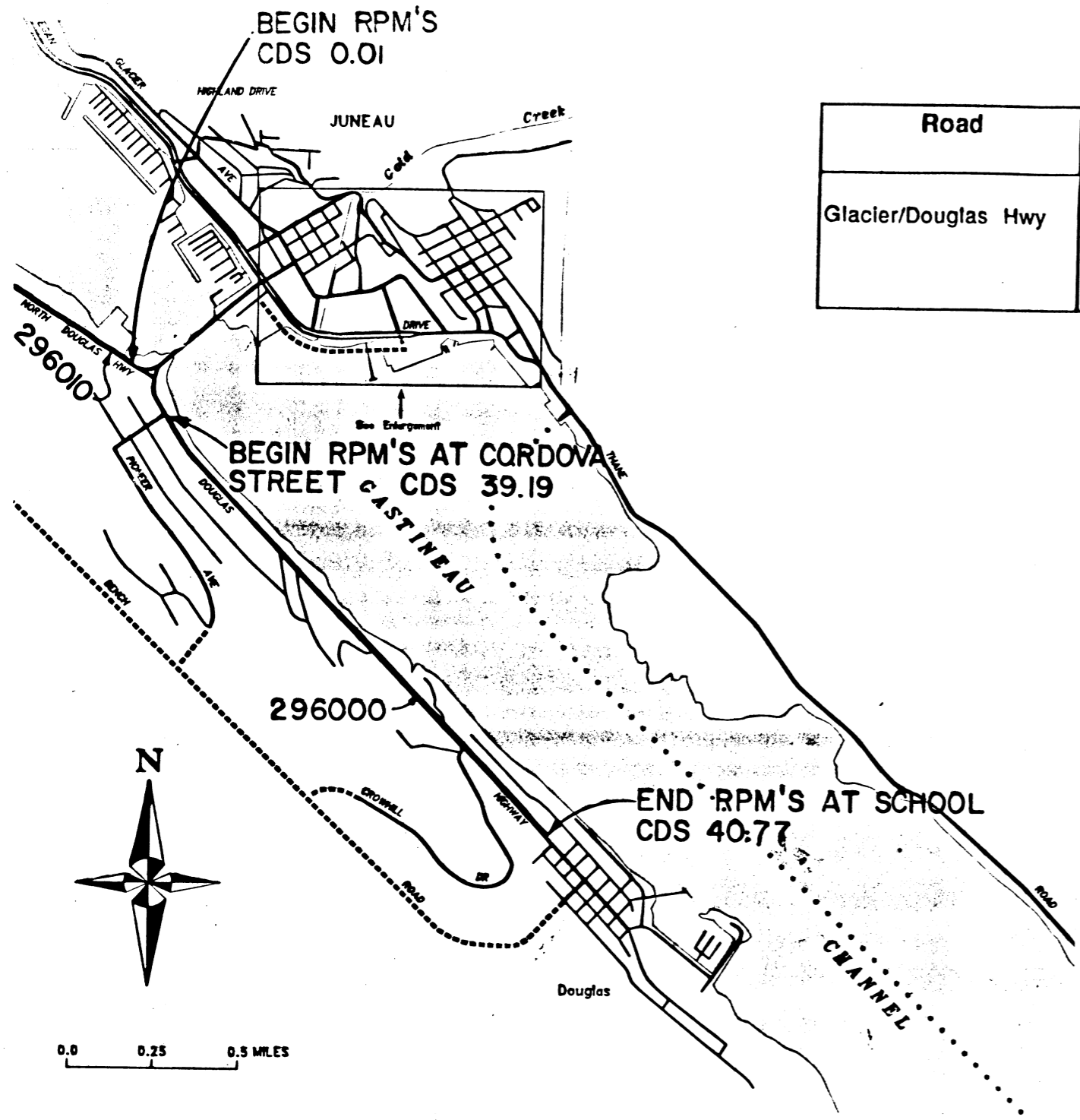

Road	CDS Route	CDS Begin	CDS End	Miles	Markers		No Pass Grooves
					Yellow	White	
Glacier/Douglas Hwy	296000	39.19	40.77	1.58	139 132	0	15



JUNEAU

NOTE: DO NOT SCALE FROM THESE PLANS-USE DIMENSIONS

BY:	DATE:	DESCRIPTION OF CHANGE:

RECORD OF REVISIONS

STATE OF ALASKA
DEPARTMENT OF TRANSPORTATION
AND PUBLIC FACILITIES
SOUTHEAST REGION DESIGN & CONSTRUCTION

S.E.AK. REFLECTIVE PAVEMENT MARKERS
F-000C(2) 70295
N. DOUGLAS ROAD

DESIGNED BY: R.P.	SCALE N.A.
DRAWN BY: /	DATE:
CHECKED BY: J.A.	SHEET 9 OF 17

ENGINEER'S SEAL

END OF ROAD
CDS 0.00

0.5 1.0 MILES

Marker Removal	Road	CDS Route	CDS Begin	CDS End	Miles	Markers		No Pass Grooves
						Yellow	White	
	Lemon Road	296021	0 3.18	1.44 3.47	1.44 0.29	130 148	20 20	7
73	Glacier/Douglas Hwy	296000	7.55 24.43 29.53	21.68 29.24 29.95	14.13 4.81 0.42	1375 1583 541	0 600 27	46 9 4
	N. Douglas Road	296010	0.01 9.47	6.00 11.27	5.99 1.80	593 527 370	0 0	34 15
	Glacier Spur Road	296028-51	0.00	1.47	1.47	94	0	3

END RPM'S AT EXISTING RPM'S, CDS 29.24

BEGIN RPM'S AT BEGIN PAVEMENT, CDS 7.55

END RPM'S AT JCT. WITH PT STEVENS ROAD, CDS 21.68
BEGIN RPM'S AT INDIAN PT PARK ROAD, CDS 24.43

END RPM'S AT END OF ROAD CDS 11.27

BEGIN CDS 0.00
END CDS 1.44

BEGIN CDS 3.18
END CDS 3.47

BEGIN CDS 9.47
END RPM'S CDS 6.00 (SEE SHT. 9 FOR BEGINNING)

BEGIN RPM'S AT EXIST. RPM'S, CDS 29.53
END RPM'S AT EXISTING DIVIDED RAISED PAVEMENT MARKERS, HIGHWAY CDS 29.95-30.15

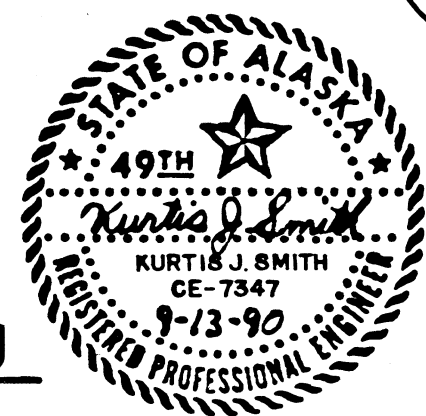
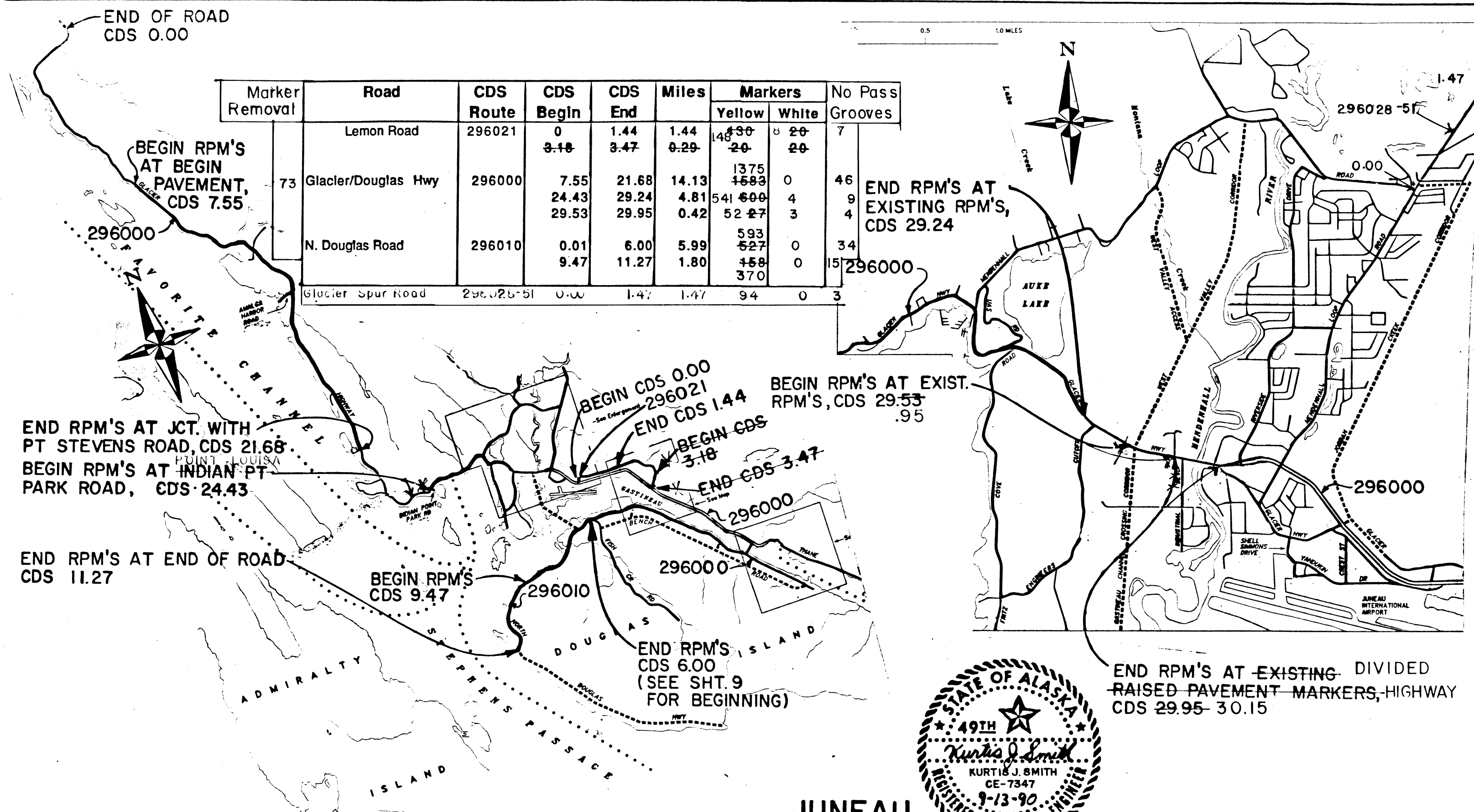

JUNEAU

NOTE: DO NOT SCALE FROM THESE PLANS-USE DIMENSIONS

NO.	DATE	DESCRIPTION OF CHANGE

RECORD OF REVISIONS

STATE OF ALASKA
DEPARTMENT OF TRANSPORTATION
AND PUBLIC FACILITIES
SOUTHEAST REGION DESIGN & CONSTRUCTION

S.E.AK. REFLECTIVE PAVEMENT MARKERS
F-000C(2) 70295
GLACIER/DOUGLAS HIGHWAY, LEMON ROAD

DESIGNED BY: R.P.	SCALE N.A.
DRAWN BY:	DATE:
CHECKED BY: J.A.	SHEET 10 OF 17

ENGINEER'S SEAL

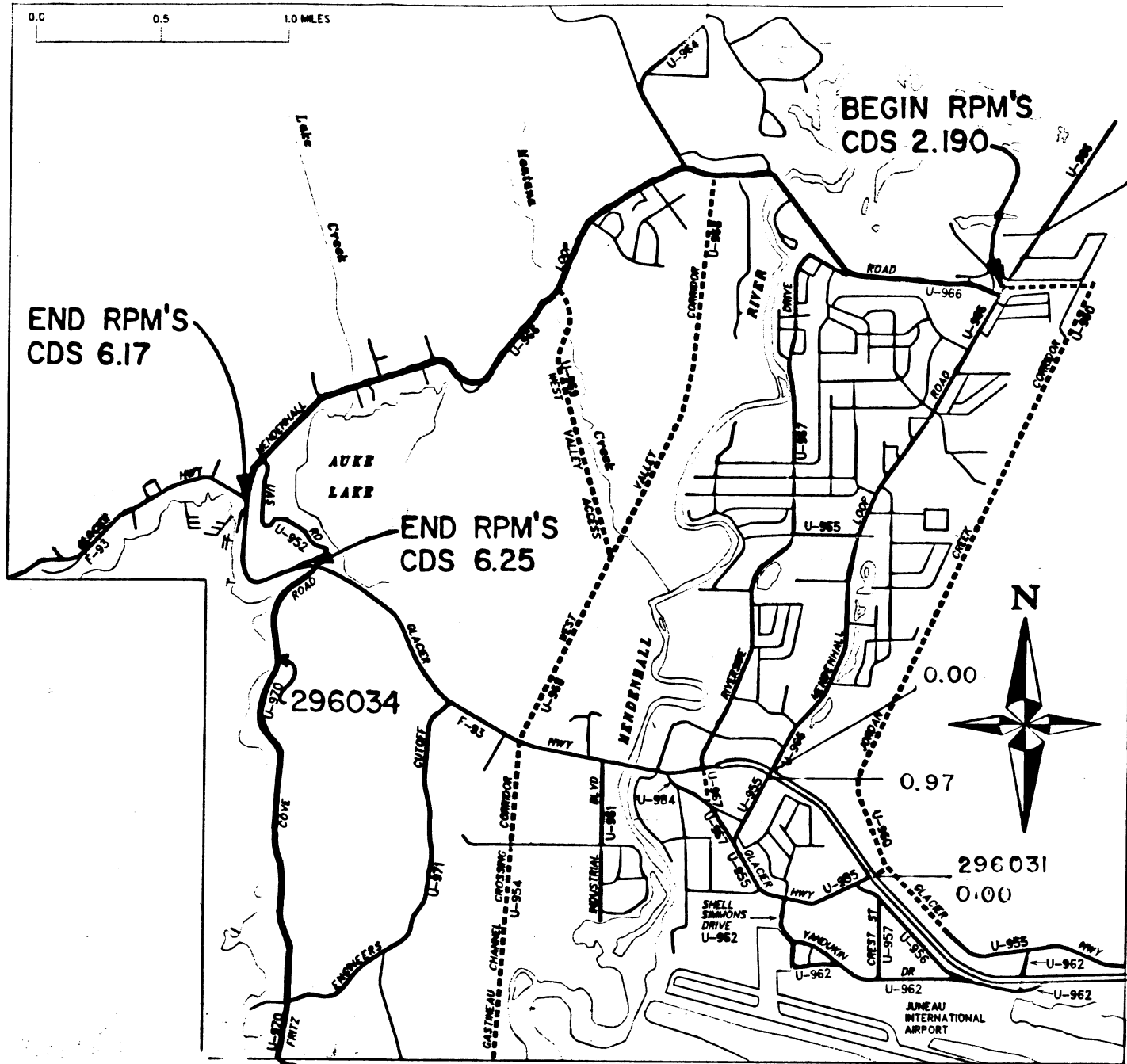

Road	CDS Route	CDS Begin	CDS End	Miles	Markers		No Passing Grooves
					Yellow	White	
Fritz Cove Road	296034	3.72	6.25	2.53	242 333	0	7
Mendenhall Loop Road	296028	2.19	6.17	3.98	401 480	0	17
Mendenhall Loop Rd.	296028	0.00	2.19	2.19	279	47	0
Airport Loop Road	296031	0.00	0.97	0.97	1	41	0

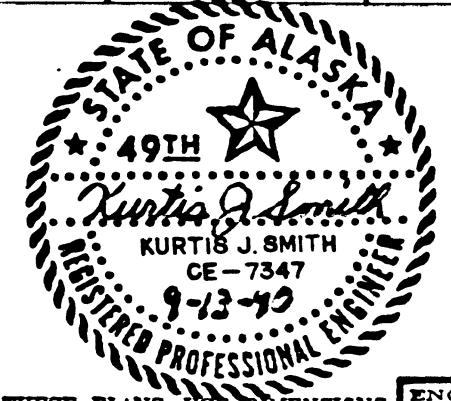

JUNEAU

NOTE: DO NOT SCALE FROM THESE PLANS—USE DIMENSIONS

DATE	DESCRIPTION OF CHANGE

RECORD OF REVISIONS

STATE OF ALASKA
DEPARTMENT OF TRANSPORTATION
AND PUBLIC FACILITIES
SOUTHEAST REGION DESIGN & CONSTRUCTION

S.E.AK. REFLECTIVE PAVEMENT MARKERS
F-000C(2) 70295
MENDENHALL LOOP RD/FRITZ COVE RD.

DESIGNED BY:	R.P.	SCALE	N.A.
DRAWN BY:		DATE:	
CHECKED BY:	J.A.	SHEET	11 OF 17

ENGINEER'S SEAL

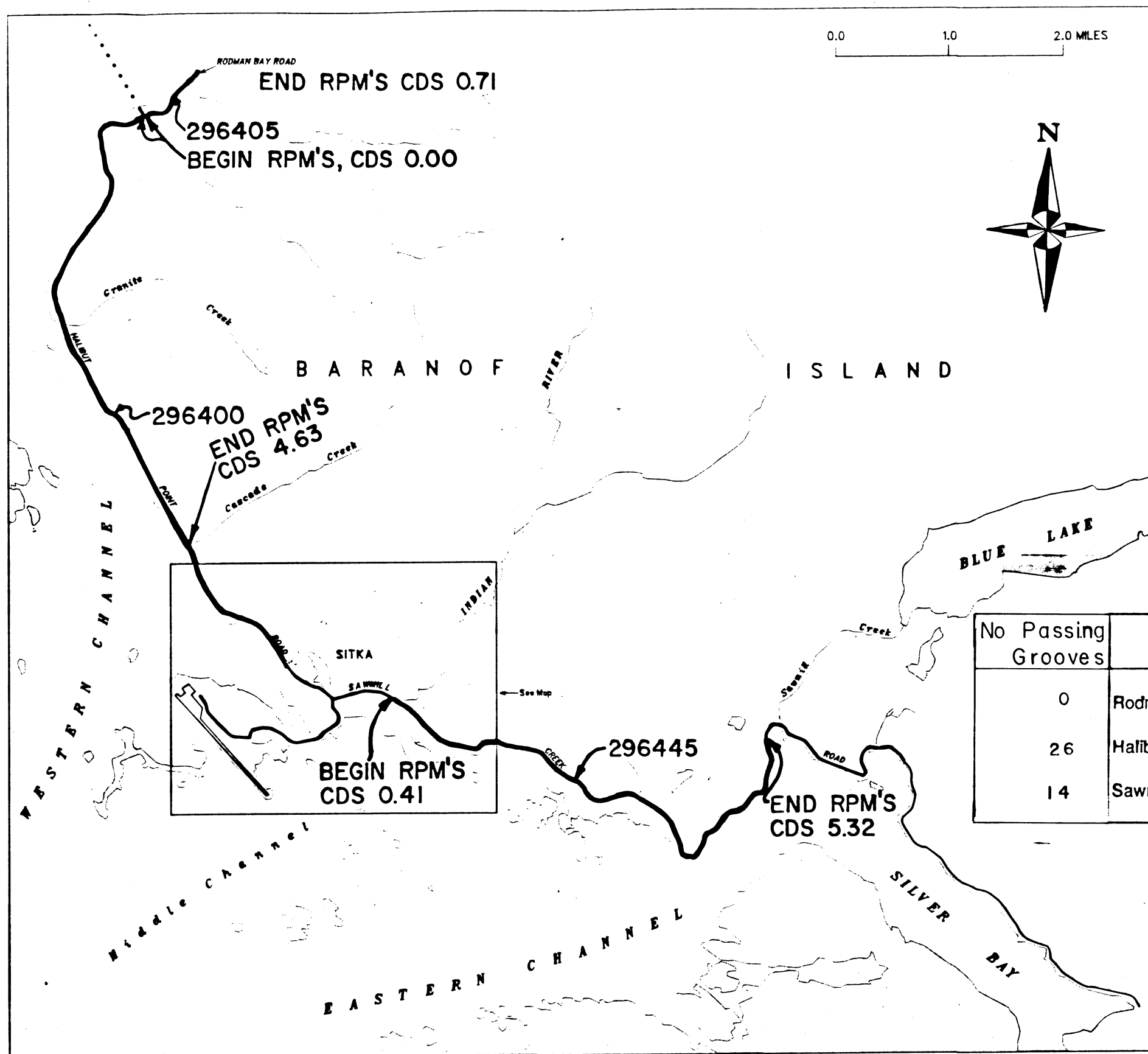

No Passing Grooves	Road	CDS Route	CDS Begin	CDS End	Miles	Markers		Removal of Markers
						Yellow	White	
0	Rodman Bay Road	296405	0.00	0.71	0.71	100 -74	0	100
26	Halibut Point Road	296400	0.00	4.63	4.63	185-373	0	560 -600
14	Sawmill Creek Road	296445	0.41	5.32	4.91	524-529	0	814 -620

SITKA

NOTE: DO NOT SCALE FROM THESE PLANS—USE DIMENSIONS

NO.	DATE	DESCRIPTION OF CHANGE

RECORD OF REVISIONS

STATE OF ALASKA
DEPARTMENT OF TRANSPORTATION
AND PUBLIC FACILITIES
SOUTHEAST REGION DESIGN & CONSTRUCTION

S.E. AK. REFLECTIVE PAVEMENT MARKERS
F-000C(2) 70295
RODMAN BAY RD./HALIBUT PT. RD./SAWMILL CREEK RD.

DESIGNED BY: R.P.	SCALE N.A.
DRAWN BY:	DATE:
CHECKED BY: J.A.	SHEET 12 OF 17

ENGINEER'S SEAL

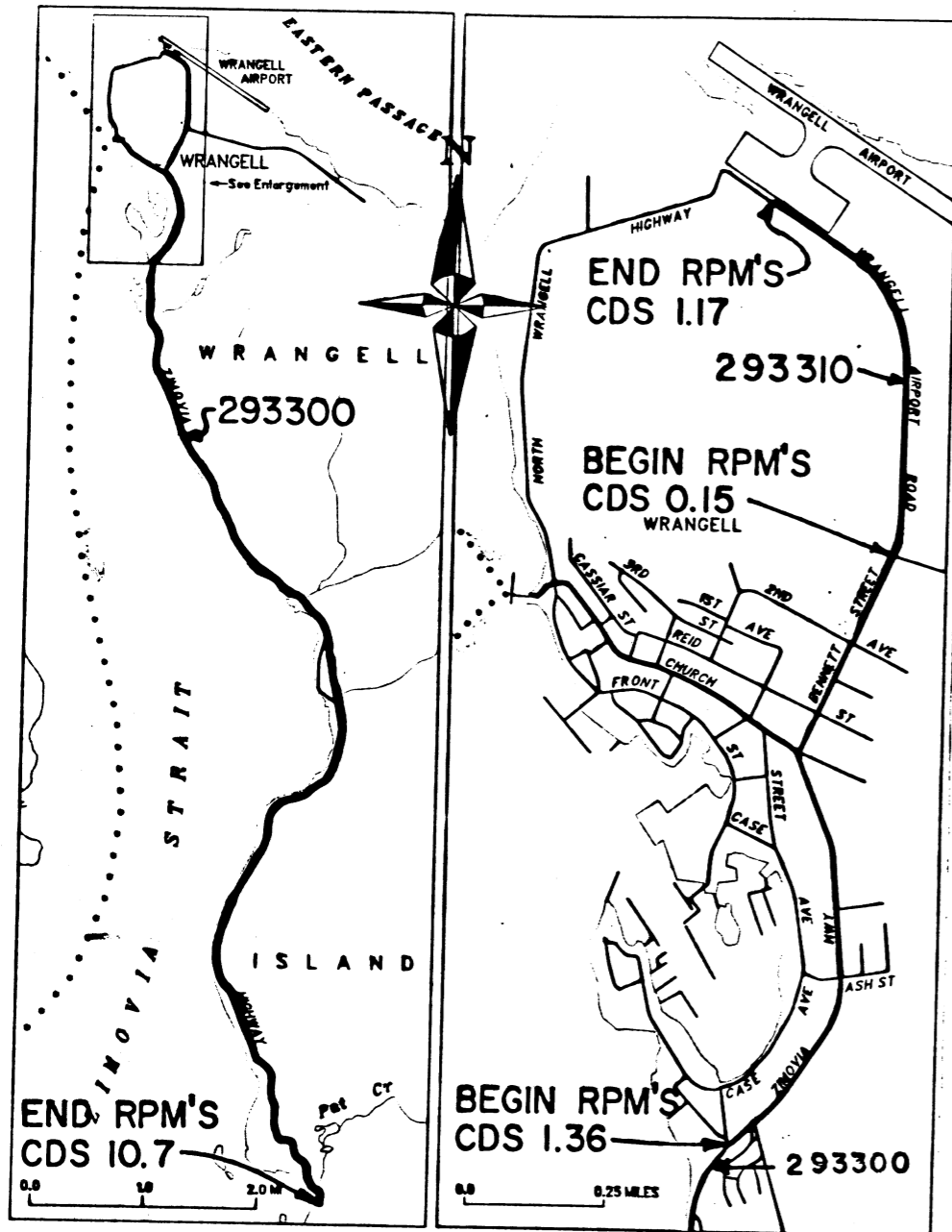

Road	CDS Route	CDS Begin	CDS End	Miles	Markers		No Passing Grooves
					Yellow	White	
Zimovia Highway	293300	1.36	10.70	9.34	831 760	0	31
Wrangell Airport Road	293310	0.22	1.17	0.95	88 69	0	11

WRANGELL



NOTE: DO NOT SCALE FROM THESE PLANS—USE DIMENSIONS

ENGINEER'S SEAL

DATE	DESCRIPTION OF CHANGE

RECORD OF REVISIONS

STATE OF ALASKA
DEPARTMENT OF TRANSPORTATION
AND PUBLIC FACILITIES
SOUTHEAST REGION DESIGN & CONSTRUCTION

S.E. AK. REFLECTIVE PAVEMENT MARKERS
F-000C(2) 70295
WRANGELL HWY./WRANGELL AIRPORT ROAD

DESIGNED BY: R.P.	SCALE N.A.
DRAWN BY:	DATE:
CHECKED BY: J.A.	SHEET 13 OF 17

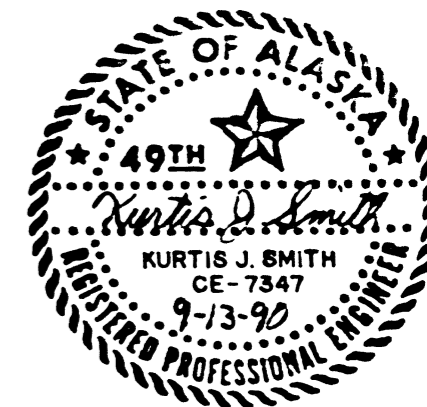
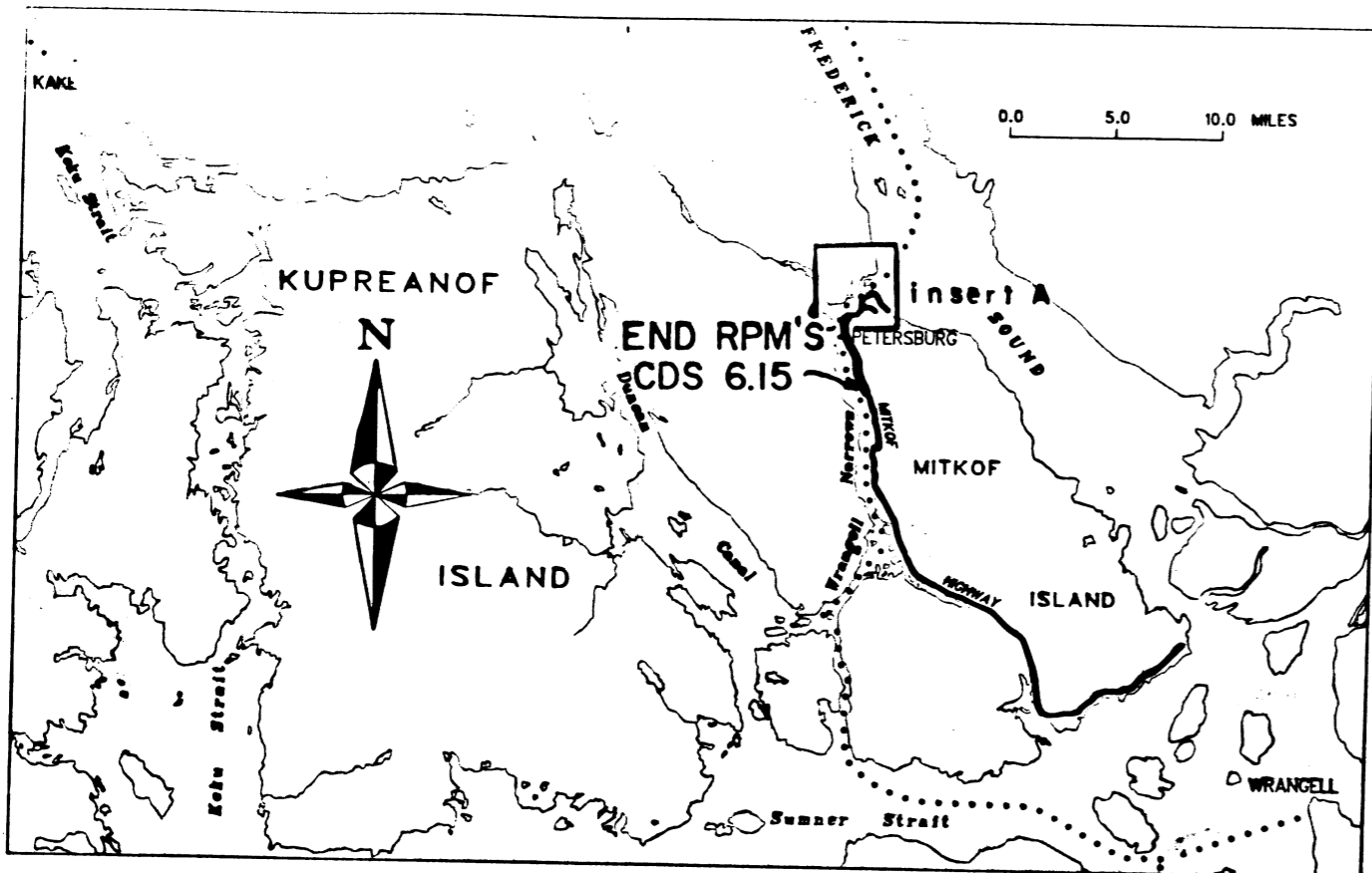

INSERT A

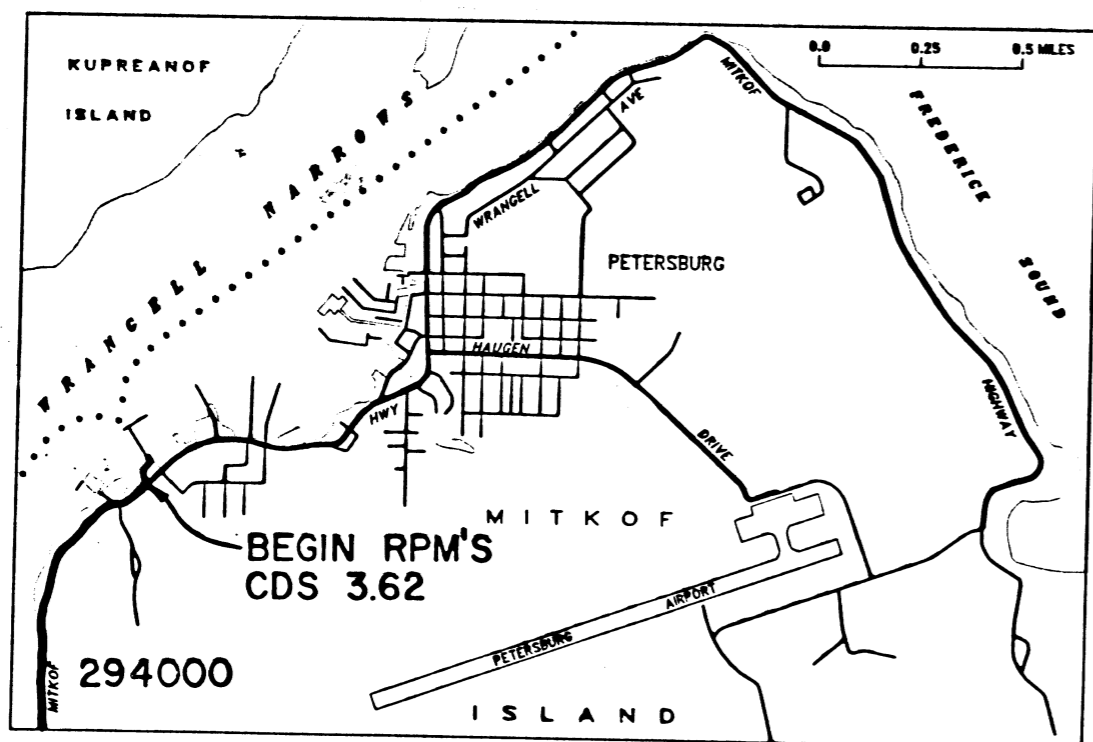

Road	CDS Route	CDS Begin	CDS End	Miles	Markers		No Passing Grooves
					Yellow	White	
Mitkof Highway	294000	3.62	6.15	2.53	226 217	0	21

PETERSBURG

NOTE: DO NOT SCALE FROM THESE PLANS—USE DIMENSIONS

BY:	DATE:	DESCRIPTION OF CHANGE:

RECORD OF REVISIONS

STATE OF ALASKA
DEPARTMENT OF TRANSPORTATION
AND PUBLIC FACILITIES
SOUTHEAST REGION DESIGN & CONSTRUCTION

S.E. AK. REFLECTIVE PAVEMENT MARKERS
F-000C(2) 70295
MITKOF HIGHWAY

DESIGNED BY: R.P.	SCALE N.A.
DRAWN BY:	DATE:
CHECKED BY: J.A.	SHEET 14 OF 17

ENGINEER'S SEAL

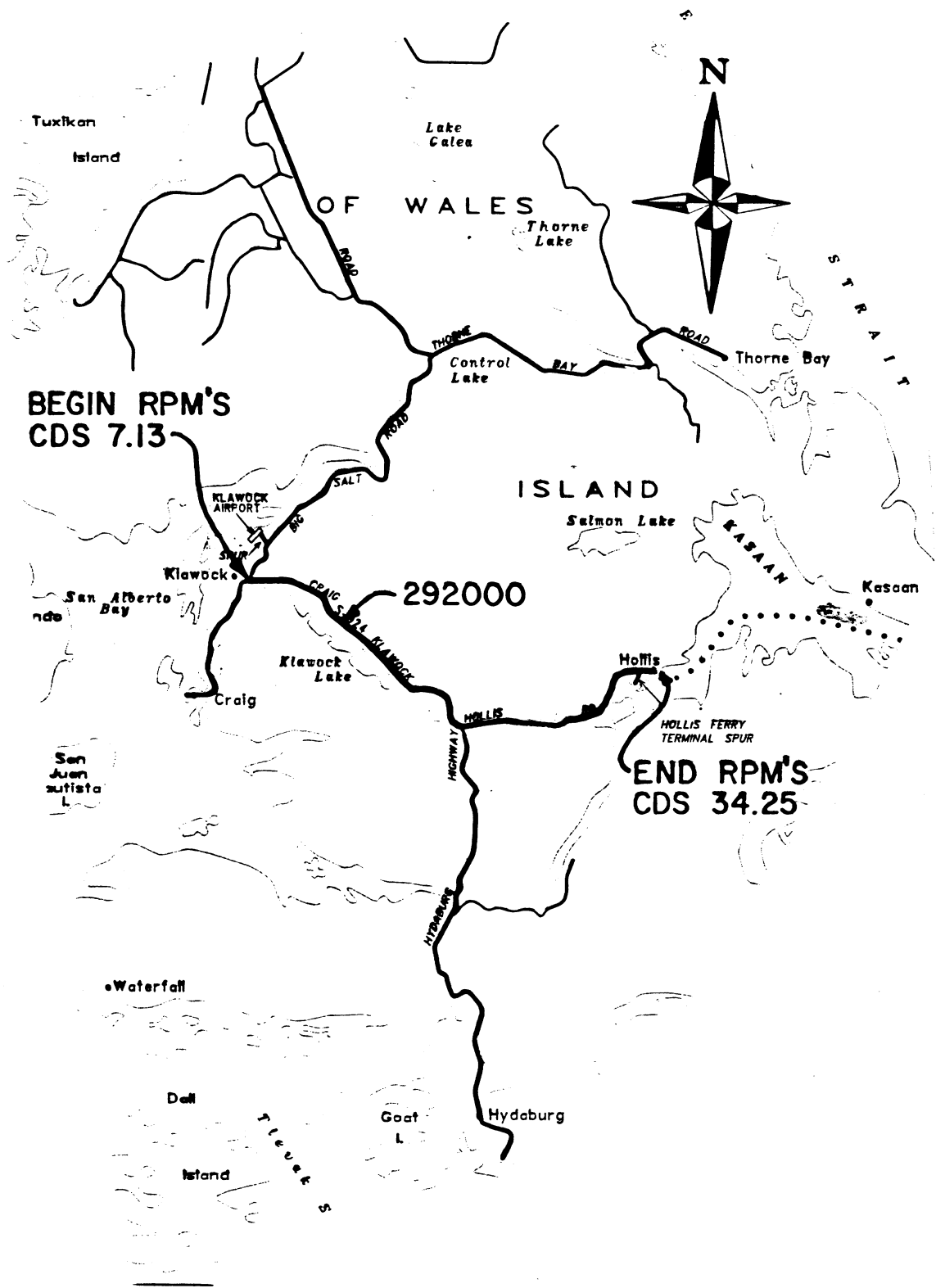

Road	CDS Route	CDS Begin	CDS End	Miles	Markers		No Passing Grooves
					Yellow	White	
Craig/Klawock/Hollis Highway	292000	7.13	34.25	27.12	2305 2168	0	81

KLAWOCK HOLLIS

NOTE: DO NOT SCALE FROM THESE PLANS--USE DIMENSIONS

DATE:	DESCRIPTION OF CHANGE:

RECORD OF REVISIONS

STATE OF ALASKA
DEPARTMENT OF TRANSPORTATION
AND PUBLIC FACILITIES
SOUTHEAST REGION DESIGN & CONSTRUCTION

S.E. AK. REFLECTIVE PAVEMENT MARKERS
F-000C(2) 70295
CRAIG/KLAWOCK/HOLLIS HIGHWAY

DESIGNED BY: R.P.	SCALE N.A.
DRAWN BY:	DATE:
CHECKED BY: J.A.	SHEET 15 OF 17

ENGINEER'S SEAL

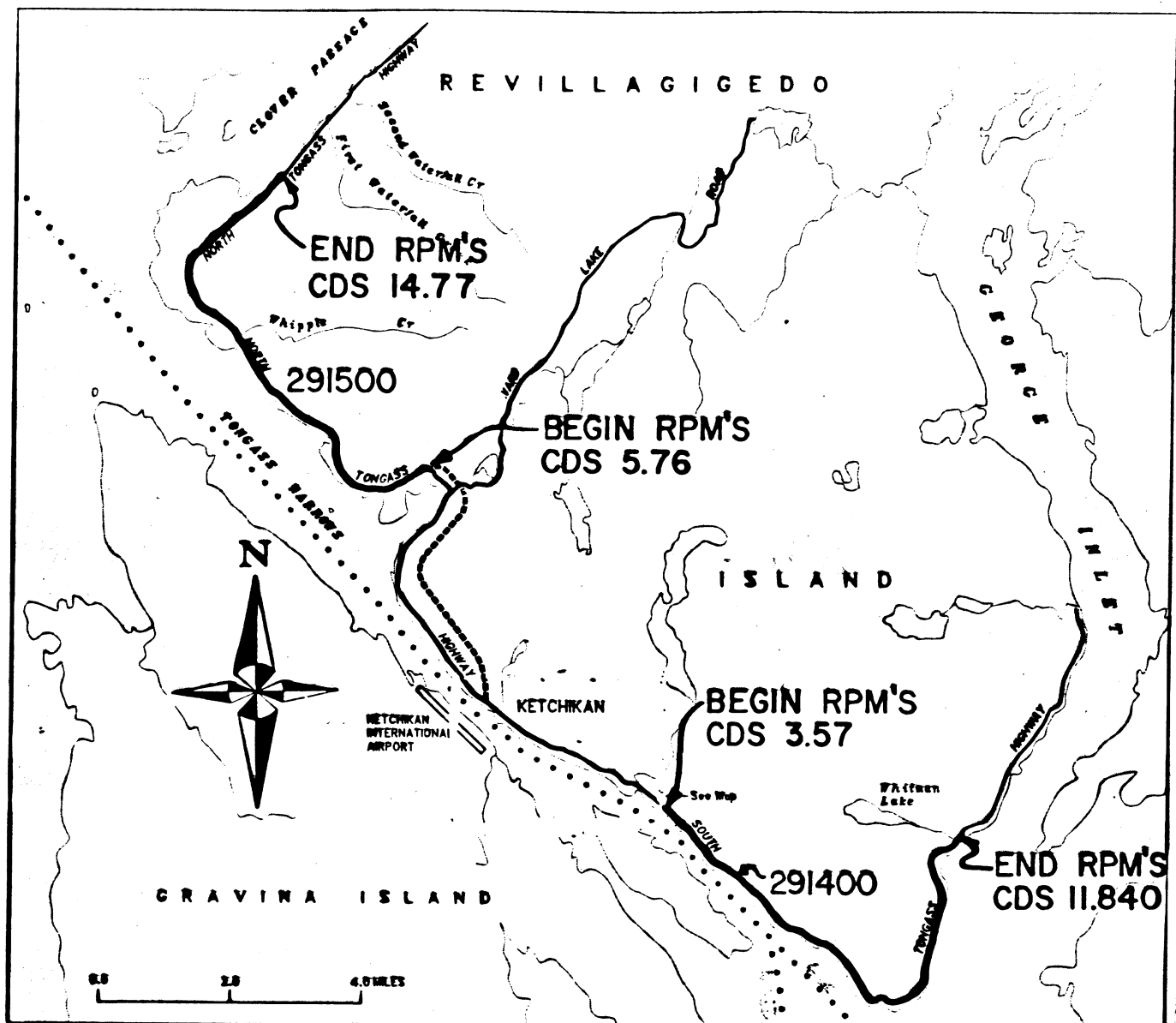

Road	CDS Route	CDS Begin	CDS End	Miles	Markers		Removal Old Markers	No Passing Grooves
					Yellow	White		
South Tongass Highway	291400	3.57	11.84	8.27	814 625		636 1119	12
North Tongass Highway	291500	5.76	14.77	9.01	835 860	13 3	144 162	18

KETCHIKAN

NOTE: DO NOT SCALE FROM THESE PLANS—USE DIMENSIONS

<table border="1" style="width: 100%; border-collapse: collapse;"> <tr> <th style="width: 10%;">BY:</th> <th style="width: 10%;">DATE:</th> <th style="width: 80%;">DESCRIPTION OF CHANGE:</th> </tr> <tr> <td> </td> <td> </td> <td> </td> </tr> <tr> <td> </td> <td> </td> <td> </td> </tr> <tr> <td> </td> <td> </td> <td> </td> </tr> </table> <p style="text-align: center; font-weight: bold;">RECORD OF REVISIONS</p>	BY:	DATE:	DESCRIPTION OF CHANGE:										<p>STATE OF ALASKA DEPARTMENT OF TRANSPORTATION AND PUBLIC FACILITIES SOUTHEAST REGION DESIGN & CONSTRUCTION</p>	<p>S.E.AK. REFLECTIVE PAVEMENT MARKERS F-000C(2) 70295 S. TONGASS HWY./N. TONGASS HWY.</p>	<table border="1" style="width: 100%; border-collapse: collapse;"> <tr> <td>DESIGNED BY: R.P.</td> <td>SCALE N.A.</td> </tr> <tr> <td>DRAWN BY:</td> <td>DATE:</td> </tr> <tr> <td>CHECKED BY: J.A.</td> <td>SHEET 16 OF 17</td> </tr> </table>	DESIGNED BY: R.P.	SCALE N.A.	DRAWN BY:	DATE:	CHECKED BY: J.A.	SHEET 16 OF 17
BY:	DATE:	DESCRIPTION OF CHANGE:																			
DESIGNED BY: R.P.	SCALE N.A.																				
DRAWN BY:	DATE:																				
CHECKED BY: J.A.	SHEET 16 OF 17																				

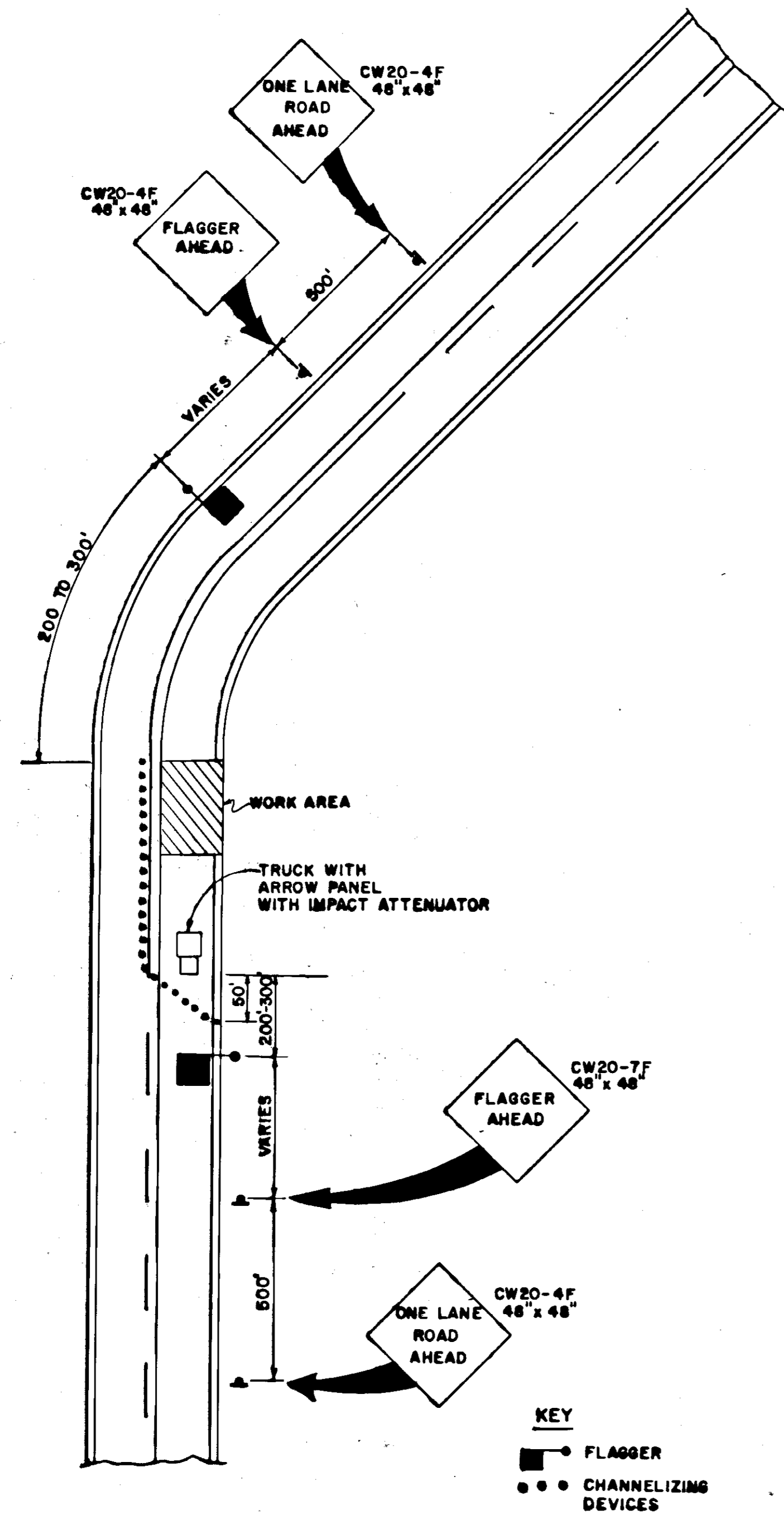

TYPICAL LANE CLOSURE - SHORT DURATION

-GENERAL NOTES-

1. IF ENTIRE WORK AREA IS VISIBLE FROM ONE STATION, SINGLE FLAGGER MAY BE USED.
2. THE TRUCK-MOUNTED-ATTENUATOR EQUIPPED SHADOW VEHICLE SHALL MAINTAIN A SEPARATION OF AT LEAST 100 FEET FROM THE WORK ZONE.

NO.	CODE	DESCRIPTION	SIZE
1	CW20-4F	ONE LANE ROAD AHEAD	48" X 48"
2	CW20-7F	FLAGGER AHEAD	48" X 48"
3	CW20-1F	ROAD CONSTRUCTION AHEAD	48" X 48"
4	CW21-1	MEN WORKING	36" X 36"
5	CW4-3		36" X 36"
6	CW13-1	20 MPH	24" X 24"

KEY
 FLAGGER
 CHANNELIZING DEVICES

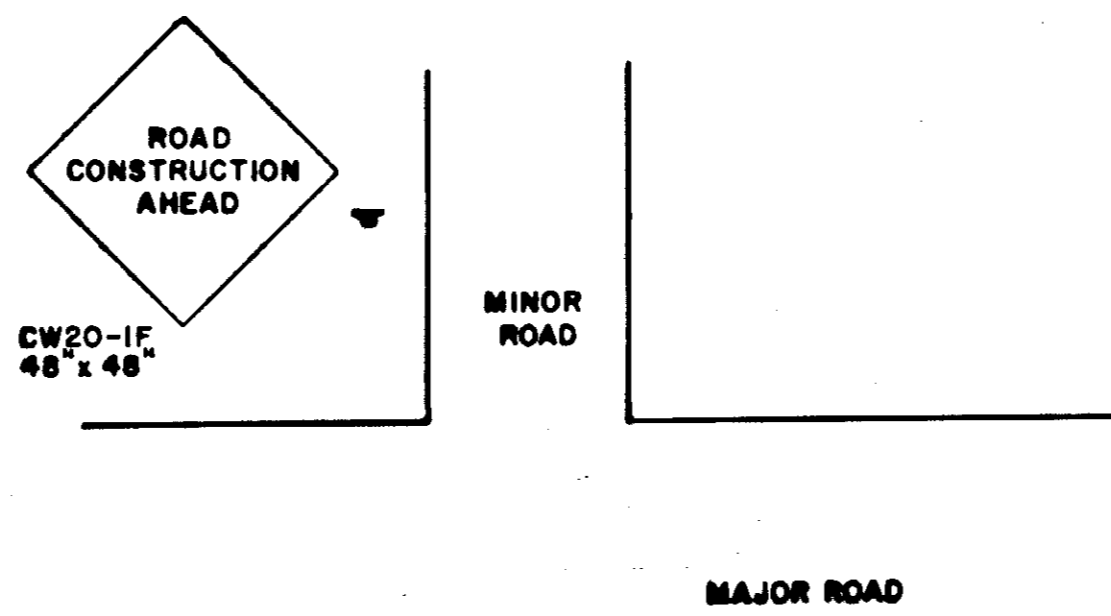

SIDE STREET SIGNING DETAIL

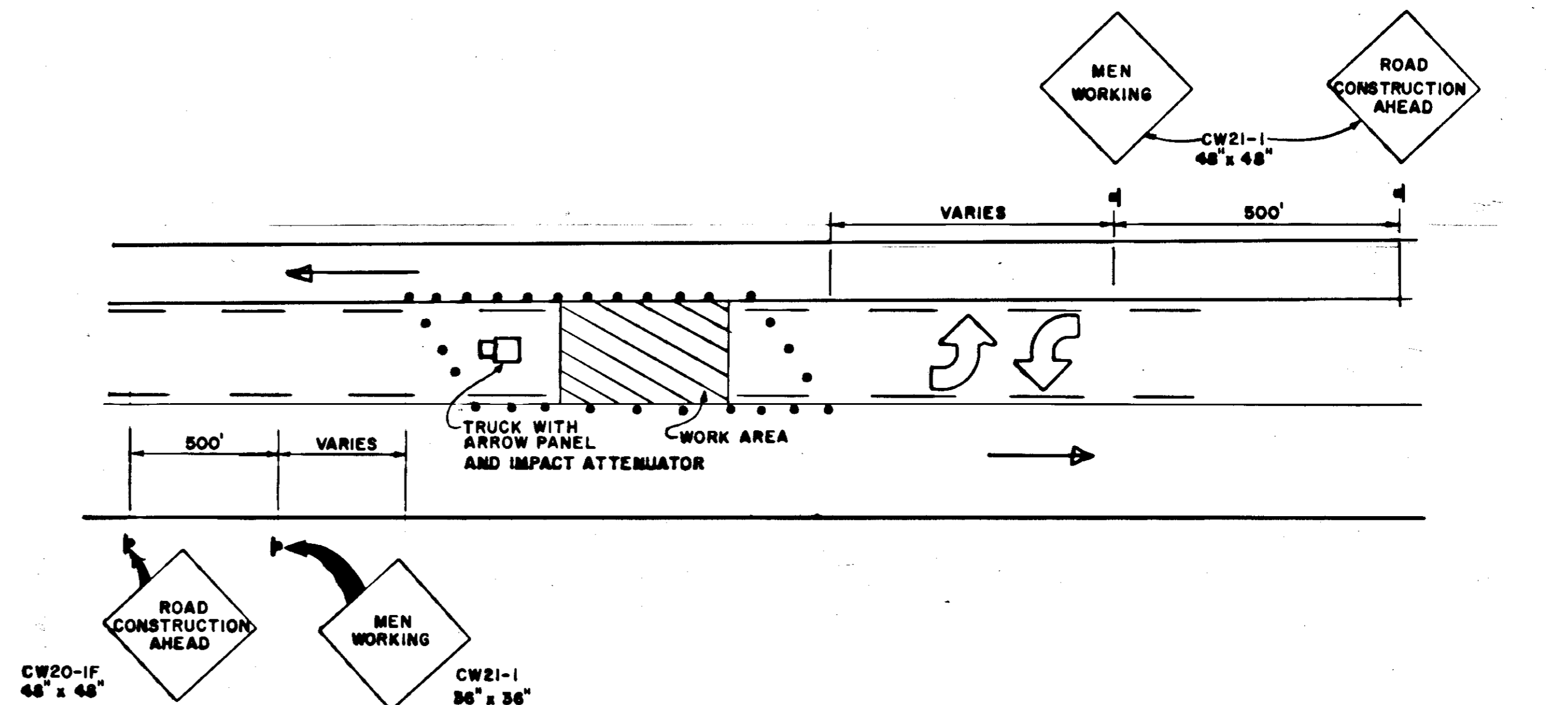

TYPICAL FOR TWO WAY LEFT TURN LANE

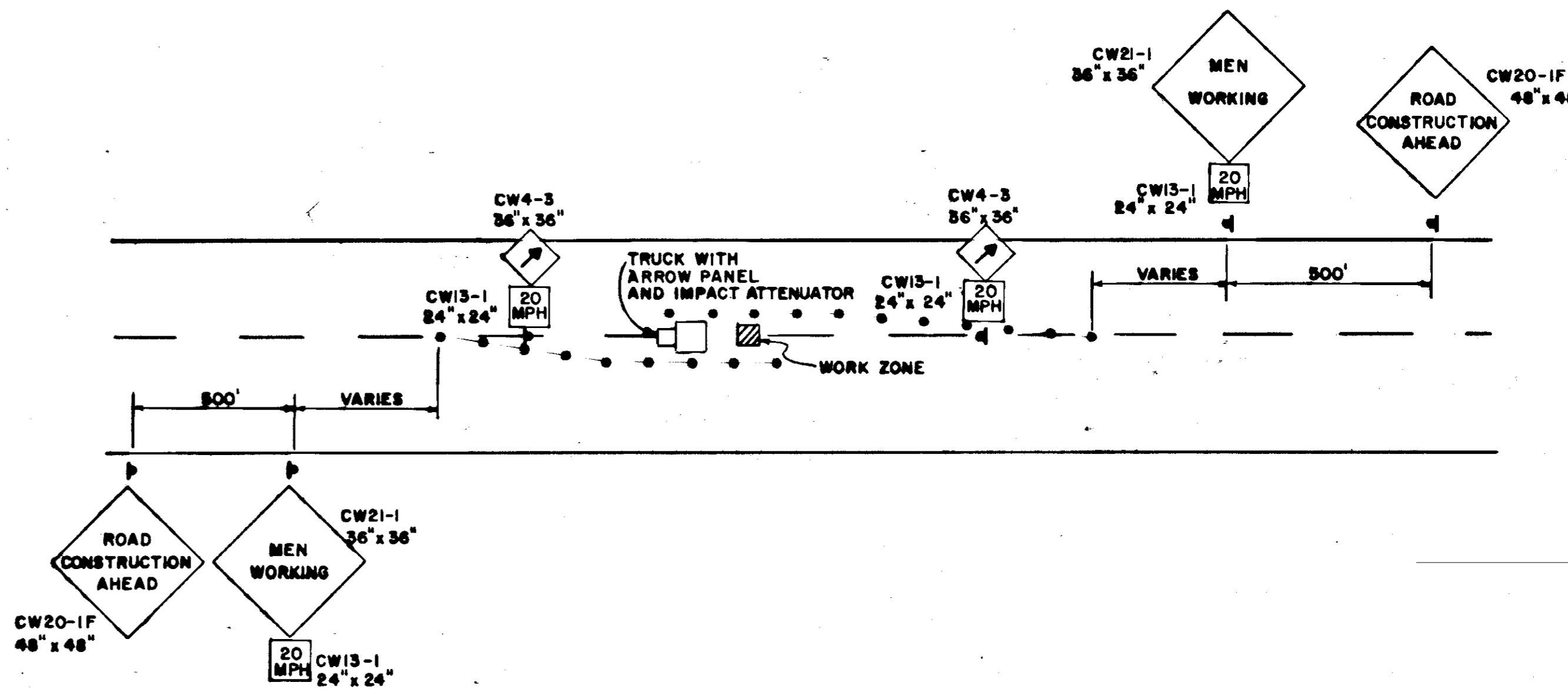

TYPICAL CLOSURE, CENTER OF TWO LANE ROAD
 FOR ROADWAYS 32' WIDE OR GREATER

BY	DATE	DESCRIPTION OF CHANGE
RECORD OF REVISIONS		

STATE OF ALASKA
 DEPARTMENT OF TRANSPORTATION
 & PUBLIC FACILITIES
 SOUTHEAST REGION DESIGN & CONSTRUCTION

S.E. AK. REFLECTIVE PAVEMENT MARKERS
 F-000C (2) 70295
 TRAFFIC CONTROL PLAN

APPROVED BY:	DESIGNED BY:	SCALE:
RECOMMENDED BY:	R.P.	NONE
PREPARED BY:	DRAWN BY:	DATE:
PROJECT MANAGER	B.A.	
LEAD DESIGNER	CHECKED BY:	SHEET 17 OF 17
	J.A.	

