

**STATE OF ALASKA  
DEPARTMENT OF TRANSPORTATION  
&  
PUBLIC FACILITIES**

**PLAN AND PROFILE  
PROPOSED HIGHWAY PROJECT**

**JUNEAU VICINITY  
SCHOOL BUS STOP ILLUMINATION  
SOS-3 (16)**

STATE	PROJECT	SHEET NO.	TOTAL SHEETS
ALASKA	SOS-3 (16)	1	4

TITLE SHEET

SHT. NO.	INDEX OF SHEETS
1	TITLE SHEET
2	LIGHTS 1-9
3	LIGHTS 10-12
4	LIGHTS 13-18

The following Standard Drawings apply to this project:  
A-1, G00.04, C-10.03, C-11.03  
L-03.12, L-23.03, L-30.01

ESTIMATE OF QUANTITIES			
ITEM NO.	ITEM	UNIT	AMOUNT
110(1)	Mobilization	L.S.	All Req'd
114(1)	Construction Engineering by Contractor	L.S.	All Req'd
115(1)	Traffic Maintenance	L.S.	All Req'd
640(3)	Highway Lighting System Complete	L.S.	All Req'd

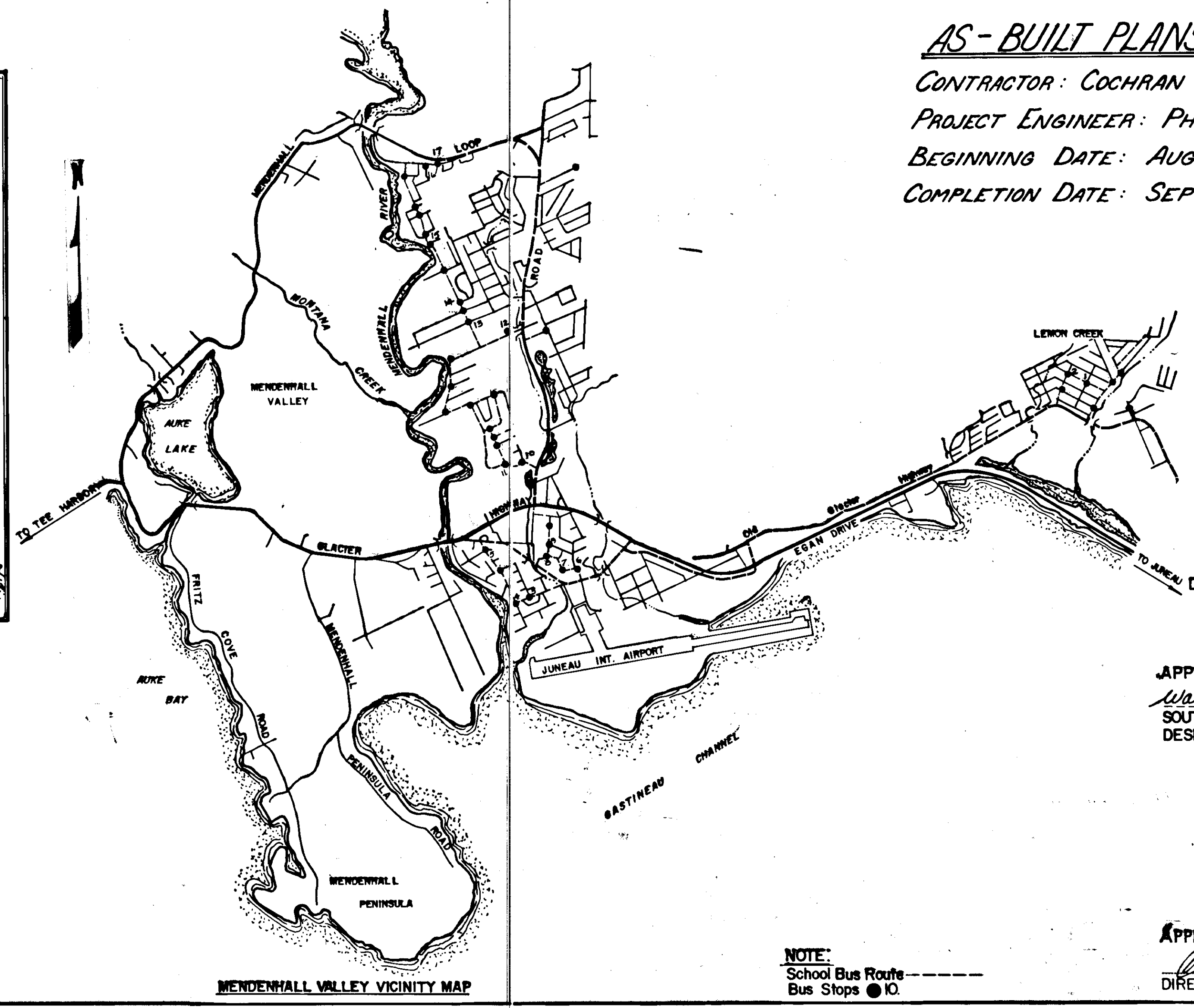
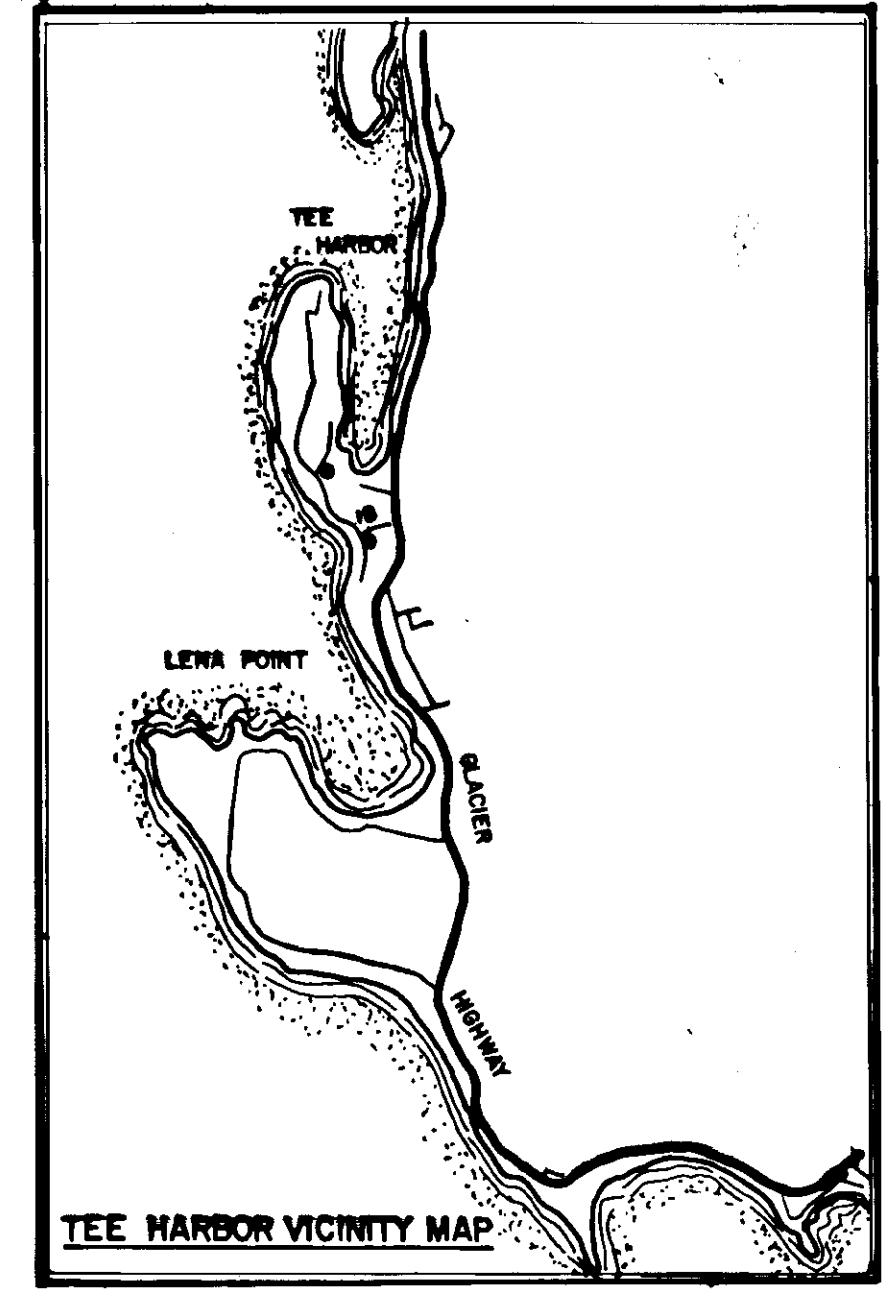

**AS-BUILT PLANS**  
 CONTRACTOR: COCHRAN ELECTRIC CO. INC  
 PROJECT ENGINEER: PHIL R. SPEER  
 BEGINNING DATE: AUG. 24, 1981  
 COMPLETION DATE: SEPT. 26, 1981

STATE OF ALASKA  
DEPARTMENT OF TRANSPORTATION  
&  
PUBLIC FACILITIES

APPROVED  
*Walter K. Williams* DATE 2-13-81  
SOUTHEASTERN REGION  
DESIGN / CONSTRUCTION ENGINEER

STATE OF ALASKA  
DEPARTMENT OF TRANSPORTATION  
&  
PUBLIC FACILITIES

APPROVED  
*Charles S. Starbuck* Date 2-17-81  
DIRECTOR-HIGHWAY DESIGN & CONSTRUCTION

NOTE:  
School Bus Route  
Bus Stops ● 10.

STATE	PROJECT DESIGNATION	YEAR	SHEET NO.	TOTAL SHEETS
ALASKA	SOS-3(16)	1981	2	4

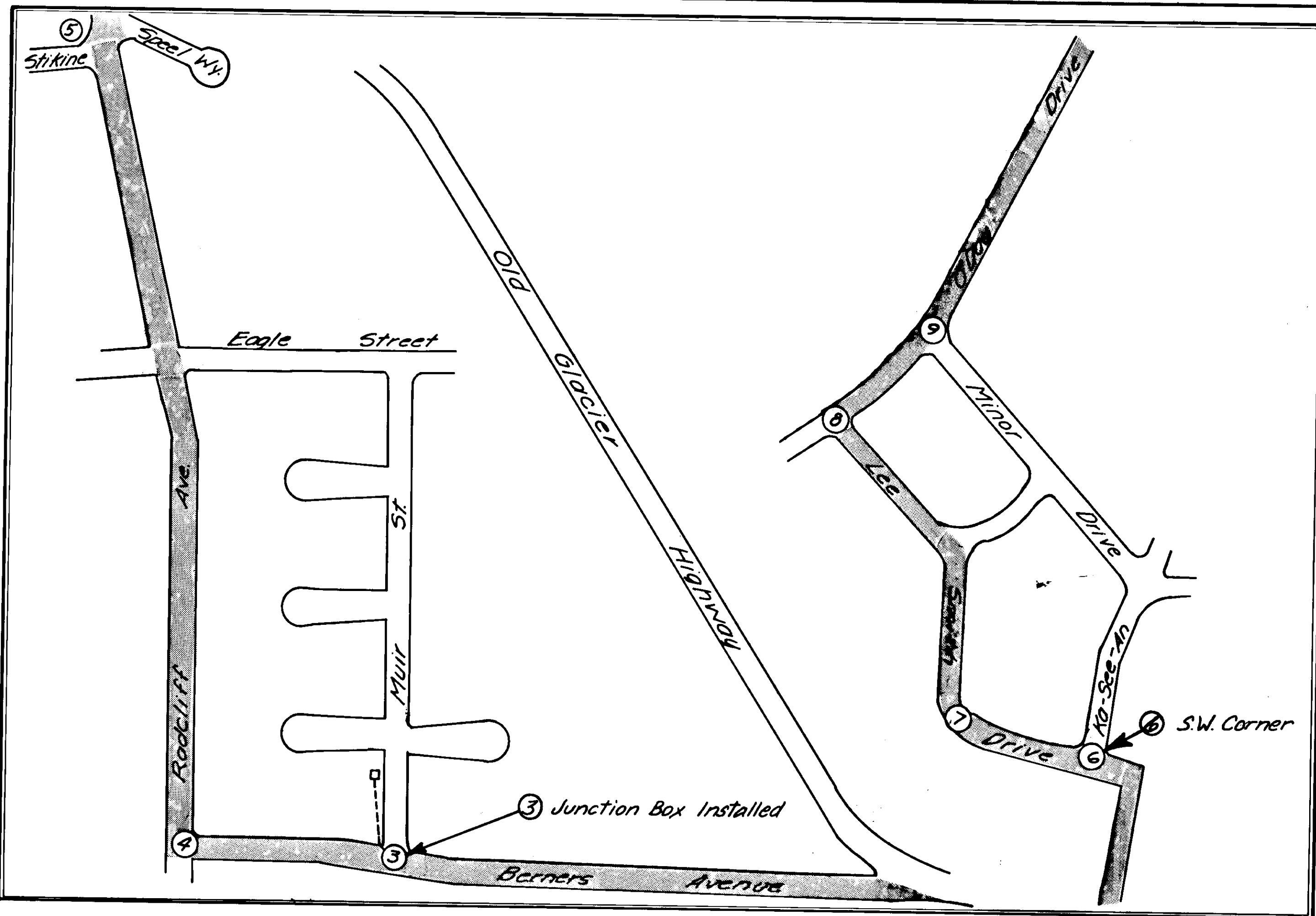

LIGHT LOCATION NOTES

- ① Lund Street and Patti Street, N.E.  
Install a new pole on S.E. corner with approximately 110 feet of underground line to transformer vault No. N144.
- ② Lund Street and Central Street  
Install a new pole on S.E. corner with approximately 145 feet underground line to transformer vault next to telephone pedestal No. 296.
- ③ Berners Avenue and Muir Street  
Install new pole on S.W. corner with approximately 125 feet underground line from vault West side of Muir St. To bring line from vault to edge of pavement it will have to cross a primary cable. & Junction Box Installed
- ④ Berners Avenue and Radcliff Drive  
Install mast arm and luminaire on existing pole.
- ⑤ Radcliff and Strike Street  
Install new pole on NW corner, bringing the secondary power from a pedestal across the street and approximately 40 feet away.
- ⑥ Lee Smith Drive and <sup>S.W.</sup> See-An Street  
Install new pole at ~~SW~~ corner, bringing the power down a pole approximately 150 feet West of intersection and then underground.
- ⑦ Lee Smith Drive in Curve  
Install mast arm and luminaire on existing pole.
- ⑧ Lee Smith Drive and O'Day Drive  
Install mast arm and luminaire on existing pole.
- ⑨ O'Day Drive and Minor Drive  
Install new pole on NE corner, bringing the power down a pole approximately 150 feet NE of O'Day Drive and then underground.

GENERAL NOTES

1. All luminaires shall be 240 V, 250 Watts medium distribution, semi cut-off Type III High Pressure Sodium.
2. All luminaires shall be equipped with their own photo electric cell.
3. All mast arms mounted on wood poles shall be General Electric, Catalog No. C 626 005.
4. All mast arms mounted on existing poles shall have a mounting height of 30 feet, if previous construction will not allow this height, they shall be mounted as high as possible.
5. All luminaires mounted on new poles shall have a mounting height of 30 feet and a mast arm of 8 feet.
6. Where new poles are specified, the Contractor shall have the option of providing lighting standards that comply with Standard Drawing L-03.12, mounted on Type II or Type III base, in accordance with Standard Drawing L-30.11. Or, centrifugally cast prestressed hollow concrete poles, base mounted or imbedded mounting. All poles to withstand a wind loading of 100 m.p.h.
7. All luminaires mounted on new poles shall be fused in accordance with Standard Modifications, Section 660-2.09 B.
8. All Wire shall be No. 8 X HHW.
9. All underground wire shall be run in 1 inch rigid conduit.
10. Engineering by Contractor shall consist of determining the property line of the lots adjacent to the new poles, and locating the poles at the edge of the Right-of-Way, or as directed by the engineer.
11. A Type I junction box shall be installed in accordance with Standard Drawing L-23.03 at horizontal angle points when underground runs can not be accomplished with a straight line.
12. All work on utility owned poles and equipment shall be done in accordance with their requirements.
13. Where a new pole is called for on the plans, it is understood that a mast arm and light are required.

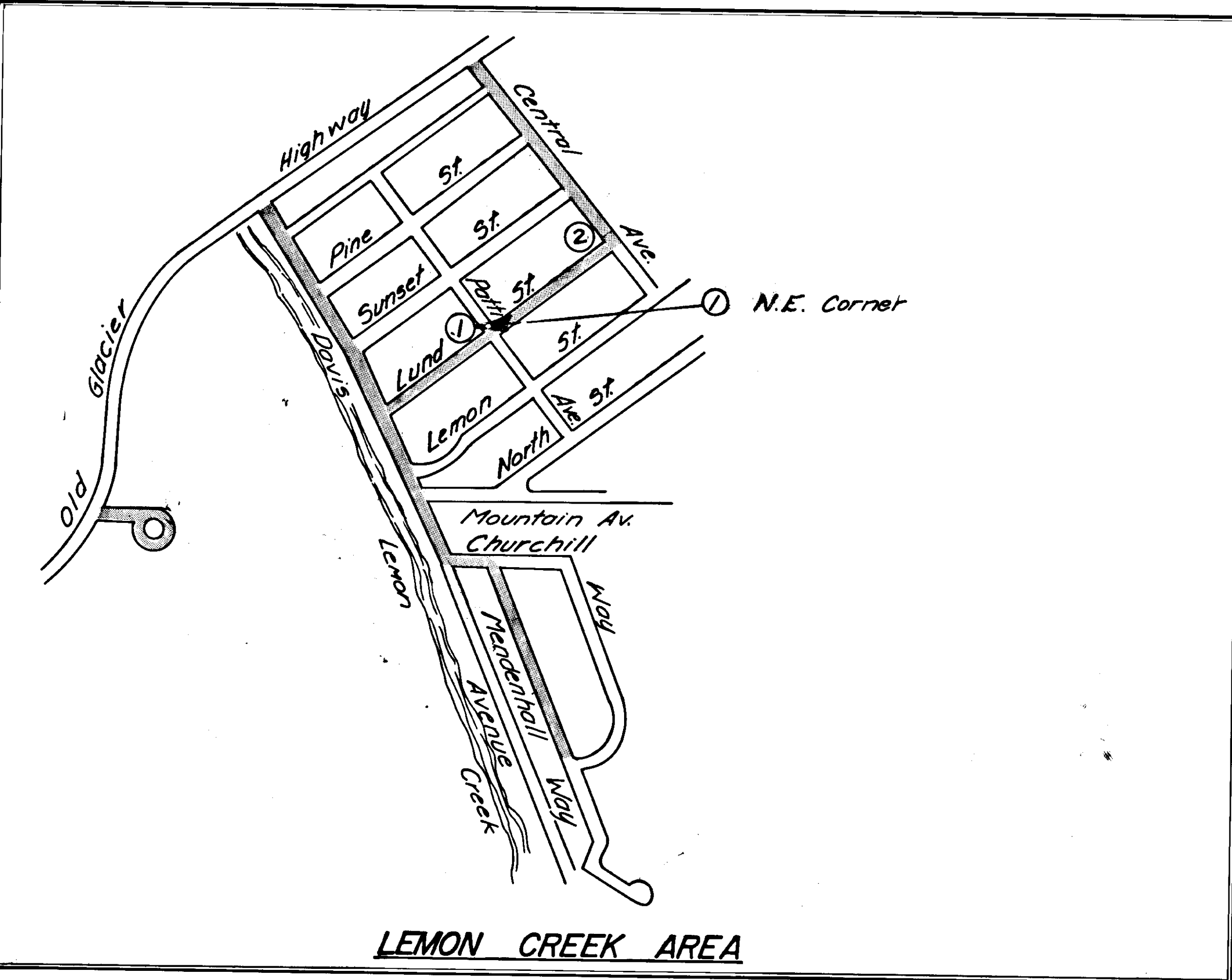

LEMON CREEK AREA

STATE	PROJECT DESIGNATION	YEAR	SHEET NO.	TOTAL SHEETS
ALASKA	505-3(16)	1981	3	4

LIGHT LOCATION NOTES

- 10. James Blvd. and Marsha Avenue  
Install new pole on Southside of intersection near transformer.
- 11. James Blvd. and Linda Ave  
Install new pole on South side of intersection near transformer.
- 12. Stephen Richards Memorial Drive across from the Sprucewood Laundromat.  
Install new pole across from laundromat. Bring power underground from back of nearest trailer, approximately 50 feet.



STATE	PROJECT DESIGNATION	YEAR	SHEET NO.	TOTAL SHEETS
ALASKA	505-3(16)	1981	4	4

LIGHT LOCATION NOTES

13. Riverside Drive and Longrun Drive  
Install mast arm and luminaire on exist. pole.
14. Riverside Drive and Julep Street  
Install mast arm and luminaire on existing pole. Bring secondary power overhead from pole approximately 200 ft. South.
15. Riverside Drive and Lupin Lane  
Install mast arm and luminaire on existing pole. Bring secondary power overhead from pole approximately 200 feet North.
16. Tournoire Street and Julep Street  
Install mast arm and luminaire on existing pole.
17. Tournoire Street and Mint Street  
Install mast arm and luminaire on existing pole. Bring secondary power overhead from pole approximately 200 ft. West.
18. Tee Harbor Road, first intersection  
Install mast arm and luminaire on existing pole. Bring secondary power overhead from pole approximately 200 feet South.

