

STATE OF ALASKA
DEPARTMENT OF PUBLIC WORKS
DIVISION OF HIGHWAYS

PLAN AND PROFILE
PROPOSED HIGHWAY PROJECT
S-0961(1)
GLACIER HIGHWAY - TEE HARBOR NORTH
BITUMINOUS PAVING
&
S-0966(4)
MENDENHALL LOOP ROAD
S-0968(2) - FH-37-1(1)
GLACIER SPUR
BITUMINOUS PAVING & MISC. WORK
AS BUILT

MICROFILMED
DATE 9-9-06

STATE	ROUTE	SECTION	YEAR	SHEET NO.	TOTAL SHEETS
ALASKA	S-0961(1), S-0966(4) & S-0968(2)-FH-37-1(1)		1962	1	1

INDEX OF SHEETS

SHEET NO.	DESCRIPTION
1	TITLE SHEET
2 & 3	TYPICAL SECTION & ESTIMATE OF QUANTITIES
4	MATERIAL SOURCES
5-11	PLAN & PROFILE SHEETS
12-13	INTERSECTION & PARKING LOT DETAILS
14-15	CULVERTS & MISC. WORK
16	SUMMARY OF STANDARD SIGNS
S-1	STANDARD CULVERTS
S-2	STANDARD END SECTIONS
S-3	STANDARD APPROACHES
S-6	STANDARD PROJECT IDENTIFICATION SIGN
S-8	STANDARD BEAM-TYPE GUARDRAIL
S-9	STANDARD TIMBER GUIDE POST
S-10	STANDARD DROP INLETS, CATCH BASINS & MANHOLES

TYPE OF IMPROVEMENT 6201

DESIGN DESIGNATION
S-0961(1)
ADT (1960) = 130 D = 65 %
ADT (1980) = 390 T = 5 %
DHV = 60 V = 45 mph

DESIGN DESIGNATION
S-0966(4) & S-0968(2)-FH-37-1(1)
ADT (1960) = 400 D = 70 %
ADT (1980) = 1400 T = 5 %
DHV = 180 V = 50 mph

Field reports of the foundation soils and the type of materials found in the listed pits for this project are available for inspection in the Dept. of Public Works, Division of Highways, District office at Juneau and the headquarters office at Juneau.
Detail cross sections for this project are available for inspection in the Headquarters office at Juneau and the District office at Juneau.

- CONVENTIONAL SIGNS
- PROPOSED CONSTRUCTION CENTERLINE
 - PRELIMINARY SURVEY LINE
 - TOWNSHIP LINE
 - SECTION LINE
 - PROPERTY LINE
 - RIGHT-OF-WAY LINE
 - EASEMENT LINE
 - CORPORATED OR CITY LIMITS
 - POWER LINE
 - TELEPHONE OR TELEGRAPH LINE
 - POLE ANCHOR
 - LIGHT POLE
 - WATER LINE
 - SEWER LINE
 - VALVE BOX
 - CATCH BASIN
 - DROP INLET
 - MANHOLE
 - CULVERT PROPOSED
 - CULVERT EXISTING
 - FIRE HYDRANT
 - TRAVELED WAY
 - SWAMP
 - FENCE
 - CURB CUT
 - LAND MONUMENT
 - RIGHT-OF-WAY MONUMENT

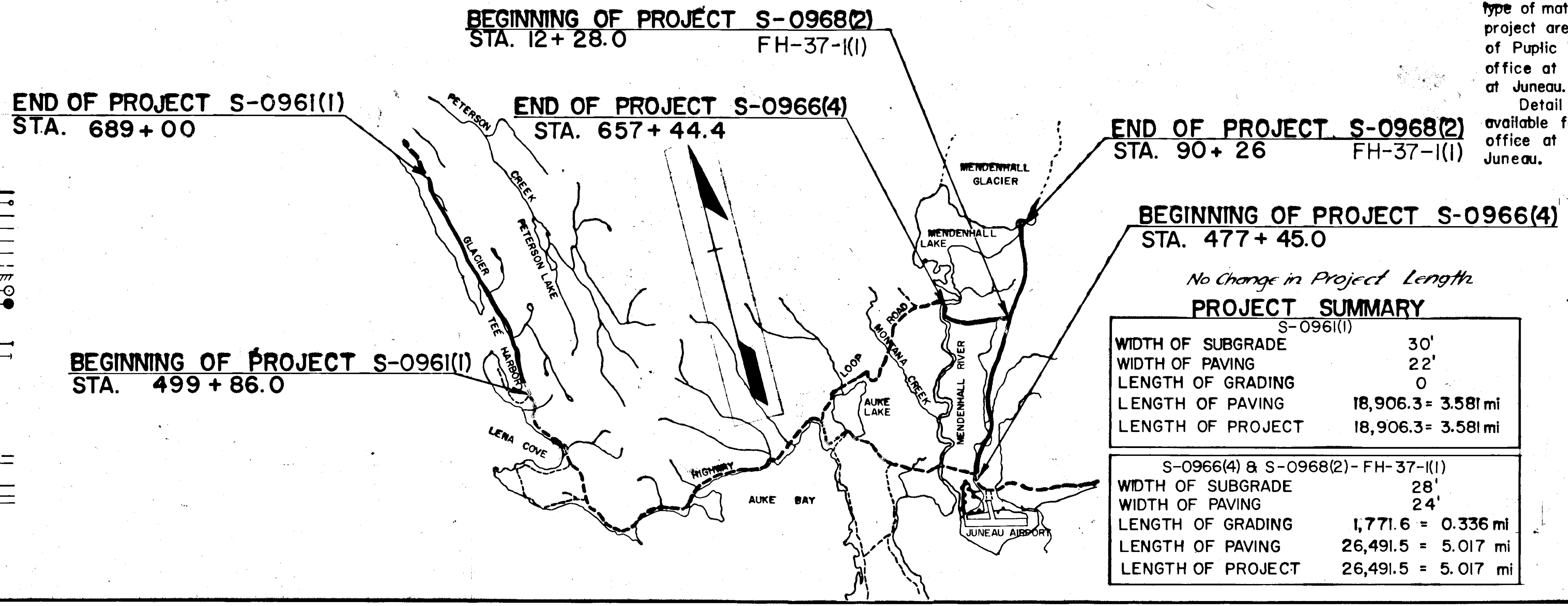

BEGINNING OF PROJECT S-0966(4)
STA. 477 + 45.0

No Change in Project Length

PROJECT SUMMARY

S-0961(1)	
WIDTH OF SUBGRADE	30'
WIDTH OF PAVING	22'
LENGTH OF GRADING	0
LENGTH OF PAVING	18,906.3 = 3.581 mi
LENGTH OF PROJECT	18,906.3 = 3.581 mi

S-0966(4) & S-0968(2)-FH-37-1(1)	
WIDTH OF SUBGRADE	28'
WIDTH OF PAVING	24'
LENGTH OF GRADING	1,771.6 = 0.336 mi
LENGTH OF PAVING	26,491.5 = 5.017 mi
LENGTH OF PROJECT	26,491.5 = 5.017 mi

Contractor: Greer Construction Co.
Project Engineer: Lowell Shepard
Project Started: 9-15-62
Project Finished: 7-13-63
"As built" changes entered Nov. 20, 1963
Changes backchecked

STATE OF ALASKA
DEPT. OF PUBLIC WORKS
DIVISION OF HIGHWAYS

APPROVED
[Signature] Date 11/9/64
COMMISSIONER OF HIGHWAYS

APPROVED
REGIONAL ENGINEER
BUREAU OF PUBLIC ROADS
REGION TEN

AS BUILT

MICROFILMED

By *W. Witham* DATE 9-9-66

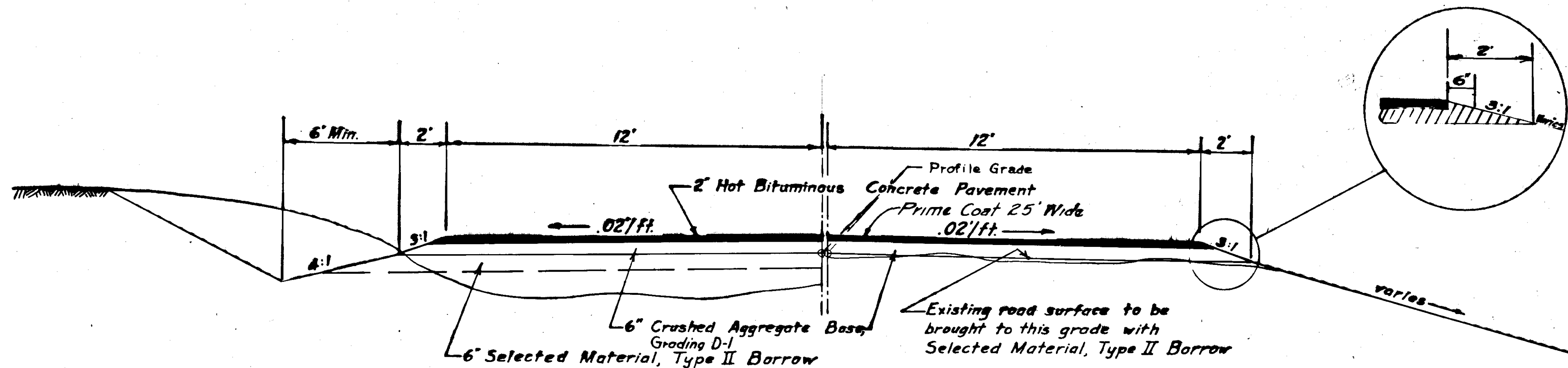

TYPICAL SECTION FOR MENDENHALL LOOP & GLACIER SPUR

TYPICAL SECTION SHOWING
ROADWAY RECONSTRUCTION
Sta. 477+45.0 - Sta. 483+10.3 S-0966(4)
Sta. 602+01.9 - Sta. 614+08.4 S-0966(4)

TYPICAL SECTION SHOWING
FINISHING PREVIOUSLY CONSTRUCTED ROADBED
Sta 483+10.3 - Sta. 607+99.5 S-0966(4)
Sta 614+08.4 - Sta 657+44.4 S-0966(4)
Sta 12+28.0 - Sta 90+26.0 S-0968(2)-FH-37-177

ESTIMATE OF QUANTITIES S-0966(4)

ITEM NO	QUANTITY	UNIT	ITEM
100(3)	1.1	Acre	Clearing and Grubbing
100(4)	1.5	Acre	Pit Clearing and Grubbing
102(1)	4000	Cu. Yd.	Unclassified Excavation
102(6)	2265	Ton	Selected Material, Type I Borrow, Case I
102(6A)	7884	Ton	Selected Material, Type II Borrow, Case I
102(8)	1225	Cu. Yd.	Stripping Borrow Pits Case I
103(1)	91	Cu. Yd.	Excavation for Structures
107(2)	1683	100 Ft. Sta.	Finishing Previously Constructed Roadbed
111(1)	22	Unit	Obliteration of Old Roadways
200(4)	20200	Ton	Crushed Aggregate Base, Grading D-1
310(3)	17300	Gal.	Asphalt, Grade MC-70 Prime Coat
322(1)	6300	Ton	Hot Bituminous Concrete Pavement
322(2)	87200	Gal.	Asphalt Cement, 120-150 Penetration
453(1E)	82	Lin. Ft.	18" Galvanized Corrugated Metal Pipe, 16 Gage
453(1G)	40	Lin. Ft.	24" Galvanized Corrugated Metal Pipe, 14 Gage
454(1B)	90	Lin. Ft.	22"x13" Corrugated Metal Pipe Arch, 16 Gage
454(1D)	40	Lin. Ft.	29"x18" Corrugated Metal Pipe Arch, 14 Gage
454(1G)	22	Lin. Ft.	50"x31" Corrugated Metal Pipe Arch, 12 Gage
457(1)	114	Lin. Ft.	Removal of Culverts
460(2G)	2	Each	Metal End Sections for 24" Pipe Culvert
560(4)	8	Each	Guideposts
583(1)	50	Lin. Ft.	Beam-type Guardrail
584(1)	11	Each	Standard Signs

ESTIMATE OF QUANTITIES S-0968(2)-FH-37-177

ITEM NO	QUANTITY	UNIT	ITEM
100(4)	0.7	Acre	Pit Clearing and Grubbing
102(6)	3530	Ton	Selected Material, Type I Borrow, Case I
102(6A)	1180	Ton	Selected Material, Type II Borrow, Case I
102(8)	575	Cu. Yd.	Stripping Borrow Pits, Case I
103(1)	451	Cu. Yd.	Excavation for Structures
107(2)	780	100 Ft. Sta.	Finishing Previously Constructed Roadbed
111(1)	16	Unit	Obliteration of Old Roadways
200(4)	9200	Ton	Crushed Aggregate Base, Grading D-1
310(3)	8100	Gal.	Asphalt, Grade MC-70 Prime Coat
322(1)	2910	Ton	Hot Bituminous Concrete Pavement
322(2)	40510	Gal.	Asphalt Cement, 120-150 Penetration
453(1C)	78	Lin. Ft.	12" Galvanized Corrugated Metal Pipe, 16 Gage
453(1E)	72	Lin. Ft.	18" Galvanized Corrugated Metal Pipe, 16 Gage
453(1G)	44	Lin. Ft.	24" Galvanized Corrugated Metal Pipe, 14 Gage
454(1B)	56	Lin. Ft.	22"x13" Corrugated Metal Pipe Arch, 16 Gage
455(5H)	78	Lin. Ft.	Bituminous Coated, Structural Plate Pipe Arch, 8'-2" span, 5'9" rise, 10 gage.
460(2G)	2	Each	Metal End Sections for 24" Pipe Culverts
511(1)	1415	Cu. Yd.	Rock Slope Protection
521(2)	4	Each	Inlets
521(5)	4	Pair	Metal Frames and Gratings
524(3)	542	Lin. Ft.	Concrete Curb and Gutter, 6" depth

GENERAL NOTES for S-0966(4) & S-0968(2)-FH-37-177

- Culvert lengths are approximate only and are subject to minor revisions.
- Grades and alignment shown on these plans are subject to minor revisions.
- When necessary for purposes of expediting traffic, aggregate base or bituminous surfacing shall be constructed part width at a time.
- All buildings, fences and other encroachments within the Right-of-Way shall be removed by owners.
- All utilities within the construction limits shall be removed by owners.
- All surfacing depths are nominal.

MICROFILMED

STATE	ROUTE	SECTION	YEAR	SHEET NO.	TOTAL SHEETS
ALASKA	5-0961(1)		1962	3	23

Withdrawn DATE 9-9-66

AS BUILT

ESTIMATE OF QUANTITIES-5-0961(1) TEE HARBOR NORTH

ITEM	QUANTITY	UNIT	ITEM
102(1)	500	Cu Yd	Unclassified Excavation
102(6A)	5400	Ton	Selected Material Type II Borrow, Case I
107(2)	190	100'Sts.	Finishing Previously Constructed Roadbed
200(4)	20,000	Ton	Crushed Aggregate Base, grading D-1
310(3)	18,900	Gal.	Asphalt Grade MC-70 Prime Coat
322(1)	5,500	Ton	Hot Bituminous Concrete Pavement
322(2)	76,500	Gal.	Asphalt Cement 120-150 Penetration
583(1)	1,150	Lin Ft.	Beam-type guardrail
584(1)	6	Each	Standard Signs
305(2A)	2,500	Ton	Stockpiled material, section 300, grading C.
305(2B)	750	Ton	Stockpiled material, section 314, grading D.
305(2C)	150	Ton	Stockpiled material, section 317, grading Article 317-2.1.

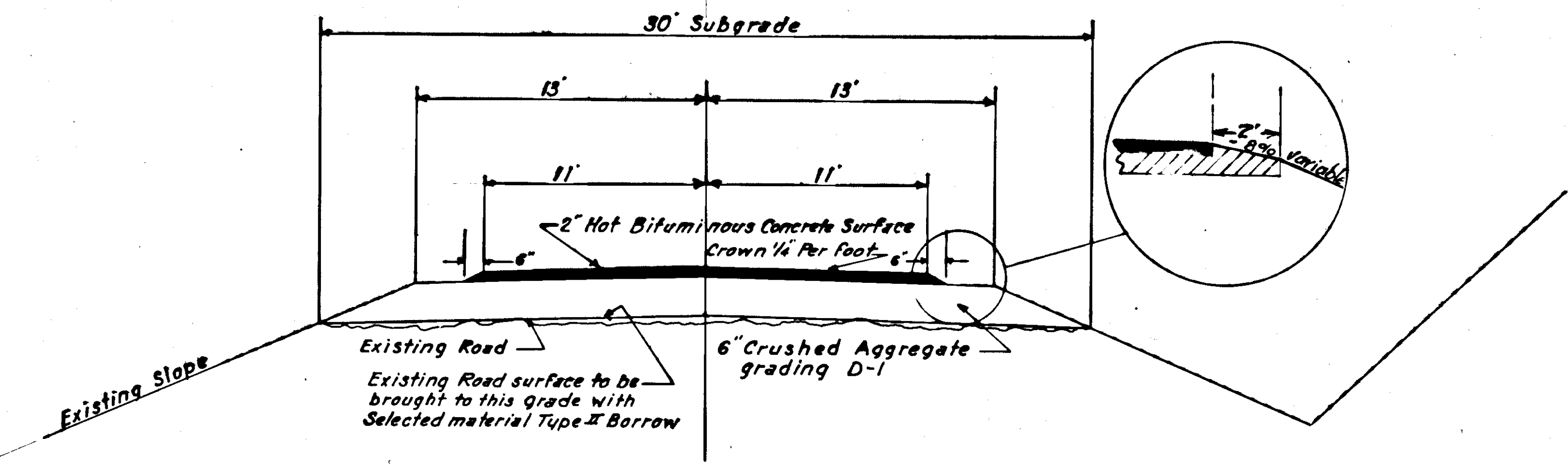

TYPICAL CROSS SECTION TEE HARBOR NORTH

PARKING AREA DETAILS Scale 1"=60'

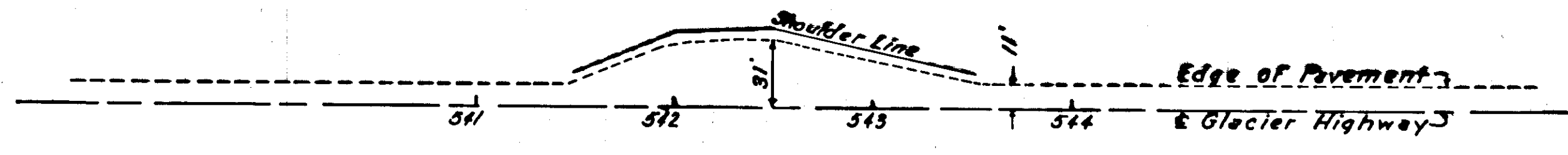
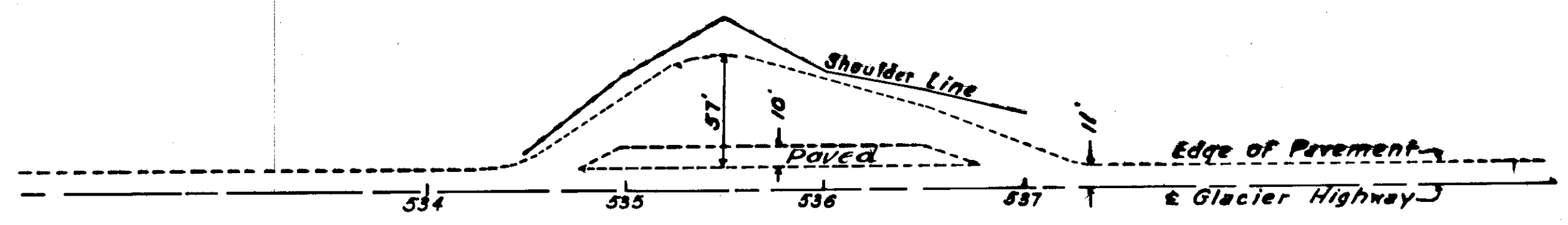
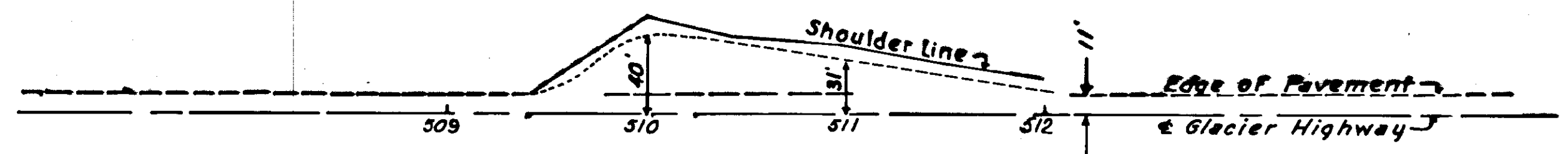

Approaches	
Station	Type
505+40 Lt.	3
584+00 Lt.	3

GUARDRAIL QUANTITIES		
STATION TO STATION		LINEAR FEET
508+00	509+00 Lt.	100
521+00	524+80 Lt.	300 325
530+00	533+30 Lt.	350 362.5
537+50	541+50 Lt.	400
Total		7150
509+50-511+10 Lt.		162.5
534+50-537+80 Lt.		337.5
538+00-541+37.5 Lt.		337.5
541+50-543+10 Lt.		175.0
Total		1800.0

MICROFILMED

STATE	ROUTE	SECTION	YEAR	SHEET	NO.
ALASKA	S-0966(A)		1961	5	2

AS BUILT

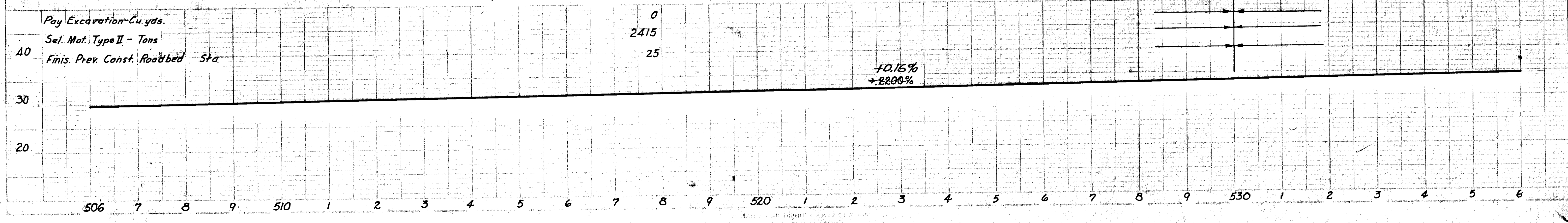
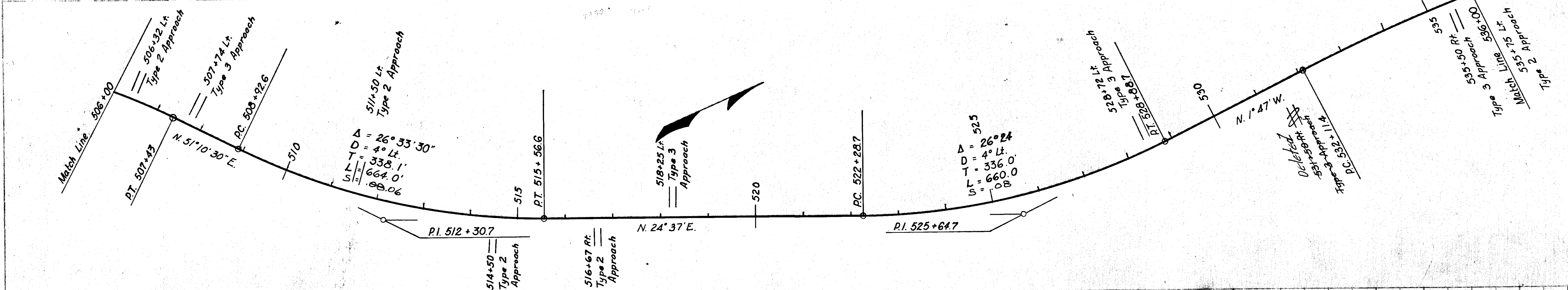
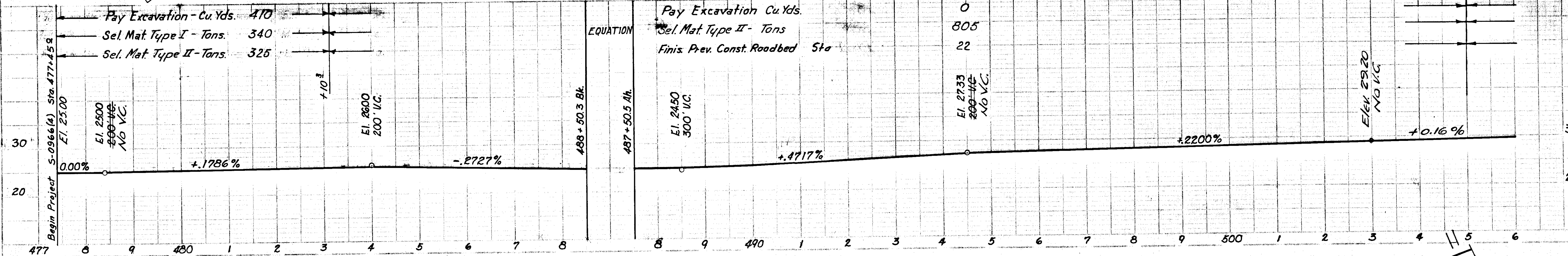
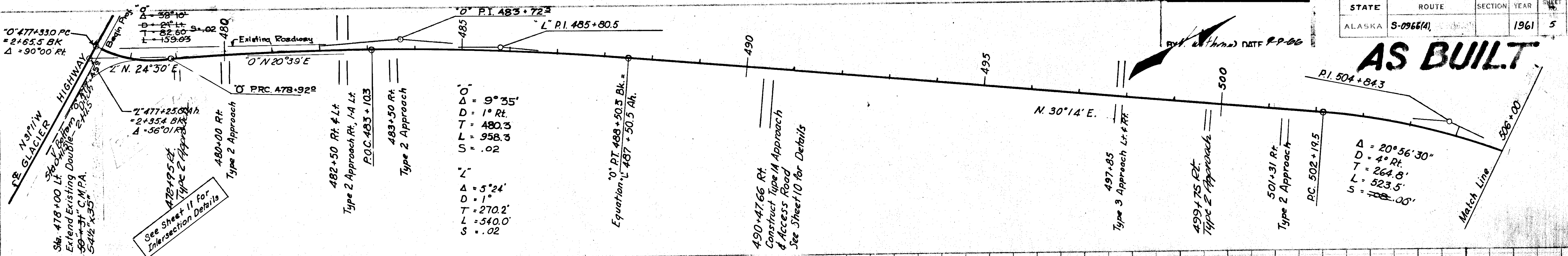

STATE	ROUTE	SECTION	YEAR	SHEET NO.	TOTAL SHEETS
ALASKA	S-0966(4)		1961	6	2

AS BUILT

MICROFILMED

BY *W. J. Withrow* DATE *R.P. 61*

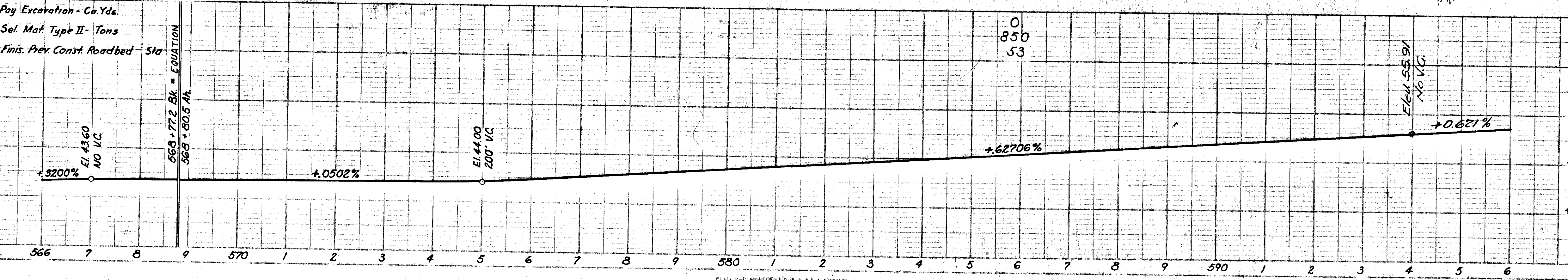
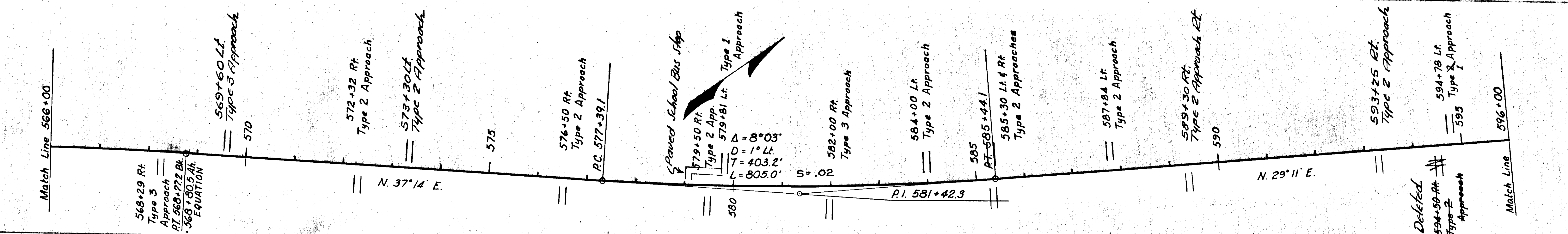
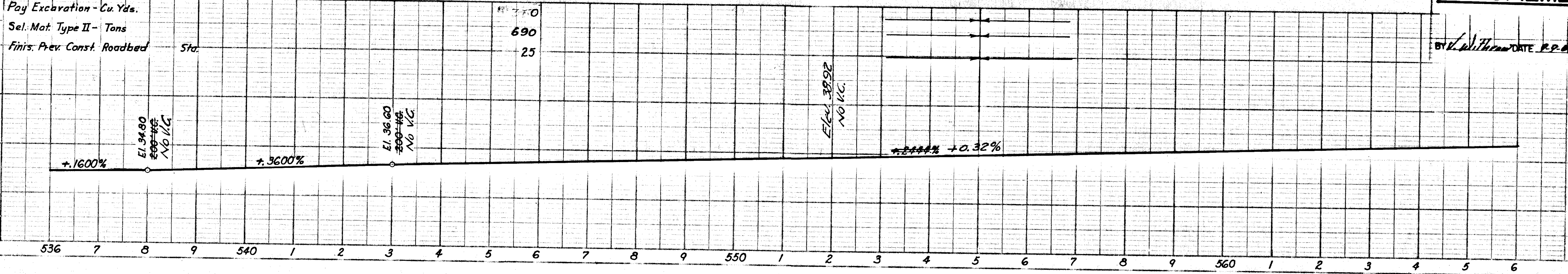
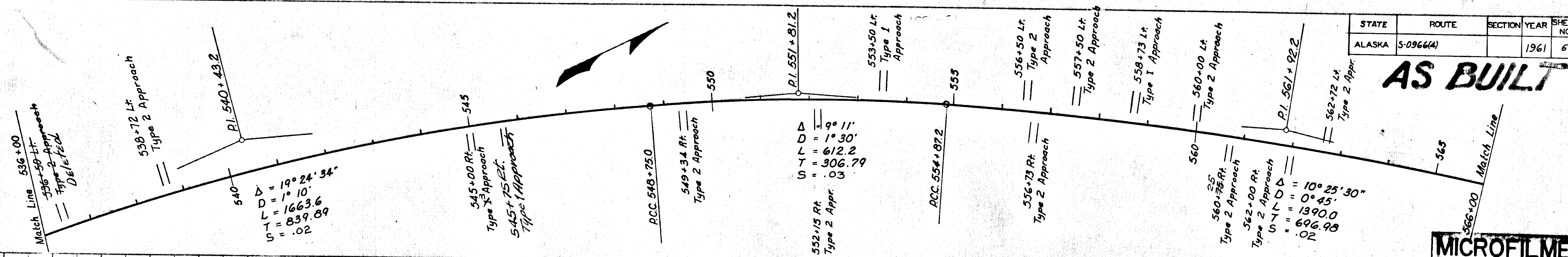

STATE	ROUTE	SECTION	YEAR	SHEET NO.	TOTAL SHEETS
ALASKA	S-0966(4)		1961	7	23

MICROFILMED
 BY *Withdraw* DATE 9-9-66

AS BUILT

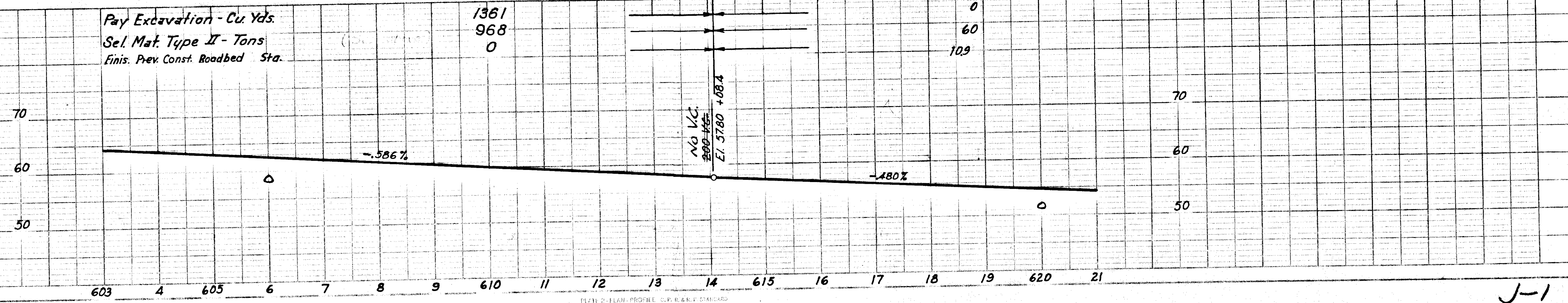
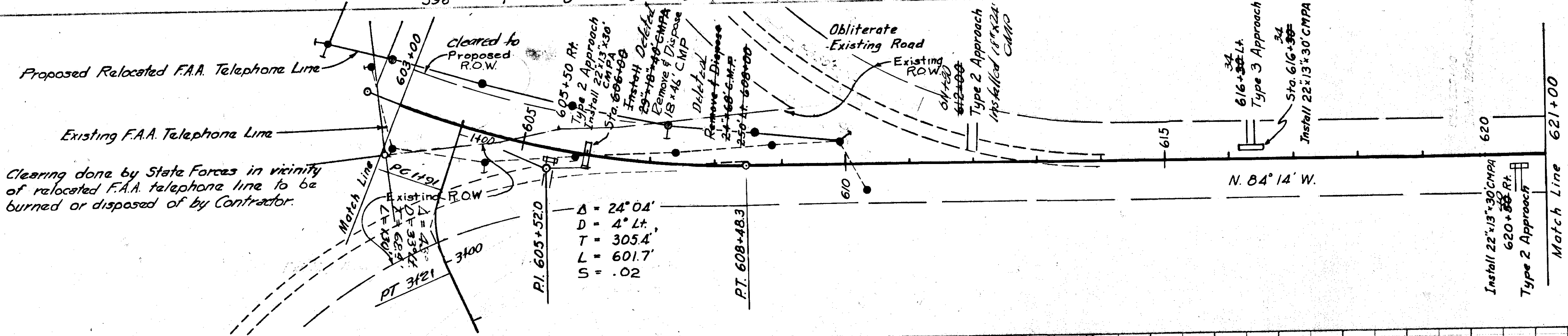
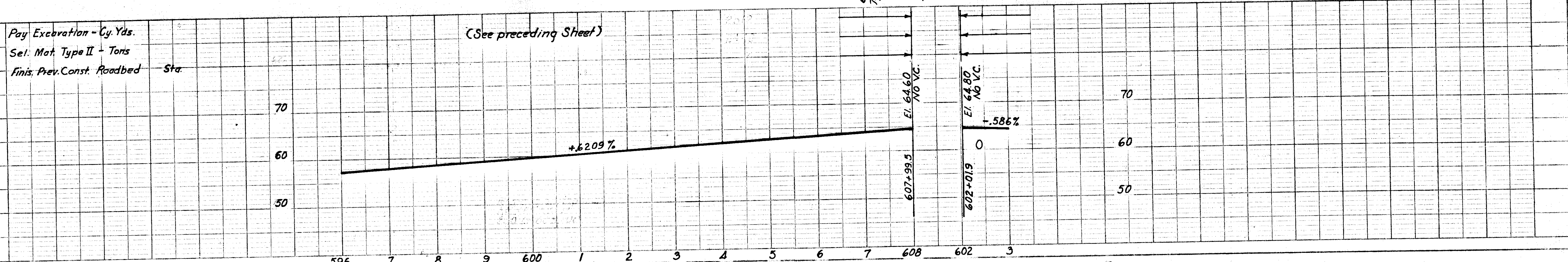
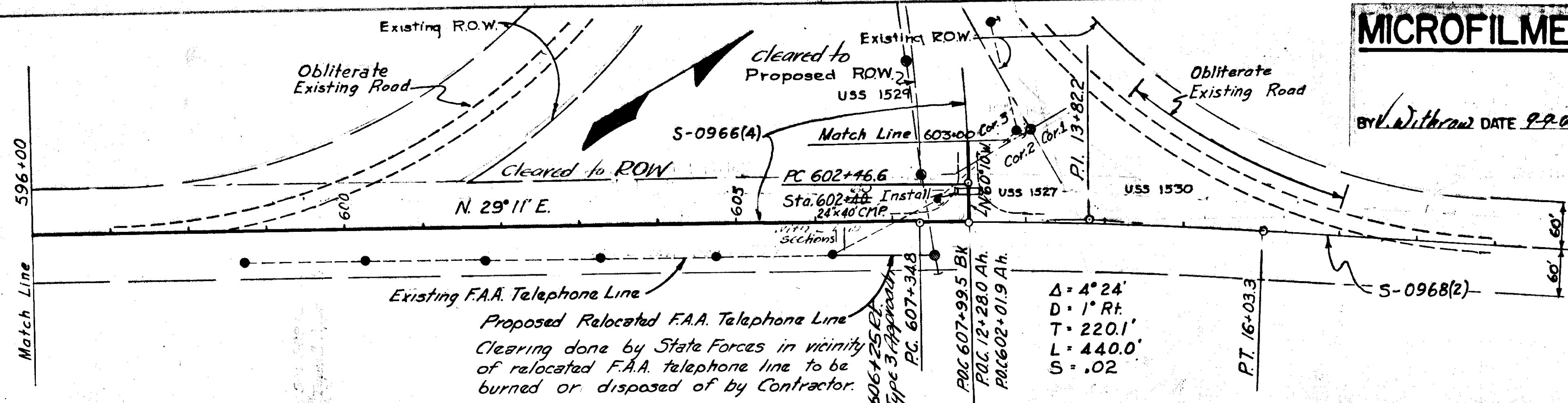

J-1
Mendenhall Loop

MICROFILMED

STATE	ROUTE	SECTION	YEAR	SHEET NO.
ALASKA	S-096670		1961	8

AS BUILT

BY: *Withdraw* DATE: 9-9-66

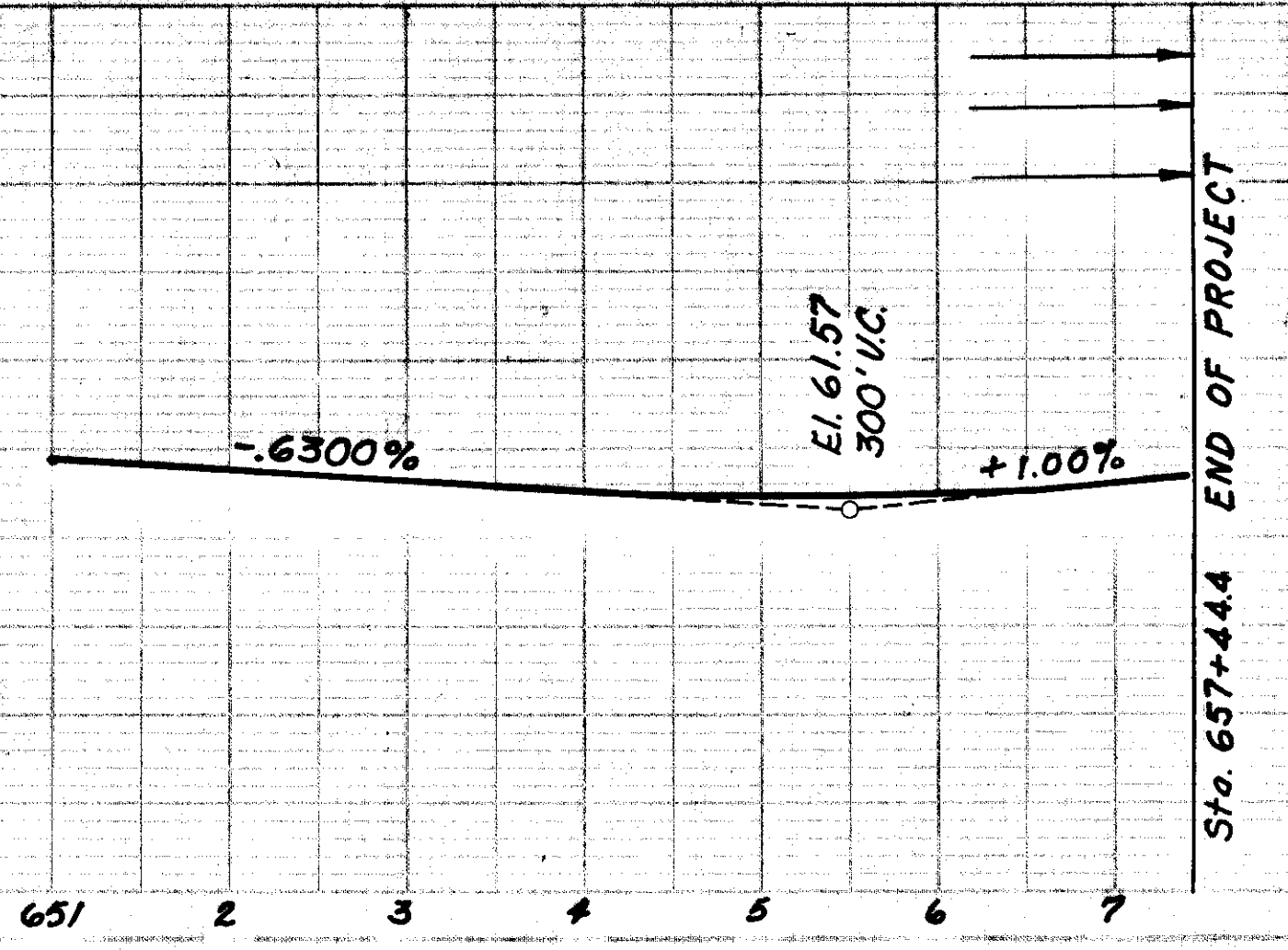
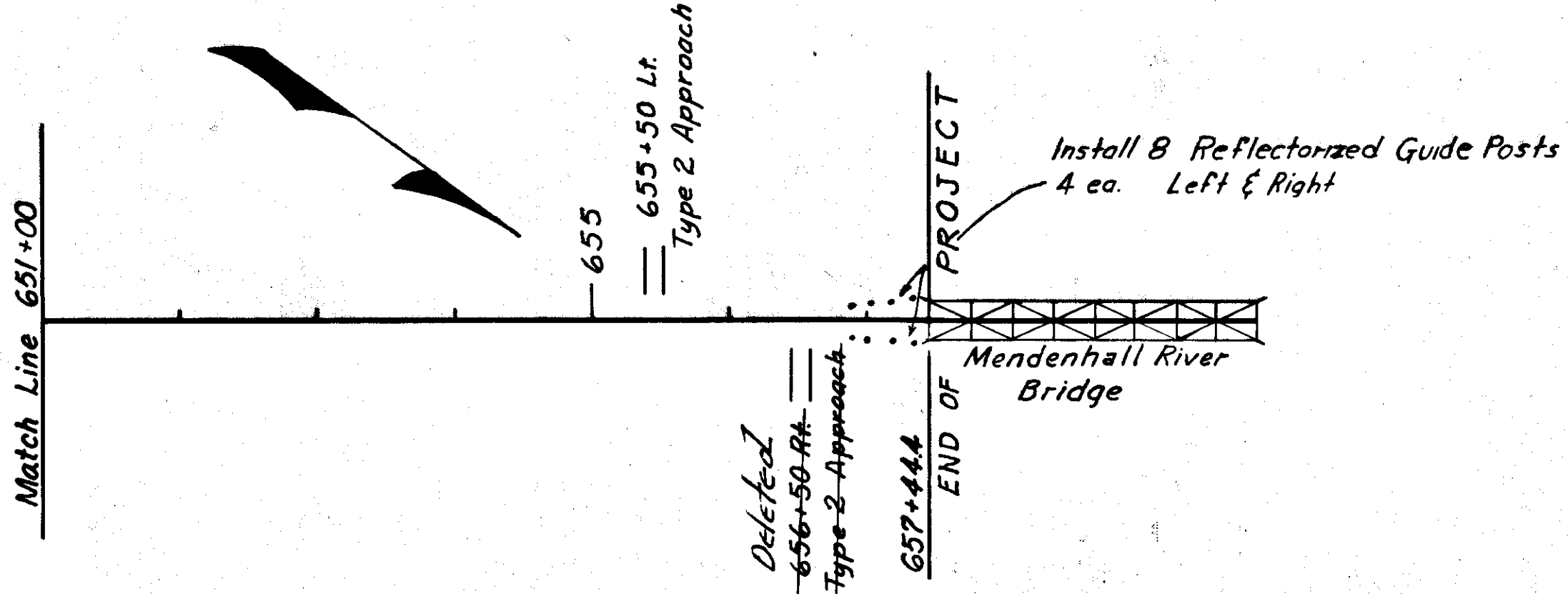
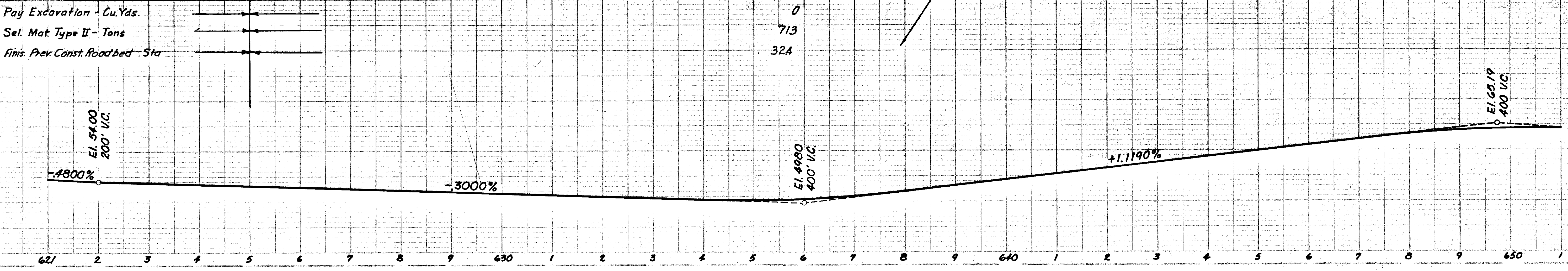
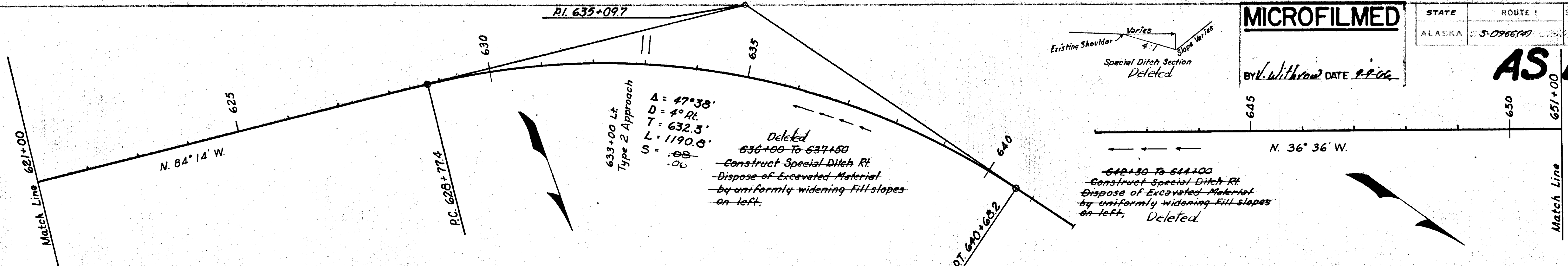

1-1

PLATE 2 - PLAN - PROFILE OF P.R. & R.E. STANDARD
K.R. & G.O., NO. 348-20
KREFFEL & ESSER CO., NEW YORK

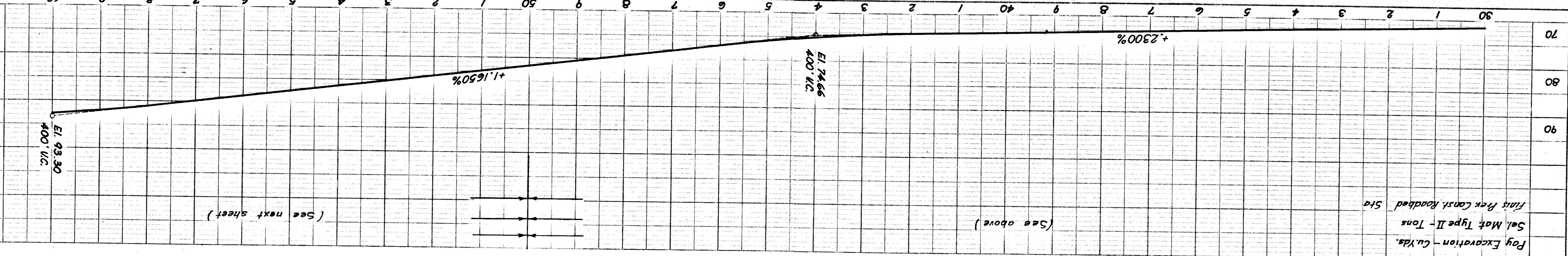

Pay Excavation - Cu Yds.
Sel. Mat. Type II - Tons
Finis Prev Const. Roadbed Sta

(See above)

(See next sheet)

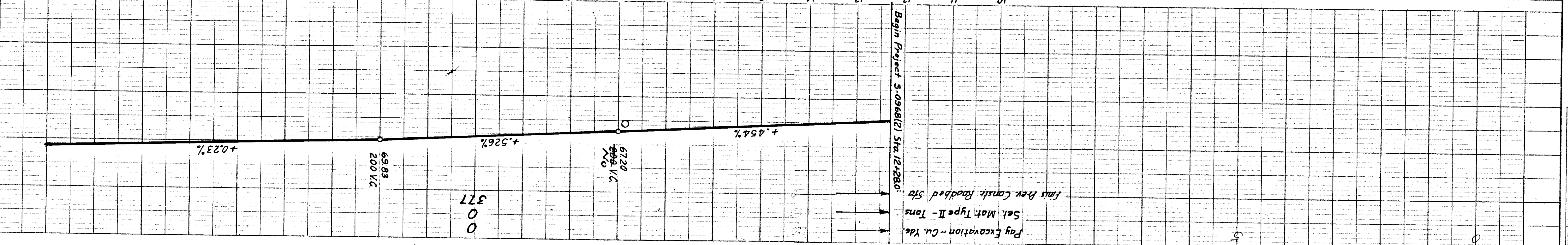
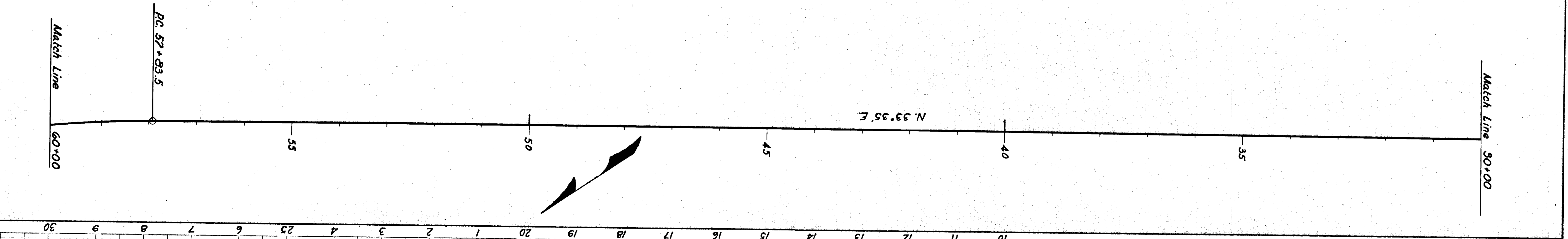

Pay Excavation - Cu Yds.
Sel. Mat. Type II - Tons
Finis Prev Const. Roadbed Sta

371

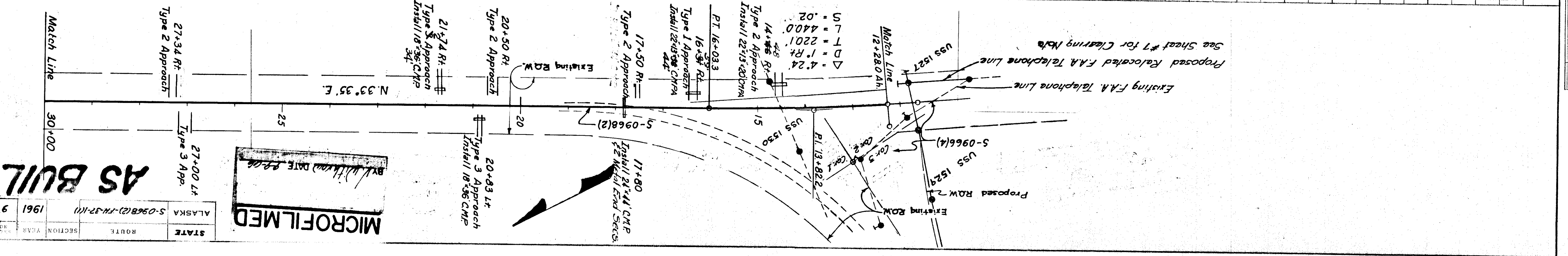

Proposed Relocated F.A. Telephone Line
See Sheet #7 for Clearing Note

Existing F.A. Telephone Line

Proposed ROW 2
USS 1529
5-0966(4)

17+80
Install 24"x44" CMP
22 Metal End Secs.

20+83 Lt
Type 3 Approach
Install 18"x36" CMP

21+74 Rt
Type 3 Approach
Install 18"x36" CMP

Existing ROW

MICROFILMED
BY *[Signature]* DATE *[Date]*

27+00 Lt
Type 3 App.

27+34 Rt
Type 2 Approach

STATE	ALASKA
ROUTE	S-0968(2)-FM-32-1(1)
SECTION	9
YEAR	1961

AS BUILT

MICROFILMED

STATE	ROUTE	SECTION	YEAR	SHEET NO.	TOT. SHEETS
ALASKA	S-0968(2)-FR-37(17)		1961	10	23

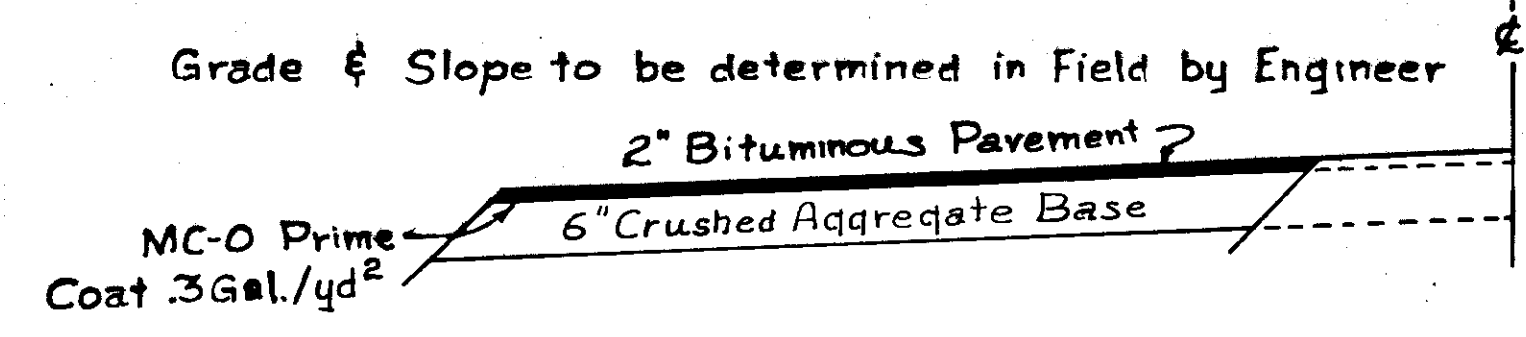
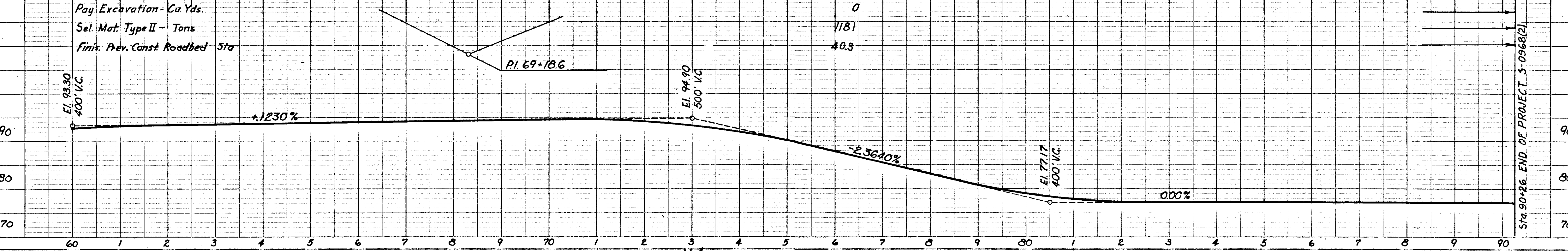
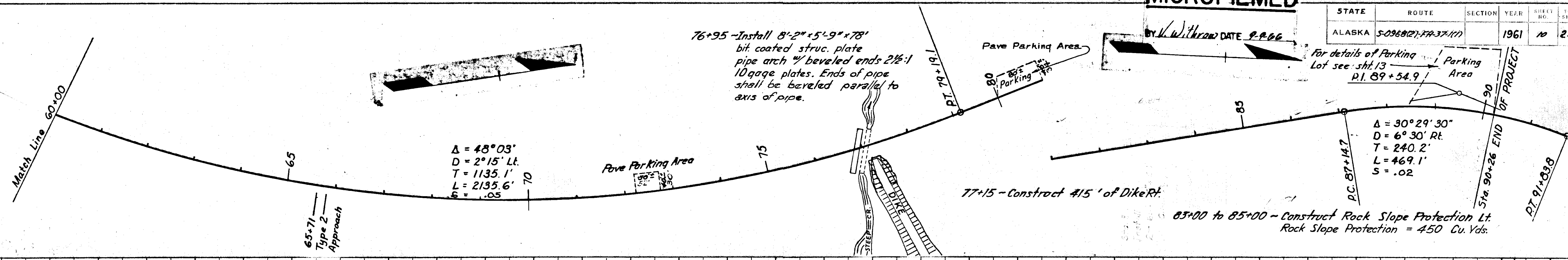

PARKING AREA DETAILS
(Not to Scale)
Approx. Sta. 80+30 & 72+30

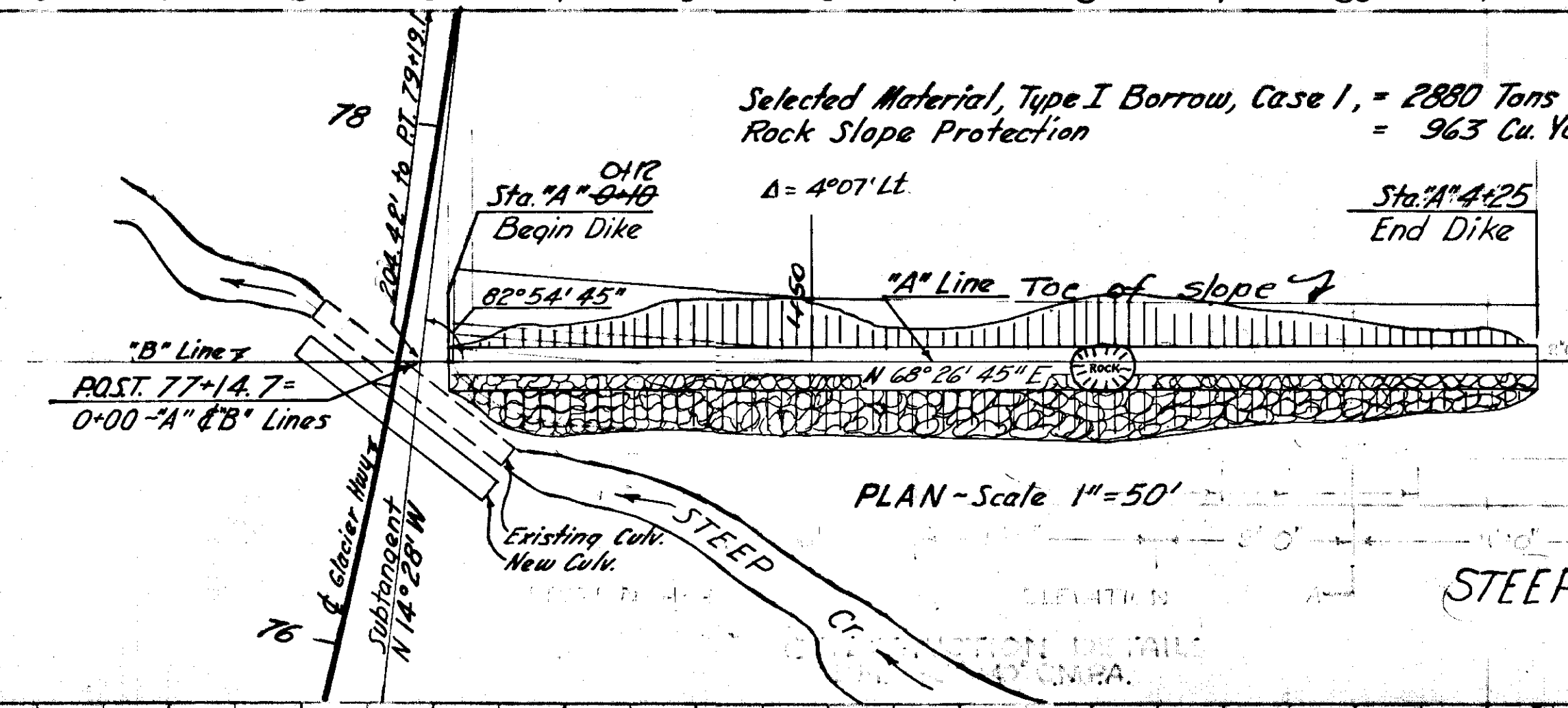

STEEP CREEK DIKE DETAILS

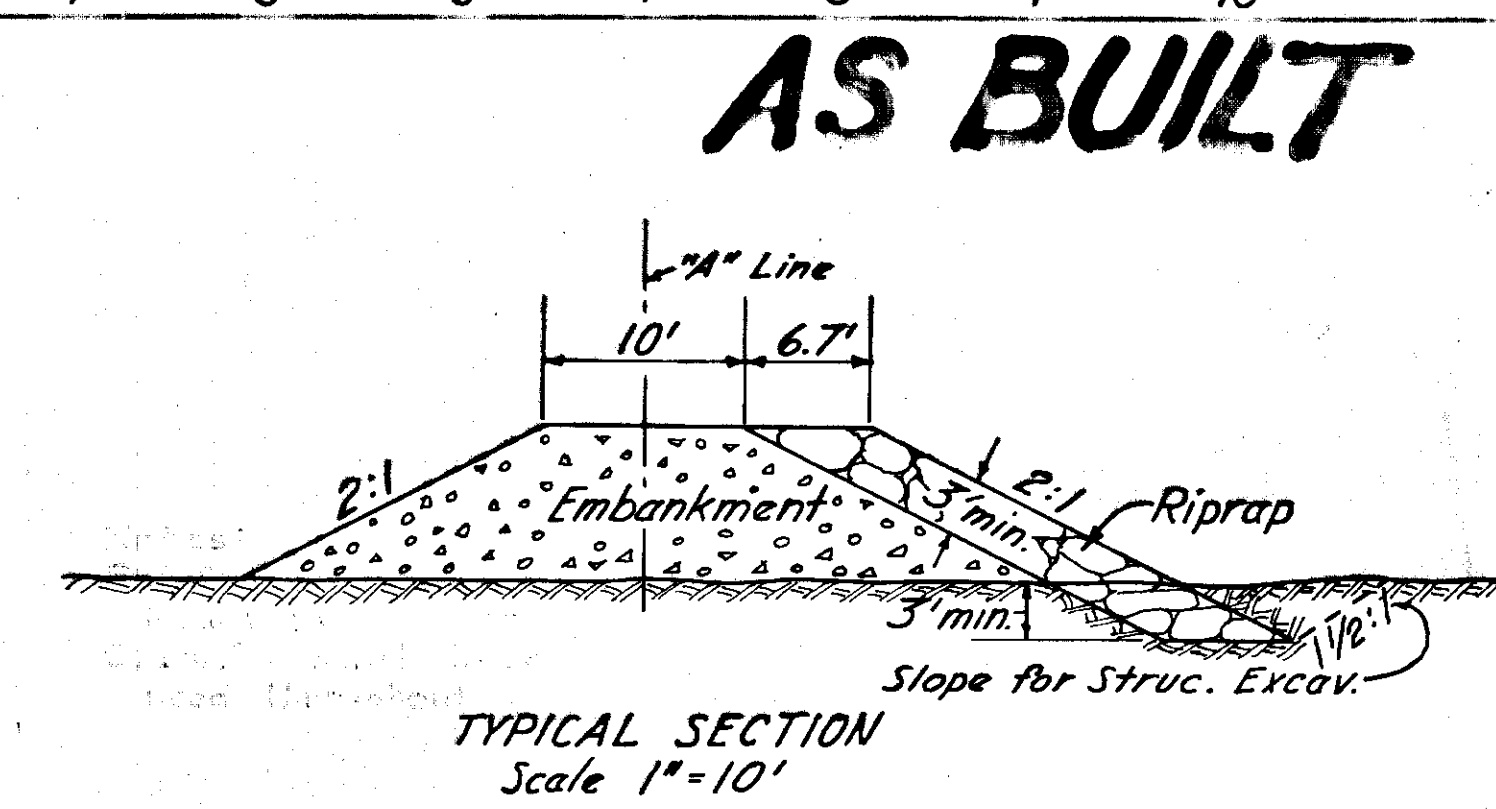

TYPICAL SECTION
Scale 1" = 10'

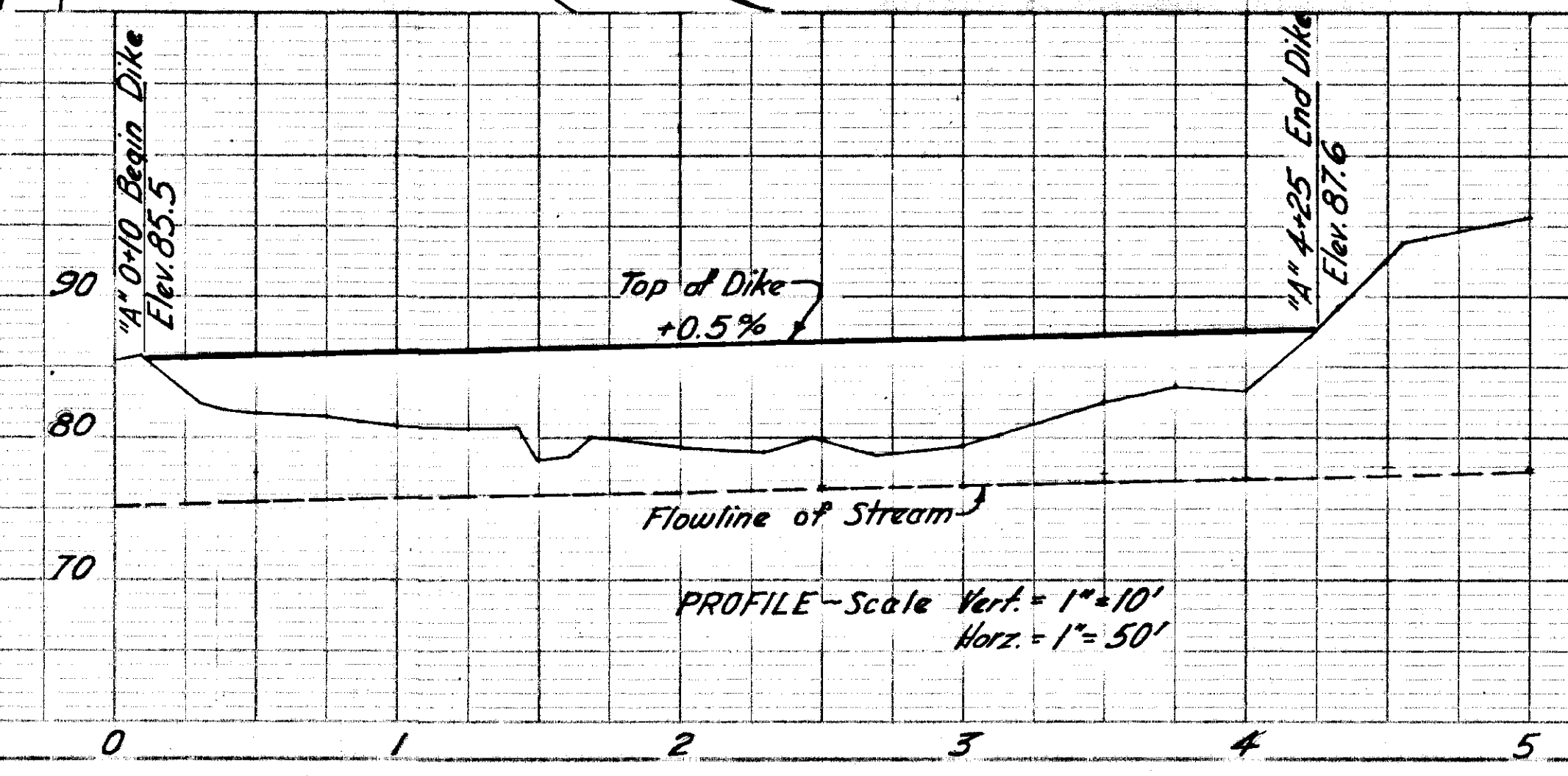

STATE	PROJECT DESIGNATION	YEAR	SHEET NO.	TOTAL SHEETS
ALASKA	S-0966(A)	1962	11	23

ACCESS ROAD

AS BUILT MICROFILMED

DATE 9-9-62

TYPICAL SECTION

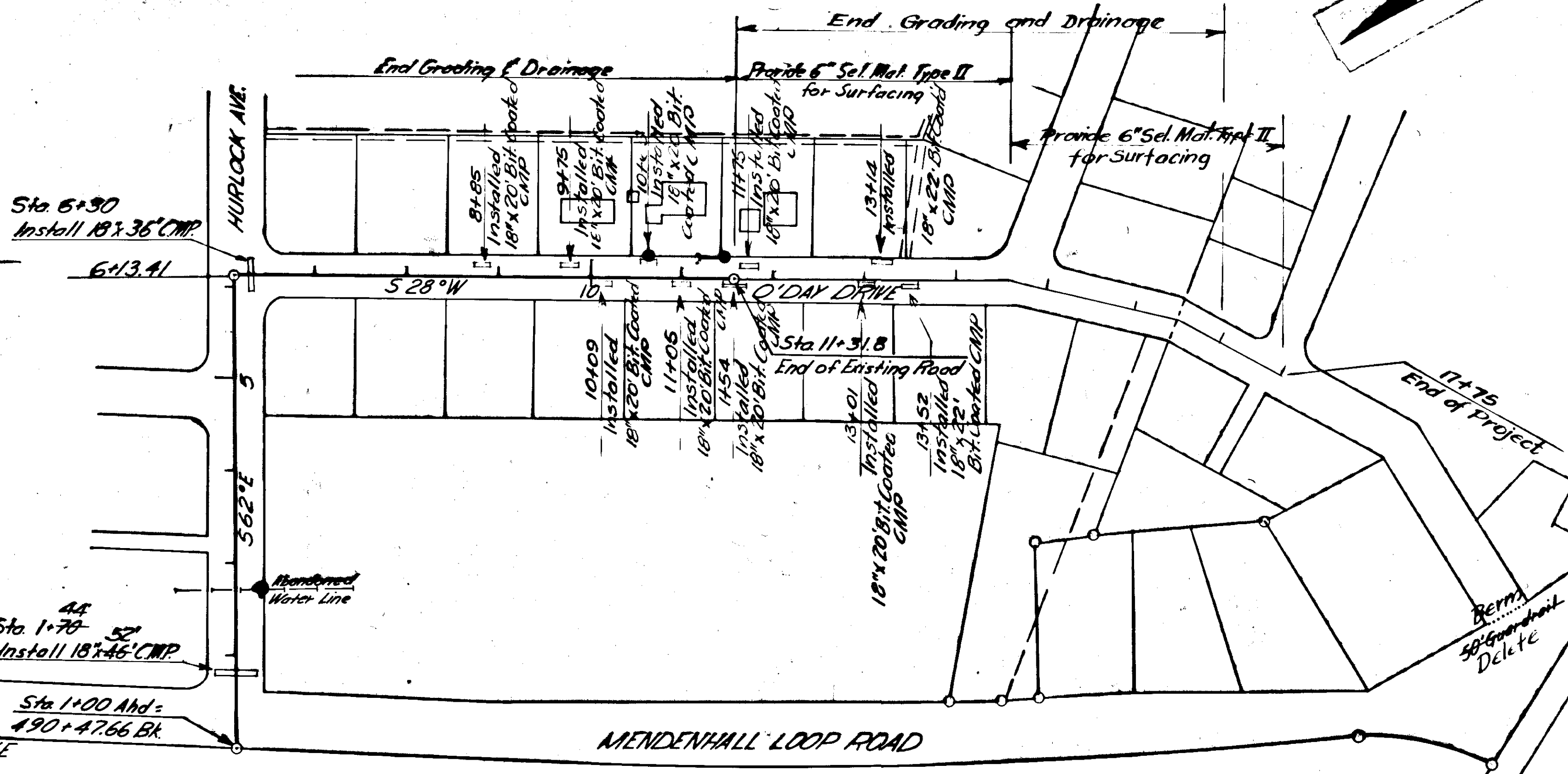
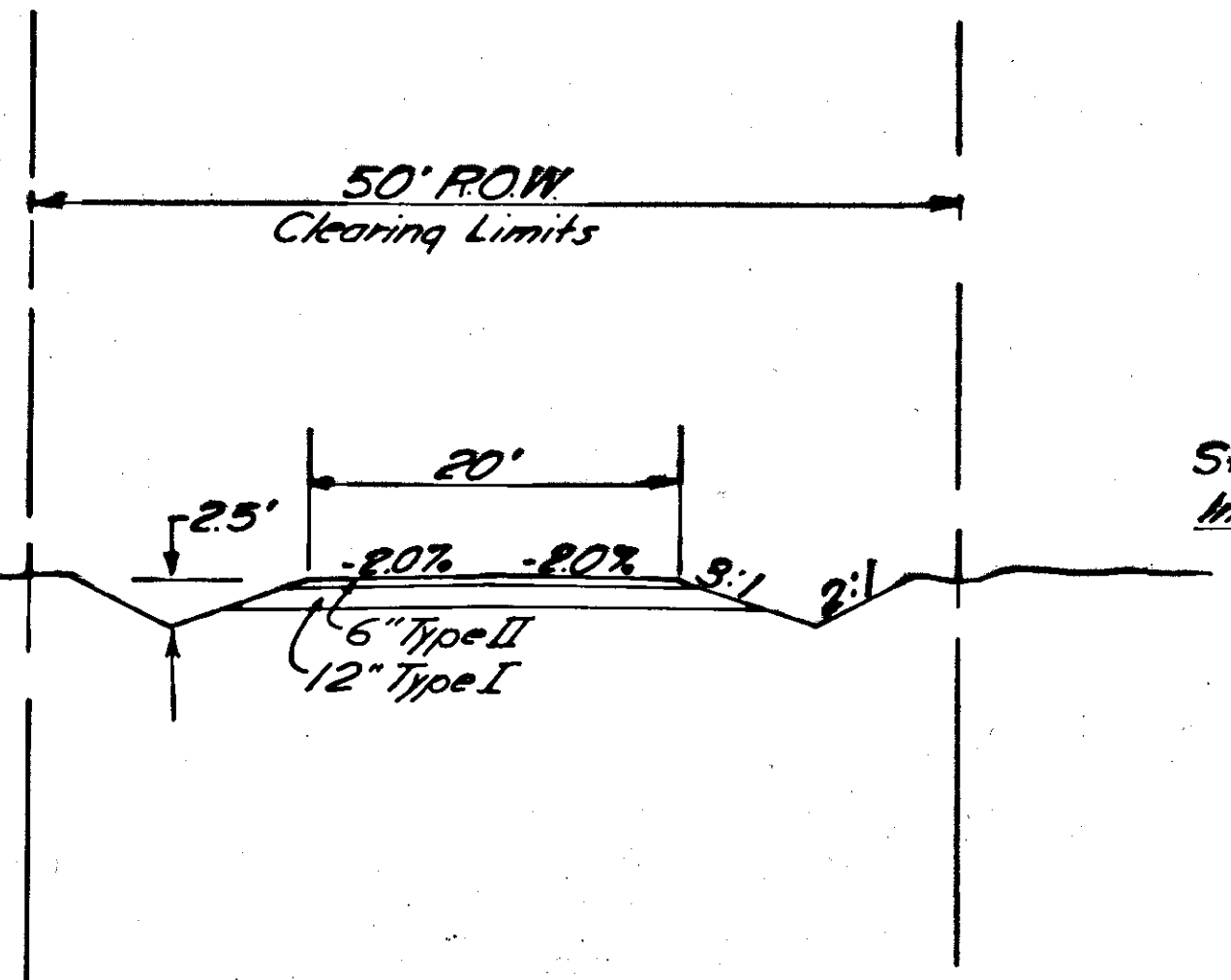

ACCESS ROAD ESTIMATE OF QUANTITIES

ITEM NO.	QUANTITY	UNIT	ITEM
100(3)	1.08	Acre	Clearing & Grubbing
102(1)	2190	Cu.Yd.	Unclassified Excavation
102(6a)	1924	Ton	Selected Material, Type I Borrow, Case I
102(6a)	1034	Ton	Selected Material, Type II Borrow, Case I
103(1)	16	Cu.Yd.	Excavation for Structures
453(1E)	82	Lin Ft.	18" Galvanized Corrugated Metal Pipe

These quantities are included in the Estimate of Quantities for S-0966(A) on Sheet #2

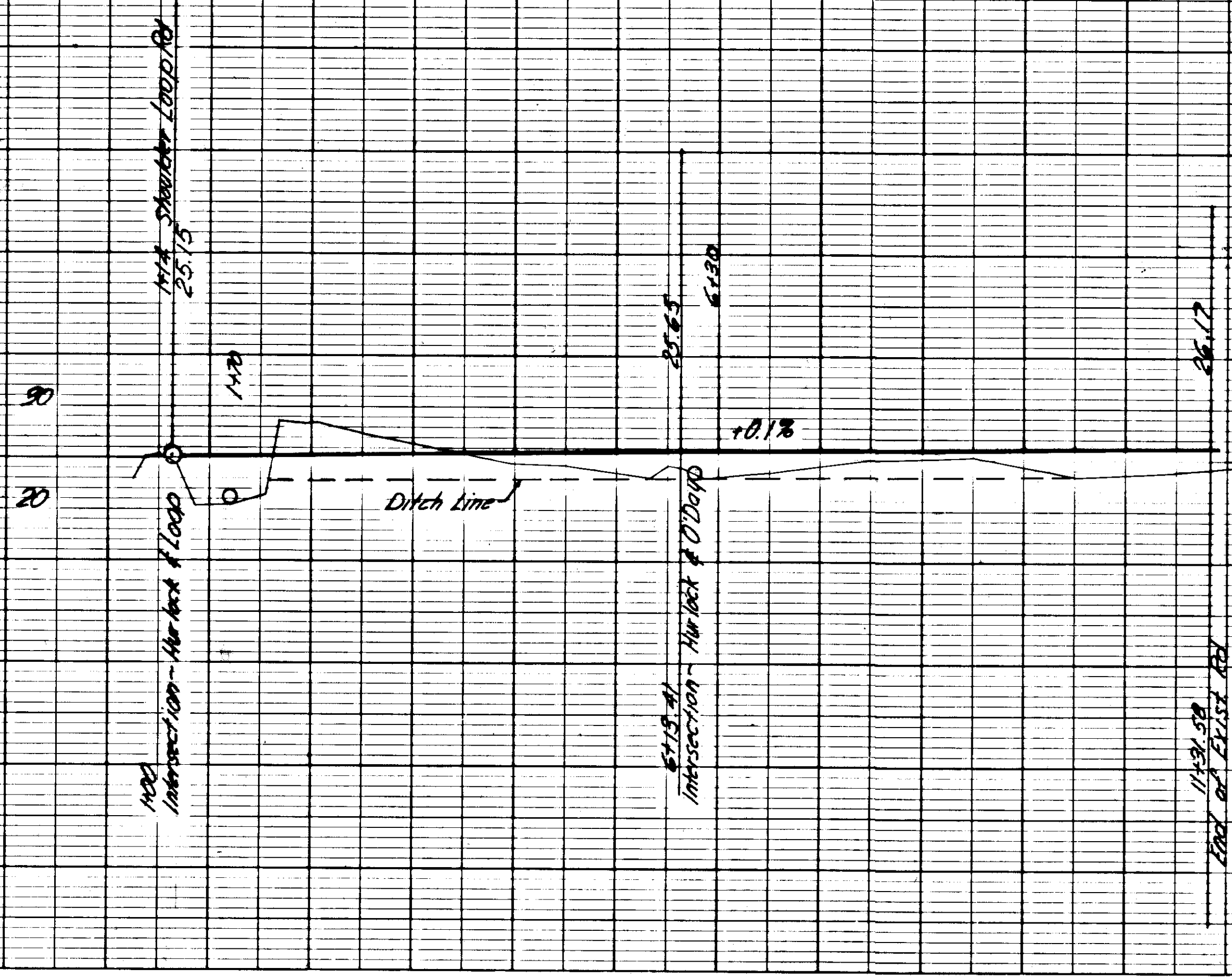

STATE	ROUTE	SECTION	YEAR	SHEET NO.	TOTAL SHEETS
ALASKA	5-0966(A)		1962	12	23

AS BUILT

MICROFILMED

By *V. J. ...* DATE 9-9-66

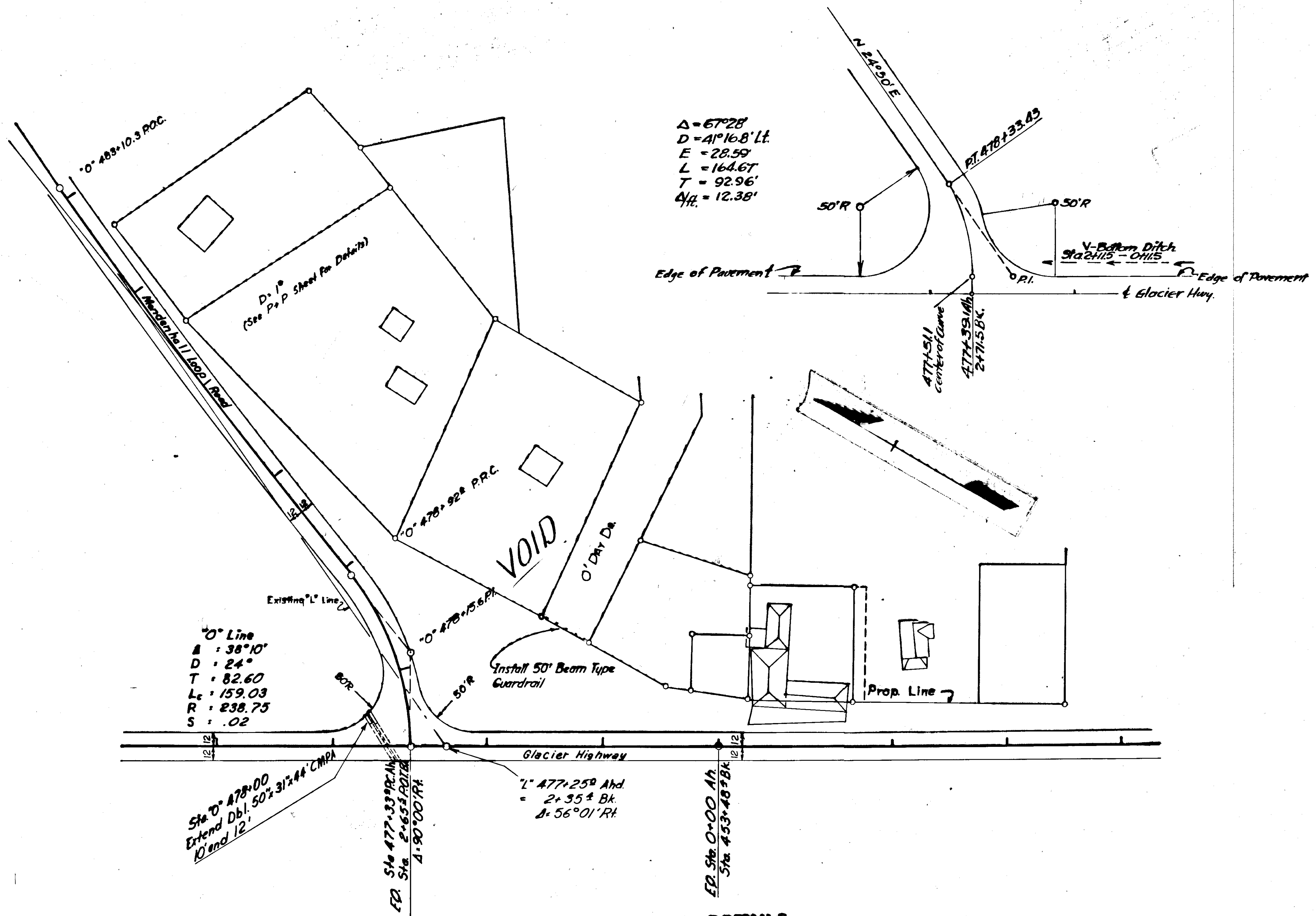

INTERSECTION DETAILS
Glacier Hwy, Mendenhall Loop Rd.

AS BUILT
MICROFILMED

DATE 9-2-66

PARKING LOT QUANTITIES

Item No.	Quantity	Unit	Item
453 (10)	78	Lin. Ft.	12" Galvanized Corrugated Metal Pipe.
521 (2)	4	Each	Inlets.
521 (5)	4	Pair	Metal Frames and Gratings.
524 (3)	542	Lin. Ft.	Concrete Curb and Gutter, 6 inch depth.

These quantities are included in the Estimate of Quantities for 5-0968(2)-FH-37-1(1) on Sheet #2.

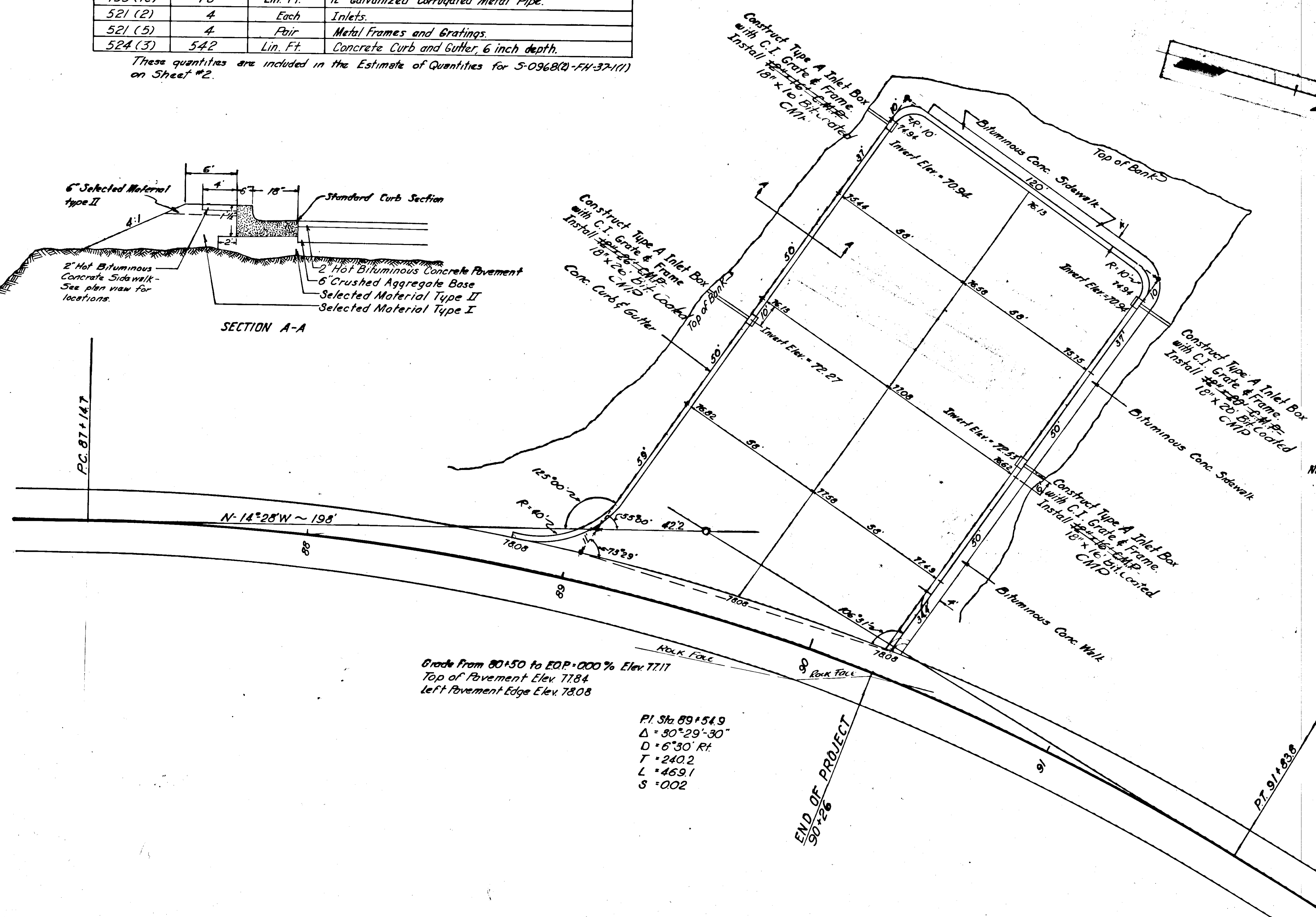
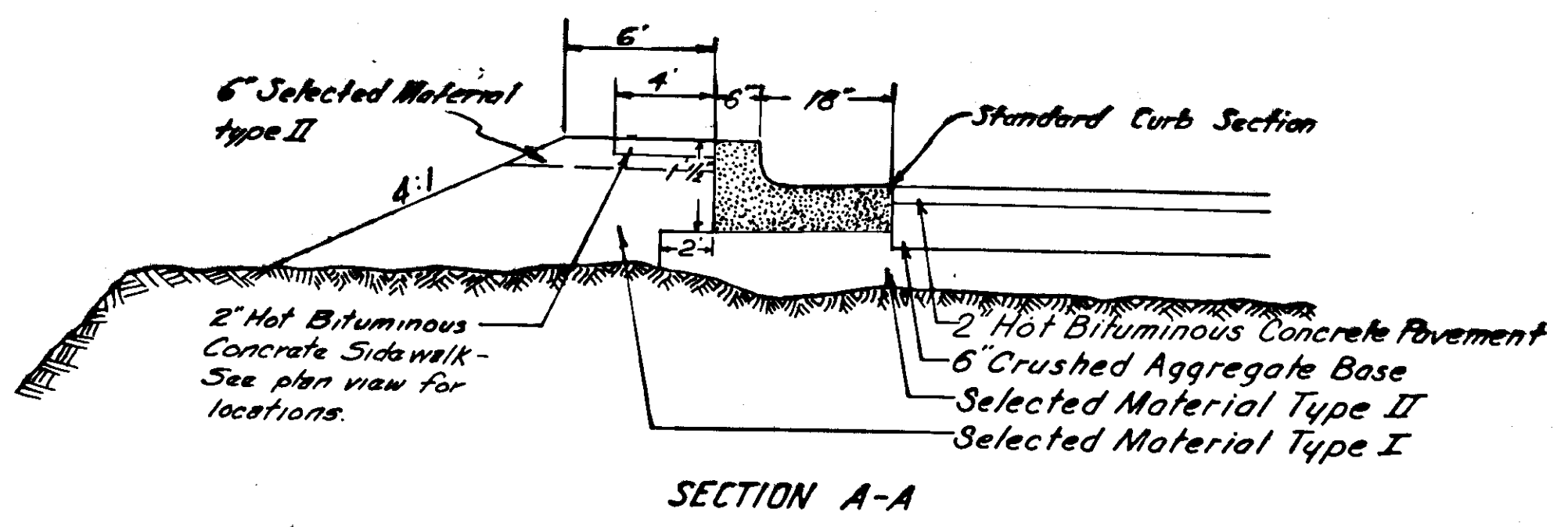

NOTE: 1. Drains shall have a minimum grade of 2%.
2. Expansion joints shall be installed at 50' minimum intervals in the curb.
3. Elevations shown are top of bituminous pavement.