

**STATE OF ALASKA
DEPARTMENT OF TRANSPORTATION
&
PUBLIC FACILITIES**

**PLAN AND PROFILE
PROPOSED HIGHWAY PROJECT
HES-093-3(2)-69054
EAGLE BEACH
OBSTACLE REMOVAL
ROCK EXCAVATION**

| | | | |
|--------|--------------|-----------|--------------|
| STATE | PROJECT | SHEET NO. | TOTAL SHEETS |
| ALASKA | HES-093-3(2) | 1 | 3 |

| SHEET NO. | INDEX OF SHEETS |
|-----------|----------------------|
| 1 | TITLE SHEET |
| 2 | PLAN & PROFILE SHEET |
| 3 | TRAFFIC CONTROL PLAN |
| | |
| | |
| | |

The following Standard Drawings apply to this project:
A-1, C-01.02, C-02.00, C-03.01, S-00.00, S-05.00, S-20.00
S-30.01

DESIGN DESIGNATION

| | | |
|----------|---|-----|
| ADT 1986 | = | 140 |
| ADT 2007 | = | 260 |
| DHV 17% | = | 45 |
| %T | = | 7% |
| TI | = | 5.5 |

"AS-BUILT"

CONTRACTOR: CHANNEL CONSTRUCTION, INC.
PROJECT ENGINEER: PHIL SPEER
CONSTRUCTION BEGAN: MAY 12, 1987
CONSTRUCTION COMPLETED: JUNE 12, 1987

Shilly R. Speer EES 8/17/87

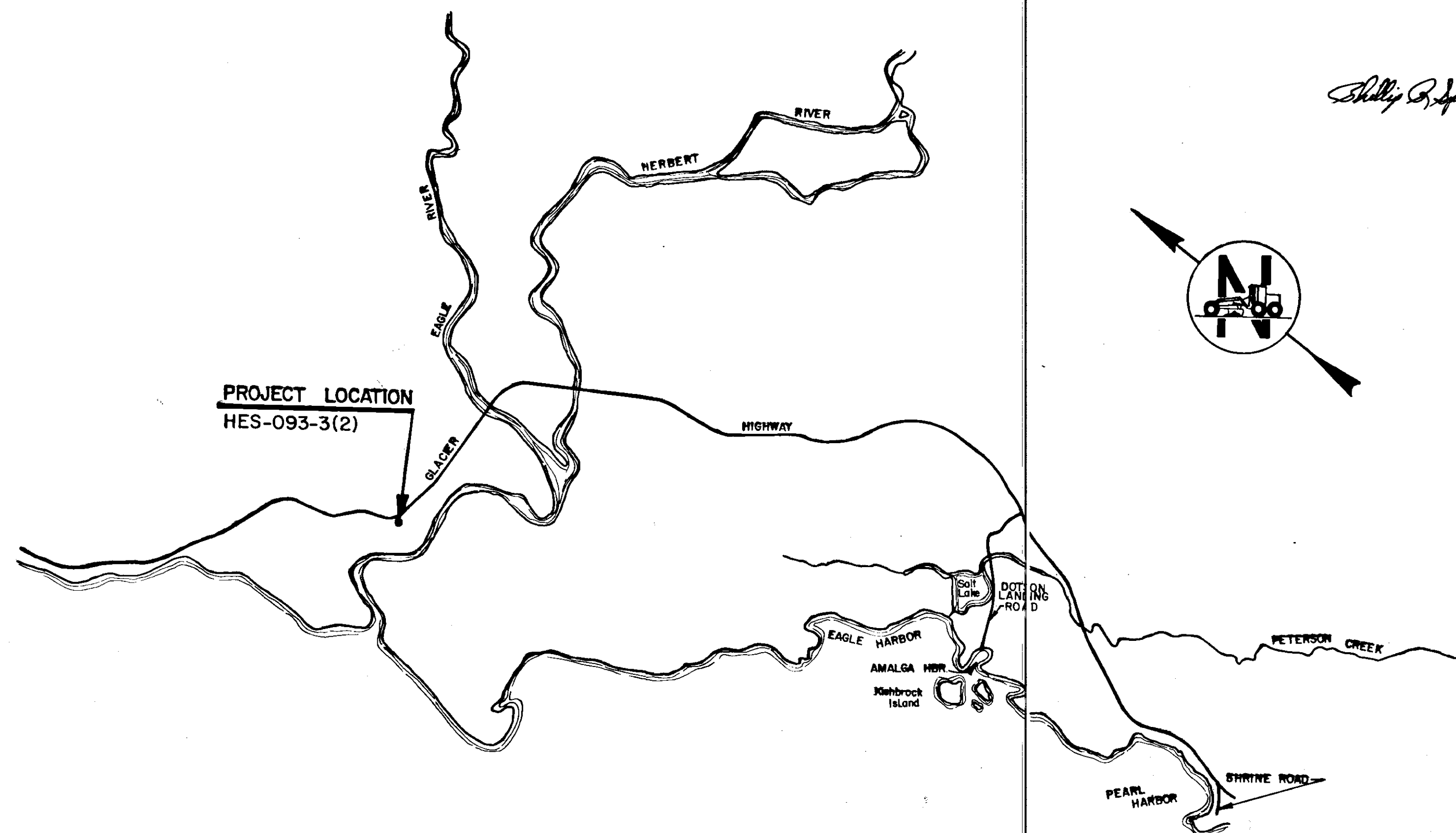

STATE OF ALASKA
DEPARTMENT OF TRANSPORTATION
&
PUBLIC FACILITIES

APPROVED
Walter Kurzman DATE 9/10/86
S. E. Region, Design Chief

STATE OF ALASKA
DEPARTMENT OF TRANSPORTATION
&
PUBLIC FACILITIES

APPROVED
Phil Speer Date 9-10-86
S.E. Region, Director, Design & Construction

ESTIMATE OF QUANTITIES

| ITEM NO. | ITEM | UNIT | QUANTITY |
|----------|--|------|-------------|
| 109 (2) | DBE and WBE Adjustments | CS | All Req'd |
| 110 (2) | Mobilization and Demobilization | LS | " |
| 111 (1) | Temporary Erosion and Pollution Control | CS | " |
| 114 (1) | Construction Surveying by the Contractor | LS | " |
| 115 (1) | Traffic Maintenance | LS | " |
| 203 (2) | Rock Excavation | CY | 4600.5322.9 |
| 615 (1) | Standard Sign | SF | 24 |

SIGNING SCHEDULE

| NO. | STATION | DIST. FROM E | | CODE NO. | LEGEND | SIZE | AREA S.F. | NO. OF POSTS | LENGTH | EMBED. | FACING TRAFFIC |
|-----|---------|--------------|-----|----------|----------------|-------|-----------|--------------|--------|--------|----------------|
| | | LT. | RT. | | | | | | | | |
| 1. | 1017+56 | 20' | | W13-1 | 40 M.P.H. | 24x24 | 4.0 | | | | N.B. |
| 2. | 1020+74 | 20' | | W1-B | Chevron (Sym.) | 24x30 | 10.0 | 1 | 15' | 3' | N.B., S.B. |
| 3. | 1027+18 | " | " | " | " | " | " | " | " | " | " |

GENERAL SIGNING NOTES

1. Sign locations and post lengths are approximate and are subject to minor revision.
2. All sign posts shall be telescoping perforated galv. square steel tube. The 2" size shall be used above ground and the 2 1/4" size shall be used below for sleeve.
3. All signs shall be .080" thick.
4. All signs shall be installed with sleeve-type embed, in accordance with Std. Dwg. S-30.01 except that the 2 1/4" sleeve shall be used for the entire embed. depth.

Horizontal Control is based on a Pk. nail at P.C. 1020+59.12 and splitting the pavement of the back tangent.

Vertical Control is based on a brass cap monument set in the South end of the Eagle River Bridge with an Elev. of 36.65.

| STATE | PROJECT DESIGNATION | YEAR | SHEET NO. | TOTAL SHEETS |
|--------|---------------------|------|-----------|--------------|
| ALASKA | HES-093-3(2) | 1986 | 2 | 3 |

GENERAL NOTES

- 1) Grades and Alignment as shown on the plans are subject to minor revision.
- 2) Clearing and Grubbing will not be measured for payment but will be considered incidental to other items of work.
- 3) One lane of traffic shall be maintained at all times. Detours around the work area shall be in accordance with Standard Drawing C-03.01, Two lane roadway - Single lane closure, Typical lane closure - short duration.
- 4) Based on original ground cross-sections, approximately 50 C.Y. of crushed agg. base will be required to construct the shoulder and foreslope as detailed. Labor and materials required for this work will not be measured for payment but will be considered incidental to other items of work.
- 5) At approx. station 1008+00 a site is available to the contractor for disposition of excavated rock. The site is available for the deposition of rock only. All excavated material shall become the property of the contractor and disposed of at a site selected by the contractor and approved by the engineer.
- 6) The contractor will be responsible for the removal of fly-rock from the adjacent wetlands. Rock pieces in excess of 100 lbs. shall be retrieved, by the use of rubber-tired equipment only, at the direction of the engineer. This work will not be measured for payment but will be considered incidental to other items of work.

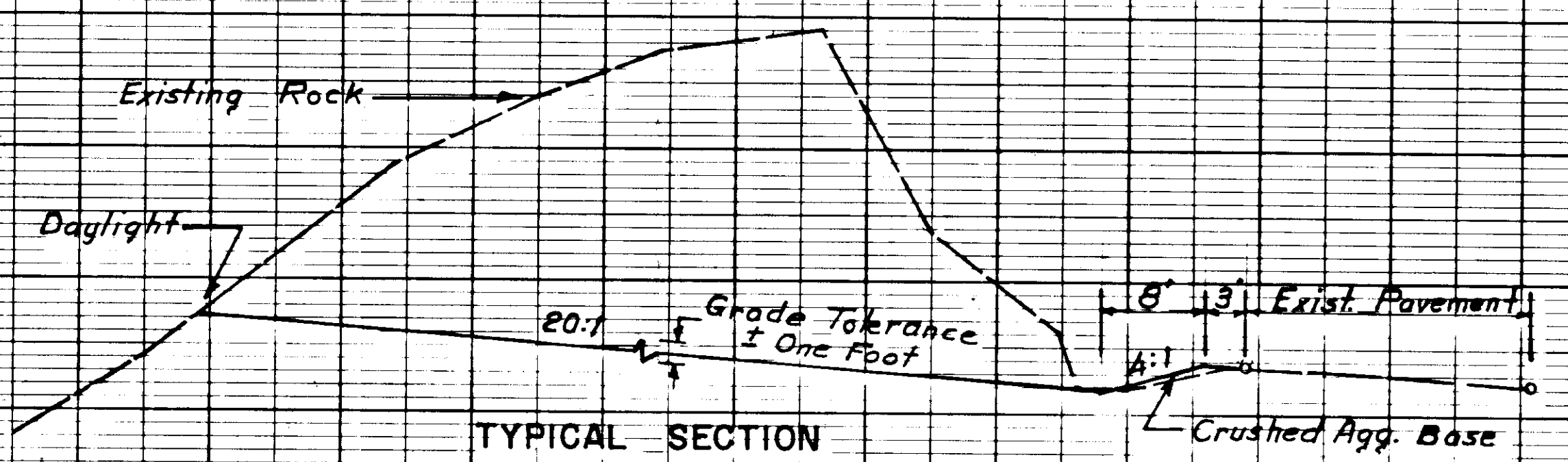
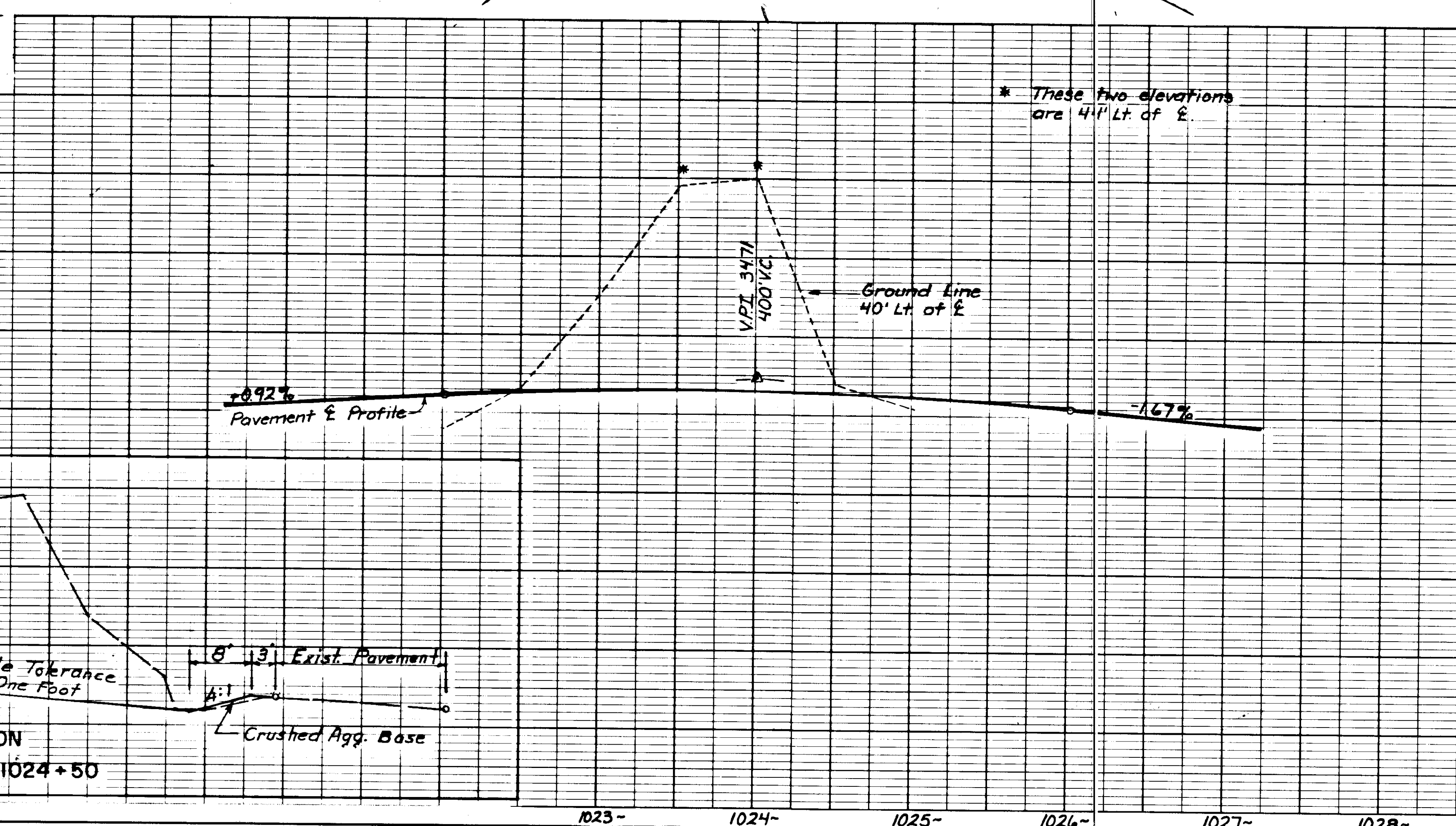
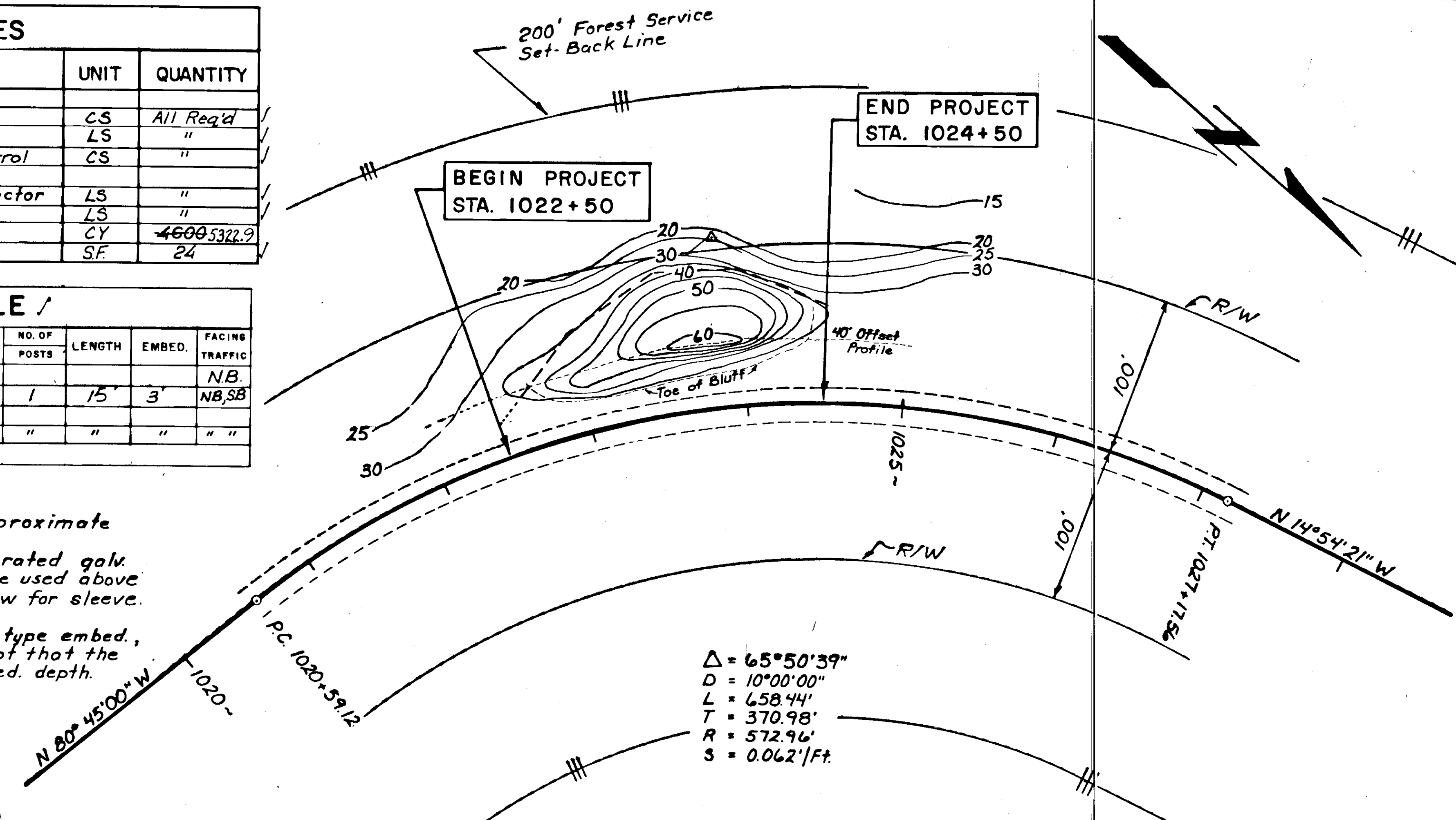

TYPICAL SECTION
Station 1022+50 to 1024+50

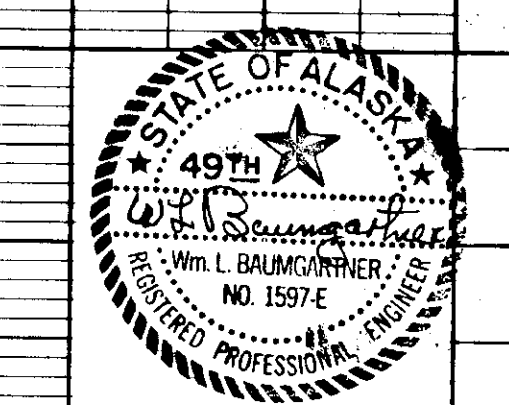

TRAFFIC CONTROL PLAN

- CONSTRUCTION SIGNING, FLAGGING, DETOURS, AND GENERAL TRAFFIC CONTROL FEATURES SHALL CONFORM TO THE GUIDELINES SET FORTH IN THE "C" SERIES STANDARD DRAWINGS AND THE APPLICABLE PORTIONS OF SECTION 107 AND SECTION 115 OF THE SPECIFICATIONS, THE ALASKA TRAFFIC MANUAL, AND THE MANUAL OF UNIFORM TRAFFIC CONTROL DEVICES.
 - THE CONTRACTOR SHALL SPECIFY IN WRITING TO THE ENGINEER, WHICH EMPLOYEE HE HAS DESIGNATED THE RESPONSIBILITY OF INSTALLING AND MAINTAINING ALL REQUIRED TRAFFIC CONTROL DEVICES, AND HOW THE DESIGNEE CAN BE CONTACTED AT ANY TIME OF THE DAY. ALL TRAFFIC CONTROL ELEMENTS SHALL BE MAINTAINED 24 HOURS A DAY.
 - ALL WORK INVOLVED WITH THE INSTALLATION, REMOVAL, AND MAINTENANCE OF CONSTRUCTION SIGNS SHALL BE PAID FOR UNDER ITEM 115(1), TRAFFIC MAINTENANCE.
 - ALL TYPE I OR TYPE II BARRICADES SHALL HAVE MOUNTABLE TYPE "B" HIGH INTENSITY FLASHING WARNING LIGHTS AS REFERRED TO IN SECTION 6E-5 OF THE MANUAL OF UNIFORM TRAFFIC CONTROL DEVICES.
 - THE PROJECT IDENTIFICATION SIGNING SHALL BE AS PER THE MANUAL OF UNIFORM TRAFFIC CONTROL DEVICES.
 - SIGNING SHALL BE IN PLACE ONLY WHEN THE CONDITIONS EXIST FOR WHICH THE SIGNS ARE INTENDED.
 - THE CONTRACTOR SHALL KEEP THE ROADWAY IN A SAFE AND TRAVERSABLE CONDITION AS DIRECTED BY THE ENGINEER.
 - A MINIMUM ROADWAY WIDTH OF 20' SHALL BE MAINTAINED FOR 2-WAY TRAFFIC, AND A WIDTH OF 10' SHALL BE MAINTAINED FOR 1-WAY TRAFFIC.
 - THE FOLLOWING ROAD CLOSURE SHALL BE IMPLEMENTED FOR TRAFFIC CONTROL FOR BLASTING:
 - THE ROADWAY MAY BE CLOSED 10 MINUTES PRIOR TO A BLAST. IF THE BLAST IS NOT MADE WITHIN THIS 10 MINUTE TIME FRAME, THE ROADWAY SHALL BE RE-OPENED ALLOWING BOTH LANES TO CLEAR OF TRAFFIC.
 - AFTER A BLAST, THE CONTRACTOR SHALL WORK TOWARDS OPENING ONE LANE OF TRAFFIC. UPON OPENING ONE LANE, BOTH NORTHBOUND AND SOUTHBOUND TRAFFIC SHALL BE ALLOWED THROUGH THE CONSTRUCTION SITE ONE TIME EACH.
 - AFTER THE TRAFFIC IS INITIALLY CLEARED EACH WAY THROUGH THE CONSTRUCTION SITE, THE CONTRACTOR MAY ONCE AGAIN COMPLETELY CLOSE THE ROADWAY FOR A MAXIMUM OF 30 MINUTES. AT THE END OF THIS PERIOD, BOTH LANES OF TRAFFIC SHALL ONCE AGAIN BE CLEARED. THIS CYCLE SHALL BE CONTINUED UNTIL THE TRAVELING PUBLIC HAS FULL AND UNRESTRICTED USE OF THE FACILITY.
 - THE TIME THAT THE CLOSURE STARTED AND THE TIME THAT THE ROADWAY WILL OPEN FOR TRAFFIC (ONE-WAY OR TWO-WAY) SHALL BE POSTED AT THE SITE OF THE CLOSURE IN VIEW OF THE TRAVELING PUBLIC.
- THE 30 MINUTE CLOSURE MAY BE ADJUSTED BY THE PROJECT ENGINEER.

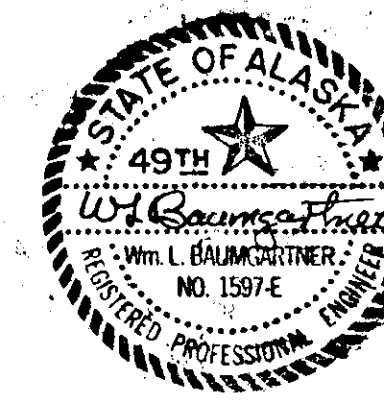

| CONSTRUCTION ZONE SIGN SCHEDULE | | | |
|---------------------------------|----------|---|------------------------|
| SIGN NO. | CODE NO. | LEGEND | SIZE |
| ① | CW20-1E | Road Construction 1500 feet | 48" x 48" |
| ② | CW20-3A | Road Closed 500 feet | 48" x 48" |
| ③ | CW20-4 | One Lane Road 1000 feet | 48" x 48" |
| ④ | CW20-7A | Symbol of Flagman Supplemental Plate 500 feet | 36" x 36" 24" x 18" |
| ⑤ | CW22-1 | Blasting Zone 1000 feet | 48" x 48" |
| ⑥ | CW22-2 | Turn off two-way radio | 42" x 36" |
| ⑦ | CW22-3 | End Blasting Zone | 42" x 36" |
| ⑧ | G20-1 | Road Construction next miles | 60" x 36" |
| ⑨ | G20-2 | End Construction | 60" x 24" |

NOTE: Other signs may be required by the engineer or used at the contractor's option.

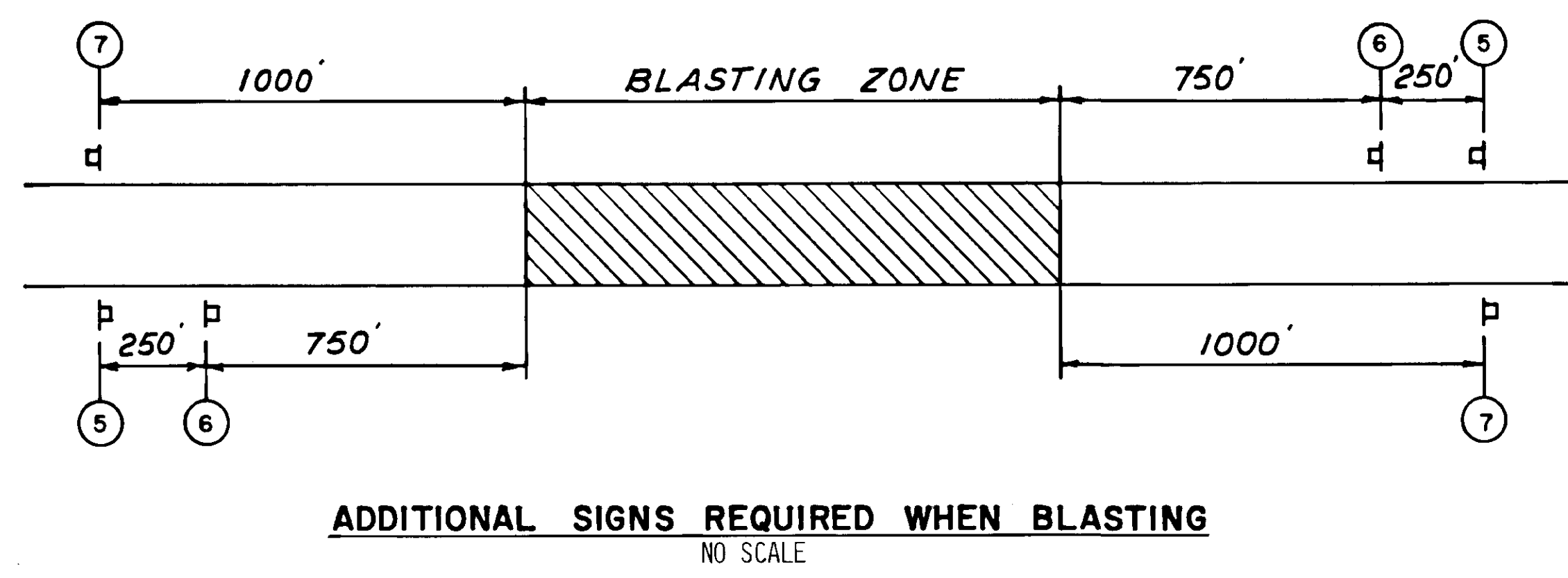
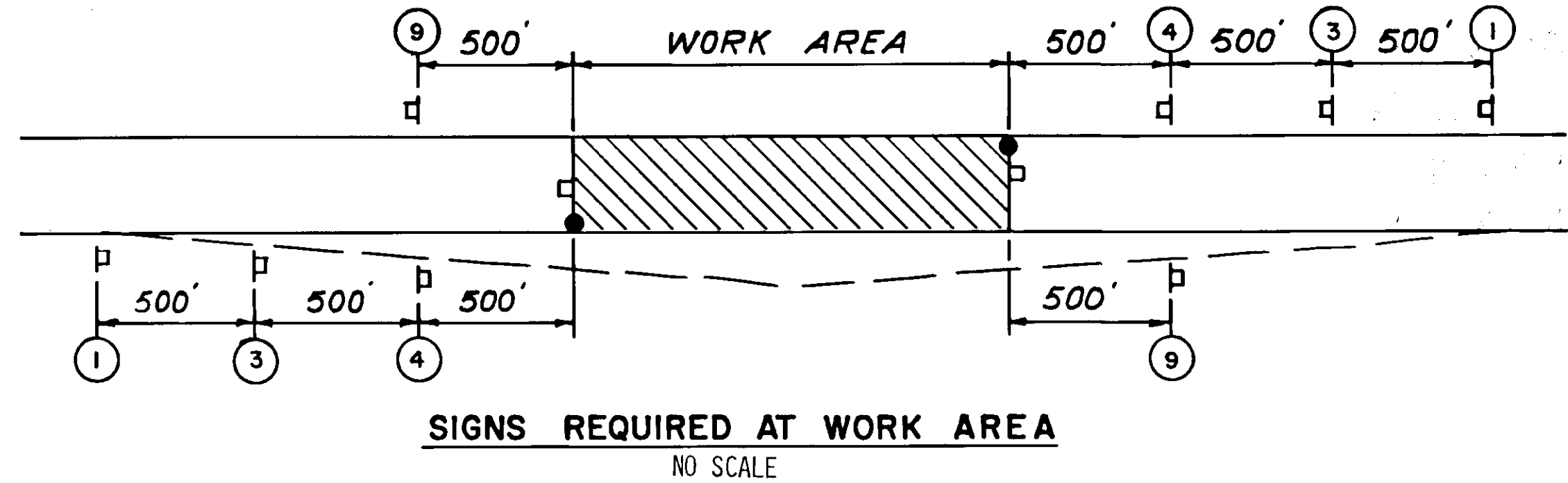
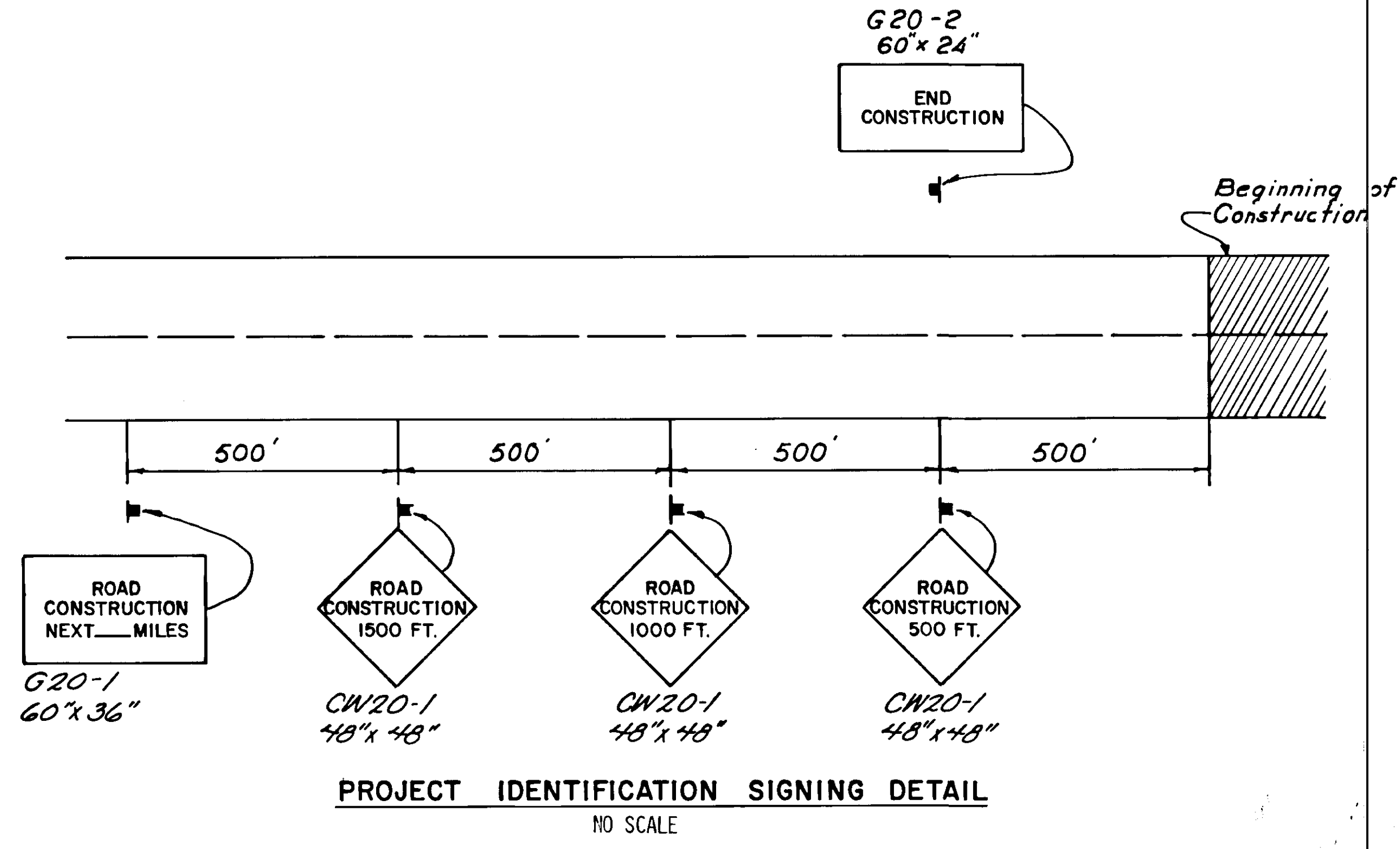

- LEGEND**
- - Flag Person Station
 - - Fixed Sign
 - - Portable Sign
 - ① - Sign no, See Sign Schedule above

8/17/87