

STATE OF ALASKA  
 DEPARTMENT OF TRANSPORTATION  
 AND  
 PUBLIC FACILITIES  
 SOUTHEAST REGION  
 DESIGN AND CONSTRUCTION DIVISION  
**HAINES, ALASKA**

**MUD BAY ROAD  
 REPAVING  
 PROJECT NO. STP-0987(6)  
 (71358)  
 PAVING & DRAINAGE**

INDEX OF SHEETS	
SHEET NO.	DESCRIPTION
1	TITLE SHEET
2	TYPICAL SECTIONS
3	ESTIMATE OF QUANTITIES
4	TRAFFIC CONTROL PLAN
5	MISCELLANEOUS DETAILS
6	MISCELLANEOUS SUMMARIES
7-9	SIGNING SUMMARY SHEETS
10-12	PLAN SHEETS

THE FOLLOWING STANDARD DRAWINGS APPLY TO THIS PROJECT:

A-1	C-01.03	C-02.01	C-03.01	C-04.00	D-01.02	D-04.10
D-05.10	D-06.01	D-20.02	D-24.00	D-26.01	D-27.01	G-04.04S
G-04.05W	G-14.04W	G-18.00S	G-18.00W	I-20.11		M-13.01
M-16.01	M-20.11	M-23.11	S-00.00	S-05.00	S-20.00	S-30.01
T-21.01						

**METRIC**  
 DIMENSIONS ARE IN METERS AND/OR  
 MILLIMETERS UNLESS OTHERWISE SHOWN.

**"AS - BUILTS"**

CONTRACTOR: Northern Timber Corp.  
 PROJECT ENGINEER: Cliff Douglas  
 BEGIN DATE: March, 1994  
 ENDING DATE: August, 1994

**DESIGN DESIGNATION**

	STA. 0+000 to 1+593	STA. 1+593 to 2+400	STA. 2+400 to 5+230	STA. 5+230 to 9+978
ADT 1994	1,335	942	702	240
ADT 2014	1,680	1,185	885	300
DHV 12%	200	141	105	36
D	50 - 50	50 - 50	50 - 50	50 - 50
T	3%	3%	3%	3%
T1	N/A	N/A	N/A	N/A
V	65 km/hr	50 km/hr	50 km/hr	65 km/hr

**EXCEPTIONS TO AASHTO STANDARDS**

HORIZONTAL CURVES (50 km/hr SPEED)	EXISTING DOC (68'53'51" REQ'D.)
STA. 1+605	71'21'39"
STA. 2+428	93'59'22"

VERTICAL CURVES (65 km/hr SPEED)	EXISTING SIGHT DISTANCE (99 m REQ'D.)
STA. 1+533	83.2
STA. 1+597	41.8
STA. 2+410	33.2
STA. 2+496	57.9
STA. 5+309	39.9

**DESIGN DATA**

STATION 0+000 TO STATION 2+400	
WIDTH OF PAVEMENT	8.4 m
LENGTH OF PAVEMENT	2,400 m
LENGTH OF PROJECT	2,400 m
STATION 2+400 TO STATION 9+804	
WIDTH OF PAVEMENT	9.6 m
LENGTH OF PAVEMENT	7,404 m
LENGTH OF PROJECT	7,404 m

**DESIGN STANDARDS**

3-R CRITERIA

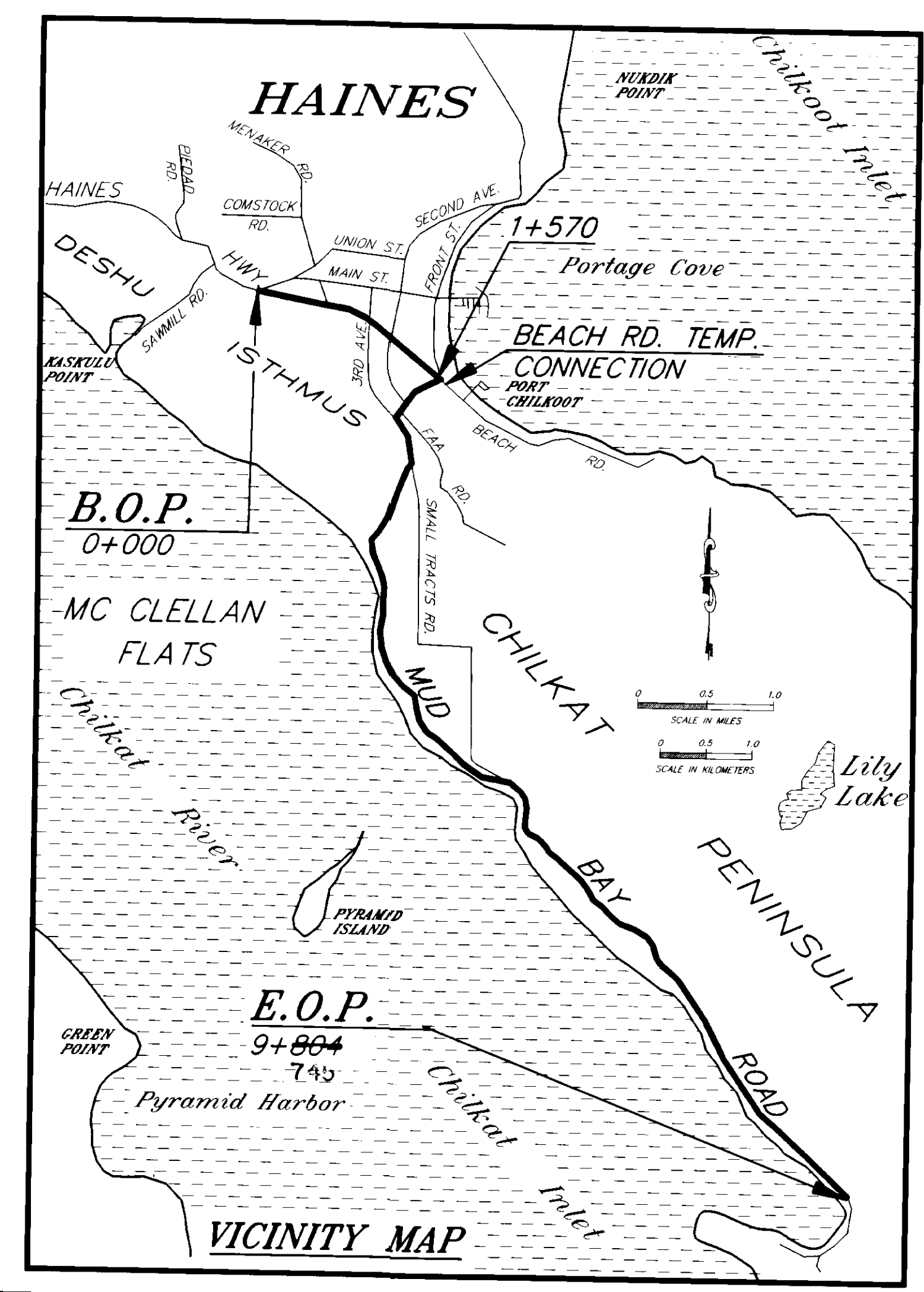

STATE OF ALASKA  
 DEPARTMENT OF TRANSPORTATION  
 AND  
 PUBLIC FACILITIES  
 SOUTHEAST REGION DESIGN SECTION

APPROVED: [Signature] DATE: 9/16/93  
 REGIONAL PRECONSTRUCTION ENGINEER

APPROVED: [Signature] DATE: 9/16/93  
 DIRECTOR, S.E. REGION DESIGN AND CONSTRUCTION

PROJECT NUMBER: <b>71358</b>	ENGINEER'S SEAL
DATE: <b>9/93</b>	
SHEET <b>1</b> OF <b>12</b>	

**METRIC**

DIMENSIONS ARE IN METERS AND/OR MILLIMETERS UNLESS OTHERWISE SHOWN.

**GENERAL NOTES**

- EXISTING SHOULDERS FROM STA. 0+575 TO STA. 1+070 LT. AND FROM STA. 1+100 TO STA. 1+558 RT. ARE 2.1 m WIDE.
- SPECIFIC LOCATIONS FOR BST REPAIR SHALL BE AS DIRECTED. ESTIMATED QUANTITIES ARE 7,800 SQUARE METERS.
- ESTIMATED QUANTITIES OF SEEDING ARE 2,000 SQ. METERS.
- ESTIMATED QUANTITIES OF HAND CLEARING ARE 20,000 SQ. METERS.

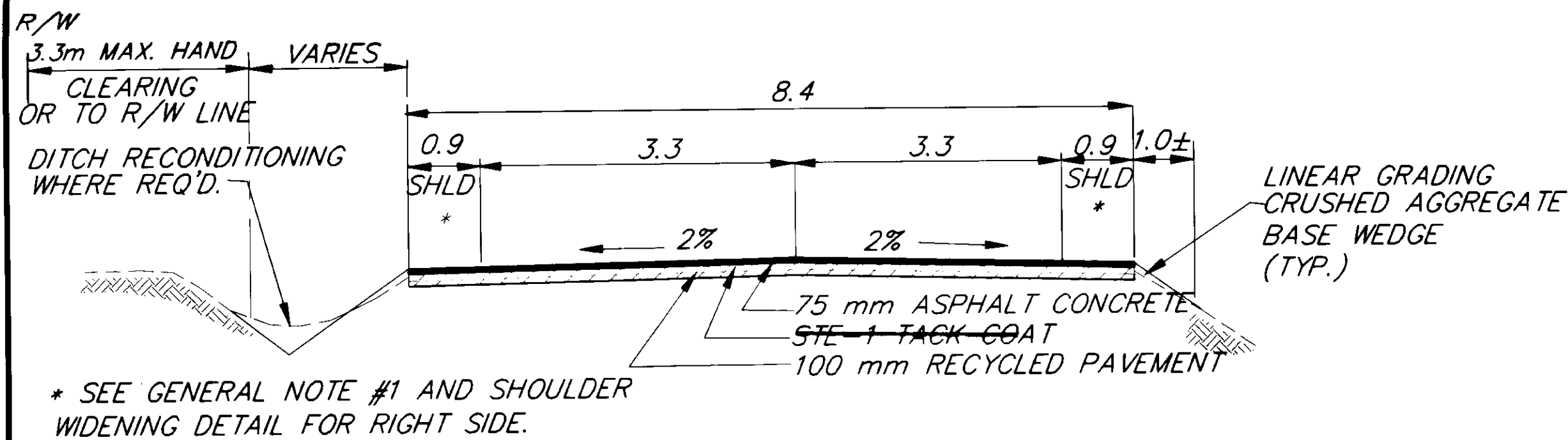

**TYPICAL SECTION**

STA. 0+060 TO STA. 1+570

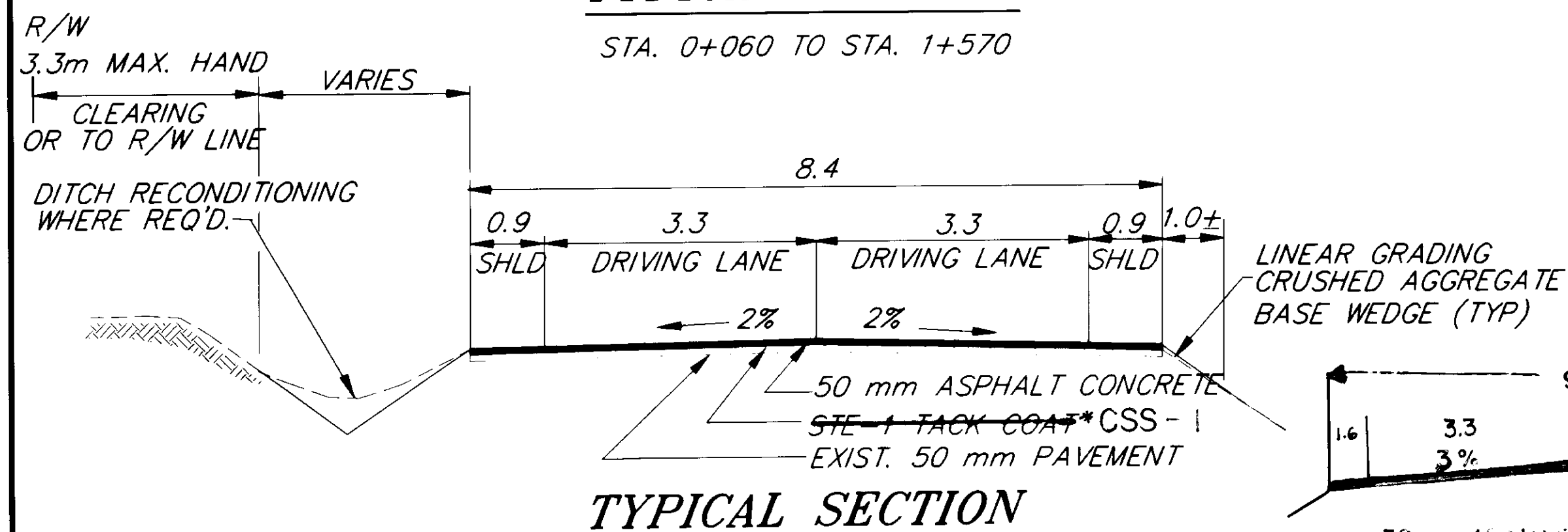

**TYPICAL SECTION**

STA. 1+570 TO STA. 2+400  
\* ONLY IN AREAS NOT RECYCLED

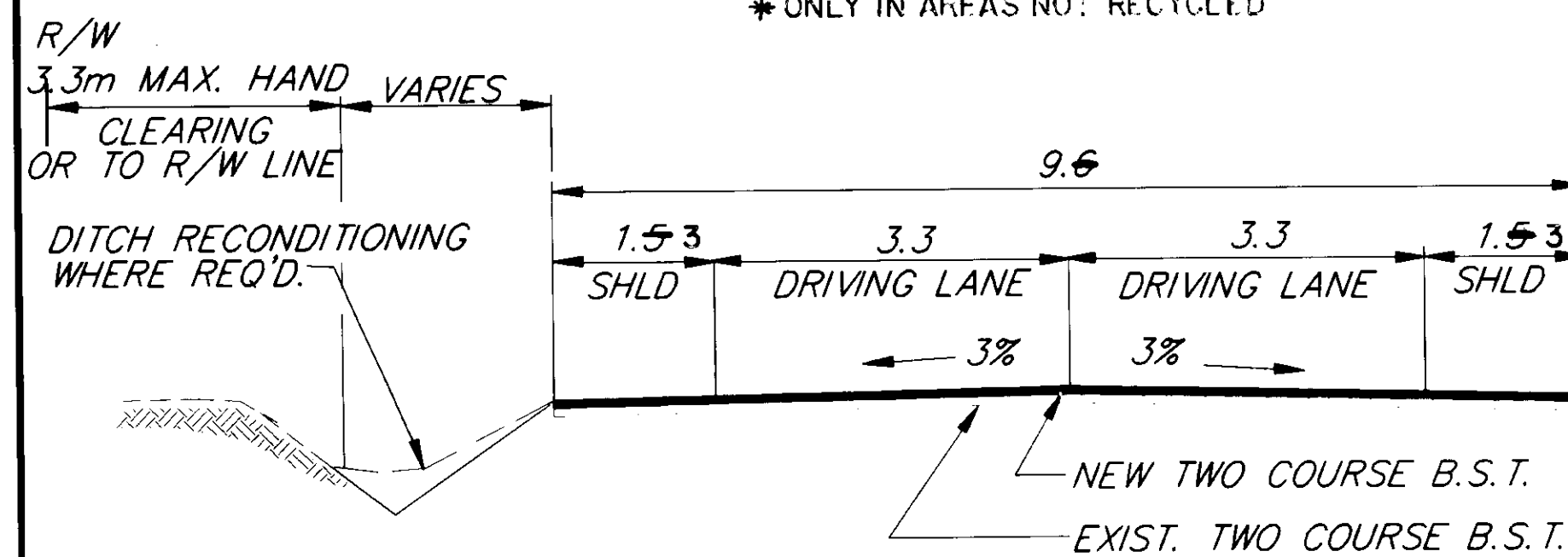

**TYPICAL SECTION**

STA. 2+400 TO STA. 9+745  
S.T. RD STA. 2+420 TO STA. 2+544

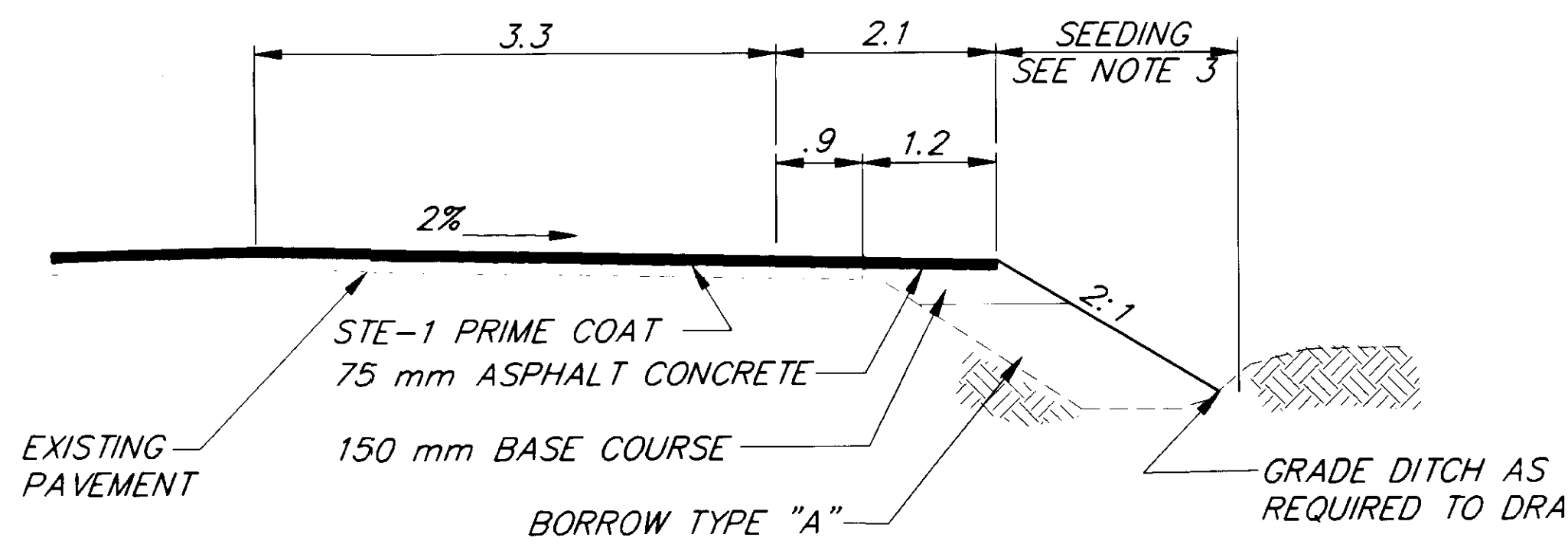

**SHOULDER WIDENING SECTION**

STA. 0+533 TO STA. 1+073  
SHOULDER WIDENING DETAIL, RIGHT SIDE ONLY  
Sta. 1+095 to Sta. 1+400 Left

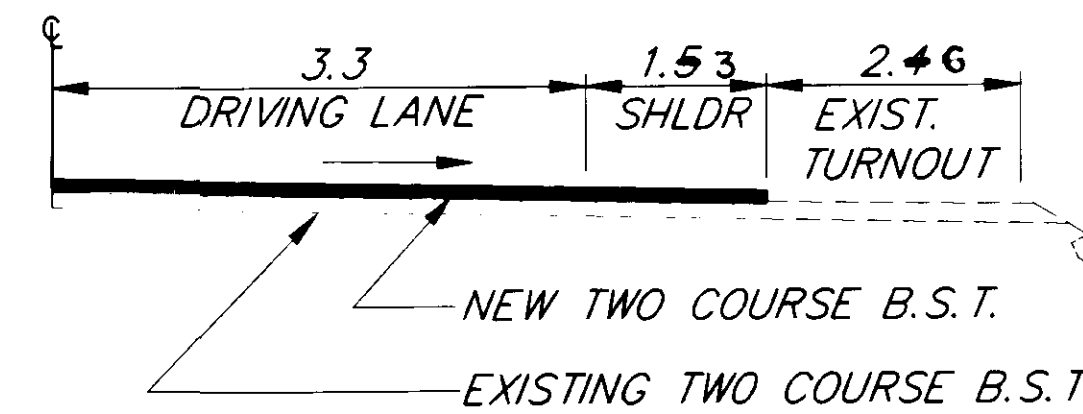

**SHOULDER DETAIL**

STA. 7+180 TO STA. 9+060

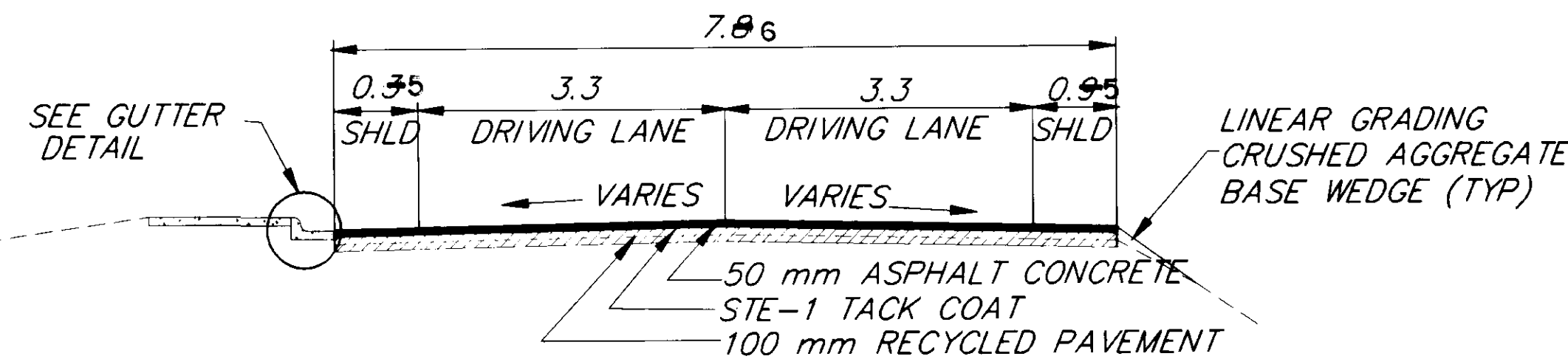

**BEACH ROAD CONNECTION TYPICAL SECTION**

STA. "B" 0+000 TO "B" 0+280  
CURB & GUTTER AND SIDEWALK ON LT. SIDE ONLY  
STA. "B" 0+091 TO STA. "B" 0+189

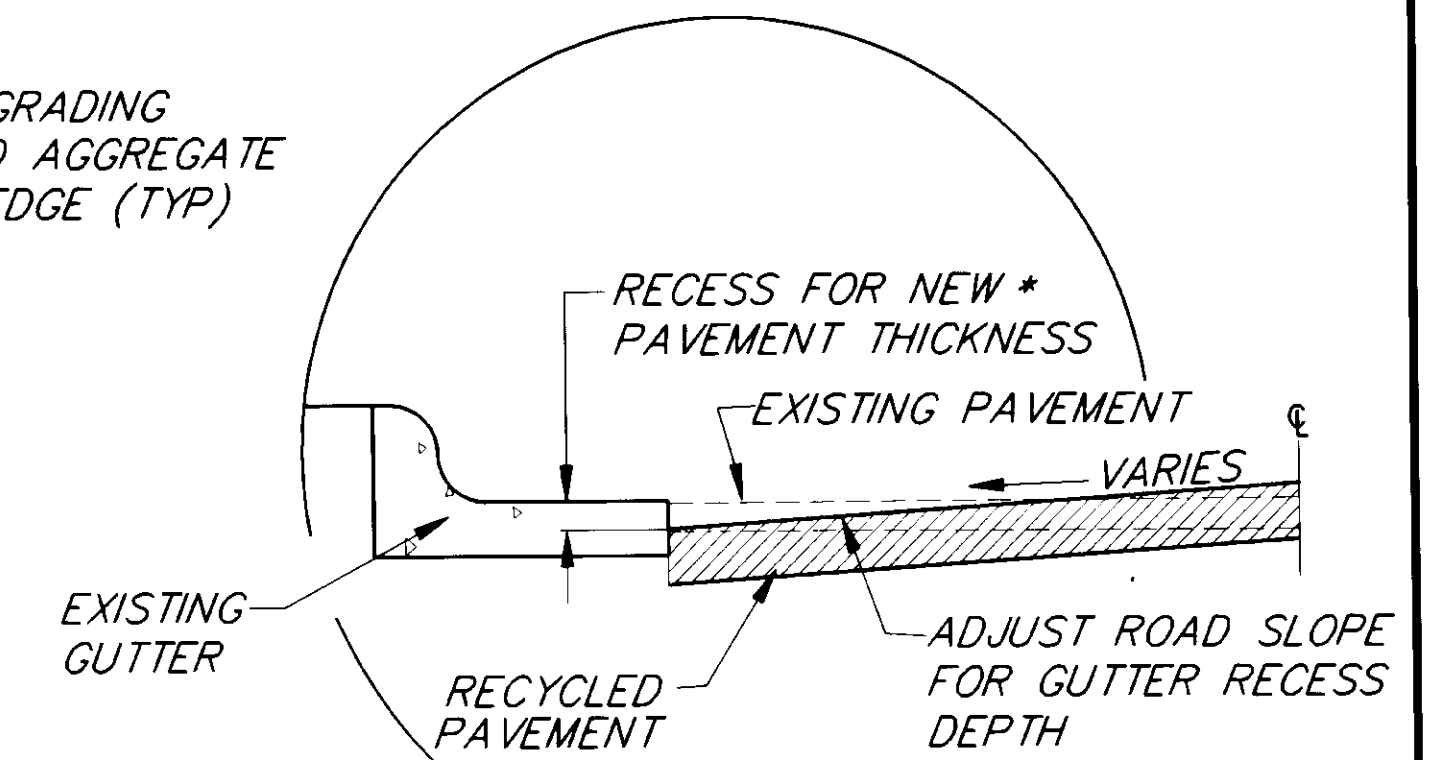

**GUTTER DETAIL**

STA. 1+240 RT TO STA. 1+450 RT  
STA. "B" 0+091 LT TO STA. "B" 0+189

\* NEW PAVEMENT WILL BE FLUSH TO GUTTER PAN

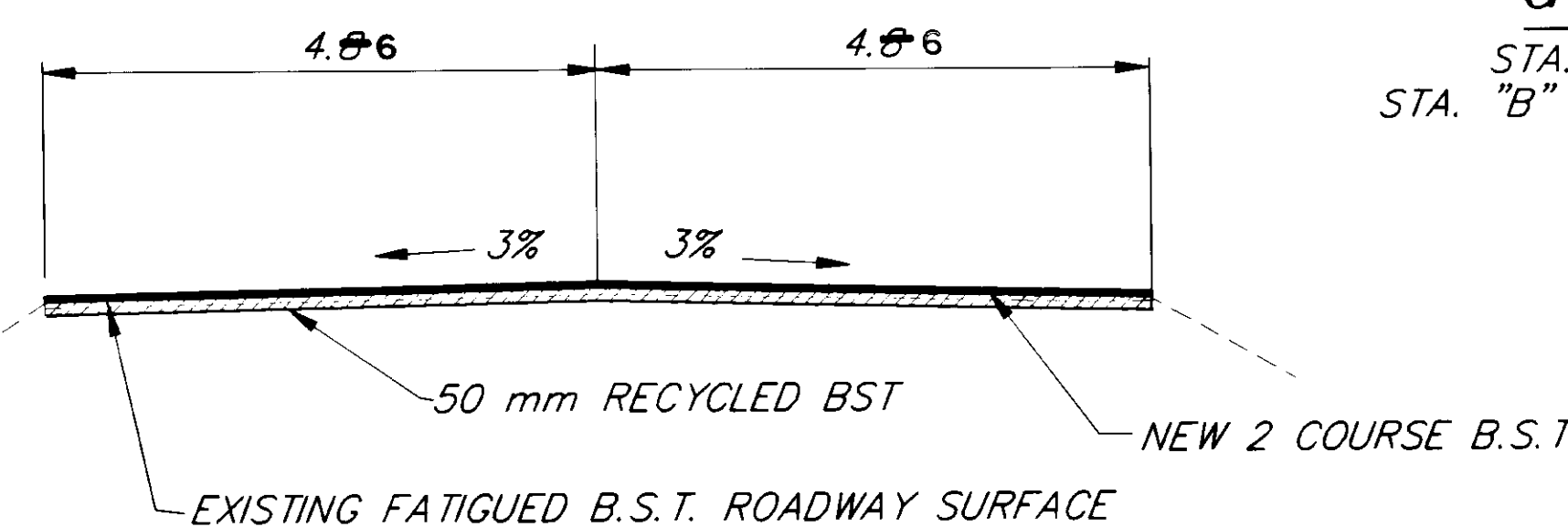

**B.S.T. REPAIR DETAIL**

STA. 2+400 TO STA. 9+745  
SEE NOTE 2

**BASIS OF ESTIMATE**

ITEM NO.	ITEM	ESTIMATING FACTOR METRIC	ESTIMATING FACTOR ENGLISH
203(6)	BORROW	2.25 t/m <sup>3</sup>	1.90 T/CY
301(1)	CRUSHED AGGREGATE BASE	2.49 t/m <sup>3</sup>	2.10 T/CY
304(1)	SUBBASE, GRADING "E"	2.48 t/m <sup>3</sup>	2.09 T/CY
405(1)	CRS-2 ASPHALT (FOR RECYCLED PAVEMENT)	5.90 4.53 l/m <sup>2</sup> (100mm DEPTH) 1,006 l/t	1.20 GAL/SY (4 IN DEPTH) 240 GAL/TON
405(1)	CRS-2 ASPHALT (FOR RECYCLED BST)	2.50 2.25 l/m <sup>2</sup> (50mm DEPTH) 1006 l/t	0.50 GAL/SY (2 IN DEPTH) 240 GAL/TON
401(1)	ASPHALT CONCRETE, TYPE II, CLASS B	2.67 kg/m <sup>2</sup> per mm	125 LB/SY-IN
401(2)	PBA-2 ASPHALT CEMENT	5.5% 6% OF ITEM 401(1)	5.5% 6% OF ITEM 401(1)
402(2)	STE-1 ASPHALT FOR TACK COAT CSS-1	0.45 l/m <sup>2</sup> 1,056 l/t	0.10 GAL/SY 253 GAL/TON
405(1)	CRS-2 ASPHALT FOR SURFACE TREATMENT	5.20 4.53 l/m <sup>2</sup> 1,006 l/t	1.10 1.00 GAL/SY 240 GAL/TON
405(2B)	GRADING B COVER COAT FOR SURFACE TREATMENT	26 kg/m <sup>2</sup> 24 kg/m <sup>2</sup>	48 LB/SY 44 LB/SY
405(2E)	GRADING E COVER COAT FOR SURFACE TREATMENT	15 kg/m <sup>2</sup> 13 kg/m <sup>2</sup>	28 LB/SY 25 LB/SY

NOTE: DO NOT SCALE FROM THESE PLANS-USE DIMENSIONS

PATH:	P:\HNS\MUDBAY\DR\TYPICAL 1=1
BY:	DATE:
	DESCRIPTION OF CHANGE:
RECORD OF REVISIONS	

STATE OF ALASKA  
DEPARTMENT OF TRANSPORTATION  
AND PUBLIC FACILITIES  
SOUTHEAST REGION DESIGN & CONSTRUCTION

HAINES

HAINES  
MUD BAY ROAD REPAVING  
PROJECT NO. 71358

**TYPICAL SECTIONS**

ALASKA

DESIGNED BY: P. JONES  
DRAWN BY: C. ANDERSON  
CHECKED BY: P. BEDNAROWICZ

PROJECT NO. 71358  
DATE: 9/8/93  
SHEET 2 OF 12

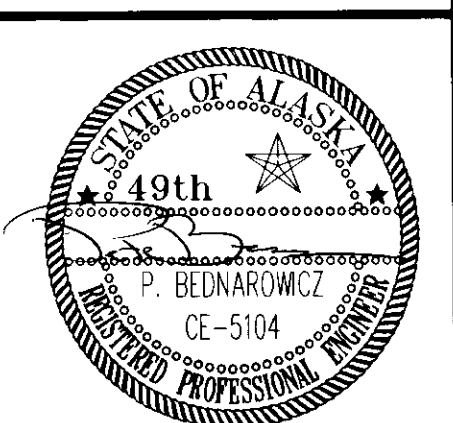

**ESTIMATE OF QUANTITIES/DETAILS**

HAINES  
MUD BAY ROAD REPAVING  
PROJECT NO. 71358

ALASKA  
DESIGNED BY: P. JONES  
DRAWN BY: C. ANDERSON  
CHECKED BY: P. BEDNAROWICZ  
DATE: 9/8/93  
PROJECT NO. 71358  
SHEET 3 OF 12

NOTE: DO NOT SCALE FROM THESE PLANS-USE DIMENSIONS



**METRIC / ENGLISH CONVERSION**

MULTIPLY BY	TO	TO CONVERT FROM
0.039370079	INCH	MILLIMETER
3.2808399	FOOT	METER
1.0936133	YARD	METER
0.6213719	MILE (STATUTE)	KILOMETER
0.001550031	SQUARE INCH	SQUARE MILLIMETER
10.76391	SQUARE FOOT	SQUARE METER
1.19599	SQUARE YARD	SQUARE METER
0.0024710538	ACRE	SQUARE METER
0.4046856	ACRE	HECTARES
35.314667	CUBIC FOOT	CUBIC METER
1.3079506	CUBIC YARD	CUBIC METER
1.102313	TON (SHORT)	TON (METRIC)
2.2046226	POUND (AVDP)	KILOGRAM
0.2641794	GALLON (LIQUID)	LITER

ITEM NO.	ITEM	UNIT	TOTAL
1201(1)	DBE ADJUSTMENT	CS	ALL REQ'D.
201(7)	HAND CLEARING & 201(2A) DEEP HAND CLEARING	LS	ALL REQ'D.
203(3)	UNCLASSIFIED EXCAVATION	m <sup>3</sup>	1681
203(6)	BORROW TYPE "A"	?	383
203(11)	LINEAR GRADING	km	3.0
203(12)	DITCH RECONDITIONING	km	7.62
203(13)	WASHED ROCK	m <sup>3</sup>	942
301(1)	CRUSHED AGGREGATE BASE COURSE	?	2500
304(1)	SUBBASE, GRADING "E"	?	529
401(1)	ASPHALT CONCRETE, TYPE II, CLASS "B"	?	5391
401(2)	PBA-2 ASPHALT CEMENT	?	290
402(1)	STE-1 ASPHALT FOR TACK COAT	?	135
405(1)	CRS-2 ASPHALT FOR SURFACE TREATMENT	?	263
405(2B)	GRADING "B" COVER COAT MATERIAL FOR ASPHALT SURFACE TREATMENT	?	1836
405(2E)	GRADING "E" COVER COAT MATERIAL FOR ASPHALT SURFACE TREATMENT	?	1066
406(1)	RECYCLED PAVEMENT	m <sup>2</sup>	2043
406(2)	RECYCLED BST	m <sup>2</sup>	5660
603(17-24)	24-INCH PIPE	m	30.5
603(17-18)	18-INCH PIPE	m	59
604(5)	INLET TYPE "A"	EACH	4
605(7)	MODIFIED UNDERDRAIN	m	125
606(4)	REMOVAL AND RECONSTRUCTION OF GUARDRAIL	m	1482.09
606(6)	END ANCHORAGES	EACH	10
614(3)	ADJUST EXISTING MONUMENTS & CASES	EACH	164
615(1)	STANDARD SIGN	m <sup>2</sup>	62.59
630(1)	GEOTEXTILE SEPARATION	m <sup>2</sup>	3493
639(3)	DRIVEWAYS	EACH	III
640(1)	MOBILIZATION AND DEMOBILIZATION	LS	ALL REQ'D.
641(1)	EROSION AND POLLUTION CONTROL-ADMINISTRATION	LS	ALL REQ'D.
641(2)	EROSION AND POLLUTION CONTROL-MANPOWER	MAN-HR	0
641(3)	EROSION AND POLLUTION CONTROL	CS	ALL REQ'D.
642(1)	CONSTRUCTION SURVEYING	LS	ALL REQ'D.
643(2)	TRAFFIC MAINTENANCE	LS	ALL REQ'D.
643(4)	CONSTRUCTION SIGN	EACH/DAY	400
643(7)	TRAFFIC CONE	EACH/DAY	3,000
643(8)	DRUM	EACH/DAY	200
643(15)	TEMPORARY PAVEMENT MARKING	km	9.80
643(15)	FLAGGING	hour	1000
643(15)	FLAGGING	m <sup>3</sup>	147
670(1)	PAINTED TRAFFIC MARKINGS	LS	ALL REQ'D.
670(8)	RECESSED PAVEMENT MARKERS	EACH	61
202(1)	REMOVAL OF STRUCTURES	LS	ALL REQ'D.
203(1)	SLIDE EXCAVATION	m <sup>3</sup>	722
606(5)	REMOVAL & DISPOSAL OF GUARDRAIL	m	240
606(8)	GUARDRAIL ADJUSTMENT	m	114
405(1A)	CRS-II P. MODIFIED	?	1225
604(4)	ADJUST EXISTING MONUMENTS & CASES	LS	ALL REQ'D.
627(1)	ADJUST EXISTING MONUMENTS & CASES	EACH	6

**GUARDRAIL PAVING DETAIL**

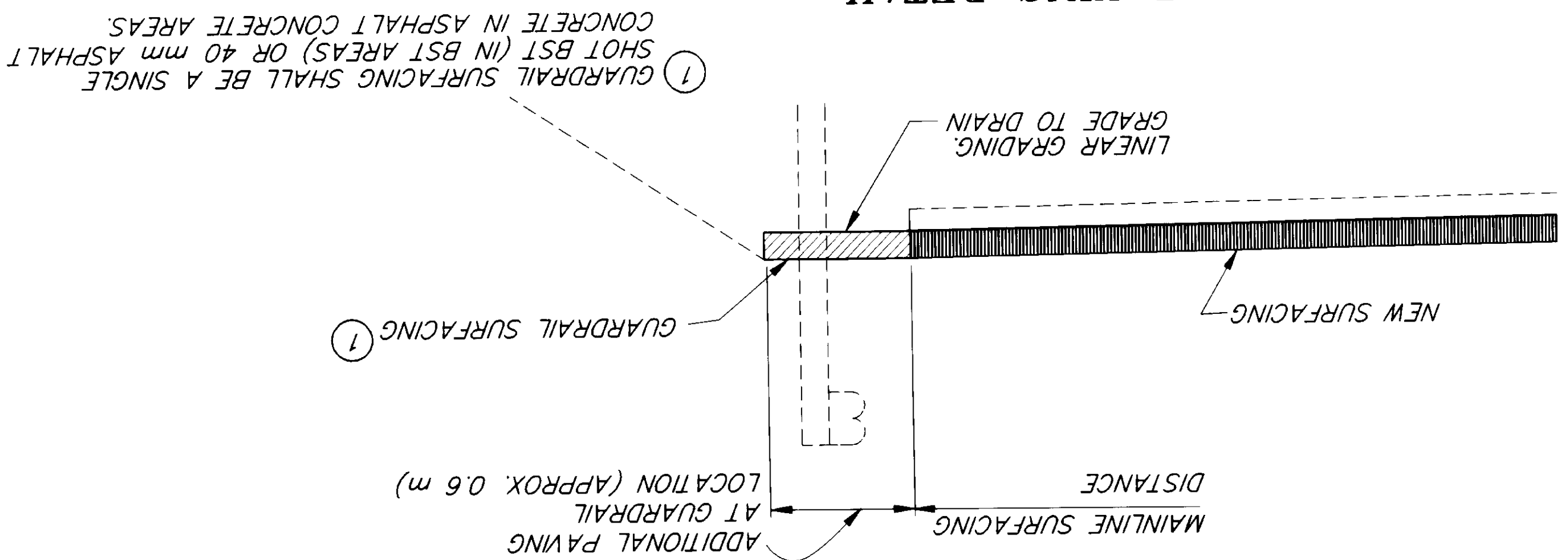

**ROAD DRAIN DETAIL**

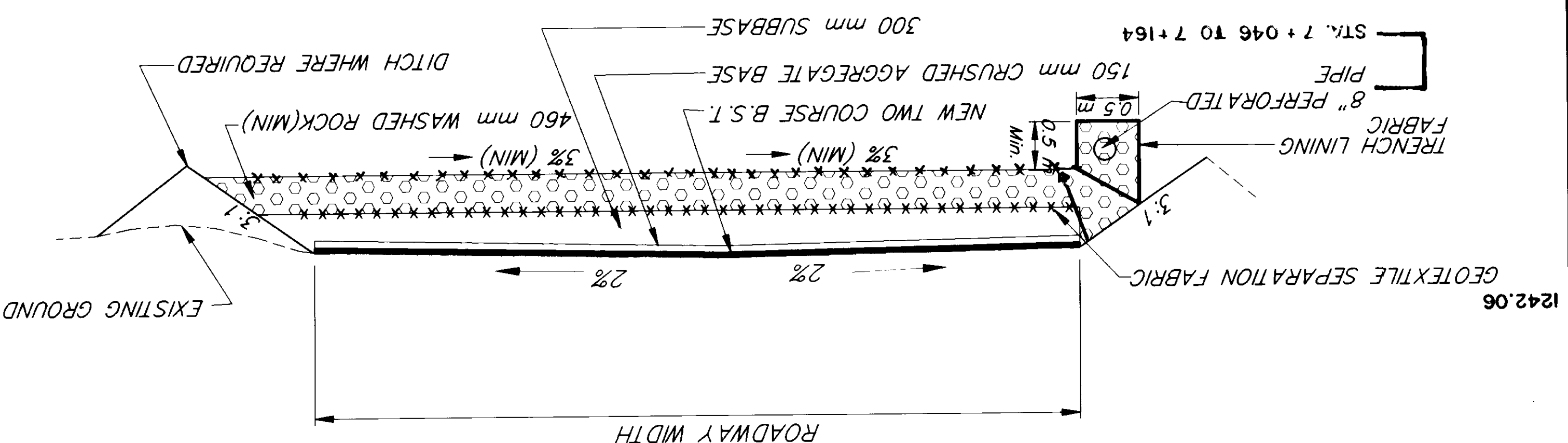

**PAVEMENT TRANSITION DETAIL**

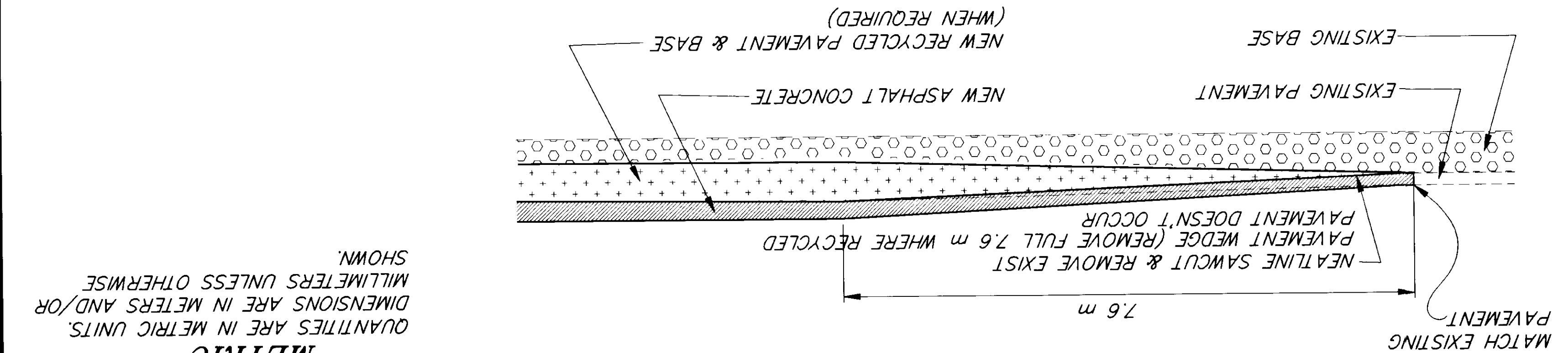

**METRIC**

QUANTITIES ARE IN METRIC UNITS.  
DIMENSIONS ARE IN METERS AND/OR  
MILLIMETERS UNLESS OTHERWISE  
SHOWN.

**METRIC**

DIMENSIONS ARE IN METERS AND/OR MILLIMETERS UNLESS OTHERWISE NOTED.

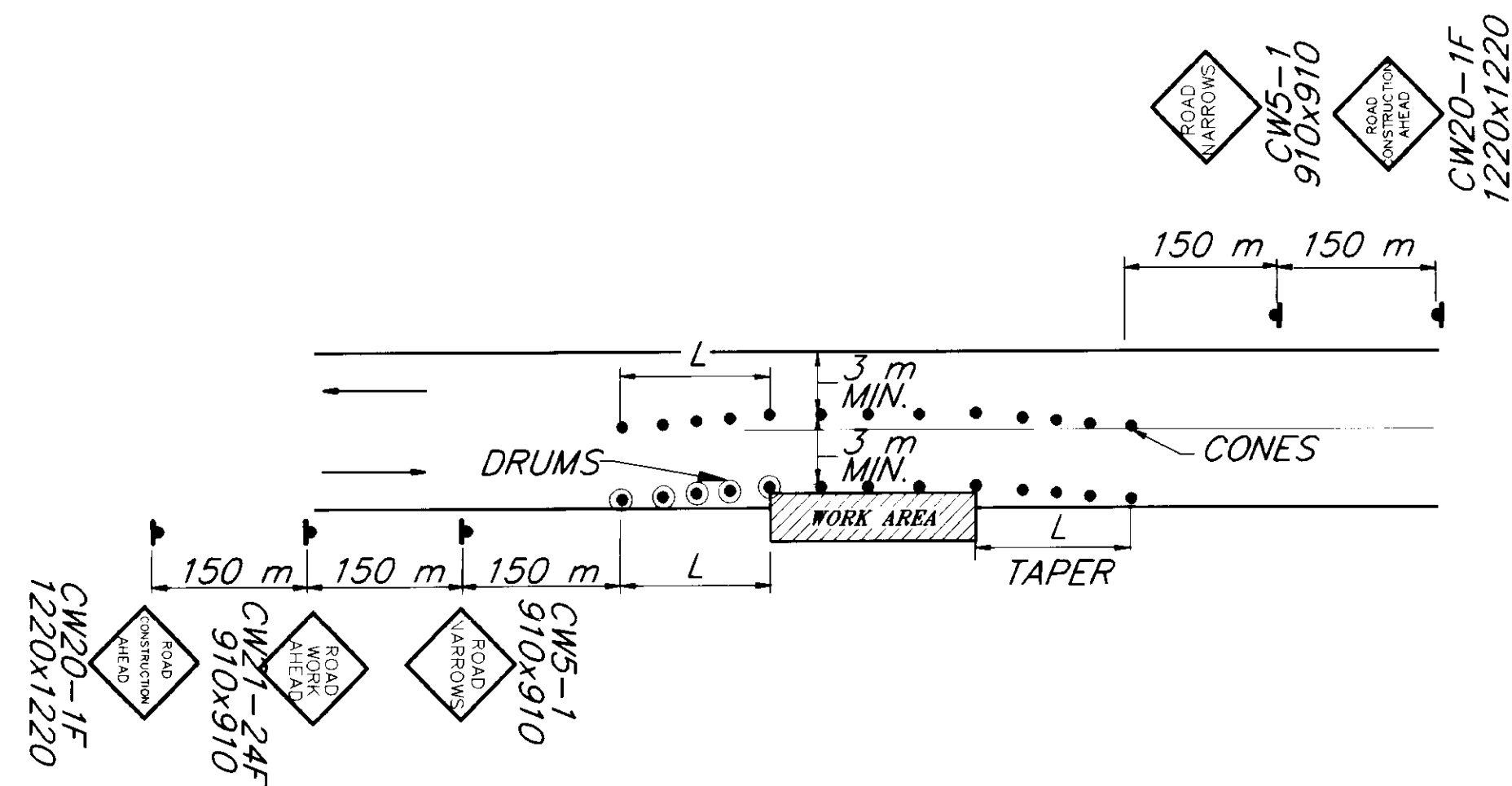

**ROADWAY ENCROACHMENT**

NOTE: IF ONLY ONE LANE IS EFFECTED BY ROAD WORK (THAT IS, THE CHANNELIZING DEVICES ALONG THE WORK AREA ARE NO CLOSER THAN 3 m TO CENTERLINE) THE CENTERLINE CONES FOR THE OPPOSING LANE MAY BE DELETED.

**TRAFFIC CONTROL NOTES**

1. A MINIMUM OF ONE LANE SHALL BE MAINTAINED OPEN AT ALL TIMES AT WORK AREAS.
2. TWO LANES SHALL BE MAINTAINED OPEN AT ALL TIMES AT WORK SITES DURING NON-WORKING HOURS.
3. MAXIMUM SPACING (IN METERS) BETWEEN CHANNELIZING DEVICES SHALL BE EQUAL TO THE SPEED LIMIT (IN MPH) DIVIDED BY 3.28. CONES SHALL BE A MINIMUM OF 710 mm TALL. DRUMS FOR DELINEATION AT NIGHT SHALL HAVE TYPE C STEADY BURN LIGHTS. DRUMS TO MARK OBSTRUCTIONS AT NIGHT SHALL HAVE TYPE C FLASHING LIGHTS.
4. FLOOD LIGHTS SHALL BE PROVIDED FOR FLAGGER STATIONS DURING NIGHT OPERATIONS. THEY SHALL BE POSITIONED SO THAT ONCOMING TRAFFIC IS NOT BLINDED.
5. A SINGLE FLAGGER MAY BE APPROVED BY THE ENGINEER IF THE ENTIRE WORK AREA IS LESS THAN 15m LONG AND IS VISIBLE FROM BOTH DIRECTIONS.
6. THE MAXIMUM LENGTH OF ONE LANE, TWO-WAY WORK AREA SHALL BE 760 m. THE MINIMUM DISTANCE BETWEEN ONE LANE WORK AREAS SHALL BE 300 m.
7. TEMPORARY PAVEMENT MARKINGS ARE REQUIRED ON THE LEVELING COURSE AND THE FINAL LIFT IN ACCORDANCE WITH SECTION 64.3 OF THE SPECIAL PROVISIONS.
8. CONSTRUCTION SIGNS SHALL ONLY BE IN PLACE WHEN THE CONDITIONS EXIST FOR WHICH THEY ARE INTENDED.
9. CHANNELIZING DEVICES IN THE LEADING TAPER SHALL BE DRUMS. THEREAFTER, DRUMS SHALL BE PLACED EVERY 75 m ALONG WORK AREAS, WITH CONES BEING APPROPRIATELY SPACED IN BETWEEN THE DRUMS.

SPEED LIMIT=40 MPH  $L^2=WS$   $L=$  MIN. LENGTH OF TAPER (meters)  
 196.8  $S=$  POSTED SPEED LIMIT (mph)  
 $W=$  WIDTH OF OFFSET (meters)

METRIC UNIT	ENGLISH UNIT
1520 X 910	60" X 36"
1520 X 610	60" X 24"
1220 X 1220	48" X 48"
1220 X 610	48" X 24"
910 X 910	36" X 36"
610 X 910	24" X 36"
760 X 760	30" X 30"
610 X 460	24" X 18"

LEGEND	
	..... SIGN
	..... CONE
	..... DRUM
	..... FLAGGER STATION

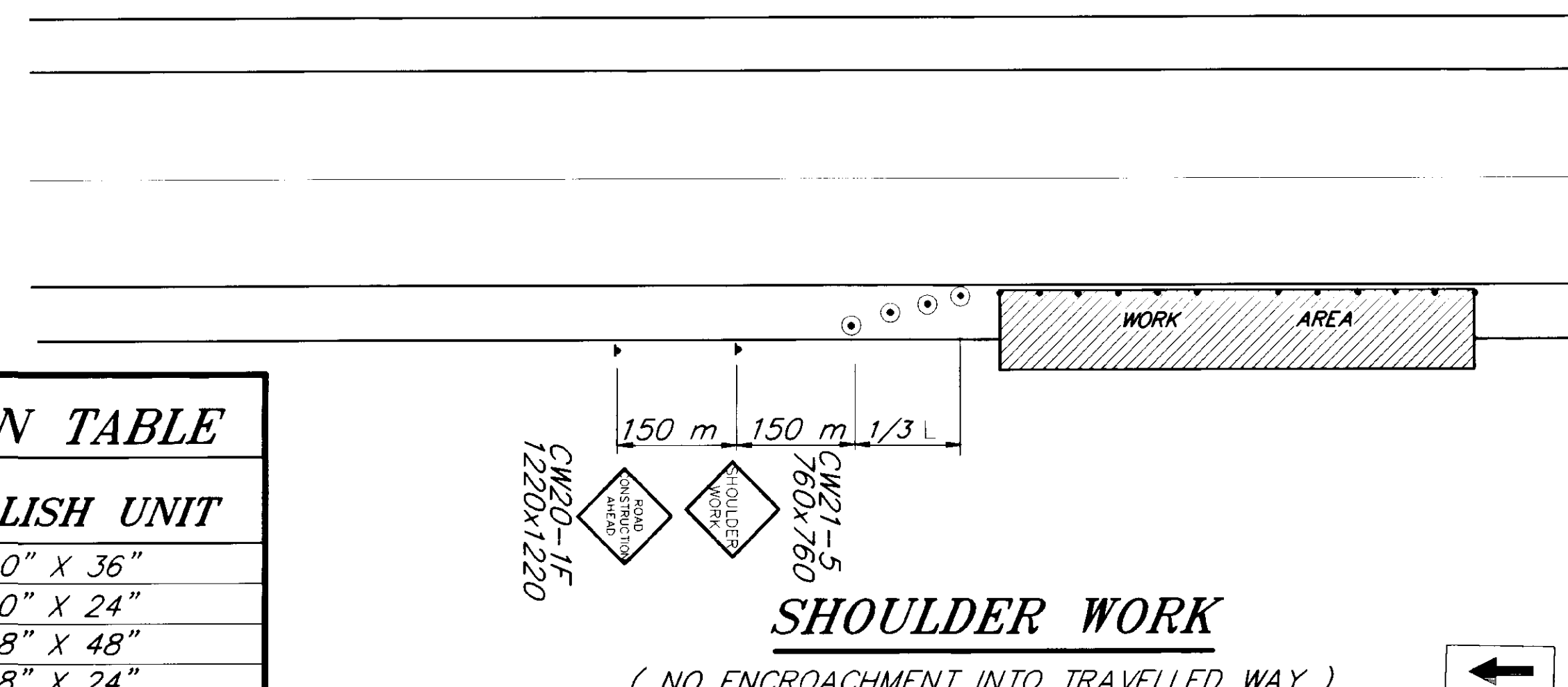

**SHOULDER WORK**

(NO ENCROACHMENT INTO TRAVELLED WAY)

CW1-6R  
914 mm x 457 mm

CW20-1F  
914 mm x 914 mm

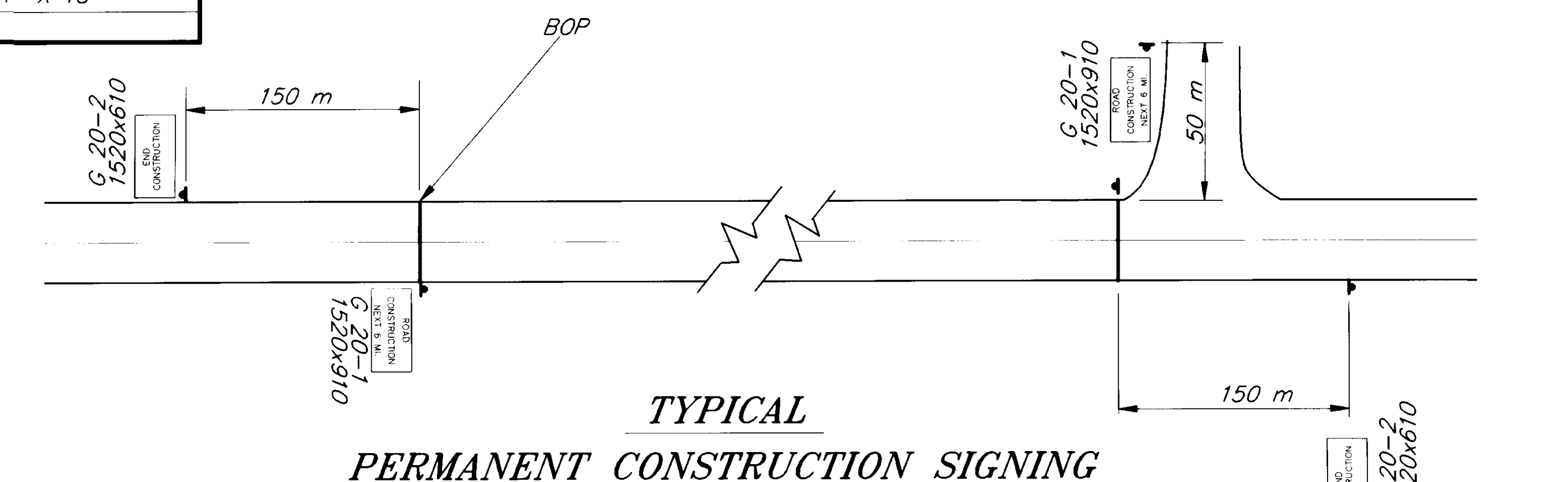

**TYPICAL**

**PERMANENT CONSTRUCTION SIGNING**

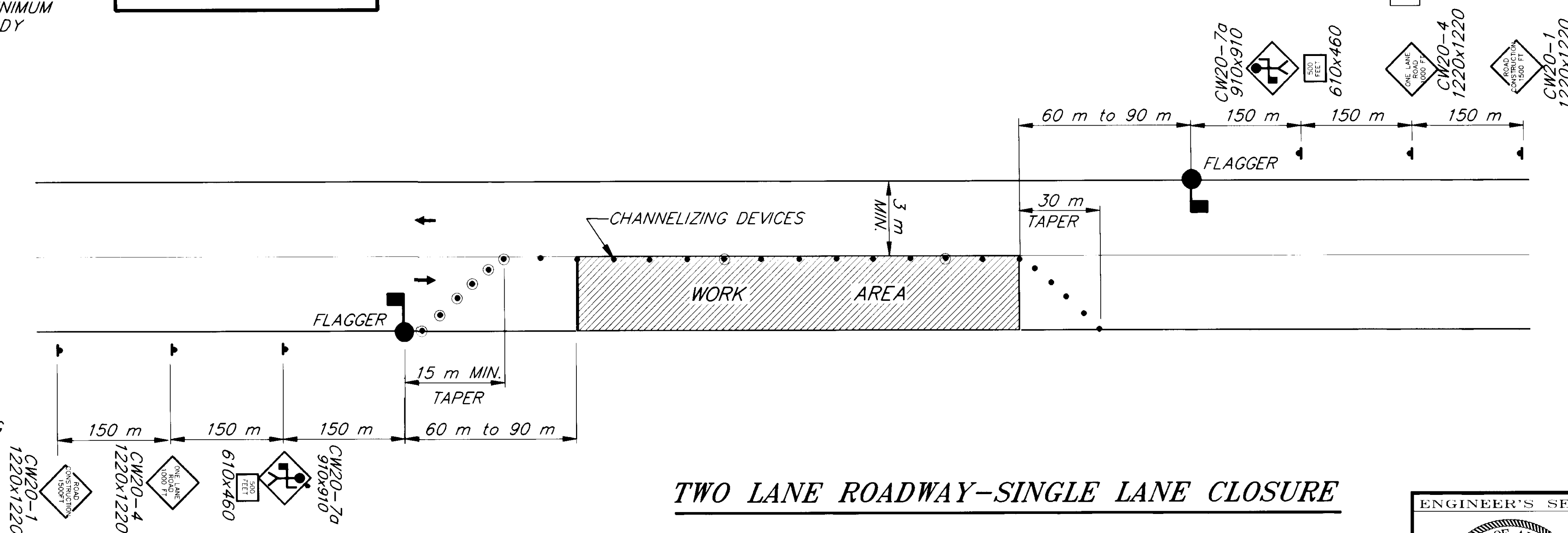

**TWO LANE ROADWAY-SINGLE LANE CLOSURE**

NOTE: DO NOT SCALE FROM THESE PLANS-USE DIMENSIONS

RECORD OF REVISIONS		
PATH:	P: \HNS\MUDBAY\DR\TCP 1=1	
BY:	DATE:	DESCRIPTION OF CHANGE:

STATE OF ALASKA  
 DEPARTMENT OF TRANSPORTATION  
 AND PUBLIC FACILITIES  
 SOUTHEAST REGION DESIGN & CONSTRUCTION

HAINES  
 HAINES  
 MUD BAY ROAD REPAVING  
 PROJECT NO. 71358  
**TRAFFIC CONTROL PLAN**

DESIGNED BY:	P. JONES	PROJECT NO.	71358
DRAWN BY:	C. ANDERSON	DATE:	9/93
CHECKED BY:	P. BEDNAROWICZ	SHEET	4 OF 12

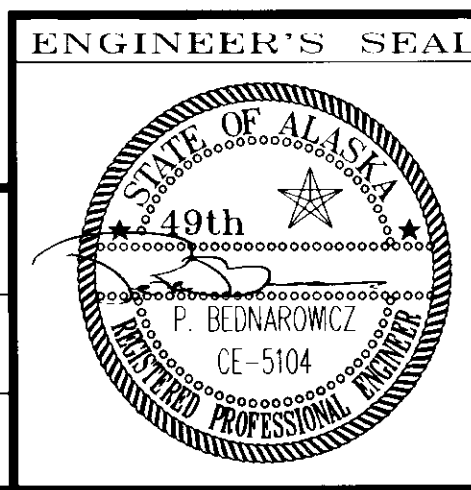

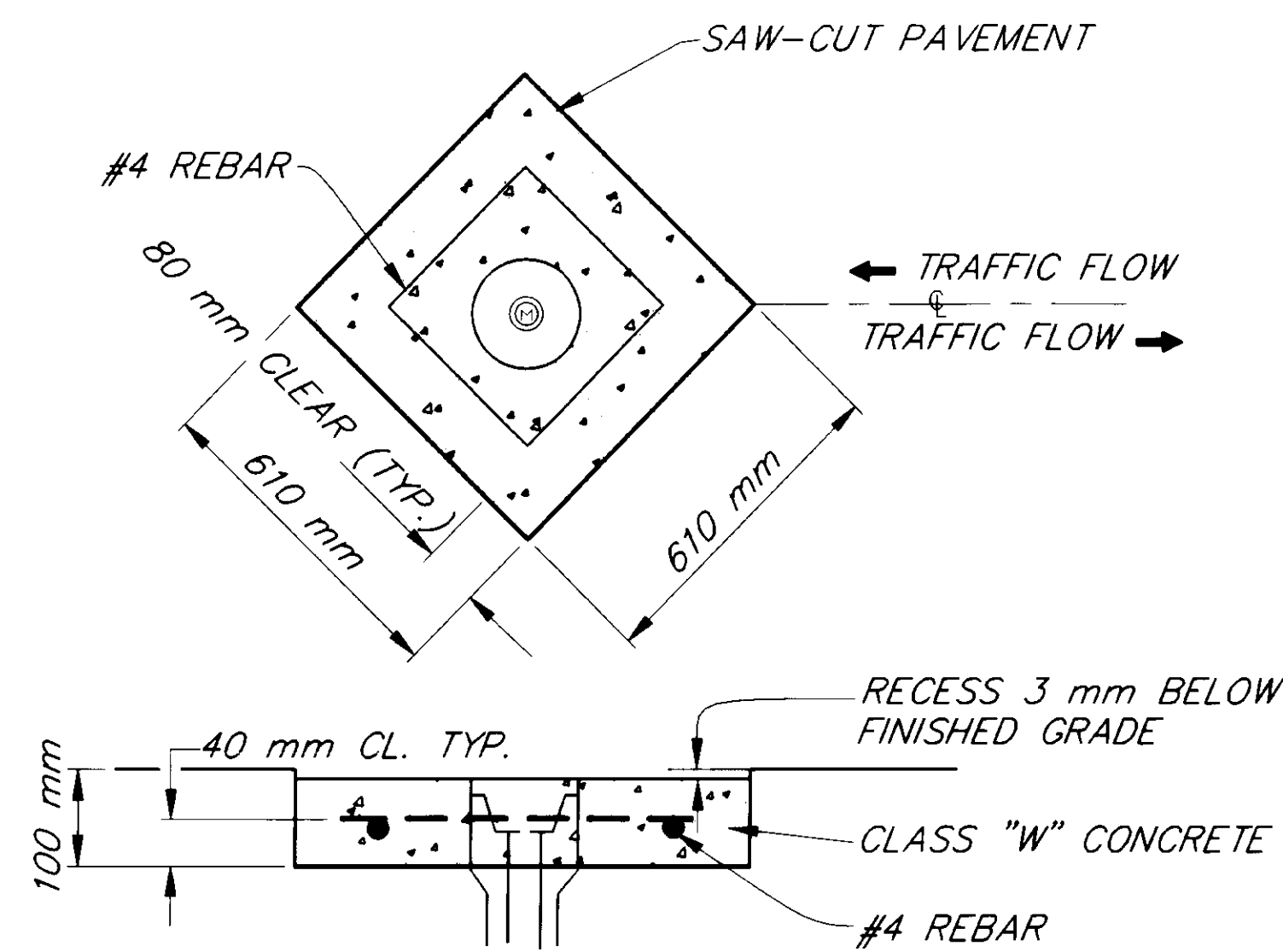

**MONUMENT CASE ADJUSTMENT DETAIL**

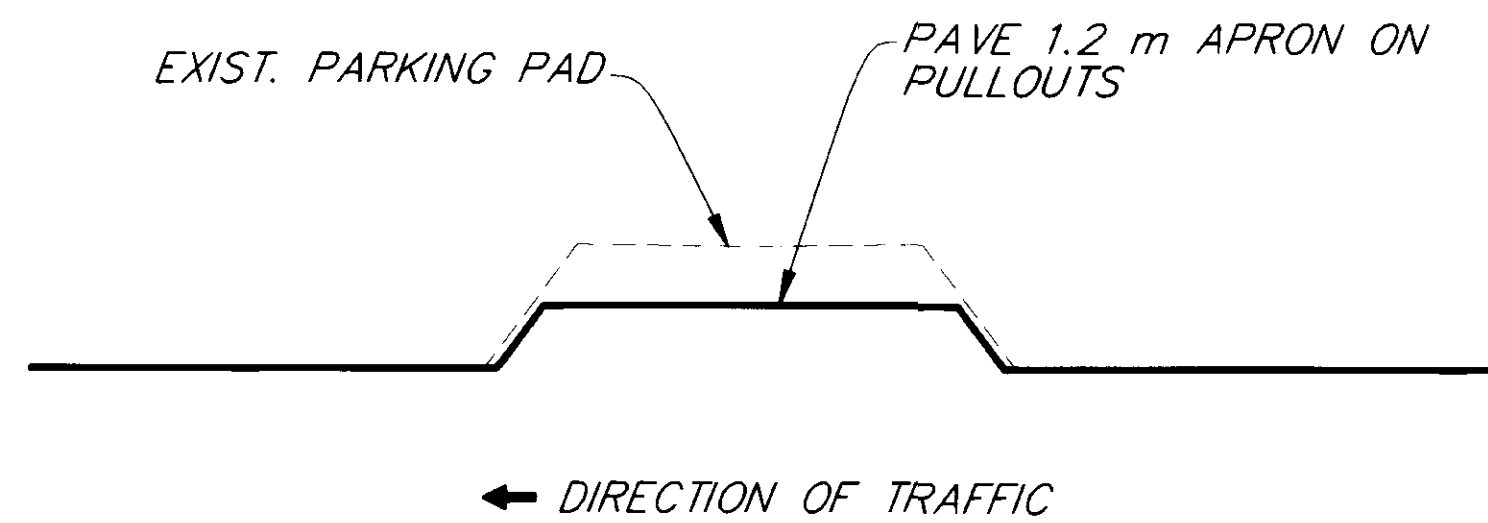

**PULLOUT DETAIL**

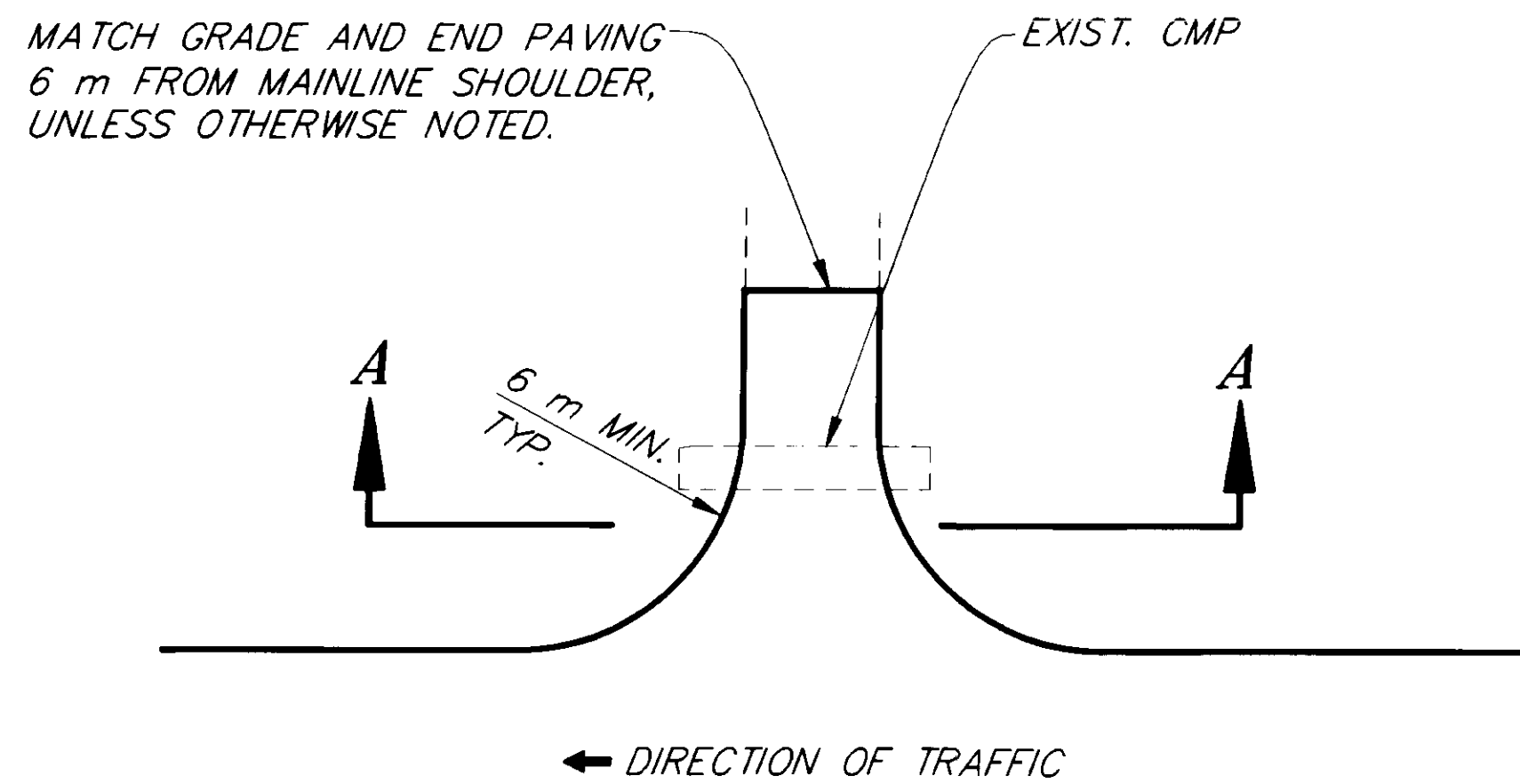

**DRIVEWAY DETAIL**

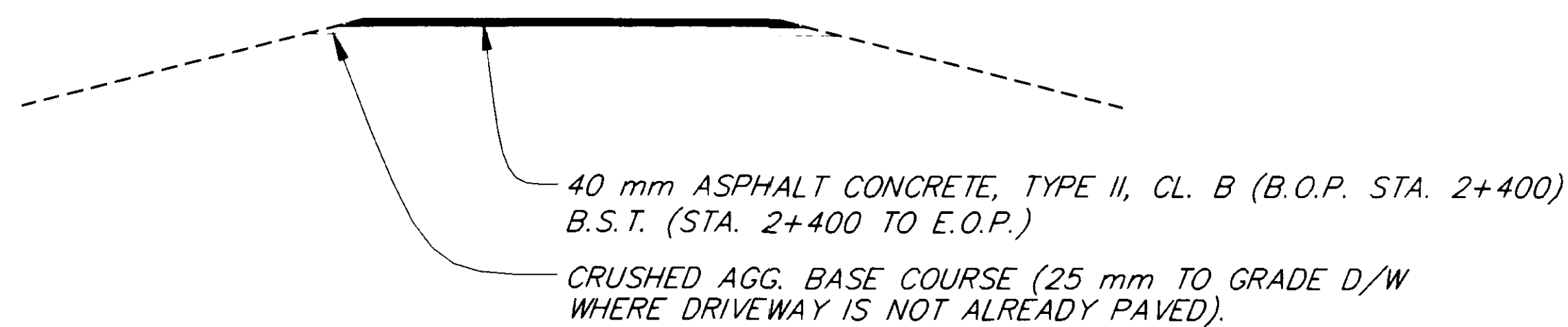

**SECTION A-A**

**DRIVEWAY NOTES:**

1. THE EXISTING PAVEMENT ON 5 TO 10 DRIVEWAYS MAY BE DIRECTED BY THE ENGINEER TO BE REMOVED IN ORDER TO REGRADE THE DRIVEWAY WITH BASE COURSE. THIS REMOVAL WILL BE PAID FOR AS UNCLASSIFIED EXCAVATION.

<b>R.P.M. SPACING TABLE</b>			
STATION TO	STATION	24 m	12 m
0+060	1+570	X	

**METRIC**  
DIMENSIONS ARE IN METERS AND/OR MILLIMETERS UNLESS OTHERWISE NOTED.

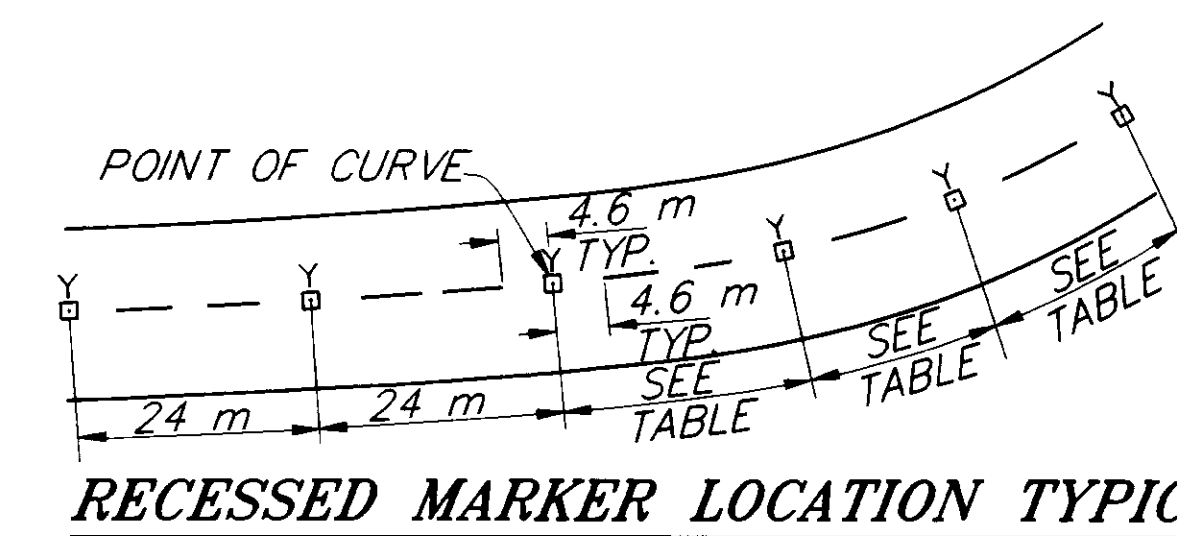
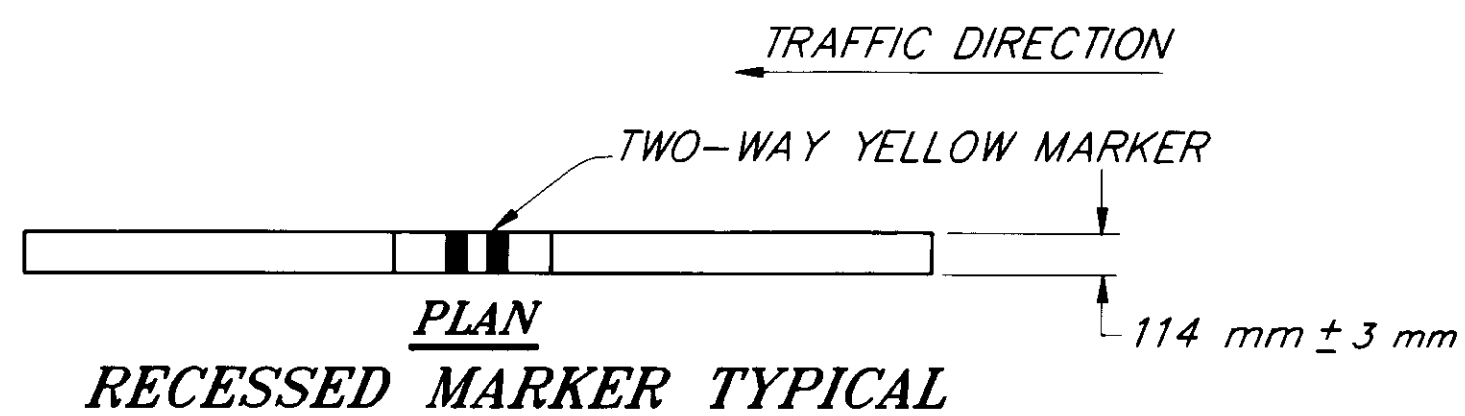
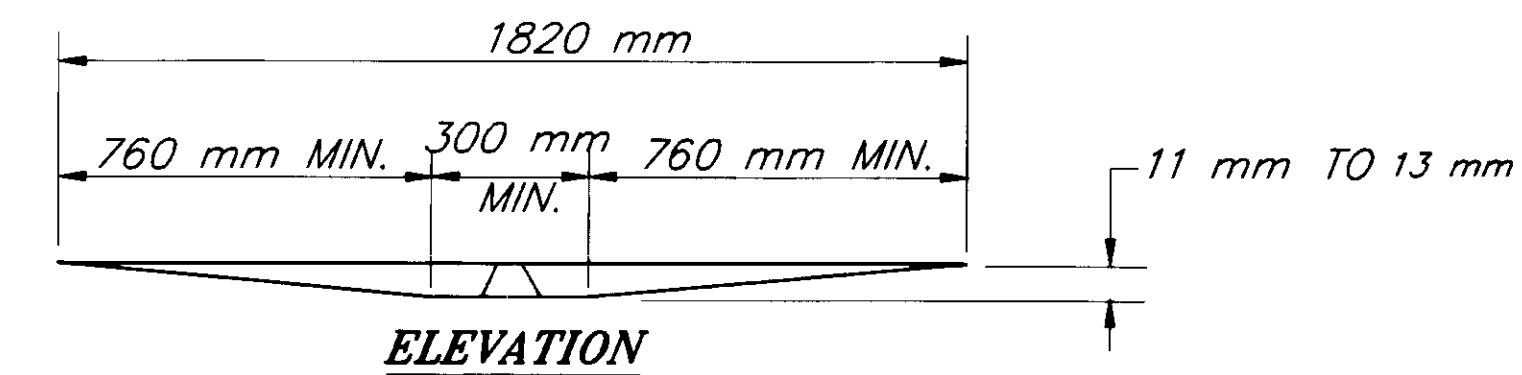

**RECESSED MARKER LOCATION TYPICAL**

(SEE R.P.M. SPACING TABLE)

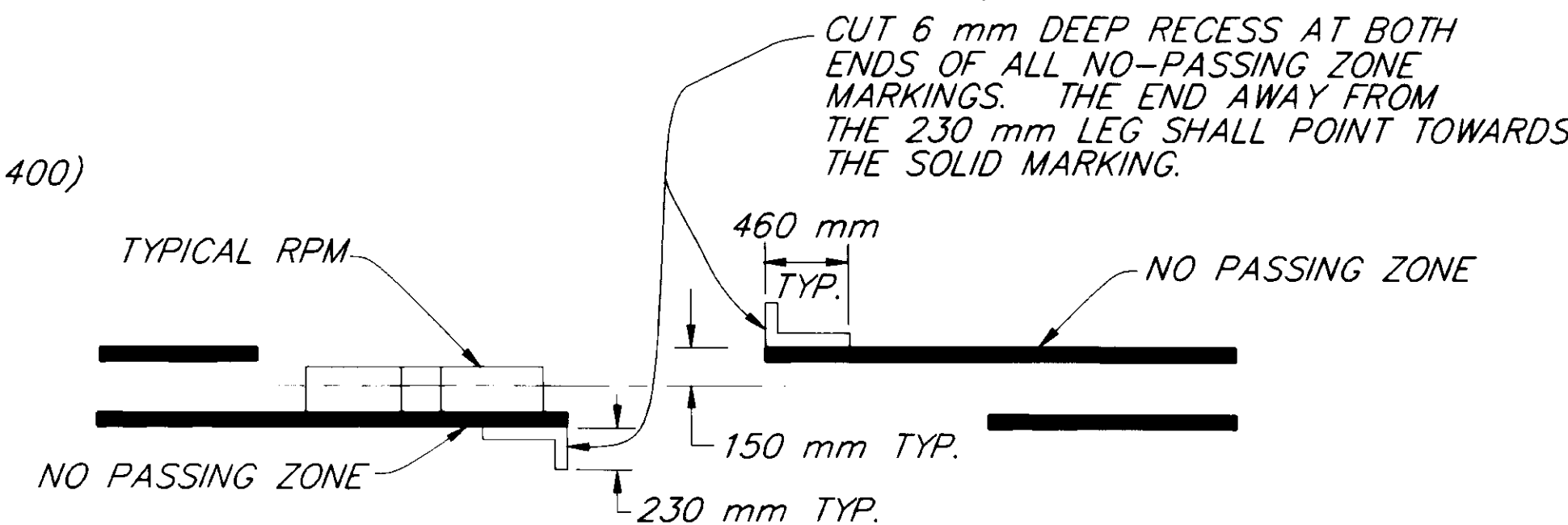

**NO PASSING GROOVES**

**STRIPING AND RPM NOTES:**

1. STRIPED LANE WIDTHS SHALL BE 3.3 m. WIDTH SHALL TAPER IN 30m TO MATCH EXISTING AT B.O.P. AND E.O.P
2. EXISTING NO-PASSING GROOVES AT ENDS OF NO PASSING ZONES SHALL BE REFERENCED BEFORE CONSTRUCTION BEGINS BY THE CONTRACTOR FOR TEMPORARY AND PERMANENT MARKING PLACEMENT.
3. LATERAL PLACEMENT OF RECESSED PAVEMENT MARKERS SHALL BE BETWEEN DOUBLE YELLOW STRIPES OR IN LINE WITH SKIP STRIPES.
4. LOCATIONS OF MARKERS IN SITUATIONS WITH UNUSUAL GEOMETRICS WILL BE DETERMINED BY THE PROJECT ENGINEER.
5. RPM QUANTITIES ARE APPROXIMATE ONLY AND MAY VARY.

NOTE: DO NOT SCALE FROM THESE PLANS-USE DIMENSIONS

RECORD OF REVISIONS		
NO.	DATE	DESCRIPTION OF CHANGE

STATE OF ALASKA  
DEPARTMENT OF TRANSPORTATION  
AND PUBLIC FACILITIES  
SOUTHEAST REGION DESIGN & CONSTRUCTION

HAINES  
HAINES  
MUD BAY ROAD REPAVING  
PROJECT NO. 71358  
ALASKA  
**MISCELLANEOUS DETAILS**

DESIGNED BY: P. JONES  
DRAWN BY: C. ANDERSON  
CHECKED BY: P. BEDNAROWICZ  
PROJECT NO. 71358  
DATE: 9/93  
SHEET 5 OF 12

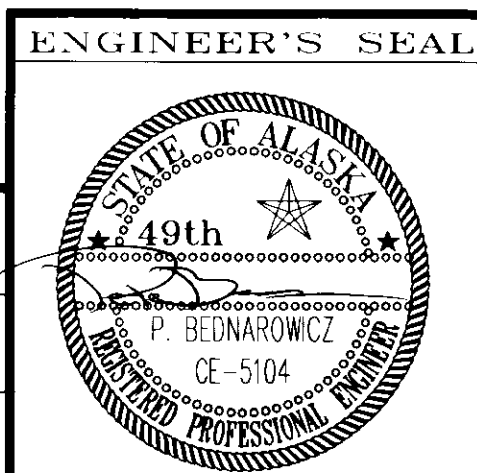

# DRIVEWAY SUMMARY

STATION	OFFSET		WIDTH (METER)	EXIST. SURFACE		REMARKS
	LT	RT		PAVED	UNPAVED	
0+128	X		7.3	X		
0+209	X		7.3		X	
0+332	X		4.2		X	
0+507		X	7.3	X		S.E. FAIR
0+526		X	8.5	X		
0+565	X	X	9.7			ALLEN ROAD
0+687	X		7.9	X		
0+767	X		7.9	X		
1+034	X		9.1	X		
1+138		X	30.5	X		
1+264		X	7.3	X		NONE
1+375	X		3.0	X		
1+376		X	3.0	X		
1+432		X	11.0	X		
1+484	X		12.2	X		
1+500	X					
1+544		X	1.2	X		
1+589		X	15.2	X		NONE
1+615		X	16.5	X		
1+636	X		7.9	X		
1+653		X	3.0		X	NONE
1+685	X		21.3	X		
1+740	X					
1+750		X				
1+783		X	1.2		X	
1+794		X	6.10	X		
1+823		X	7.3			
1+855		X	7.3			
1+870	X		4.8	X		
1+974	X		8.5	X		
2+056	X		4.3	X	X	
2+073		X	4.3	X		
2+148		X	7.3	X		
2+177	X		6.1	X		
2+199		X	4.3	X		
2+257	X		7.6	X		
2+260		X	7.6	X		
2+280		X	7.6	X		
2+344	X		9.1	X		
2+349		X	4.3	X		
2+456		X	6.1	X		
2+525	X		6.1		X	
2+555		X	3.0			
2+612		X	4.3	X		
2+667	X		4.3		X	
2+669		X	4.3		X	
2+650		X	4.0			
2+710		X	4.3		X	
2+736	X		4.3	X		
2+761		X	4.6	X		
2+767	X		4.3	X		
2+830	X		6.1		X	
2+915		X	4.3		X	
2+993	X		4.3	X		
3+179		X	11.0	X		
3+188		X	5.5	X		
3+233		X	4.3	X		
3+498	X		6.1	X		
3+546	X		4.6	X		
3+575	X		4.0			
3+645	X		4.3	X		
3+666	X		4.6	X		

# DRIVEWAY SUMMARY

STATION	OFFSET		WIDTH (METER)	EXIST. SURFACE		REMARKS
	LT	RT		PAVED	UNPAVED	
3+713	X		4.6	X		
3+727	X		5.5	X		
3+812	X		4.6	X		
3+828	X		4.6	X		
3+855	X		4.6	X		
3+945	X		4.6	X		
3+995	X		5.5	X		
4+075	X		5.5	X		
4+105	X		4.3	X		
4+170		X	4.3	X		
4+196	X		4.3		X	
4+274	X		6.1		X	
4+090		X	5.0			
4+331	X		4.6	X		
4+200		X	7.5			
4+361	X		4.6	X		
4+471	X		4.3	X		
4+616	X		4.3		X	
4+639	X		4.6	X		NONE
4+727	X		4.3		X	
5+395		X	6.1	X		
5+434	X		6.1	X		
5+727	X		4.0		X	NONE
5+754		X	4.3	X		
6+842	X		4.9	X		
6+963		X	4.9		X	
7+002		X	4.9	X		
7+032	X		4.3		X	
7+085		X	4.9	X		
7+145	X		5.5	X		
7+177	X		4.3		X	
7+392		X	5.5	X		
9+726	X		6.1	X		
"B" 0+045	X					
"B" 0+066		X	8.2	X		
"B" 0+118		X	7.3		X	TOTEM STREET
"B" 0+135		X	6.1		X	
"B" 0+209		X	7.3			PORTAGE STREET
"B" 0+168		X				
"B" 0+186		X				
"B" 0+222		X				
"B" 0+275		X				
3RD AVENUE		X				
2ND AVENUE	X					
2ND AVENUE	X					
1+775		X				
1+830	X					
2+010		X				
"ST" 2+460		X				
"ST" 2+504		X				
"ST" 2+519		X				

# GUARDRAIL SUMMARY

STA. THRU STA.	REMOVE RAIL (METERS)	RECONSTRUCT RAIL (METERS)	END ANCHORS	REMARKS
1+567 LT "B" 0+009 LT	19.05	19.05 LT	2	
3+046 RT 3+176 RT	144.78	129.54 RT 0	+ 0	REMOVE 4 POSTS NO RECONSTRUCT
3+190 RT 3+220 RT	41.91	30.48 RT 0	2 0	REMOVE 3 POSTS NO RECONSTRUCT
4+850 RT 5+014 RT	163.83	163.83 RT	+ 0	160.02 R&R STA. 4+859 TO STA. 5+014
5+062 RT 5+310 RT	247.65	247.65 RT	0	236.22 R&R
5+292 LT 5+318 LT	45.72	0	0	REMOVE ALL POSTS. CONTINUES 19.72m ON SMALL TRACTS RD.
5+323 LT 5+346 LT	45.7238.1	45.72 LT 38.1	0 2	CONTINUES 22.86m ON SMALL TRACTS RD.
5+335 RT 5+388 RT	53.34	53.34 RT	0 0	72.39 R&R STA. 5+335 TO STA. 5+402
5+540 RT 5+700 RT	160.02	160.02 RT	2	72.39 R&R STA. 5+532 TO STA. 5+604
5+576 LT 5+725 LT	160.02	160.02 LT	2 0	152.40 R&R STA. 5+576 TO STA. 5+741
6+913 RT 6+996 RT	182.88	182.88 RT	2	STA. 6+794 TO STA. 6+977
7+121 RT 7+350 RT	228.69	228.69 RT	2 1	232.41 R&R STA. 7+116 TO 7+352
7+377 RT 7+435 RT	60.96	60.96 RT	2 1	76.20 R&R STA. 7+363 TO STA. 7+435
"B" 0+362.8 LT "B" 0+044 LT	7.02	0		
TOTALS	1,554.48 m	1,482.09 m	18	

# MONUMENT SUMMARY

\* MAY HAVE BEEN DESTROYED WHEN INTERSECTION WAS REDONE.

STATION	REMARKS	STATION	REMARKS
0+059.437 PT	DESTROYED PRIOR TO PROJECT	5+079.210 PT	
0+691.555 PC		5+225.211 PC	
0+978.711 PT		5+323.542 PT	
1+484.541 PI		5+497.122 PT	
1+569.984 PI		5+566.456 PC	
1+605.768 PI		5+738.169 PT	
1+638.861 POT		5+777.696 PC	
1+759.476 POST		5+841.857 PT	
1+766.483 PI		5+945.456 PC	
1+843.094 PI		6+040.432 PT	
1+967.726 PC *	NONE LOCATED	6+147.394 PC	
2+010.559 PI *	NONE LOCATED	6+233.533 PT	
2+053.393 PT *	NONE LOCATED	6+389.129 POT	
2+103.292 PC		6+505.922 PC	
2+154.525 PI	NONE LOCATED	6+666.085 PT	
2+202.962 PT		6+755.865 PC	
2+364.224 AP	NONE LOCATED	6+893.218 PT	
2+399.639 PI		7+007.737 PC	
2+453.649 PT		7+104.548 PT	
2+584.479 PC		7+128.423 PC	
2+658.484 PT		7+212.165 PT	
		7+219.795 PC	
2+710.407 PC		7+273.347 PT	
2+836.441 PT		7+401.242 PC	
2+925.242 PC		7+486.577 PT	
3+115.135 PT		7+796.851 PC	
3+342.263 PC		7+879.129 PT	
3+507.847 PT		7+940.150 PC	
3+616.246 PC		8+001.767 PT	
3+807.066 PT		8+166.360 PC	
3+945.823 PC		8+229.894 PT	
		8+301.528 PC	
4+059.219 PT		8+424.507 PT	
4+107.484 PC		8+513.759 PC	
4+242.182 PT		8+618.772 PT	
4+356.646 PC		8+923.083 PC	
4+531.010 PT		9+000.920 PT	
4+577.669 PC		9+063.809 PC	
4+647.269 PT		9+174.576 PT	
4+823.187 PC		9+331.809 PC	
4+876.438 PT		9+426.581 PT	
4+954.315 PC			
2+340.7 POT	SET PRIOR TO 6-15-94		
2+346.5 POT	SET PRIOR TO 6-15-94		
"B" 0+080 POT	SET PRIOR TO 6-15-94		

PATH: F:\VINS\MUDBAY\CR\SUM 1-1		
BY:	DATE:	DESCRIPTION OF CHANGE:
RECORD OF REVISIONS		

STATE OF ALASKA  
DEPARTMENT OF TRANSPORTATION  
AND PUBLIC FACILITIES  
SOUTHEAST REGION DESIGN & CONSTRUCTION

HAINES

HAINES

ALASKA

MUD BAY ROAD REPAVING  
PROJECT NO. 71358

MISCELLANEOUS SUMMARIES

NOTE: DO NOT SCALE FROM THESE PLANS-USE DIMENSIONS

DESIGNED BY: P. JONES	PROJECT NO. 71358
DRAWN BY: AUTOCAD/WDA	DATE: 9/93
CHECKED BY: P. BEDNAROWICZ	SHEET 6 OF 12

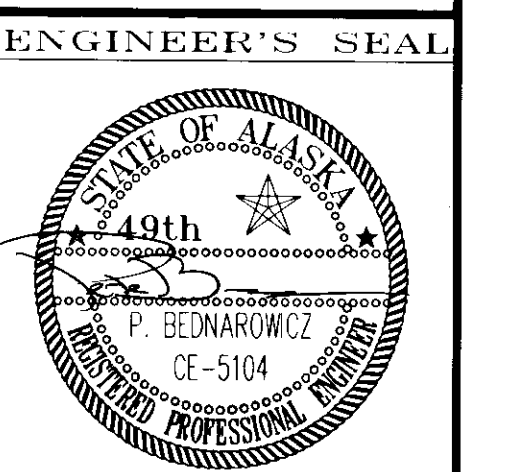

NOTE: SIGNING SUMMARY CONTINUED ON SHEETS 8 AND 9.

**SIGNING SUMMARY**

SIGN NO.	STATION	OFFSET		TYPE	FACING TRAFFIC	LEGEND	POST SIZE	NO. OF POSTS	WIDTH IN.	HEIGHT IN.	AREA Ft <sup>2</sup>	AREA m <sup>2</sup>	REMARKS
		LT.	RT.										
1	0+080		X	D3-1	NB & SB	HAINES HWY			36	8	2	0.19	INSTALL ABOVE STOP SIGN
				R1-1	NB	STOP	2.5" PST	1	30	30	6.25	0.58	
2	0+159		X	R2-1	SB	SPEED LIMIT 35	2.5" PST	1	30	36	7.50	0.70	
3	0+300	X		W3-1	NB	STOP AHEAD SYMBOL	2.5" P	1	36	36	9	0.811	
				W3-1	NB	STOP AHEAD			24	18	3	0.28	INSTALL BELOW STOP AHEAD SYMBOL SIGN
—	0+349	X				1		1	6	8			REMOVE MILEPOST SIGN, POST AND FOUNDATION
4	0+505		X	D1-1	SB	S.E. STATE FAIR							EXIST. TO REMAIN IN PLACE. REMOVE BACK SIDE SIGN PANEL.
5	0+535			D3-1	EB	HAINES HWY			36	8	2	0.19	INSTALL ABOVE FAIR DR SIGN
			X	D3-1	NB & SB	FAIR DR	2.5" PST	1	30	8	1.67	0.15	INSTALL ABOVE STOP SIGN
				R1-1	EB	STOP			30	30	6.25	0.58	
6	0+540		X	S1-1	SB	SCHOOL ADVANCE	2.5" PST	1	36	36	9	0.84	
7	0+550	X			NB	S.E. STATE FAIR	2.5" PST	1					INSTALL REMOVED SIGN FROM 0+505 RT.
8	0+564			D3-1	WB	HAINES HWY			36	8	2	0.19	INSTALL ABOVE ALLEN ROAD SIGN
		X		D3-1	WB & SB	ALLEN RD	2.5" PST	1	30	8	1.67	0.15	INSTALL ABOVE STOP SIGN
				R1-1	WB	STOP			30	30	6.25	0.58	
9	0+591		X	S5-2	SB	SCHOOL SPEED LIMIT 20 WHEN CHILDREN ARE PRESENT	2.5" PST	1	24	48	8	0.74	
10	0+591	X		S6-1	NB	END SCHOOL ZONE	2.5" P	1	30	12	2.5	0.23	INSTALL ABOVE SPEED LIMIT
		X		R2-1	NB	SPEED LIMIT 35			30	36	7.5		
11	0+655	X		W11-11	NB	HORSE SYMBOL	2.5" P	1	36	36	9	0.84	
12	0+762			D9-10	SB	QUESTIONS SYMBOL			24	24	4	0.37	
			X	D9-10	SB	INFORMATION	2.5" PST	1	24	6	1	0.09	INSTALL BELOW QUESTION SYMBOL
				D9-10	SB	1500 FT.			24	6	1	0.09	INSTALL BELOW INFORMATION SIGN
13	0+960	X		S5-2	NB	SCHOOL SPEED LIMIT 20 WHEN CHILDREN ARE PRESENT	2.5" PST	1	24	48	8	0.74	
14	0+960		X	S6-1	SB	END SCHOOL ZONE			30	12	2.5	0.23	INSTALL ABOVE SPEED LIMIT
			X	R2-1	SB	SPEED LIMIT 35	2.5" P	1	30	36	7.5	0.70	
15	1+015	X		S1-1	NB	SCHOOL ADVANCE	2.5" PST	1	36	36	9	0.84	
16	1+011		X	W11-8	SB	FIRE TRUCK SYMBOL	2.5" PST	1	30	30	6.25	0.58	
				W11-8	SB	FIRE STATION			24	18	3	0.28	INSTALL BELOW FIRE TRUCK SIGN
17	1+050	X		R2-1	NB	SPEED LIMIT 35	2.5" PST	1	30	36	7.5	0.70	

**GENERAL SIGNING NOTES:**

- NEW SIGNS WITH NEW POST SHALL USE "EXPRESSWAY" DIMENSIONS AS SHOWN ON STANDARD DRAWING S-05.00.
- EXISTING SIGNS REMOVED SHALL BE DELIVERED TO THE D.O.T. MAINTENANCE YARD LOCATED NEAR THE BEGINNING OF THE PROJECT.
- ALL NEW PIPE POSTS (P) SHALL HAVE MULTIDIRECTIONAL BREAKAWAY BASES PER STANDARD SPECIFICATION 615-2.01.
- ALL NEW PERFORATED STEEL TUBE (PST) POSTS SHALL HAVE EITHER CONCRETE OR SOIL EMBEDMENT FOUNDATION WITH A DEPTH ACCORDING TO STANDARD DRAWING S-30.01.



NOTE: DO NOT SCALE FROM THESE PLANS-USE DIMENSIONS

RECORD OF REVISIONS		
PATH:	F:\HNS\MUDBAY\DR\SUM\ 1 1	
BY:	DATE:	DESCRIPTION OF CHANGE:

STATE OF ALASKA  
**DEPARTMENT OF TRANSPORTATION AND PUBLIC FACILITIES**  
 SOUTHEAST REGION DESIGN & CONSTRUCTION

HAINES  
 HAINES  
 MUD BAY ROAD REPAVING  
 PROJECT NO. 71358  
**SIGNING SUMMARY**

ALASKA  
 DESIGNED BY: P. JONES  
 DRAWN BY: AUTOCAD/CSA  
 CHECKED BY: P. BEDNAROWICZ

PROJECT NO. 71358  
 DATE: 9/93  
 SHEET 7 OF 12

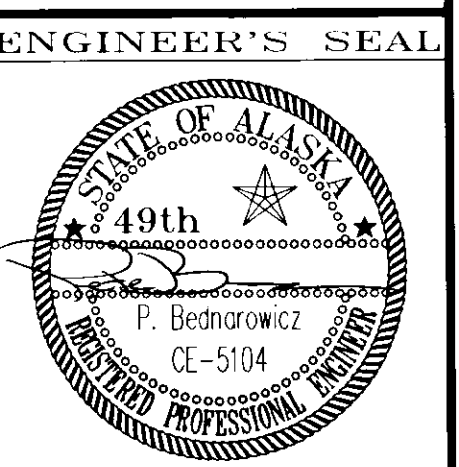

**SIGNING SUMMARY (CONTINUED)**

SIGN NO.	STATION	OFFSET		TYPE	FACING TRAFFIC	LEGEND	POST SIZE	NO. OF POSTS	WIDTH IN.	HEIGHT IN.	AREA Ft <sup>2</sup>	AREA m <sup>2</sup>	REMARKS	
		LT.	RT.											
18	1+055	X		D3-1	EB & WB	HAINES HWY.			36	8	2	0.19	INSTALL ABOVE THIRD AV SIGN	
				D3-1	NB & SB	THIRD AV	2.5" PST	1	30	8	1.67	0.15	INSTALL ABOVE STOP SIGN	
				R1-1	WB	STOP				30	30	6.25	0.58	
19	1+110		X	D3-1	EB & WB	HAINES HWY.			36	8	2	0.19	INSTALL ABOVE THIRD AV SIGN	
				D3-1	NB & SB	THIRD AV	2.5" PST	1	30	8	1.67	0.15	INSTALL ABOVE STOP SIGN	
				R1-1	WB	STOP				30	30	6.25	0.58	
20	1+150	X		W11-8	NB	FIRE TRUCK SYMBOL	2.5" PST	1	30	30	6.25	0.58		
				W11-8	NB	FIRE STATION				24	18	3	0.28	INSTALL BELOW FIRE TRUCK SIGN
				D9-10	SB	QUESTIONS SYMBOL				24	24	4	0.37	
21	1+175		X	D9-10	SB	INFORMATION	2.5" PST	1	24	6	1	0.09	INSTALL BELOW QUESTION SYMBOL	
				D9-10	SB	INFORMATION				24	6	1	0.09	INSTALL BELOW INFORMATION SIGN
				D9-10	SB	INFORMATION				24	6	1	0.09	INSTALL BELOW INFORMATION SIGN
22	0+200	X		D3-1	EB & WB	HAINES HWY.			36	8	2	0.19	INSTALL ABOVE SECOND AV SIGN	
				D3-1	NB & SB	SECOND AV	2.5" PST	1	30	8	1.67	0.15	INSTALL ABOVE STOP SIGN	
				R1-1	WB	STOP				30	30	6.25	0.58	
23	1+245		X	D3-1	EB & WB	HAINES HWY.			36	8	2	0.19	INSTALL ABOVE SECOND AV SIGN	
				D3-1	NB & SB	SECOND AV	2.5" PST	1	30	8	1.67	0.15	INSTALL ABOVE STOP SIGN	
				R1-1	WB	STOP				30	30	6.25	0.58	
24	1+258	X		W11-8	NB	FIRE TRUCK SYMBOL	2.5" PST	1	30	30	6.25	0.58		
				W11-8	NB	FIRE STATION				36	8	2	0.19	INSTALL BELOW FIRE TRUCK SIGN
				R2-1	SB	SPEED LIMIT 35	2.5" PST	1	30	36	7.5	0.70		
25	1+275		X	R2-1	SB	SPEED LIMIT 35	2.5" PST	1	30	36	7.5	0.70		
26	1+367		X	R2-1	SB	SPEED LIMIT 35	2.5" PST	1	30	36	7.5	0.70		
27	1+470		X	D1-2	SB	PORTAGE COVE CHILKAT STATE PARK	3" P	2	138	24	23	21.4	6" U.C. 4.5" L.C.	
				D7-2A(R)	SB	FORT SEWARD				107	30	22.29	2.07	INSTALL BELOW OTHER SIGN-SEE DETAIL @ RIGHT
				D3-1(SPECIAL)	NB	HAINES HWY. BEACH RD				48	16	5.33	0.49	INSTALL ABOVE STOP SIGN
28	1+581	X		D3-1	SB	MUD BAY RD	2.5" P	1	36	8	2	0.19	INSTALL ABOVE HAINES HWY SIGN	
				R1-1	NB	STOP				30	30	6.25	0.58	
				R2-1	SB	SPEED LIMIT 25	2.5" PST	1	30	36	7.5	0.70		
29	1+661		X	D3-1	EB	MUD BAY RD			36	8	2	0.19	INSTALL ABOVE FORT SEWARD DR SIGN	
				D3-1	NB & SB	FORT SEWARD DR	2.5" PST	1	42	8	2.33	0.22	INSTALL ABOVE STOP SIGN	
				R1-1	WB	STOP				30	30	6.25	0.58	
31	1+801		X	D3-1	EB	MUD BAY RD			36	8	2	0.19	INSTALL ABOVE SECOND AV SIGN	
				D3-1	NB & SB	SECOND AV	2.5" PST	1	30	8	1.67	0.15	INSTALL ABOVE STOP SIGN	
				R1-1	WB	STOP				30	30	6.25	0.58	
32	1+907		X	W3-1	SB	STOP AHEAD SYMBOL	2.5" PST	1	36	36	9	0.84		
				W3-1	SB	STOP AHEAD				24	18	3	0.28	INSTALL BELOW STOP AHEAD SYMBOL SIGN
				D3-1	WB	MUD BAY RD				36	8	2	0.19	INSTALL ABOVE FAA RD SIGN
33	1+969	X		D3-1	NB & SB	FAA RD	2.5" PST	1	24	8	1.33	0.12	INSTALL ABOVE STOP SIGN	
				R1-1	WB	STOP				30	30	6.25	0.58	
				D3-1(SPECIAL)	SB	MUD BAY RD				46	16	5.11	0.47	INSTALL ABOVE STOP SIGN
34	* 1+998		X	D3-1	NB & SB	MUD BAY RD	2.5" P	1	36	8	2	0.19	INSTALL ABOVE MUD BAY RD SIGN	
				R1-1	SB	STOP				30	30	6.25	0.58	
				D3-1	EB	MUD BAY RD				36	8	2	0.19	INSTALL ABOVE CHURCHILL ST SIGN
35	2+153	X		D3-1	NB & SB	CHURCHILL ST	2.5" PST	1	42	8	2.33	0.22	INSTALL ABOVE STOP SIGN	
				R1-1	EB	STOP				30	30	6.25	0.58	
				R2-1	NB	SPEED LIMIT 25	2.5" PST	1	30	30	7.5	0.70		
36	2+209		X	R2-1	NB	SPEED LIMIT 25	2.5" PST	1	30	30	7.5	0.70		
37	2+209		X	R2-1	SB	SPEED LIMIT 35	2.5" PST	1	30	36	7.25	0.67		
38	2+327		X	D1-2	SB	SMALL TRACTS RD CHILKAT STATE PARK	2.5" PST	2	138	24	23	2.14	6" U.C. & 4.5" L.C.	
				D3-1	EB&WB	MUD BAY RD				36	8	2	0.19	INSTALL ABOVE TOWER RD SIGN
				D3-1	NB&SB	TOWER RD	2.5" PST	1	30	8	1.67	0.15	INSTALL ABOVE STOP SIGN	
39	2+334	X		R1-1	WB	STOP			30	30	6.25	0.58		
				D3-1	EB&WB	MUD BAY RD				36	8	2	0.19	INSTALL ABOVE TOWER RD SIGN
				D3-1	NB&SB	TOWER RD	2.5" PST	1	30	8	1.67	0.15	INSTALL ABOVE STOP SIGN	
40	2+338		X	R1-1	EB	STOP			30	30	6.25	0.58		
				D3-1	NB&SB	TOWER RD	2.5" PST	1	30	8	1.67	0.15	INSTALL ABOVE STOP SIGN	
				D3-1(SPECIAL)	NB	MUD BAY RD				42	16	4.67	0.43	INSTALL ABOVE STOP SIGN
41	2+413	X		D3-1	SB	MUD BAY RD	2.5" P	1	36	8	2	0.19	INSTALL ABOVE MUD BAY RD SIGN	
				R1-1	NB	STOP				30	30	6.25	0.58	
				D1-2	NB	HAINES SMALL TRACTS RD	2.5" P	2	120	24	20	1.86	6" U.C. & 4.5" L.C.	
42	2+450		X	D1-2	NB	HAINES SMALL TRACTS RD	2.5" P	2	120	24	20	1.86	6" U.C. & 4.5" L.C.	

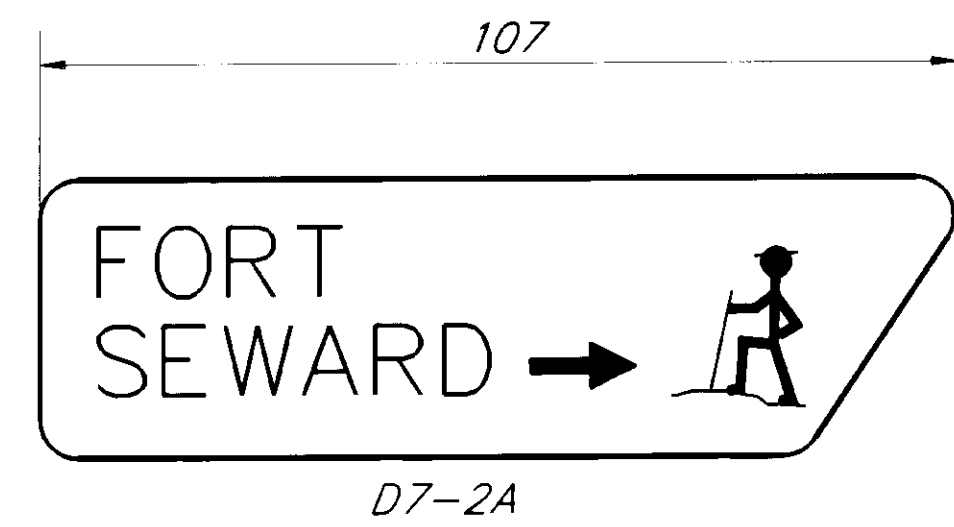

RECORD OF REVISIONS		
PATH:	I:\VANS\MUDBAY\DR\SUMS 1-1	
BY:	DATE:	DESCRIPTION OF CHANGE:

STATE OF ALASKA  
DEPARTMENT OF TRANSPORTATION  
AND PUBLIC FACILITIES  
SOUTHEAST REGION DESIGN & CONSTRUCTION

HAINES  
HAINES  
ALASKA  
MUD BAY ROAD REPAVING  
PROJECT NO. 71358  
**SIGNING SUMMARY**

NOTE: DO NOT SCALE FROM THESE PLANS-USE DIMENSIONS

DESIGNED BY: P. JONES	PROJECT NO. 71358
DRAWN BY: AUTOCAD/CSA	DATE: 9/93
CHECKED BY: P. BEDNAROWICZ	SHEET 8 OF 12

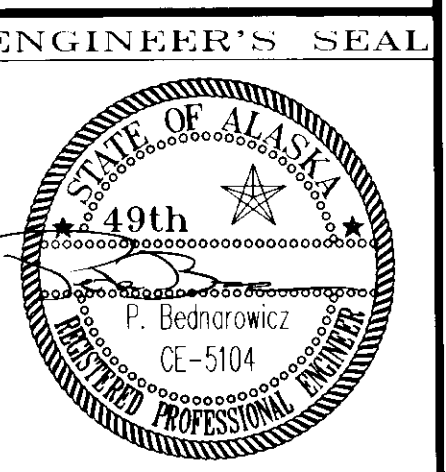



**SIGNING SUMMARY (CONTINUED)**

SIGN NO.	STATION	OFFSET		TYPE	FACING TRAFFIC	LEGEND	POST SIZE	NO. OF POSTS	WIDTH IN.	HEIGHT IN.	AREA Ft <sup>2</sup>	AREA m <sup>2</sup>	REMARKS
		LT.	RT.										
43	2+472		X	W7-1	SB	STEEP GRADE SYMBOL	2.5" P	1	36	36	9	0.84	INSTALL BELOW STEEP GRADE SIGN
		X		W7-3	SB	9% GRADE	2.5" P	1	24	18	3	0.28	
44	2+503		X	W3-1	NB	STOP AHEAD SYMBOL	2.5" P	1	36	36	9	0.84	INSTALL BELOW STOP AHEAD SIGN
		X		W3-1	NB	STOP AHEAD	2.5" P	1	24	18	3	0.28	
45	2+503		X	R2-1	SB	SPEED LIMIT 30	2.5" P	1	30	36	7.5	0.70	6" U.C. , 4.5" L.C. & 4" U.C.
46	2+764	X		I2-A	NB	HAINES CITY LIMITS	2.5" PST	2	66	24	11	1.02	
47	3+210		X	R2-1	SB	SPEED LIMIT 30	2.5" PST	1	30	36	7.5	0.70	
48	4+958	X		R2-1	NB	SPEED LIMIT 30	2.5" PST	1	30	36	7.5	0.70	
49	5+225		X	W3-1	SB	STOP AHEAD SYMBOL	2.5" P	1	36	36	9	0.84	INSTALL BELOW STOP AHEAD SIGN
		X		W3-1	SB	STOP AHEAD	2.5" P	1	24	18	3	0.28	
50	5+300	X		R2-1	NB	SPEED LIMIT 30	2.5" PST	1	30	36	7.5	0.70	
51	5+300	X		R2-1	SB	SPEED LIMIT 35	2.5" PST	1	30	36	7.5	0.70	LOCATE ON SMALL TRACTS RD
52	5+321		X	D3-1(SPECIAL)	SB	← MUD BAY RD	2.5" P	1	46	16	5.11	0.47	INSTALL ABOVE MUD BAY RD SIGN
		X		D3-1	NB&WB	MUD BAY RD	2.5" P	1	36	8	2	0.19	
				R1-1	SB	STOP	2.5" P	1	30	30	6.25	0.58	REMOVE SIGN
53	5+325	X		D1-2	SB	← HAINES	2.5" PST	2	96	24	16	0.35	
54	5+375	X		D1-1	NB	← HAINES	2.5" PST	2	42	12	3.5	1.49	6" U.C. & 4.5" L.C.
55	5+448		X	R2-1	SB	SPEED LIMIT 35	2.5" PST	1	30	36	7.5	0.70	
56	5+790	X		W1-5R	NB	2	2.5" P	1	36	36	9	0.84	
57	6+309		X	I-4A	SB	← MT. RILEY TRAIL	2.5" P	1	42	54	15.75	1.46	
58	6+360		X	W7-1	NB	STEEP GRADE SYMBOL	2.5" P	1	36	36	9	0.84	INSTALL BELOW STEEP GRADE SIGN
		X		W7-3	NB	9% GRADE	2.5" P	1	24	18	3	0.28	
59	6+360		X	W7-1	SB	STEEP GRADE SYMBOL	2.5" P	1	36	36	9	0.84	INSTALL BELOW STEEP GRADE SIGN
			X	W7-3	SB	9% GRADE	2.5" P	1	24	18	3	0.28	EXISTING TO REMAIN IN PLACE
60	6+385		X		SB	MT. RILEY TRAIL PARKING AREA	2.5" P	1	36	36	9	0.84	
61	6+734		X	W1-5R	SB	2	2.5" P	1	36	36	9	0.84	
62	7+311		X	W1-5R	NB	2	2.5" P	1	36	36	9	0.84	
	7+460	X				4	2.5" P	2	6	8			REMOVE MILEPOST SIGN, POST AND FOUNDATION
63	9+193		X	D2-2	SB	CHILKAT STATE PARK 5 MI	2.5" PST	2	72	24	12	1.11	6" U.C. & 4.5" L.C.
64	9+611		X	W1-1R	SB	25 M.P.H.	2.5" P	1	36	36	9	0.84	INSTALL BELOW RIGHT TURN SIGN
		X		W1-3-1	SB	25 M.P.H.	2.5" P	1	24	24	4	0.37	
65	9+667	X		R2-1	NB	SPEED LIMIT 35	2.5" PST	1	30	36	7.5	0.70	
66	9+680		X	W5-1	SB	ROAD NARROWS	2.5" P	1	36	36	9	0.84	
67	"B" 0+00		X	W1-7	NB	2	2.5" PST	2	48	24	8	0.74	REFLECTOR, INSTALL BELOW ← → SIGN
		X		OM-1	NB	2	2.5" PST	2	24	24	2	0.19	
68	"B" 0+043		X	D3-1	EB&WB	BEACH RD	2.5" PST	1	30	8	1.67	0.15	INSTALL ABOVE FRONT ST SIGN
		X		D3-1	NB&SB	FRONT ST	2.5" PST	1	30	8	1.67	0.15	
				R1-1	EB	STOP	2.5" PST	1	30	30	6.25	0.58	
69	"B" 0+071		X	R1-1	EB	STOP	2.5" PST	1	30	30	6.25	0.58	
70	"B" 0+090		X	R2-1	NB	SPEED LIMIT 35	2.5" PST	1	30	36	7.5	0.70	
71	"B" 0+090		X	R2-1	SB	SPEED LIMIT 20	2.5" PST	1	30	36	7.5	0.70	
72	"B" 0+122		X	D3-1	EB	BEACH RD	2.5" PST	1	30	8	1.67	0.15	INSTALL ABOVE TOTEM ST SIGN
		X		D3-1	NB&SB	TOTEM ST	2.5" PST	1	30	8	1.67	0.15	
				R1-1	EB	STOP	2.5" PST	1	30	30	6.25	0.58	
73	"B" 0+214		X	D3-1	EB&WB	BEACH RD	2.5" PST	1	30	8	1.67	0.15	INSTALL ABOVE PORTAGE ST SIGN
		X		D3-1	NB&SB	PORTAGE ST	2.5" PST	1	30	8	1.67	0.15	
				R1-1	EB	STOP	2.5" PST	1	30	30	6.25	0.58	

PATH: P: \HNS\MUDBAY\DR\SUM4 1-1		
BY:	DATE:	DESCRIPTION OF CHANGE:
<b>RECORD OF REVISIONS</b>		

STATE OF ALASKA  
DEPARTMENT OF TRANSPORTATION  
AND PUBLIC FACILITIES  
SOUTHEAST REGION DESIGN & CONSTRUCTION

HAINES  
HAINES  
MUD BAY ROAD REPAVING  
PROJECT NO. 71358  
ALASKA  
**SIGNING SUMMARY**

DESIGNED BY: <b>P. JONES</b>	PROJECT NO. <b>71358</b>
DRAWN BY: <b>AUTOCAD/CSA</b>	DATE: <b>9/93</b>
CHECKED BY: <b>P. BEDNAROWICZ</b>	SHEET <b>9 OF 12</b>

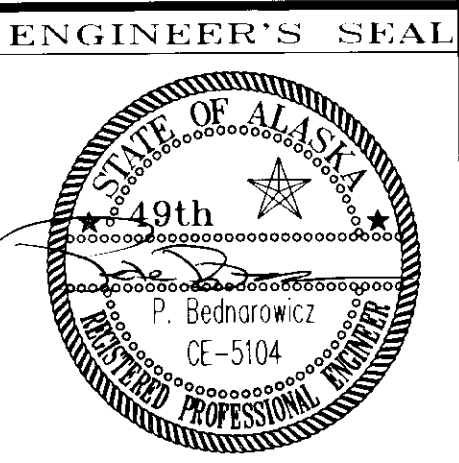

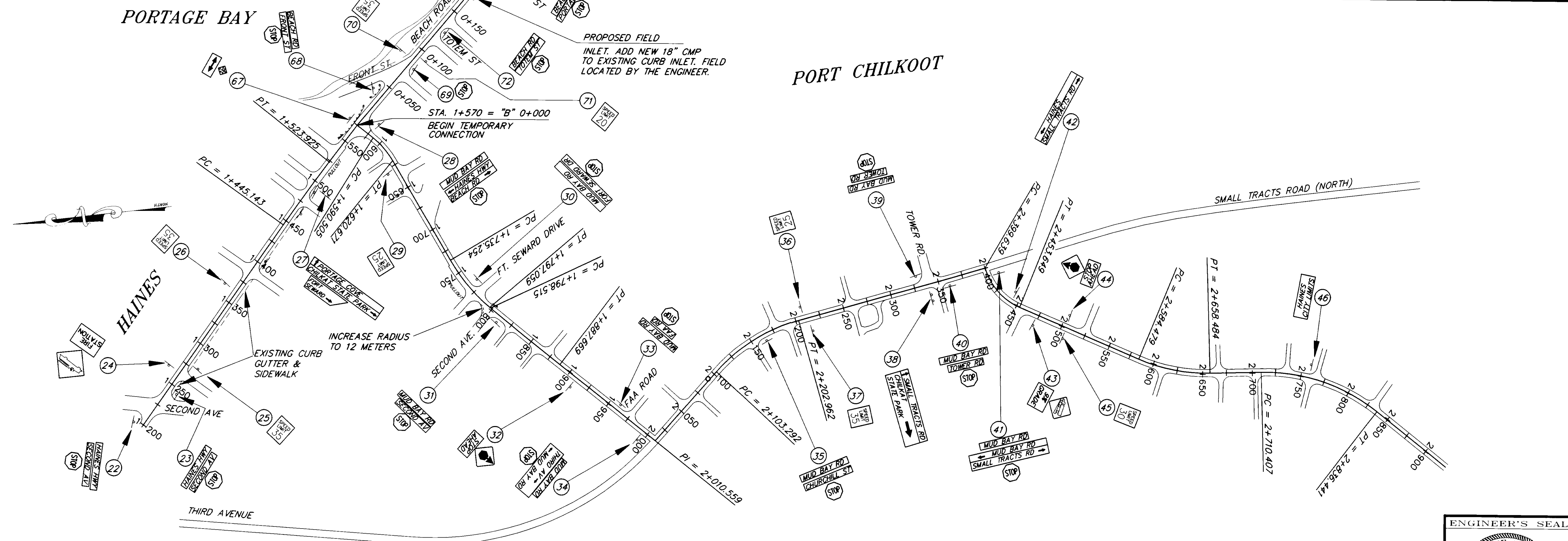
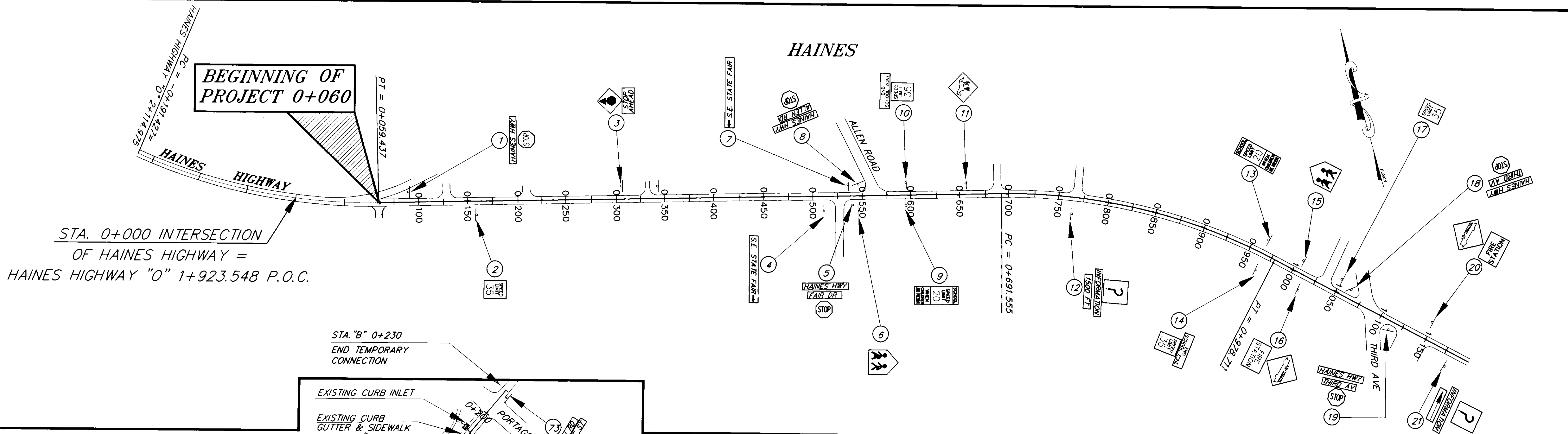

RECORD OF REVISIONS	
PATH:	P:\VINS\MUDBAY\DR\F0191 1-2 (MLTRC)
BY:	
DATE:	
DESCRIPTION OF CHANGE:	

STATE OF ALASKA  
 DEPARTMENT OF TRANSPORTATION  
 AND PUBLIC FACILITIES  
 SOUTHEAST REGION DESIGN & CONSTRUCTION

HAINES HAINES ALASKA  
 MUD BAY ROAD REPAVING  
 PROJECT NO. STP-0987(6) (71358)  
**PLAN SHEET ~ STA. 0+000 TO STA. 2+900**

DESIGNED BY:	P. BEDNAROWICZ	PROJECT NO.	71358
DRAWN BY:	C. ANDERSON/PB	DATE:	9/93
CHECKED BY:	T.W. MOORE	SHEET	10 OF 12

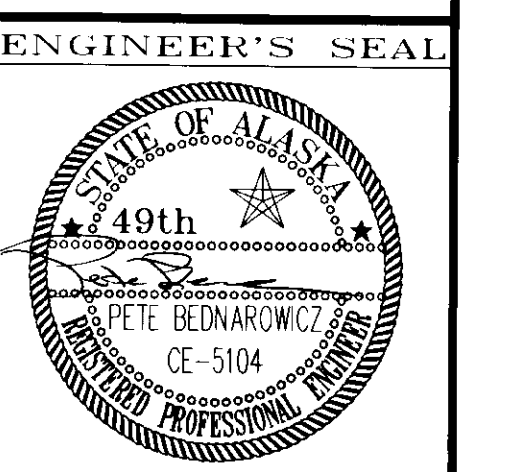

NOTE: DO NOT SCALE FROM THESE PLANS-USE DIMENSIONS

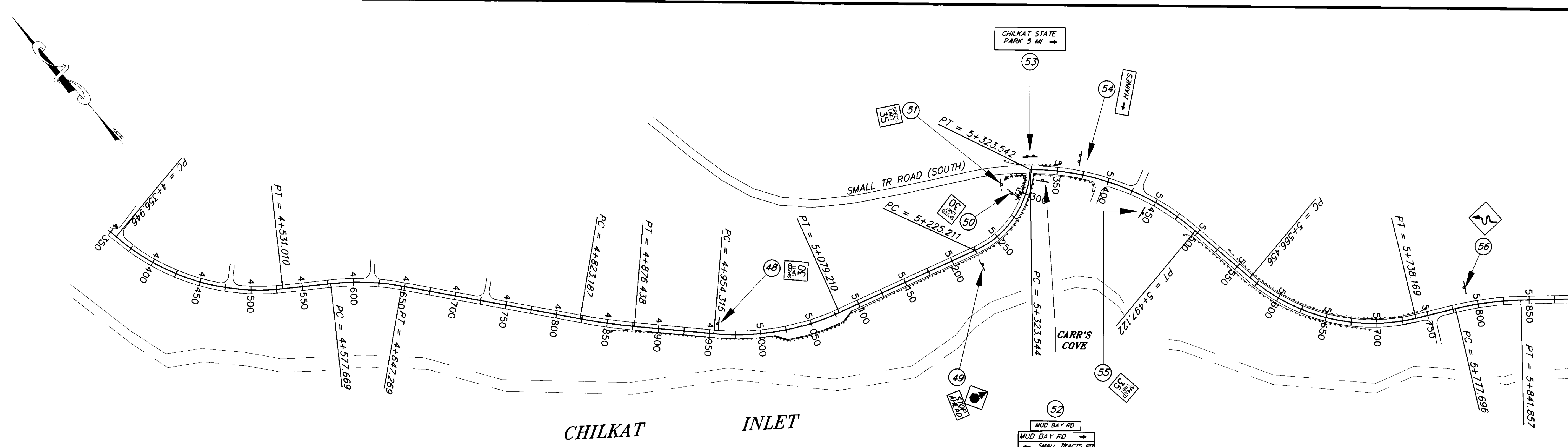
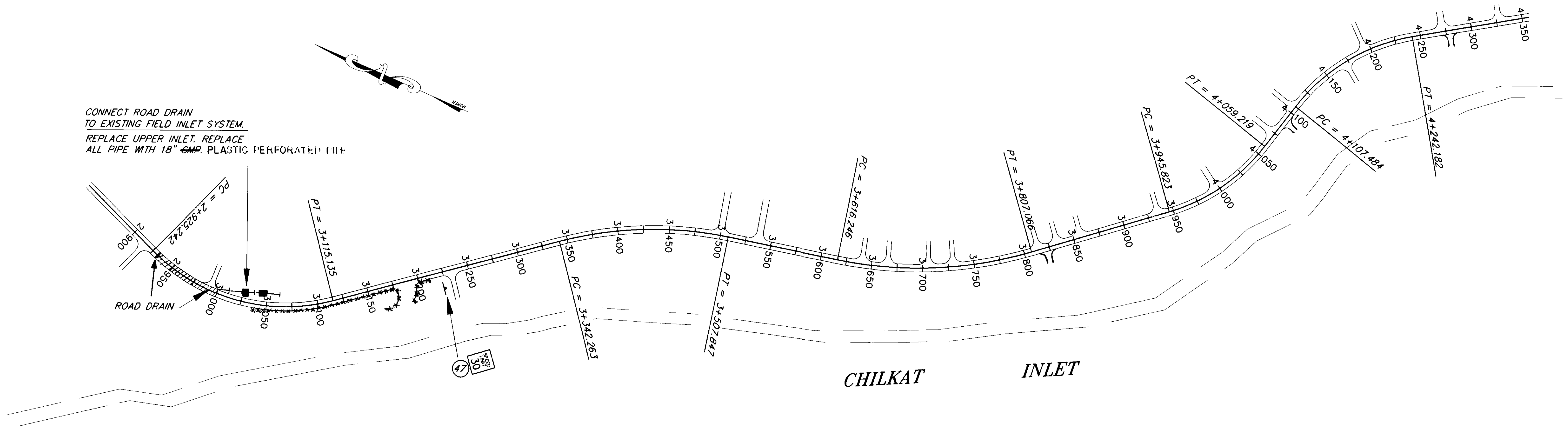

RECORD OF REVISIONS		
NO.	DATE	DESCRIPTION OF CHANGE

STATE OF ALASKA  
 DEPARTMENT OF TRANSPORTATION  
 AND PUBLIC FACILITIES  
 SOUTHEAST REGION DESIGN & CONSTRUCTION

HAINES  
 ALASKA  
 HAINES  
 MUD BAY ROAD REPAVING  
 PROJECT NO. STP-0987(6) (71358)  
**PLAN SHEET ~ STA. 2+900 TO STA. 5+900**

NOTE: DO NOT SCALE FROM THESE PLANS-USE DIMENSIONS

DESIGNED BY: P. BEDNAROWICZ	PROJECT NO. 71358
DRAWN BY: C. ANDERSON/PB	DATE: SEPT. 1993
CHECKED BY: T.W. MOORE	SHEET 11 OF 12

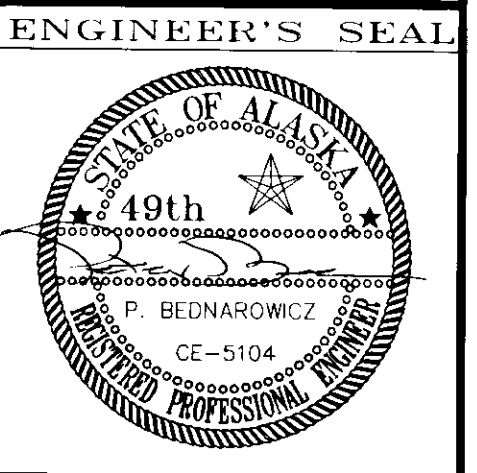

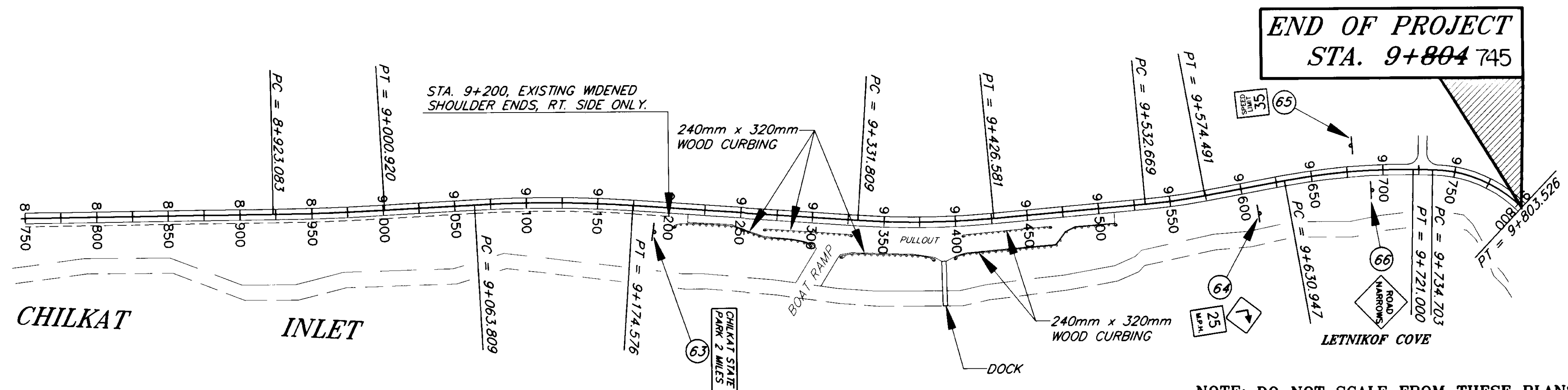
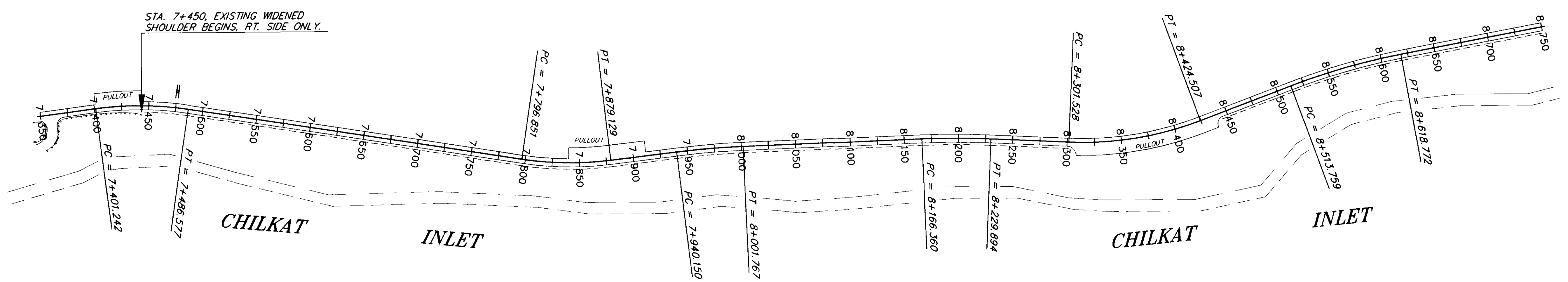
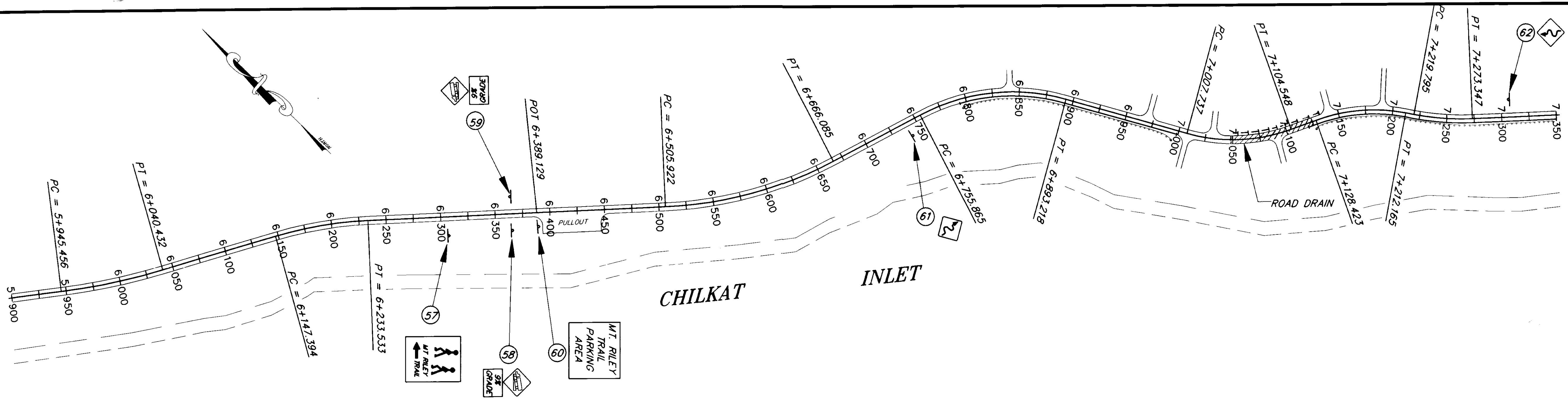

NOTE: DO NOT SCALE FROM THESE PLANS—USE DIMENSIONS

PATH: P:\HVS\MUDBAY\DR\F5900 1-2 (MLTRIC)	
BY:	DATE:
DESCRIPTION OF CHANGE:	
RECORD OF REVISIONS	

STATE OF ALASKA  
 DEPARTMENT OF TRANSPORTATION  
 AND PUBLIC FACILITIES  
 SOUTHEAST REGION DESIGN & CONSTRUCTION

HAINES ALASKA  
 HAINES  
 MUD BAY ROAD REPAVING  
 PROJECT NO. STP-0987(8) (71358)  
**PLAN SHEET ~ STA. 5+900 TO STA. 9+804**

DESIGNED BY: P. BEDNAROWICZ	PROJECT NO. 71358
DRAWN BY: C. ANDERSON/PB	DATE: 9/93
CHECKED BY: T.W. MOORE	SHEET 12 OF 12

