

U. S. DEPARTMENT OF THE INTERIOR

OFFICE OF TERRITORIES

A L A S K A P U B L I C W O R K S

Project No. Aaa. 50 - A - 290

SMALL BOAT HARBOR

HAINES , ALASKA

FELIX J. TONER, REGISTERED ENGINEER

JUNEAU, ALASKA

Set No. _____

DEPARTMENT OF THE INTERIOR
ALASKA PUBLIC WORKS
AS-BUILT DRAWING
APPROVED: *[Signature]* DIRECTOR
JUNEAU, ALASKA Date AUG 1961

As CONSTRUCTED ~ AUGUST, 1961

**SECTION II
BASIN EXCAVATION**

**SECTION I
ROCK BREAKWATER**

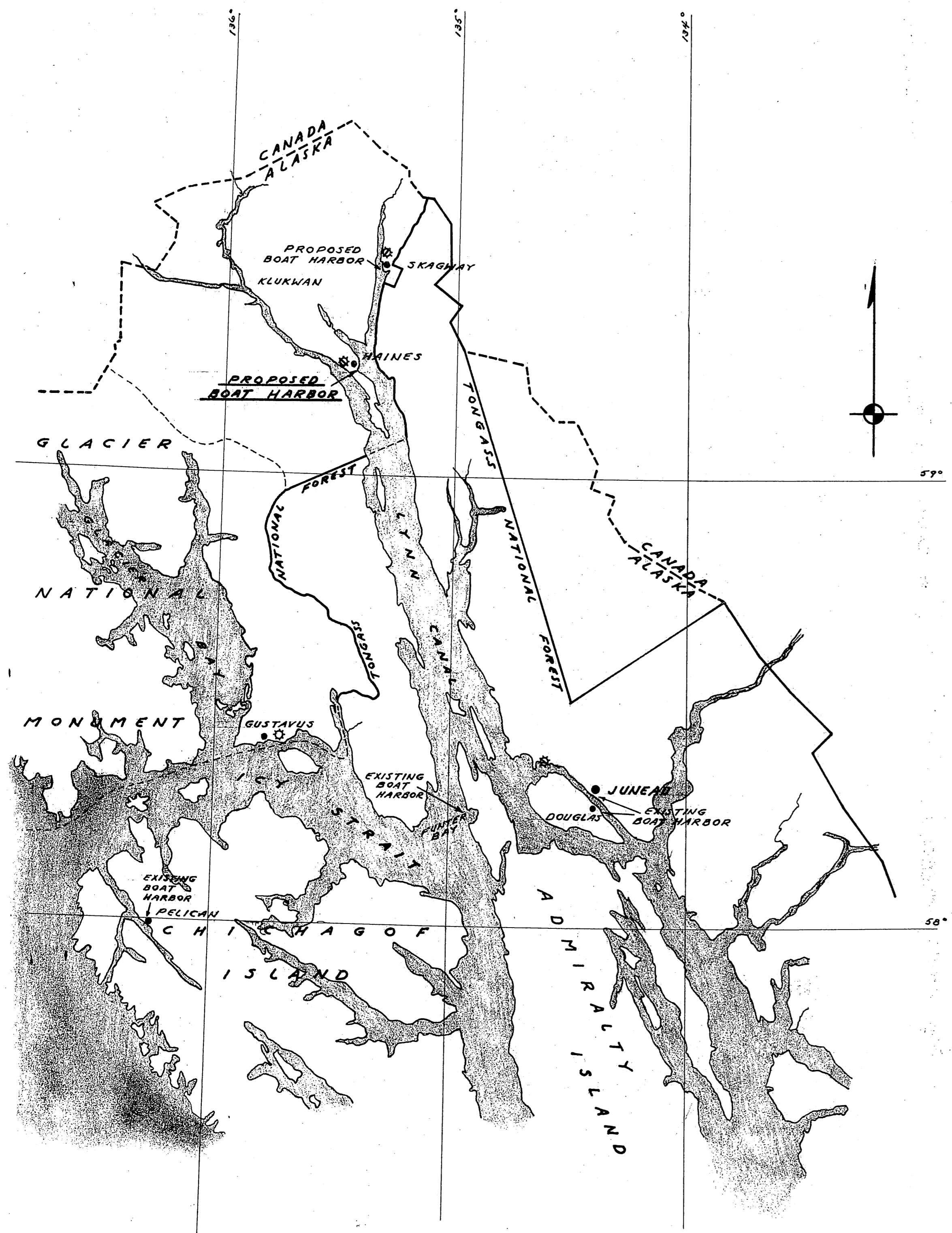

VICINITY MAP
SOUTHEAST ALASKA
SCALE: 1" = 12 MILES

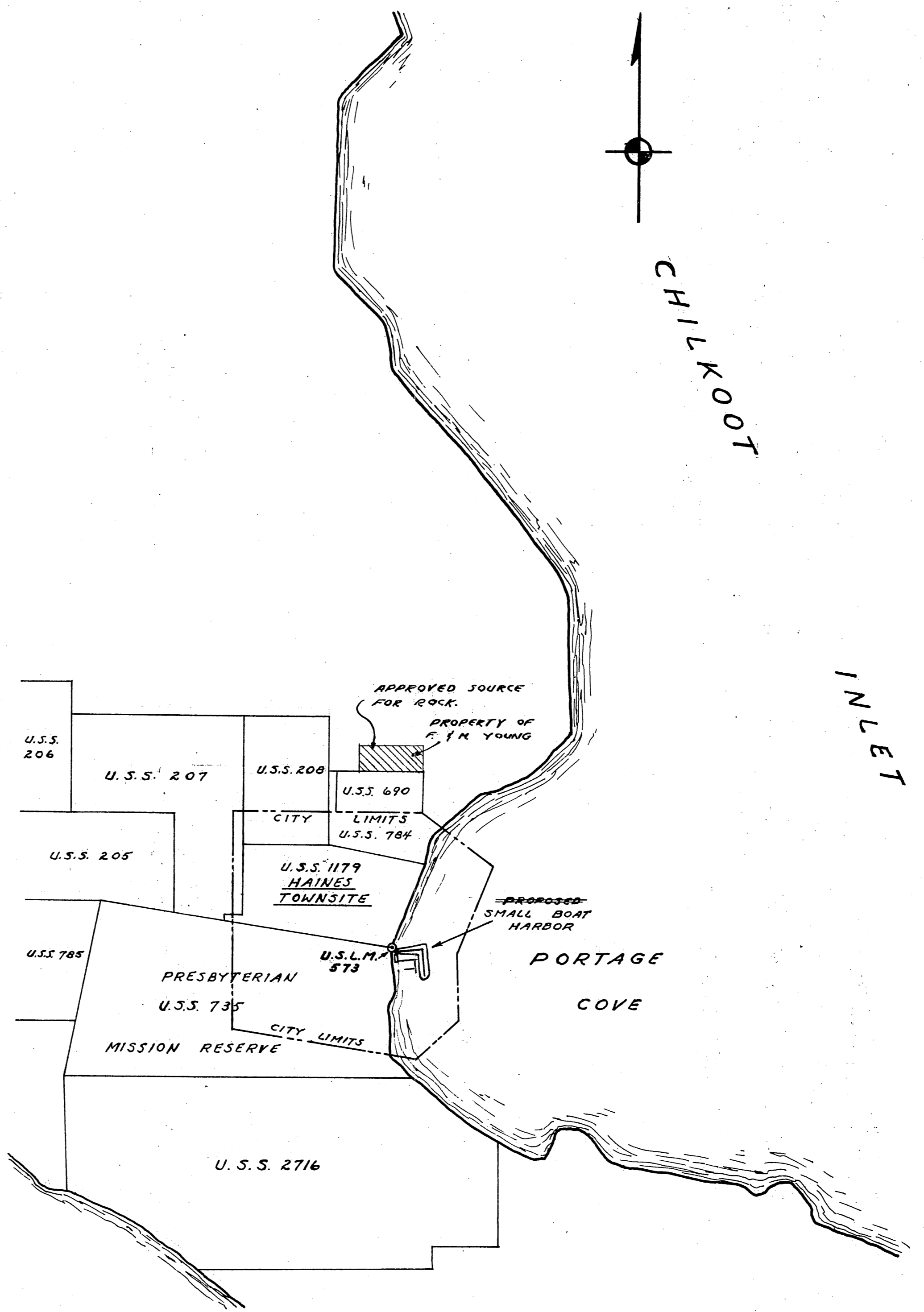

LOCATION MAP
HAINES SMALL BOAT HARBOR
SCALE: 1" = 20 CHAINS

ESTIMATED CONSTRUCTION QUANTITIES

ITEM	EST. QUANTITY	BID ITEM
SECTION I		
ROCK BREAKWATER	35,680 CU.YD.	LUMP SUM
(UNDER CONTRACT 50-A-290, SECTION I)		
SECTION II		
BASIN EXCAVATION	109,700 CU.YD.	CU.YD.
(UNDER CONTRACT 50-A-290, SECTION II)		

INDEX

TITLE	SHEET NO.
TITLE SHEET	0 of 8
VICINITY and LOCATION MAPS	1 of 8
PLAN and DETAILS	2 of 8
PLAN and DETAILS	3 of 8

APPROVED for TERRITORY of ALASKA
By Frank A. Metcalf
FRANK A. METCALF
ALASKA HIGHWAY COMMISSIONER
DATE 7/4/57

Date _____
These plans have been approved by the City Council and Mayor of Haines
John Thompson
Mayor,
Attest Dorothy M. Allen
City Clerk

AS CONSTRUCTED ~ AUGUST 1961

U.S. DEPARTMENT of the INTERIOR - OFFICE of TERRITORIES

ALASKA PUBLIC WORKS
Project No. 50-A-290 HAINES, ALASKA

VICINITY and LOCATION MAPS
HAINES BOAT HARBOR

Scale: As Noted Sheet 1 of 8

Designed: F. J. T.	APPROVED: <u>Felix J. Toner</u>
Drawn: L. D. R.	MAYOR
Checked: F. J. T.	City of Haines
FEBRUARY 1957	

FELIX J. TONER, REGISTERED ENGINEER - JUNEAU, ALASKA

SHEET NO.	TITLE
1.	Title Sheet
2.	Master Plan, Index & Construction Quantities
3.	Float Layout
4.	Float Construction Details
5.	Dock Construction Details
6.	Gangway Details
7.	Gangway Details

CONSTRUCTION QUANTITIES			
Item No.	Description	Quantity	Unit
1.	21' x 70' Approach & 41' x 61' Dock	1	Lump Sum
2.	Steel Gangway	1	Lump Sum
3.	10' x 22' Gangway Float	1	Lump Sum
4.	10' Wide Floats	528	Lin. Ft.
5.	Move and Moor 200' Existing Log Float		Lump Sum
6.	Creosoted Mooring Piles	45	Each

ALTERNATE 1			
Item No.	Description	Quantity	Unit
1A	21' x 70' Approach & 21' x 61' Dock	1	Lump Sum

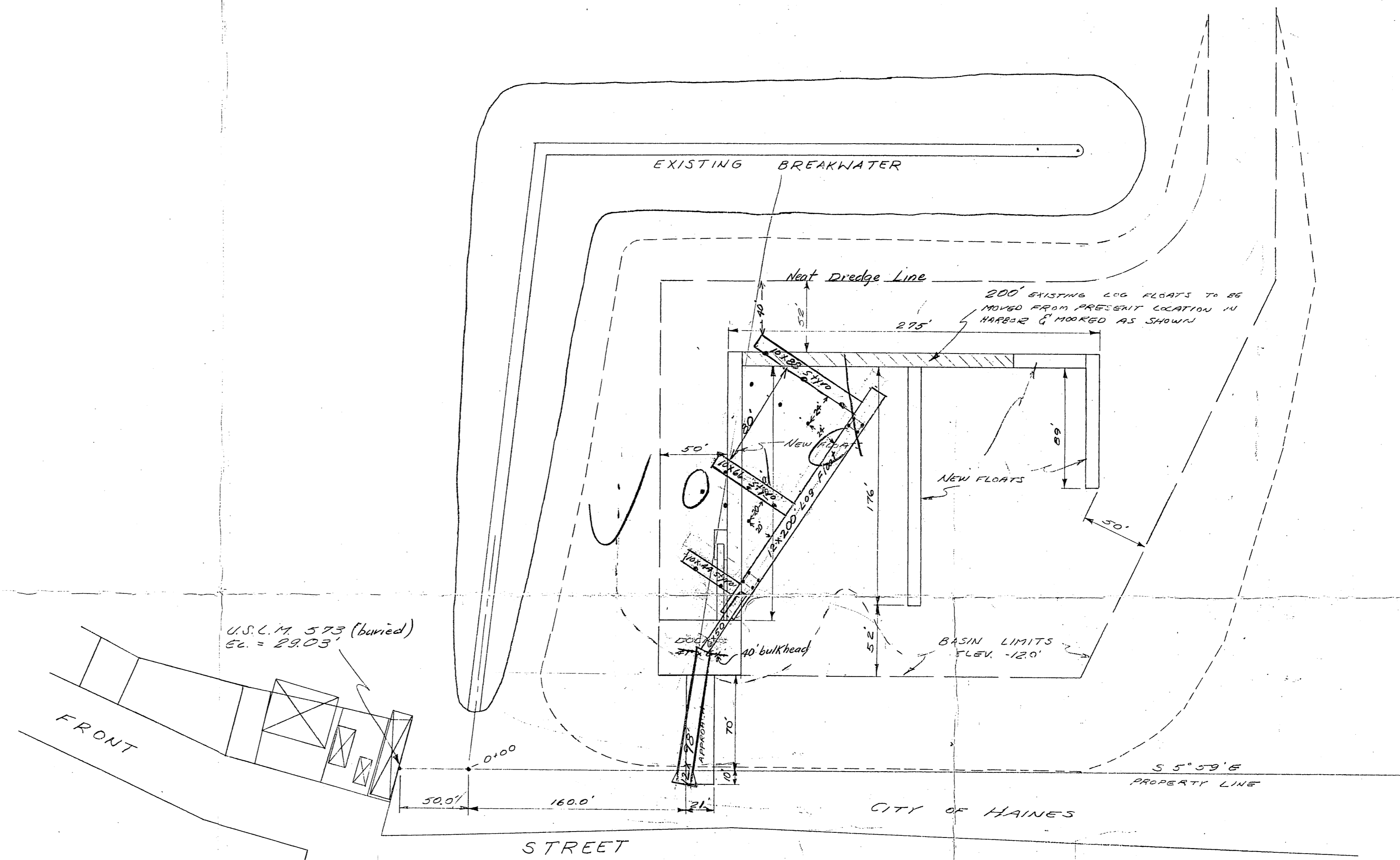

MASTER PLAN
SMALL BOAT HARBOR
1"=60'

U.S. DEPARTMENT of the INTERIOR — OFFICE of TERRITORIES	
ALASKA PUBLIC WORKS	
Project No. 50-A-290	HAINES, ALASKA
MASTER PLAN, INDEX & CONST. QUANTITIES	
HAINES BOAT HARBOR	
Scale: As Noted	Sheet 2 of 7
Designed: F. J. T.	APPROVED: <i>Frank A. Metcalf</i>
Drawn: C. R. N.	Frank A. Metcalf
Checked: F. J. T.	Alaska Highway Commissioner
MARCH 1952	
FELIX J. TONER, REGISTERED ENGINEER — JUNEAU, ALASKA	

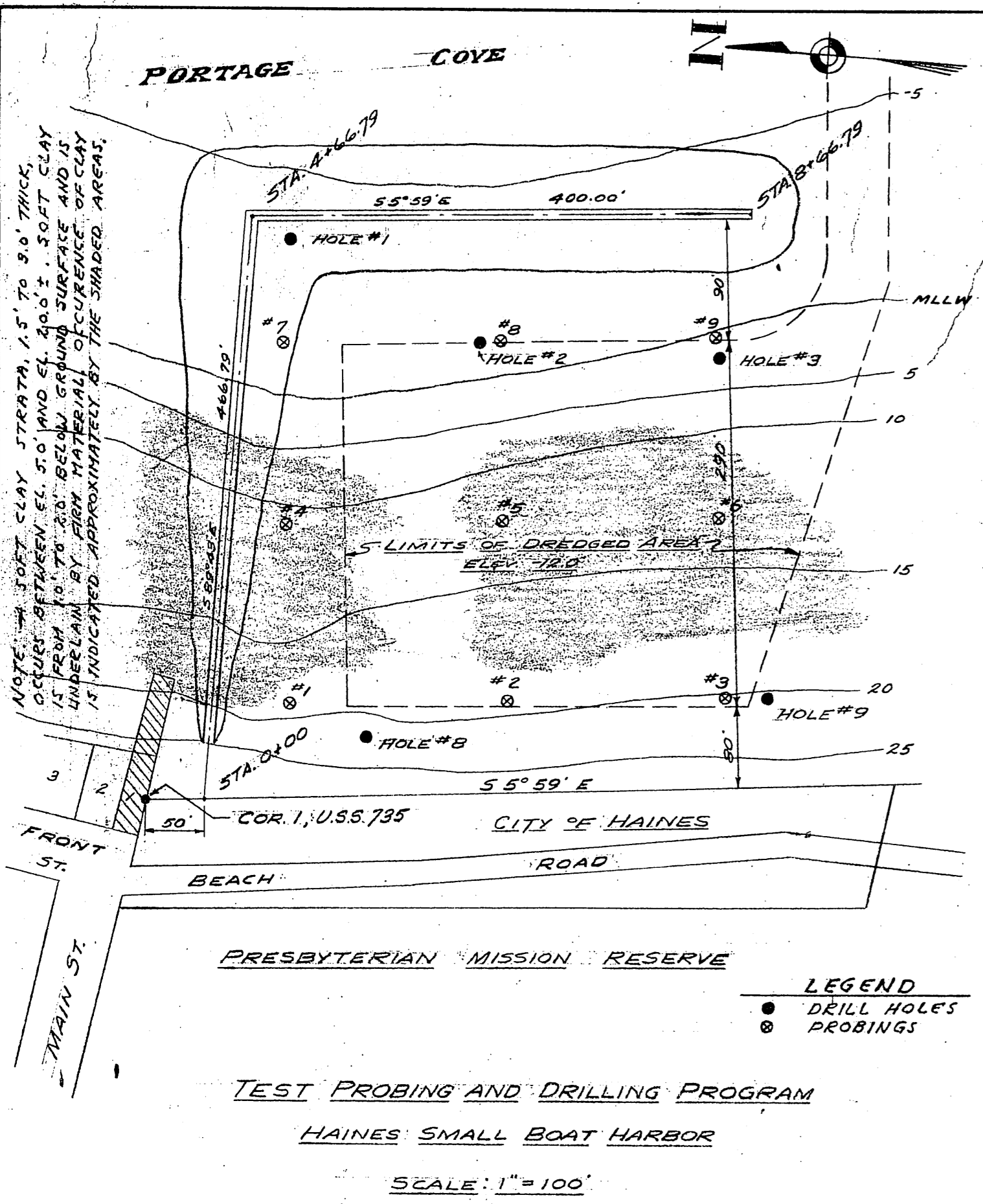

HOLE #1	HOLE #2	HOLE #3	HOLE #8	HOLE #9
SAND-SILT-CLAY	SAND	SILTY SAND	SAND	SAND-SILT
FIRM CLAY	SAND-SILT	FIRM CLAY	SAND-GRAVEL	SILTY SAND-GRAVEL
	MED. FIRM CLAY	COMPR. SAND	COMPR. SAND/SILT	SAND-SILT
	FIRM CLAY	COMPR. SAND/SILT		
	CLAY SAND/GRVLS	COMPR. SAND/SILT		
	SILT	SAND-GRAVEL		
	COMPR. SAND			
		GRAVEL 1/2 MINUS	COARSE SAND-CLAY	SILTY SAND
		COMPR. SAND/SILT	COMPR. SAND/SILT	SAND-PEA GRAVEL
			CRSE. SAND-SILT	COMPACTED SAND
			SILTY SAND	COARSE SAND
			WTR. BRNS. SAND	SAND-PEA GRAVEL
			SAND-PEA GRAVEL	SILTY SANDS
			COARSE SAND	SAND-PEA GRAVEL
			SILTY SAND	

DATUM IS GROUND SURFACE

BORING LOGS

DRILLING PROGRAM CONDUCTED BY FELIX J. TONER. SAMPLES WERE OBTAINED WITH A 6" CHURN DRILL AND BAILER. SITE WAS PROBING WITH A STEEL ROD AT LOCATIONS MARKED THUSLY (○ #3). DEPTH OF PROBING WAS 10' IN ALL CASES. PROBINGS INDICATED SAND, SILT OR CLAY STRATAS, WITH NO BEDROCK OR BOULDERS ENCOUNTERED. (PROBINGS BY A.R.W.)

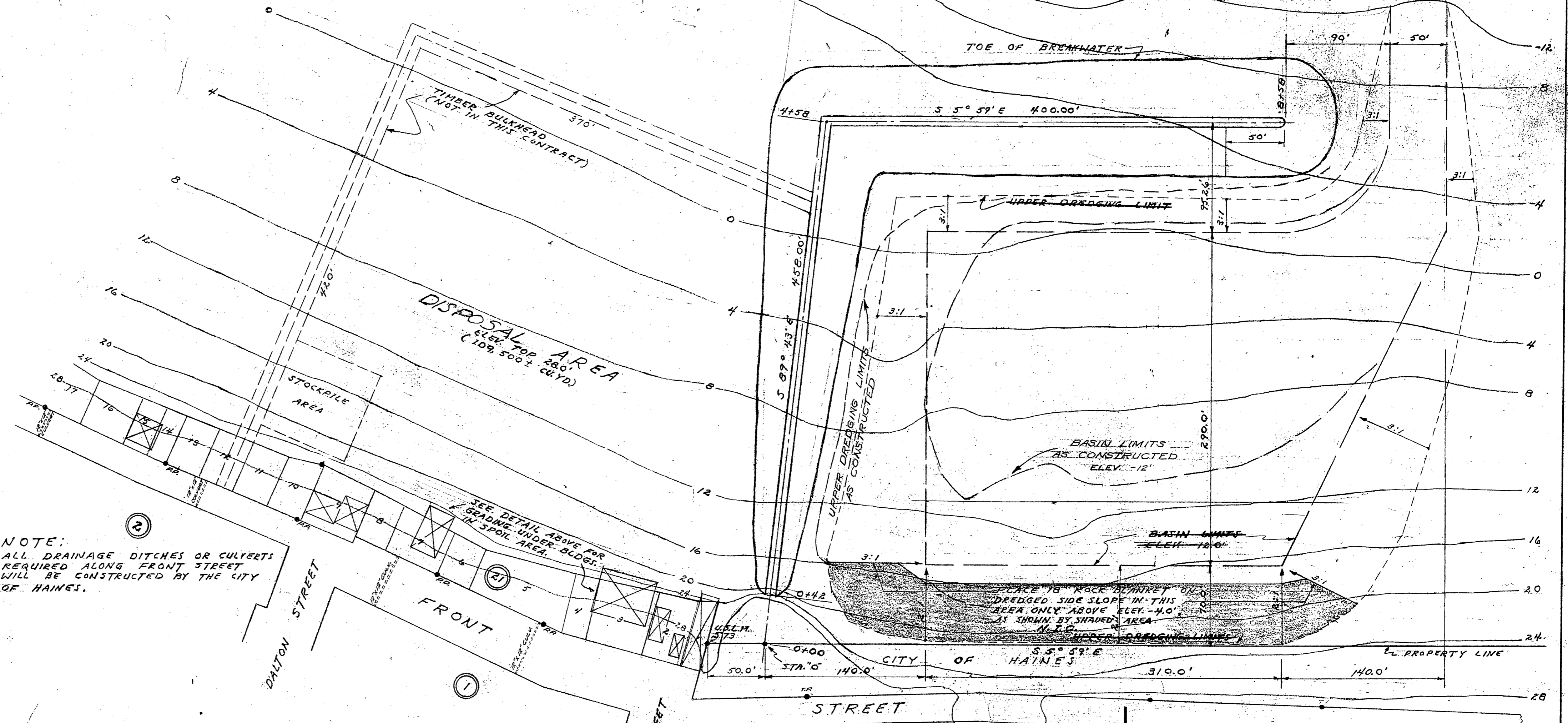
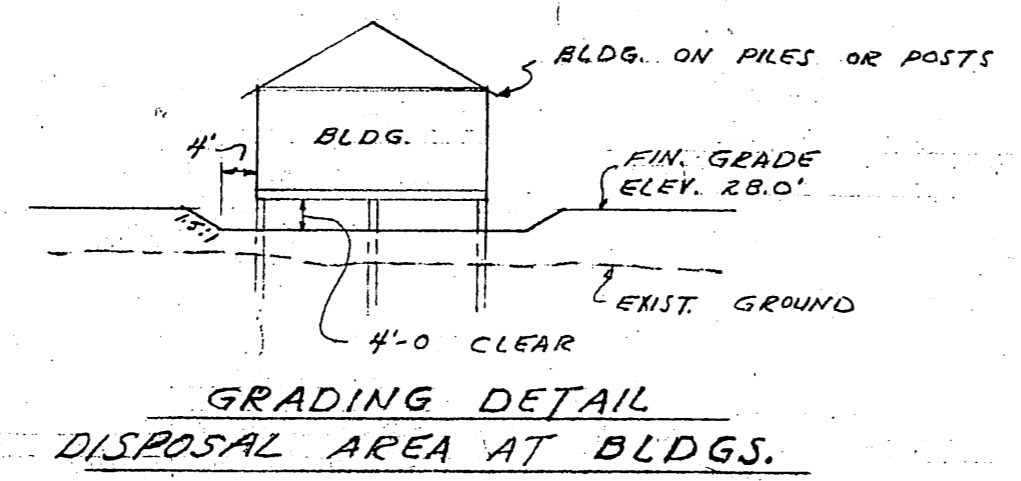

NOTE

SCOPE OF THE WORK IN CONTRACT 50-A-290, SECTION II, INCLUDES THE FOLLOWING ITEMS:
1. EXCAVATION OF THE BOAT HARBOR BASIN
2. DISPOSAL OF THE EXCAVATED MATERIAL IN THE DISPOSAL AREA SHOWN ABOVE.

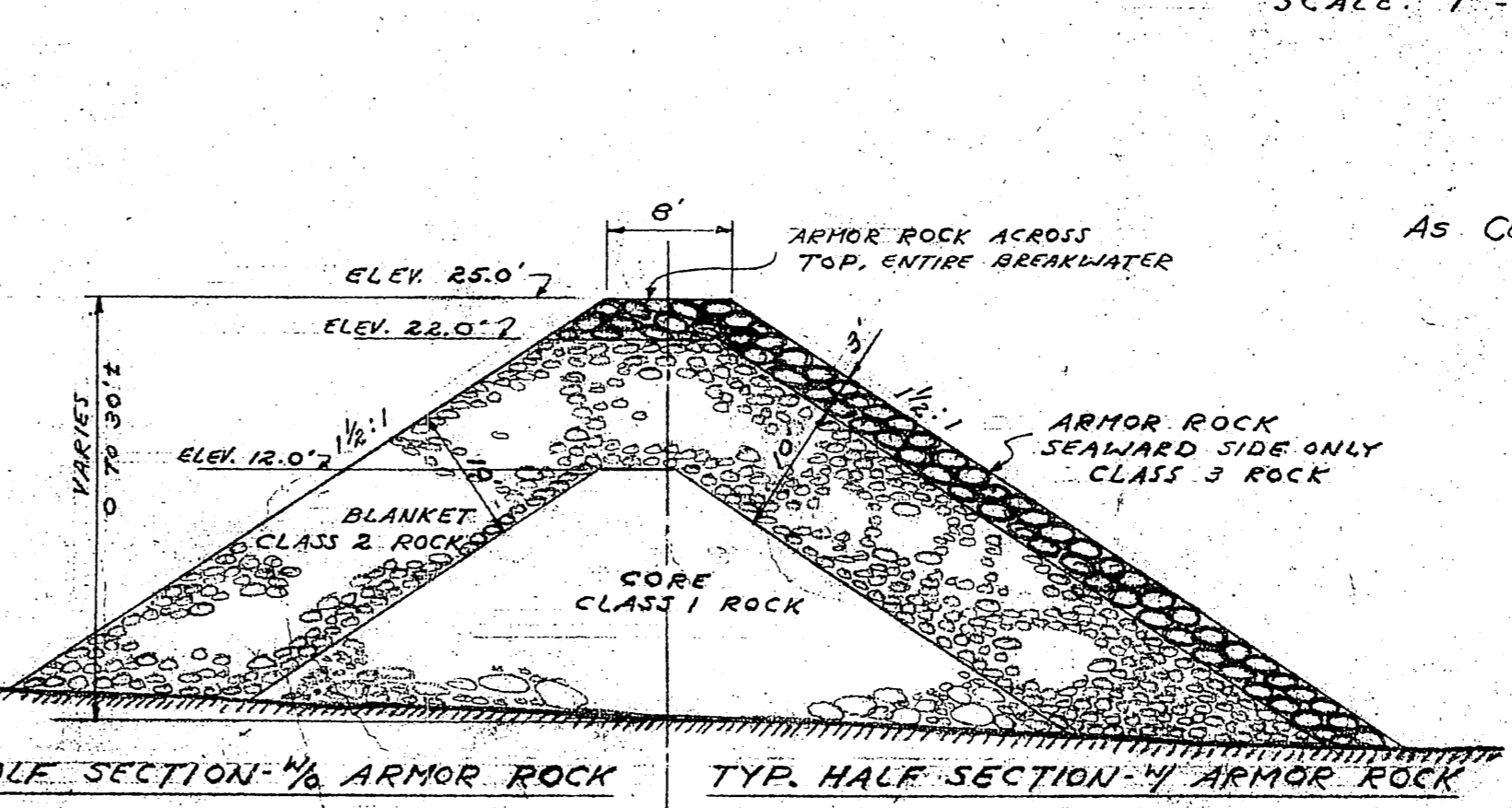
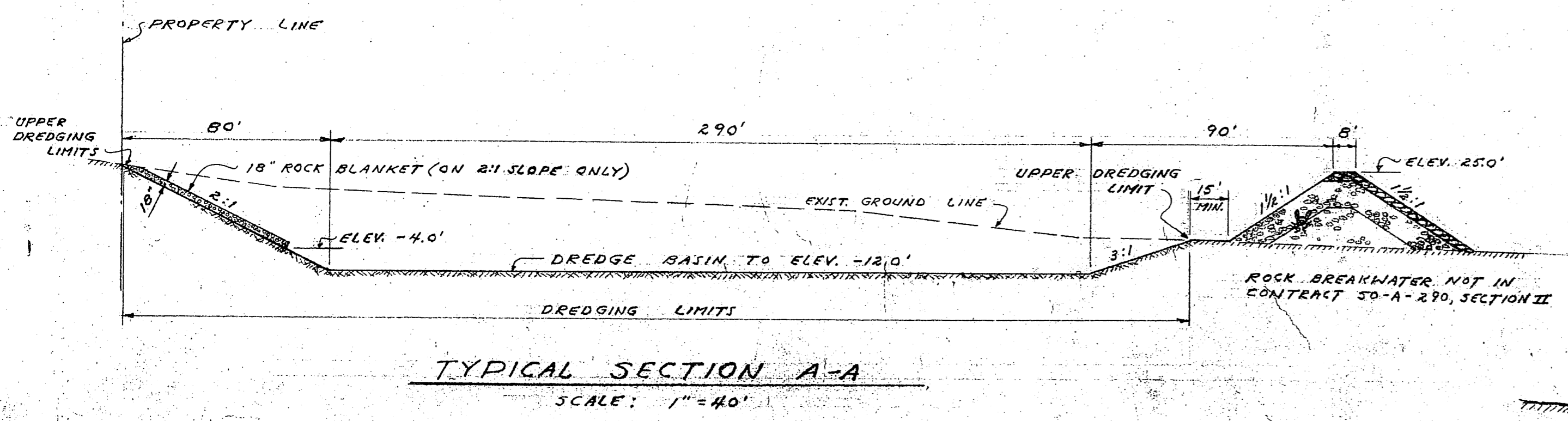

APPROVED FOR TERRITORY OF ALASKA
By Frank A. Metcalf
ALASKA HIGHWAY COMMISSIONER
DATE 7/21/57

Date _____
These plans have been approved by the City Council and Mayor of Haines, Alaska.
J. Thompson
Mayor,
Attest Anna M. Allen
City Clerk

AS CONSTRUCTED - AUGUST, 1961

U.S. DEPARTMENT of the INTERIOR - OFFICE of TERRITORIES

ALASKA PUBLIC WORKS
Project No. 50-A-290 HAINES, ALASKA

PLANS & DETAILS
HAINES BOAT HARBOR

Scale: As Noted Sheet 2 of 8

Designed: F.J.T.
Drawn: L.D.R.
Checked: F.J.T.
FEBRUARY 1957

APPROVED: J. Thompson
MAYOR
City of Haines

FELIX J. TONER, REGISTERED ENGINEER - JUNEAU, ALASKA

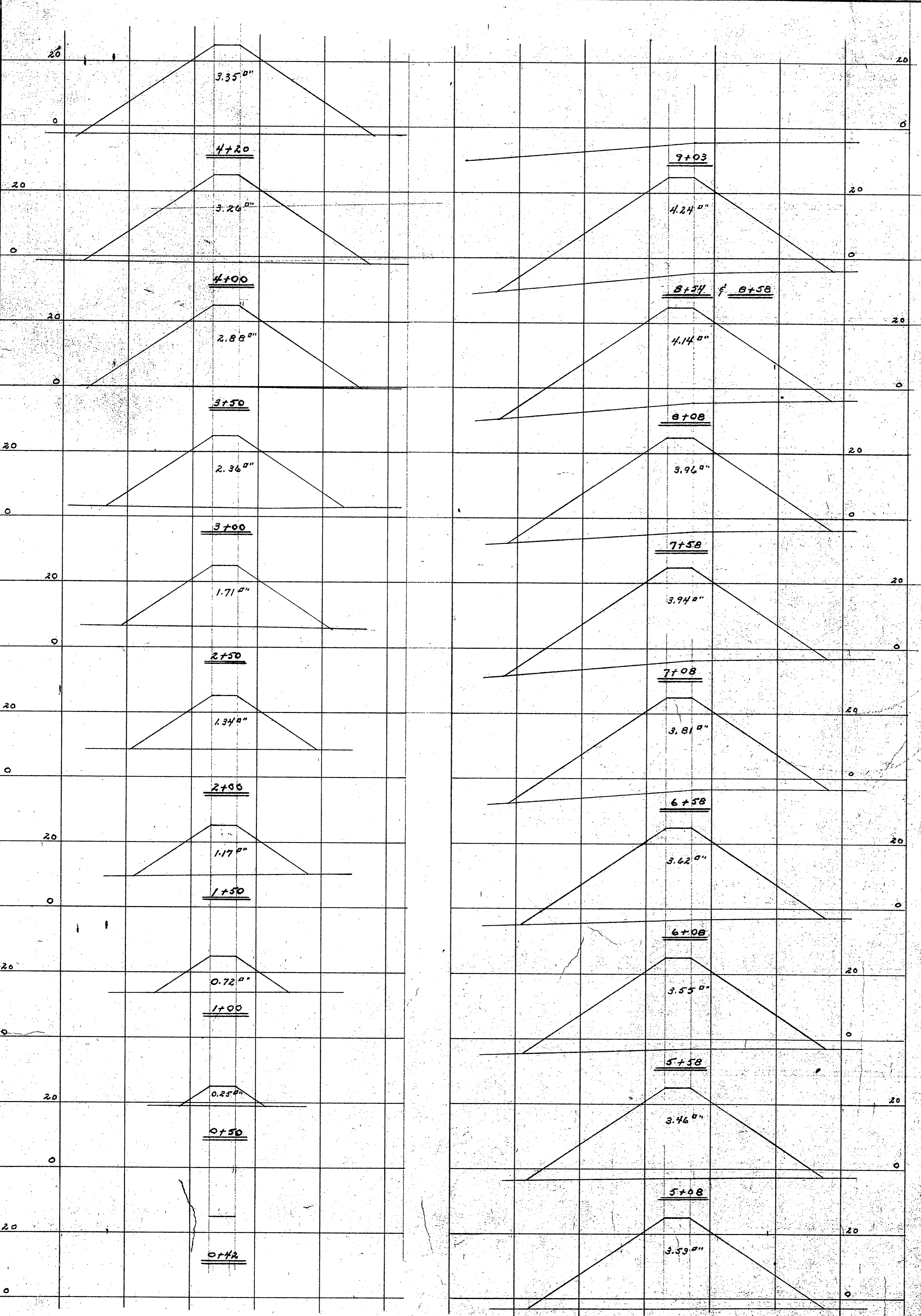

**CROSS SECTIONS
ROCK BREAKWATER**
SCALE: 1"=20'

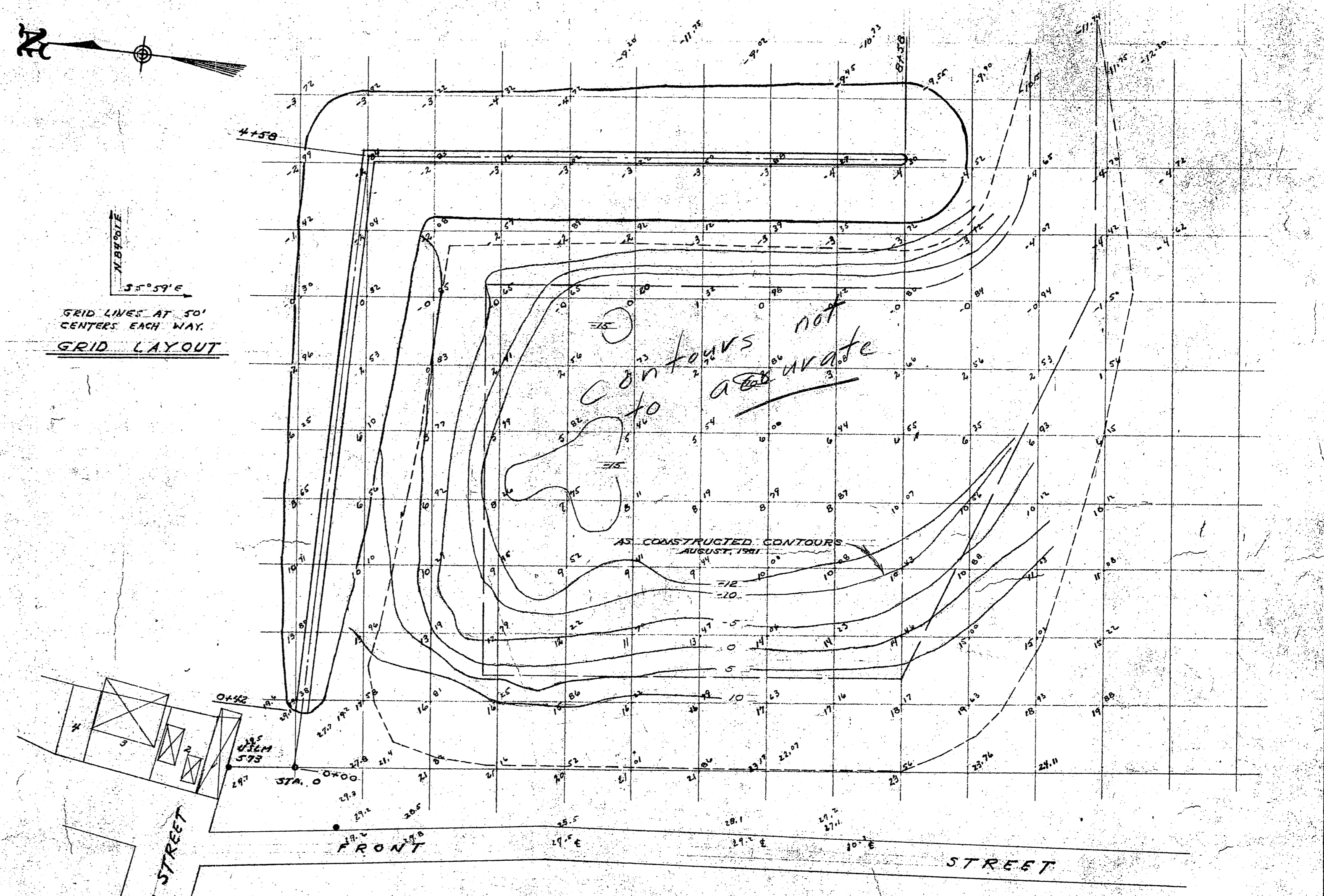
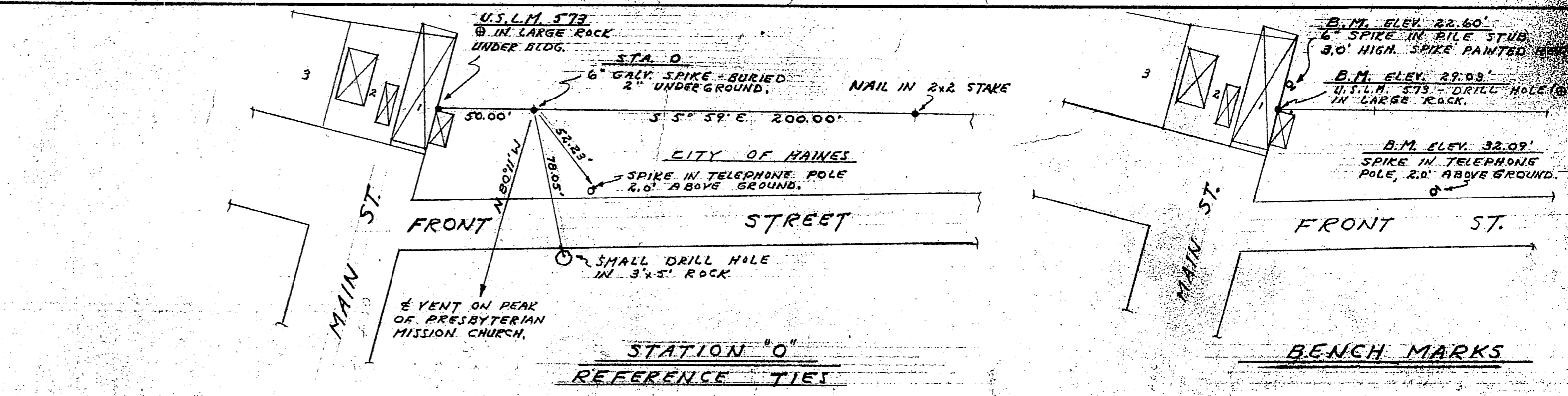

**CONDITION SURVEY
SMALL BOAT HARBOR SITE
HAINES, ALASKA**
SCALE: 1"=60'
DATE OF SURVEY MAY 28, 1957

APPROVED FOR TERRITORY OF ALASKA
By *Frank A. Metcalf*
FRANK A. METCALF
ALASKA HIGHWAY COMMISSIONER
DATE: 7/1/57

Date
These plans have been approved by the City Council and Mayor of Haines, Alaska.
Attest *Annie McAllen*
City Clerk

AS CONSTRUCTED - AUGUST, 1961	
U.S. DEPARTMENT OF THE INTERIOR - OFFICE OF TERRITORIES	
ALASKA PUBLIC WORKS	
Project No. 50-A-290	HAINES, ALASKA
PLANS & DETAILS	
HAINES BOAT HARBOR	
Scale: As Noted	Sheet 3 of 8
Designed: F. J. T.	APPROVED: <i>Felix J. Toner</i>
Drawn: L. D. R.	MAYOR
Checked: F. J. T.	City of Haines
FEBRUARY 1957	
FELIX J. TONER, REGISTERED ENGINEER - JUNEAU, ALASKA	