

DEPARTMENT OF TRANSPORTATION  
and PUBLIC FACILITIES  
S.E. REGION AVIATION—DESIGN & CONSTRUCTION



CONSTRUCTION PLANS FOR

# HOONAH AIRPORT

RUNWAY, TAXIWAY, APRON AND ACCESS ROAD  
IMPROVEMENTS AND MISCELLANEOUS ITEMS  
OF WORK

S.C. NO. 81-691-01

SPONSORED BY  
THE STATE OF ALASKA

1981

AS-BUILT PLANS

PROJECT No. - 81-691-01  
CONTRACTOR - WYMAN CONST. CO.  
PROJECT ENGINEER - PAUL E. JONES  
BEGINNING DATE - 5/22/82  
COMPLETION DATE - 11/1/82

APPROVED  
  
CHARLES S. MATLOCK, DIRECTOR, S.E. REGION DESIGN & CONSTRUCTION  
DATE 12-28-81

APPROVED  
  
WALLACE K. WILLIAMS, CHIEF, S.E. REGION HIGHWAY & AVIATION DESIGN & CONSTRUCTION  
DATE 12-28-81



LOCATION MAP

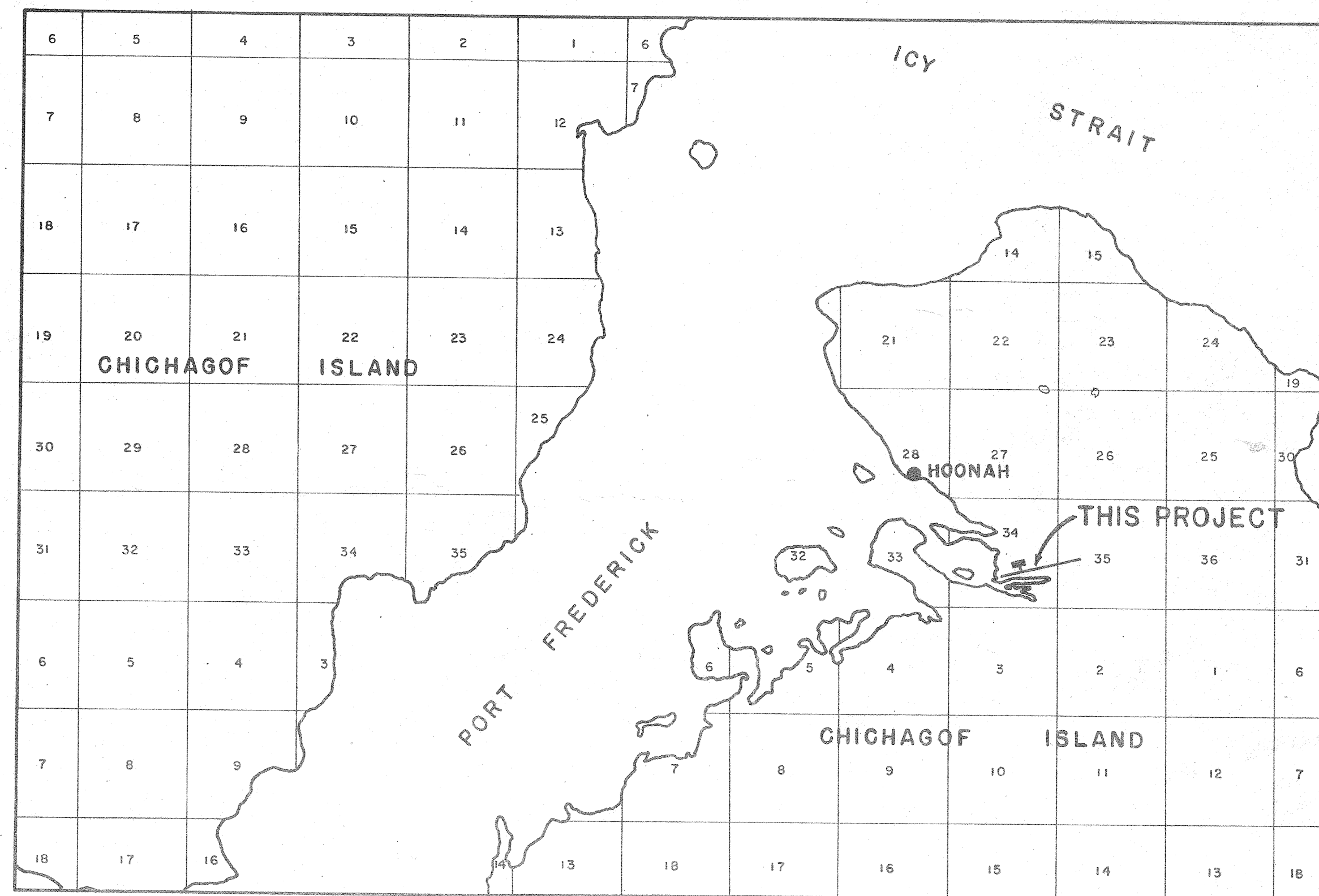

VICINITY MAP

SCALE: 1" = 1 MILE

ESTIMATED QUANTITIES

NO.	ITEM	QUANTITY	UNIT
100	MOBILIZATION AND DEMOBILIZATION	ONE JOB	LUMP SUM
130	ENGINEERS FIELD OFFICE	ONE JOB	LUMP SUM
200a	CLEARING C.O.#1 & C.O.#3	<del>48</del> 64	ACRES
330d	BORROW EMBANKMENT C.O.#2	<del>40,690</del> 43,781	CUBIC YARDS
330e	DITCH EXCAVATION	<del>2050</del> 3,130	CUBIC YARDS
540	AGGREGATE SURFACE COURSE	<del>5,350</del> 6,707	CUBIC YARDS
721	SEGMENTED CIRCLE	ONE JOB	LUMP SUM
710	RUNWAY BOUNDARY MARKER	4	EACH
720	WIND CONE (UNLIGHTED) C.O.#3	1	EACH
731	REFLECTIVE MARKERS	73	EACH
820a	TIE-DOWN ANCHORS	15	EACH
2000a	PLACED RIPRAP, CLASS I	<del>800</del> 760	CU. YDS.
2000b	STOCKPILED RIPRAP, CLASS I	100	CU. YDS.
3000	PETROLEUM ESCALATION	ALL REQ'D.	CONT. SUM
721(1)	TRAFFIC PATTERN INDICATOR	ALL REQ'D.	LUMP SUM
2000a	PLACED RIPRAP, CLASS I (C.O.#5)	25	CU. YDS.

SUPPLEMENT NO. 1, HOONAH AIRPORT ACCESS ROAD

540 (A)	AGGREGATE SURFACE COURSE	5000	CU. YDS.
540 (B)	AGGREGATE SURFACE COURSE	7000	CU. YDS.

INDEX

SHEET TITLE	SHEET NO.
TITLE SHEET	1
LOCATION & VICINITY MAPS, INDEX & ESTIMATED QUANTITIES	2
PROJECT LAYOUT PLAN	3
RUNWAY PLAN & PROFILE, CLOSED R/W MARKING	4
RUNWAY PLAN & PROFILE, WIND CONE & SEGMENTED CIRCLE DETAILS	5
TYPICAL SECTIONS	6
CLEARING & PROPERTY PLAN	7
MINING & EXCAVATION PLAN	8
RUNWAY CROSS SECTIONS	9-14
RUNWAY, TAXIWAY & APRON CROSS SECTIONS	15

See Special Provisions SP-14 through SP-16 for Tie-Down and Reflective Marker details and locations.

REVISIONS

NO.	DATE	DESCRIPTION
1	11-27-81	CHANGED QUANTITIES 200, 300e, 731, 2000a, 2000b, Removed No. 125 Removed all lighting from contract
2	8/27/81	ADD RIPRAP QUANTITIES

PLANS AND SPECIFICATIONS FOR THIS PROJECT  
PREPARED BY  
TONER & NORDLING  
REGISTERED ENGINEERS, INC.  
JUNEAU, ALASKA

STATE OF ALASKA  
DEPARTMENT OF TRANSPORTATION  
AND PUBLIC FACILITIES  
DIVISION OF AVIATION-DESIGN AND CONSTRUCTION

HOONAH AIRPORT  
S.C. NO. 81-691-01  
LOCATION AND VICINITY MAP, INDEX  
& ESTIMATED QUANTITIES

APPROVED: *William Koester*  
WILLIAM KOESTER, P.E. SOUTHEAST REGION ENGINEER

APPROVED: *James A. Heinich*  
JAMES A. HEINICH, P.E. CHIEF DESIGN ENGINEER

SCALE: AS NOTED  
DRAWN: GTS  
DATE: 10/28/81  
SHEET 2 OF 15

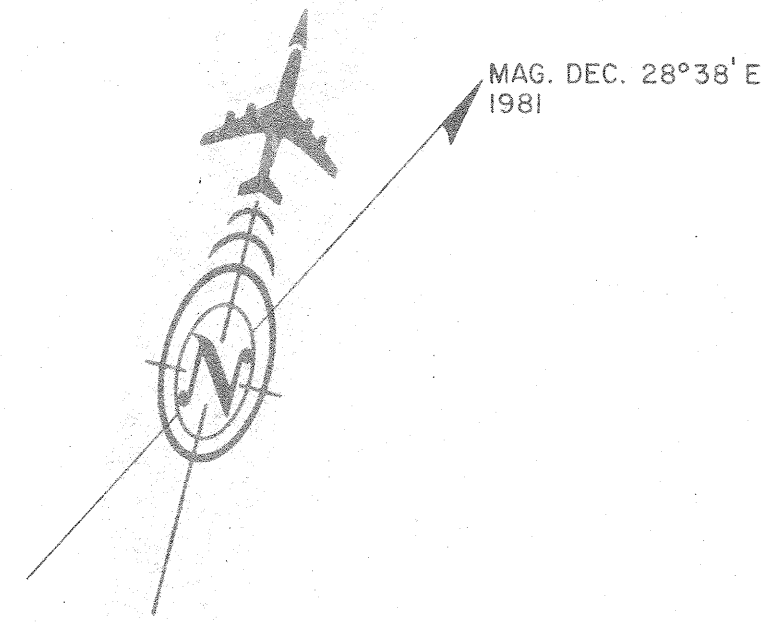

**LEGEND**

- BLM BRASS CAP
- P.P. POWER POLE

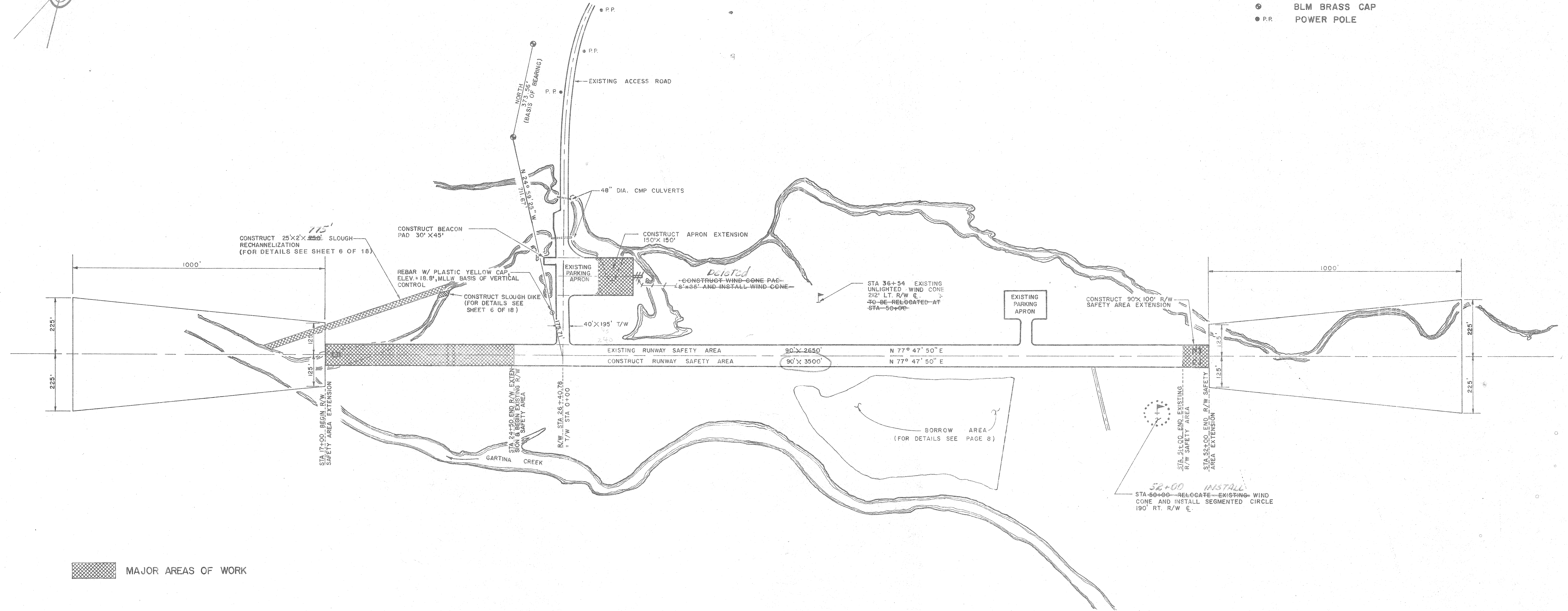

MAJOR AREAS OF WORK



**REVISIONS**

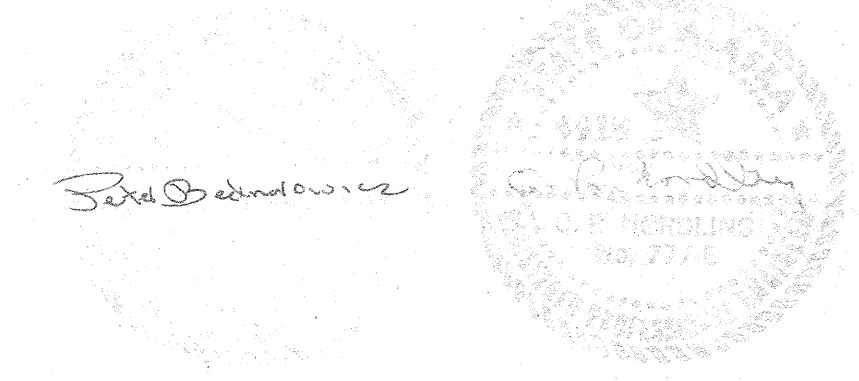

PLANS AND SPECIFICATIONS FOR THIS PROJECT  
PREPARED BY  
TONER & NORDLING  
REGISTERED ENGINEERS, INC.  
JUNEAU, ALASKA

STATE OF ALASKA  
DEPARTMENT OF TRANSPORTATION  
AND PUBLIC FACILITIES  
DIVISION OF AVIATION-DESIGN AND CONSTRUCTION

**HOONAH AIRPORT**  
S.C. NO. 81-691-01  
PROJECT LAYOUT PLAN

BY	DATE	CHANGE	SCALE	DESIGNED	DRAWN	CHECKED	DATE
PB	12/18/81	CHANGED WIND CONE DISTANCE	AS NOTED	CRN	GTB		
PB	12/3/81	DELETED VASI PADS					
PB	12/15/81	ADDED BAR SCALE, DECREASED BORROW AREA					

APPROVED: *Thomas Alan Hennick*  
WILLIAM A. ALLISON, P.E. CHIEF DESIGN ENGINEER

APPROVED: *William Koester*  
WILLIAM KOESTER, P.E. SOUTHEAST REGION ENGINEER

SCALE: AS NOTED

DESIGNED: CRN  
DRAWN: GTB  
CHECKED: CRN  
DATE: 12/15/81

SHEET 3 OF 15

DATE	
BY	
NO.	
PLAN	
NOTE BOOK	
NO.	

DATE	
BY	
NO.	
PROFILE	
NOTE BOOK	
NO.	

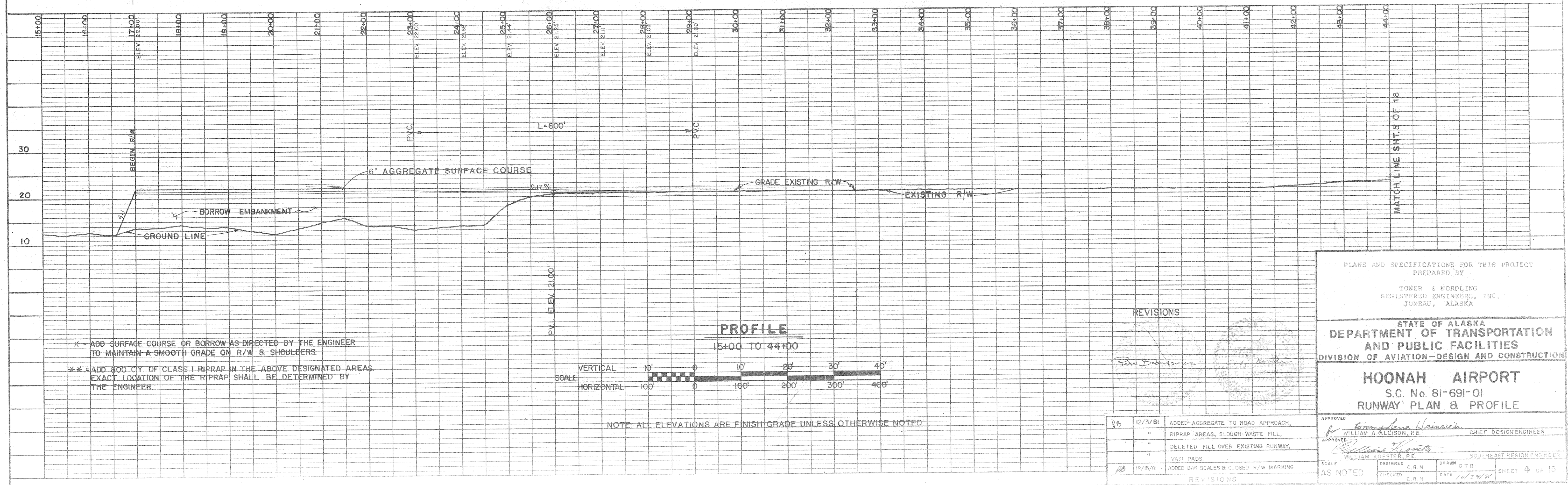
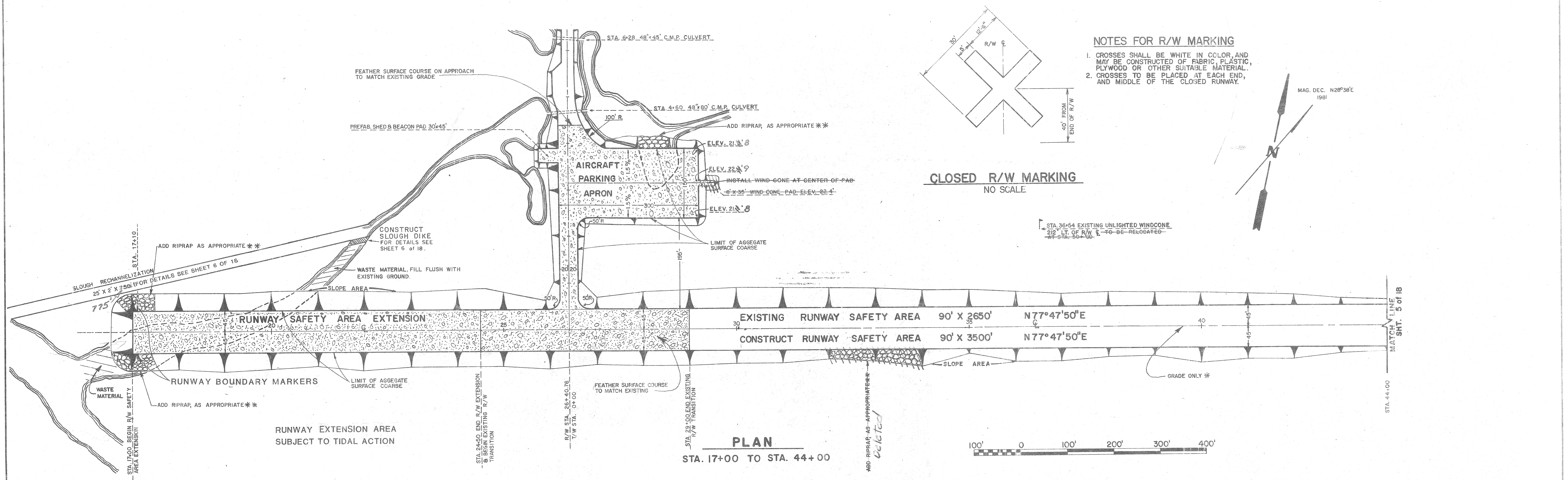

PLANS AND SPECIFICATIONS FOR THIS PROJECT  
PREPARED BY

TONER & NORDLING  
REGISTERED ENGINEERS, INC.  
JUNEAU, ALASKA

STATE OF ALASKA  
DEPARTMENT OF TRANSPORTATION  
AND PUBLIC FACILITIES  
DIVISION OF AVIATION-DESIGN AND CONSTRUCTION

**HOONAH AIRPORT**  
S.C. No. 81-691-01  
RUNWAY PLAN & PROFILE

APPROVED	12/3/81	ADDED AGGREGATE TO ROAD APPROACH, RIPRAP AREAS, SLOUGH WASTE FILL.	WILLIAM A. ALTON, P.E.	CHIEF DESIGN ENGINEER	
APPROVED		DELETED FILL OVER EXISTING RUNWAY.	WILLIAM ROESTER, P.E.	SOUTHEAST REGION ENGINEER	
SCALE	AS NOTED	DESIGNED	C.R.N.	DRAWN	S.T.B.
CHECKED		DATE	10/29/81	SHEET	4 OF 15

DATE	
BY	
SURV. NO.	
ALIGNMENT CHECKED	
RT. OF WAY CHECKED	
PLAN	
NOTE BOOK	
No.	

DATE	
BY	
SURV. NO.	
GRADE CHECKED	
STRUCTURE NOTATIONS CHECKED	
PROFILE	
NOTE BOOK	
No.	

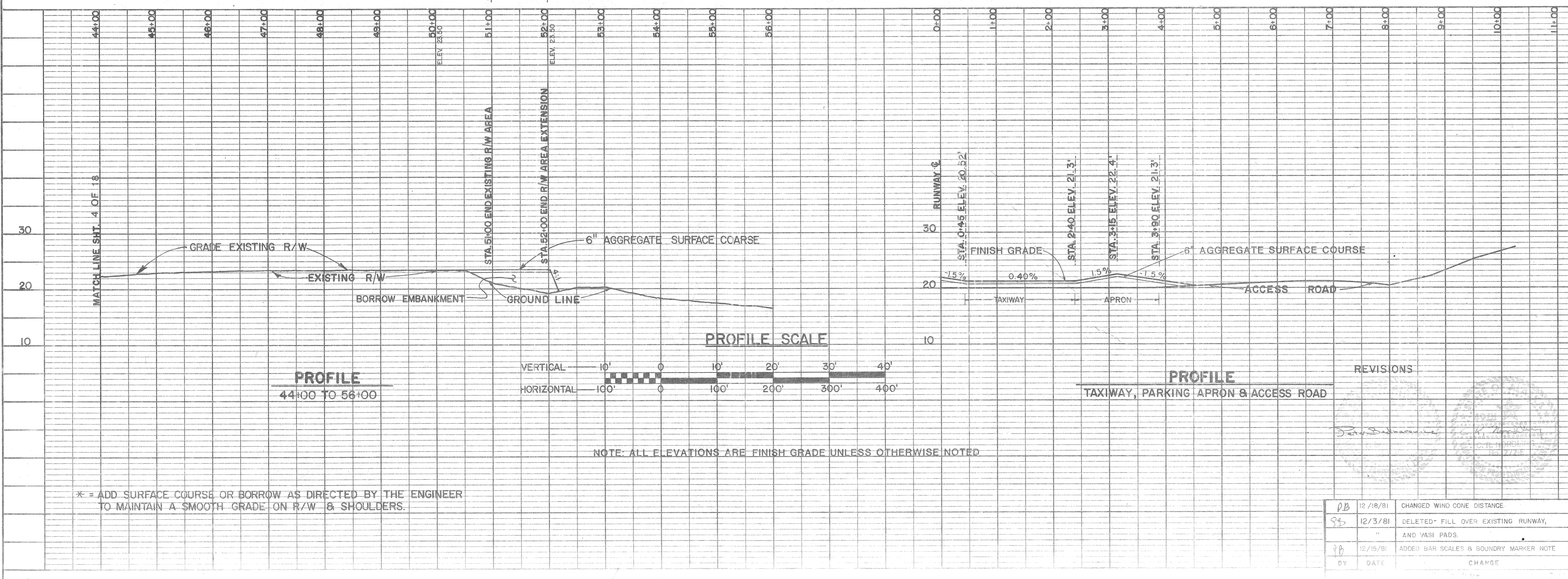
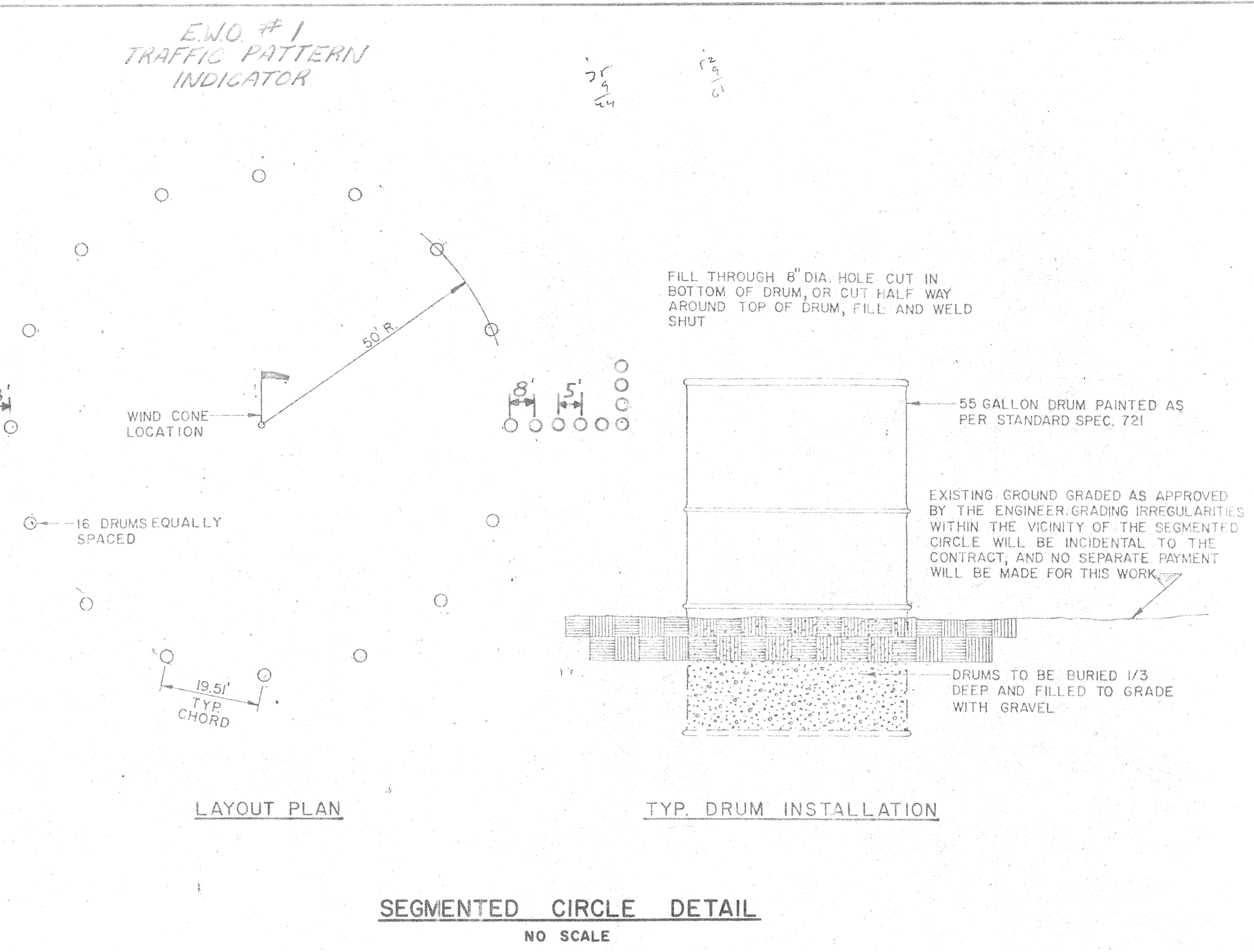
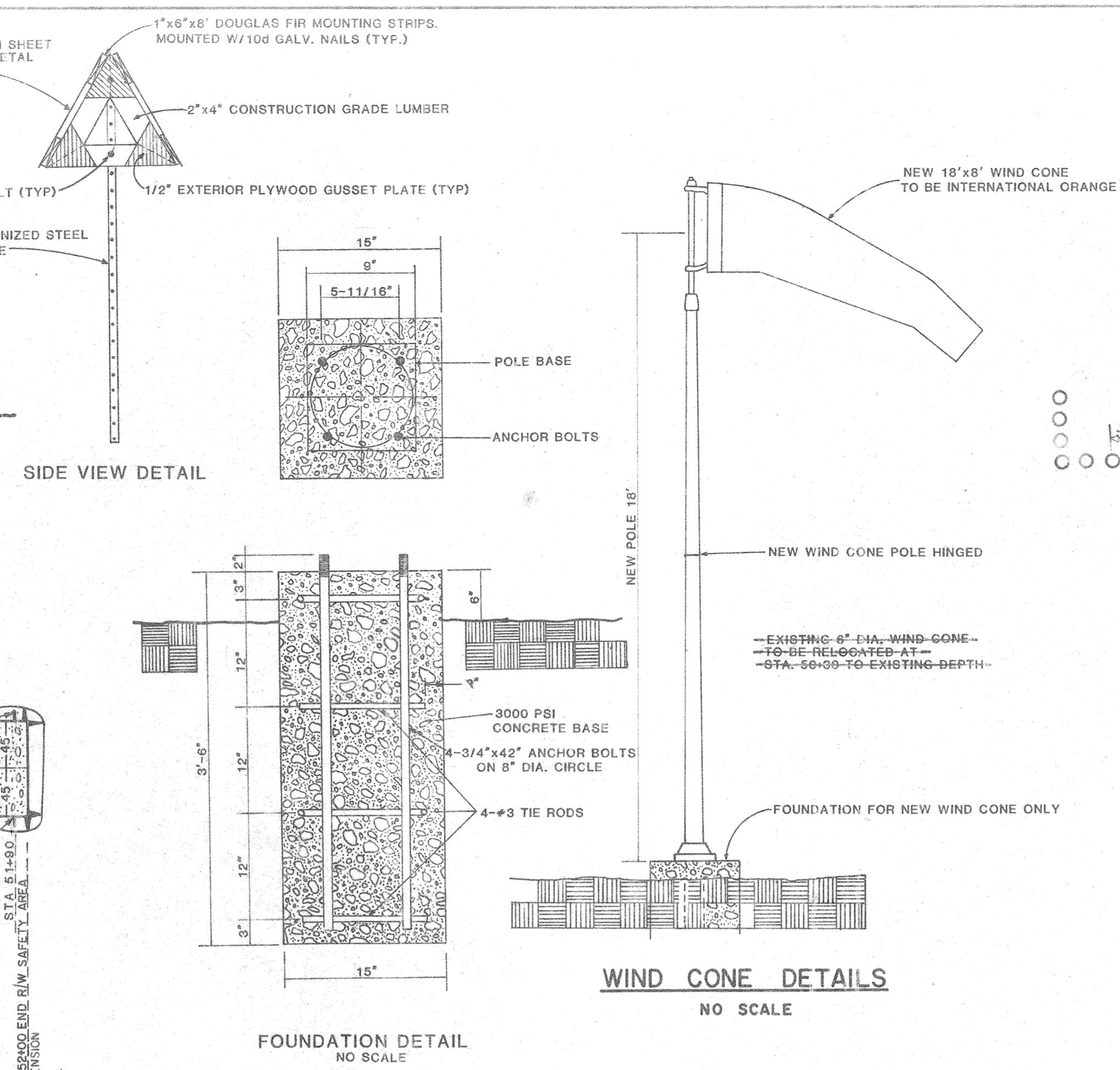
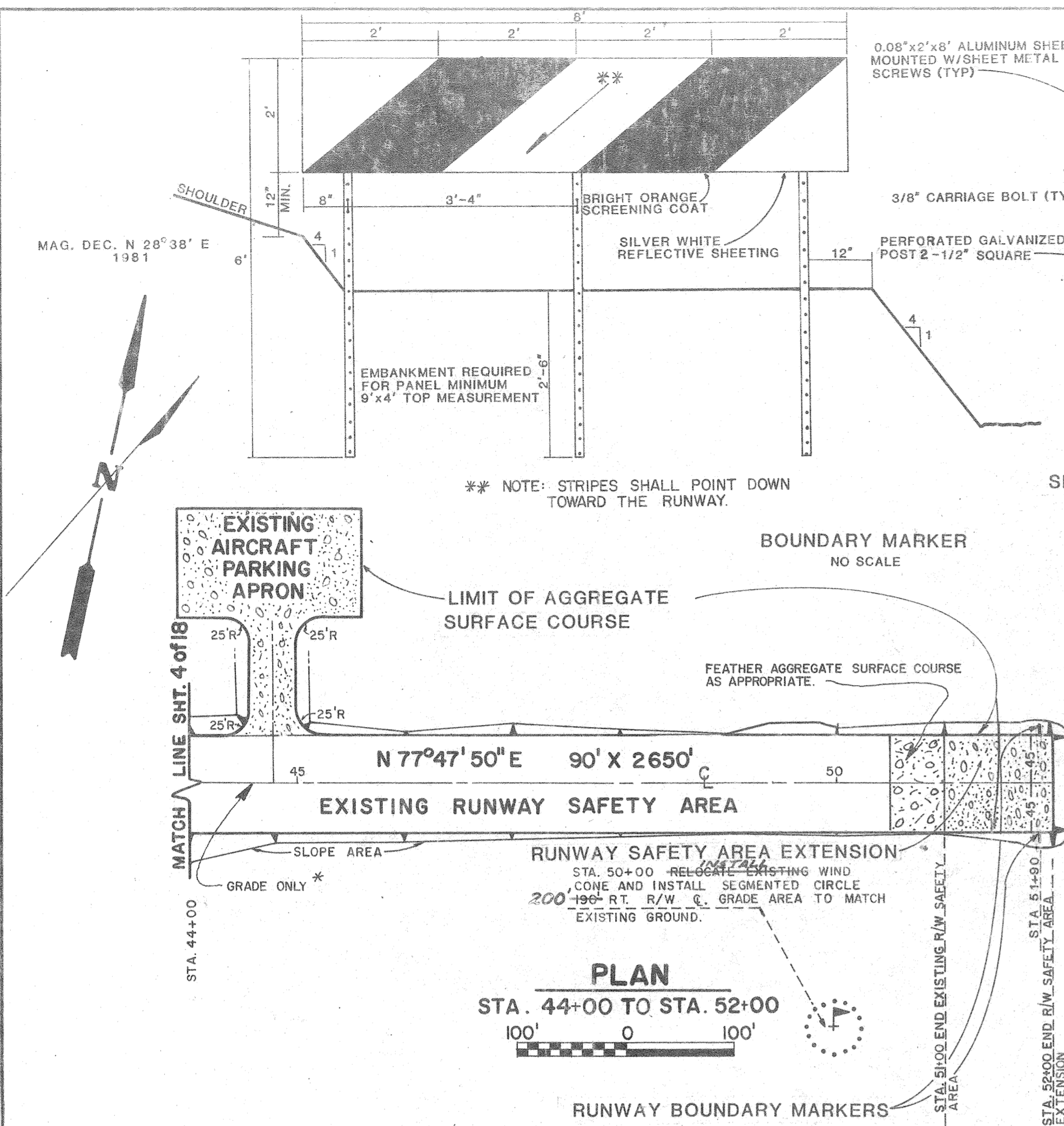

PLANS AND SPECIFICATIONS FOR THIS PROJECT PREPARED BY  
TONER & NORDLING  
REGISTERED ENGINEERS, INC.  
JUNEAU, ALASKA

STATE OF ALASKA  
DEPARTMENT OF TRANSPORTATION  
AND PUBLIC FACILITIES  
DIVISION OF AVIATION-DESIGN AND CONSTRUCTION

HOONAH AIRPORT  
S.C. No. 81-691-01  
RUNWAY PLAN & PROFILE  
WIND CONE & SEGMENTED CIRCLE DETAILS

APPROVED: *Tommy J. Heinicke*  
WILLIAM A. ALLISON, P.E. CHIEF DESIGN ENGINEER

APPROVED: *William Roester*  
WILLIAM ROESTER, P.E. SOUTH-EAST REGION ENGINEER

BY	DATE	CHANGE
JB	12/18/81	CHANGED WIND CONE DISTANCE
JB	12/3/81	DELETED FILL OVER EXISTING RUNWAY AND VASI PADS.
JB	12/15/81	ADDED BAR SCALES & BOUNDARY MARKER NOTE

SCALE AS NOTED  
DESIGNED C.R.N.  
CHECKED C.R.N.  
DATE 1/13/82  
SHEET 5 OF 15

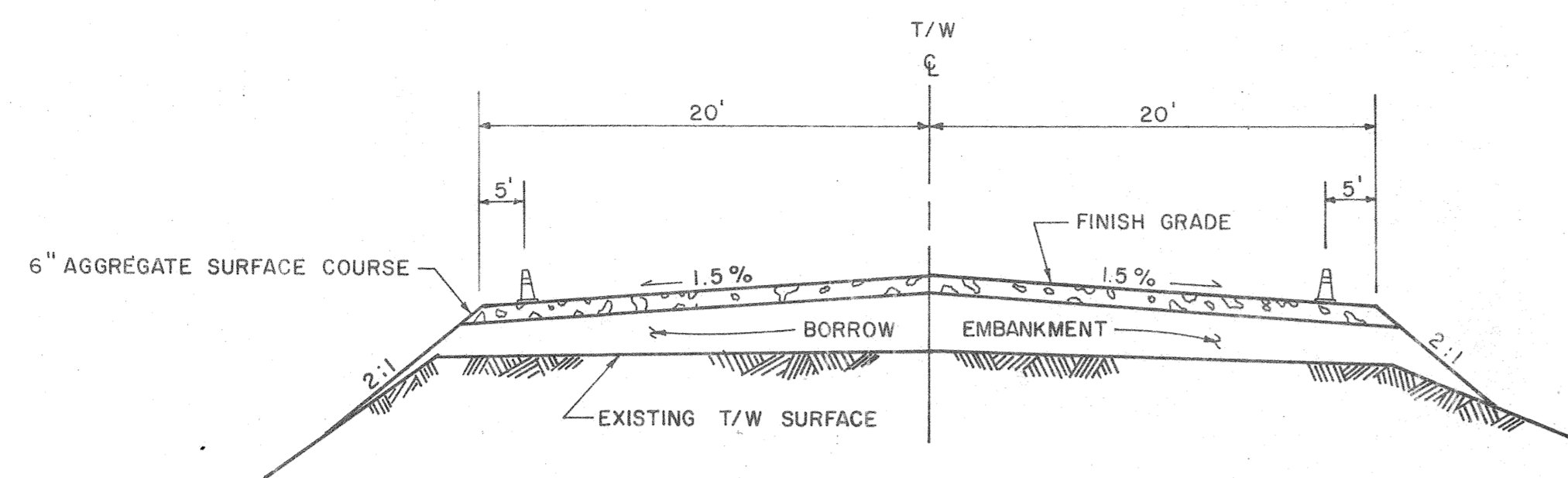

TAXIWAY TYPICAL FILL SECTION

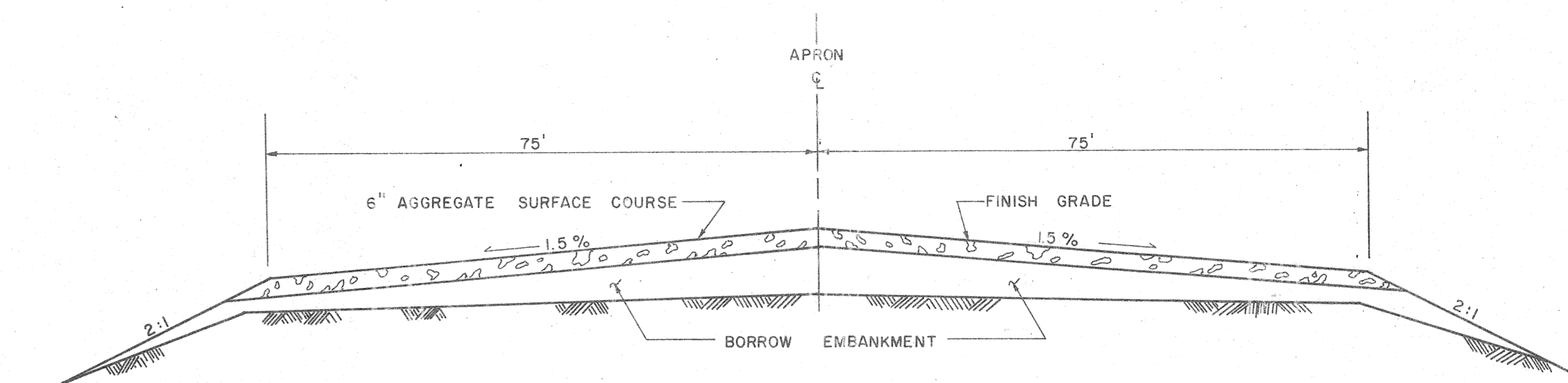

APRON TYPICAL FILL SECTION

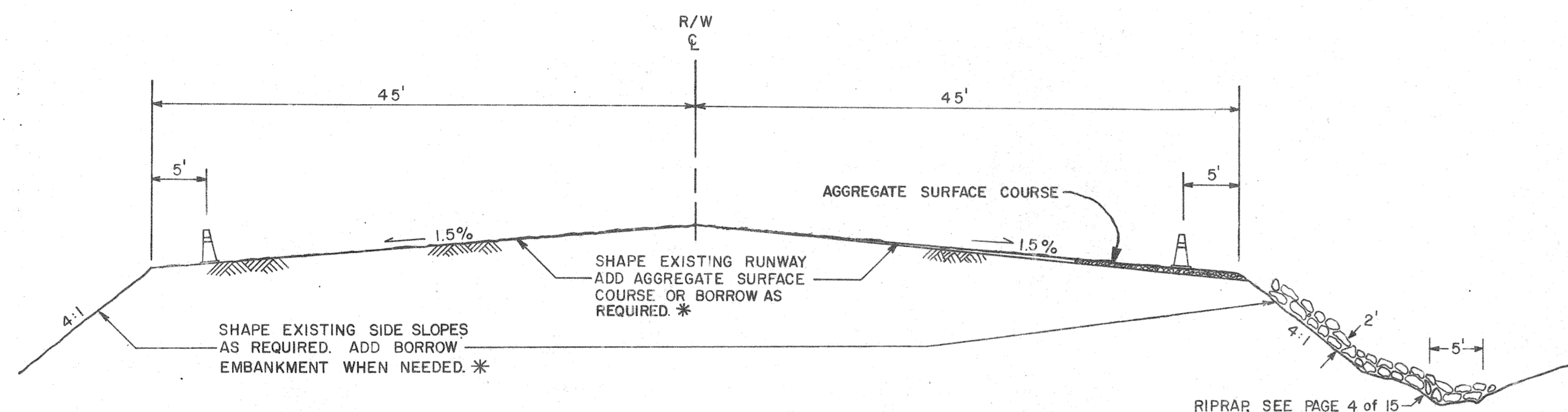

EXISTING RUNWAY TYPICAL SECTION

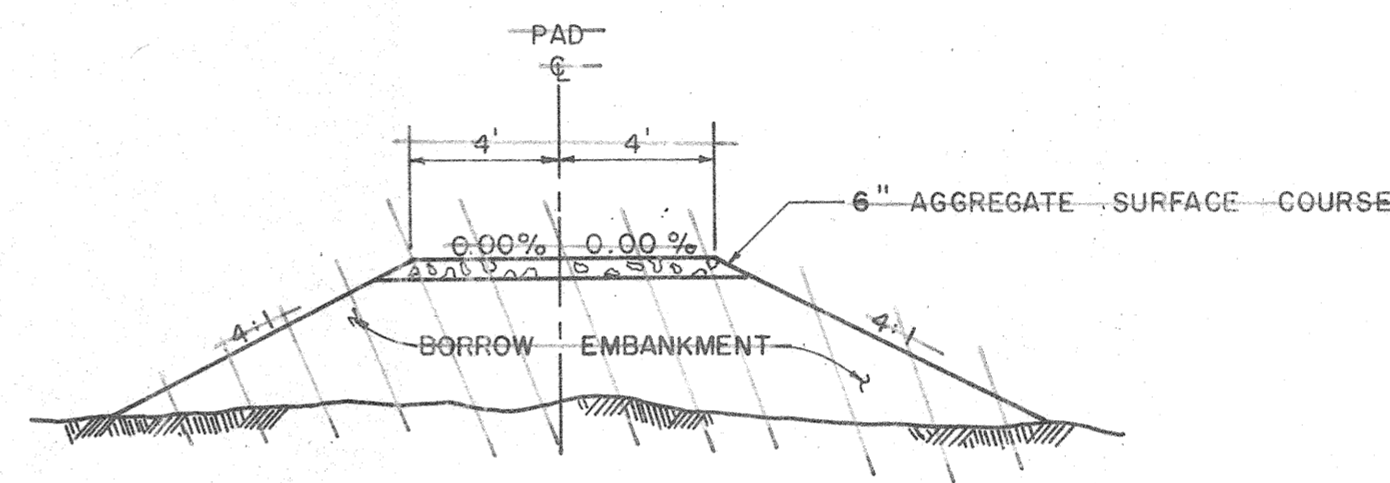

WIND CONE PAD TYPICAL FILL SECTION  
Deleted, See C.O. #3. 6/15/82

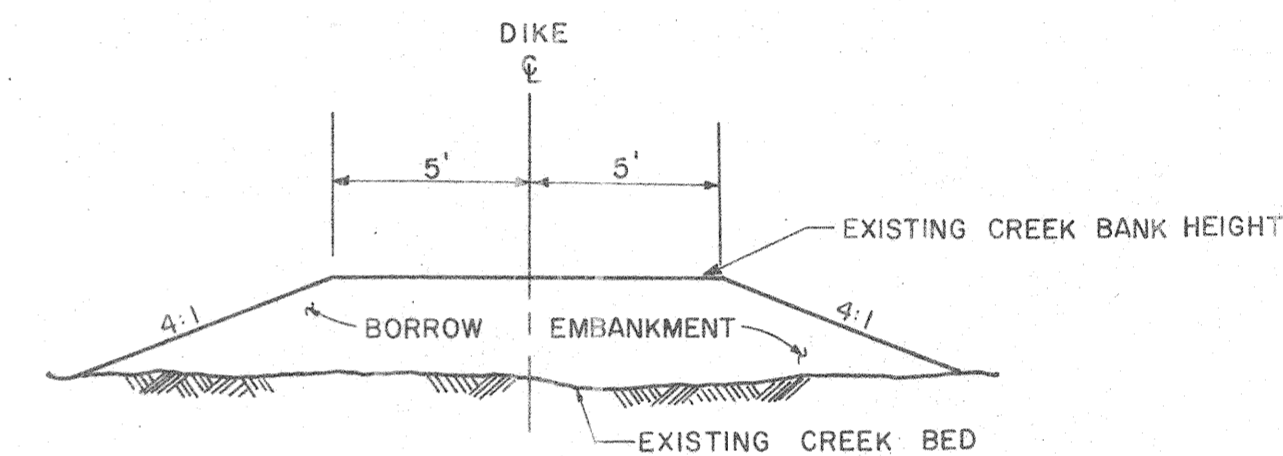

SLOUGH DIKE TYPICAL FILL SECTION

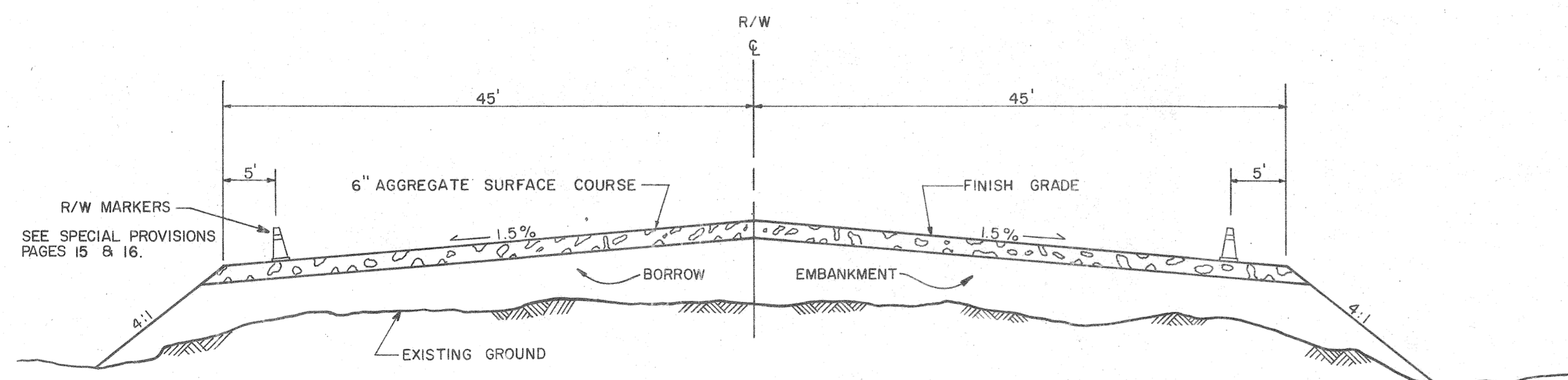

RUNWAY TYPICAL FILL SECTION

STA. 17+00 TO STA. 24+50 & STA. 51+00 TO STA. 52+00

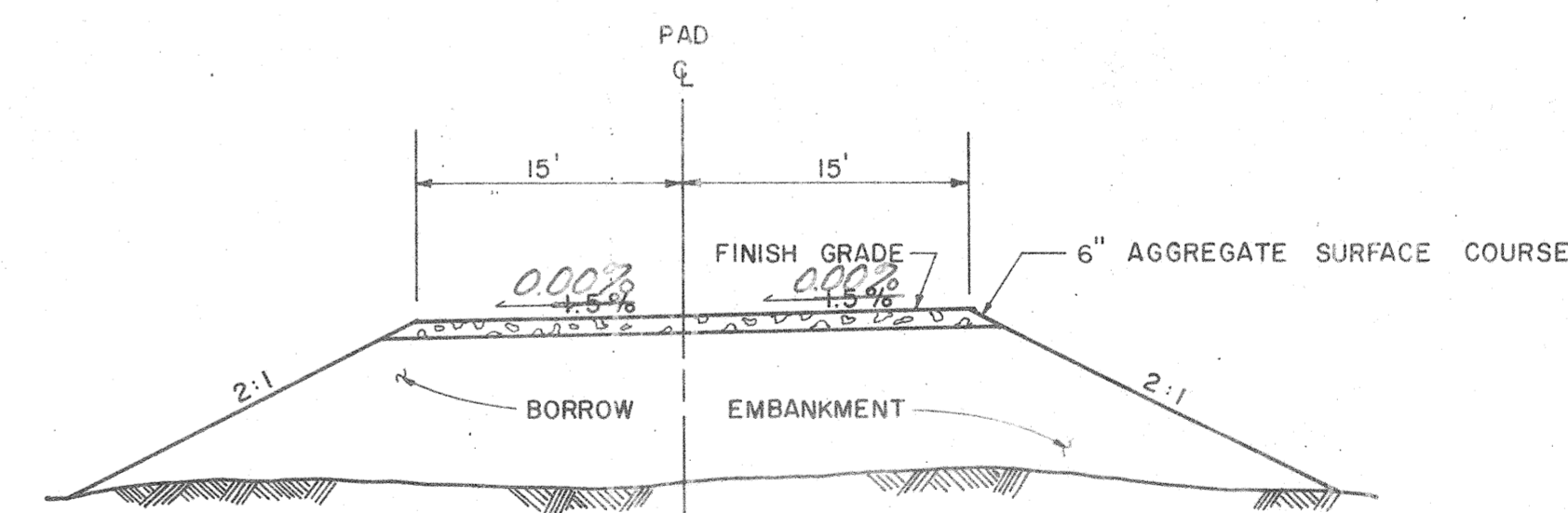

BEACON PAD TYPICAL FILL SECTION

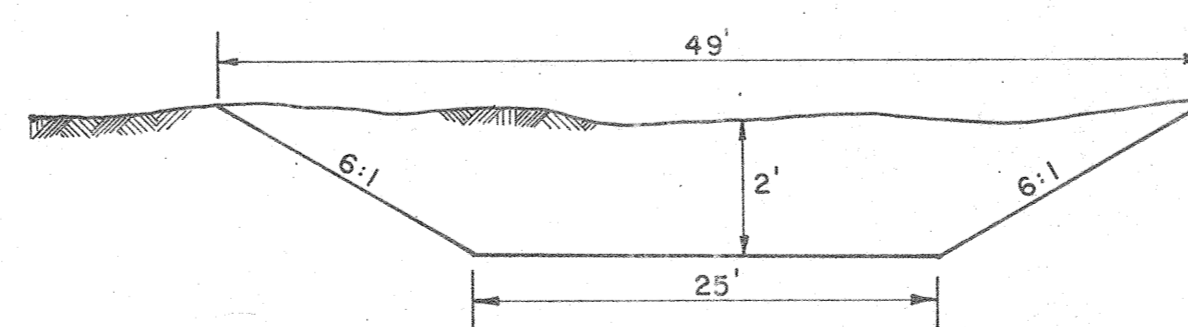

RECHANNELIZATION TYPICAL SECTION

NOTE: UNCLASSIFIED EXCAVATION FROM RECHANNELIZATION WILL BE USED TO FILL IN ABANDONED CHANNELS AS DIRECTED BY THE ENGINEER.

REVISIONS

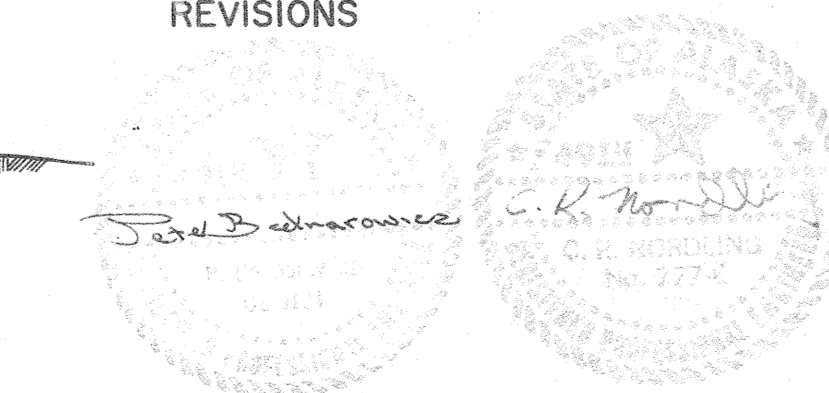

BY	DATE	REVISIONS	DESIGNED	C.R.N.	DRAWN	G.T.B.	CHECKED	C.R.N.	DATE	SHEET	OF
RB	12/3/81	REMOVED WASTE BERM, CHANGE TYPICAL	Tommy Alan Heimich		William A. Allison, P.E.					6	15
RB	"	CUT SECTION, AND SUBSTITUTED EXISTING			William Koester, P.E.						
RB	"	RUNWAY SECTION.									
		CHANGE									
		REVISIONS									

PLANS AND SPECIFICATIONS FOR THIS PROJECT  
PREPARED BY  
TONER & NORDLING  
REGISTERED ENGINEERS, INC.  
JUNEAU, ALASKA

STATE OF ALASKA  
DEPARTMENT OF TRANSPORTATION  
AND PUBLIC FACILITIES  
DIVISION OF AVIATION-DESIGN AND CONSTRUCTION

HOONAH AIRPORT  
S.C. NO. 81-691-01  
TYPICAL SECTIONS

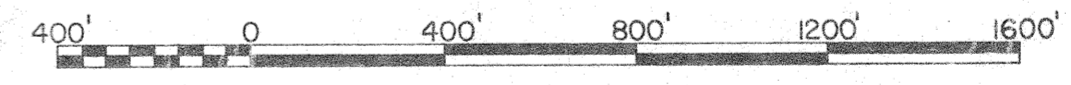
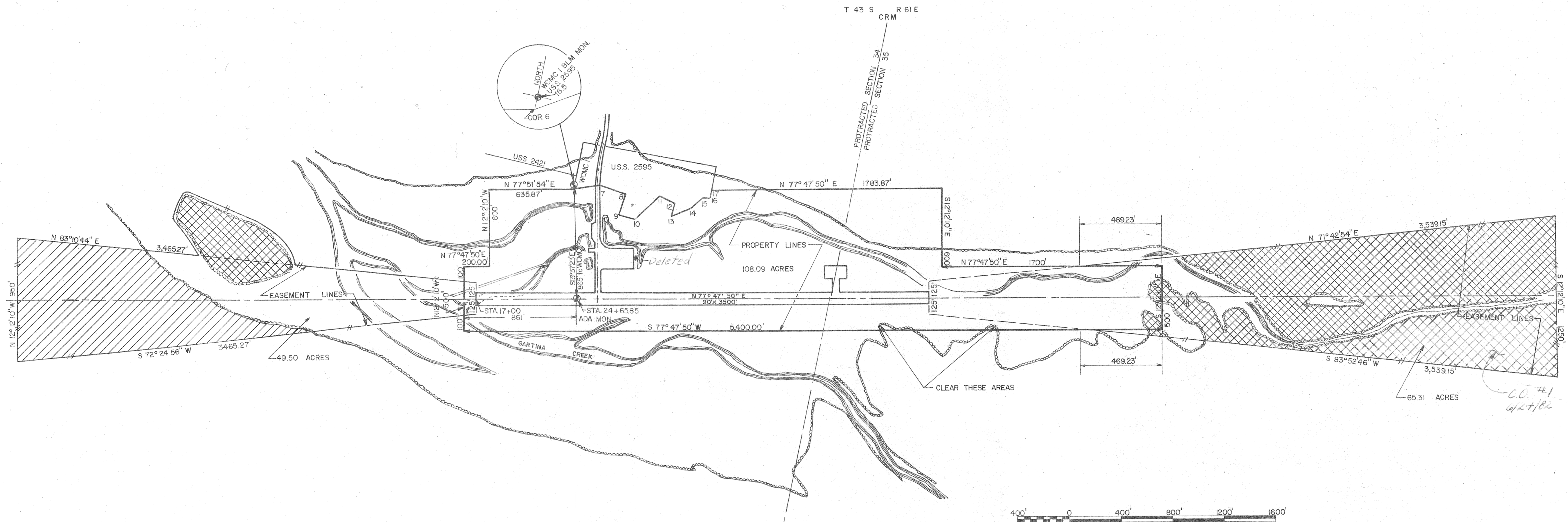
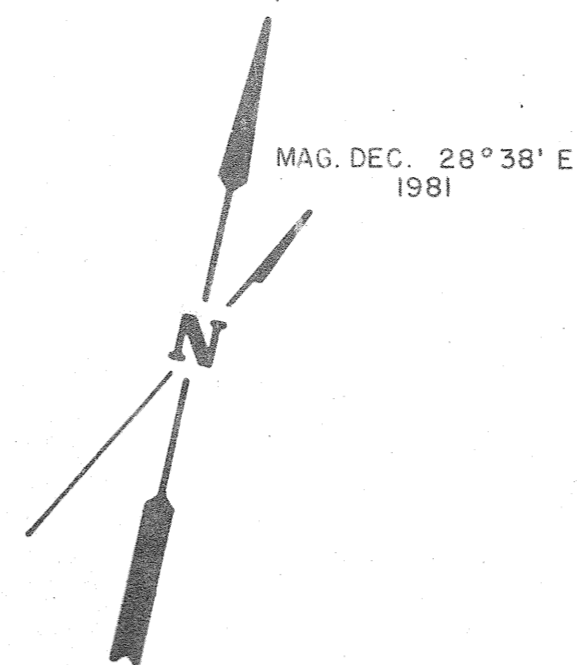

**MEANDERS OF PARCEL 1**

BEGINNING AT MEANDER COR. 1 OF U.S.S. 2595 BEGINS IDENTICAL TO COR. 6. PARCEL 1.

7.	S 2° 50' E	210.54
8.	S 78° 07' E	214.50
9.	S 8° 18' W	164.30
10.	S 82° 37' E	147.84
11.	N 34° 00' E	272.58
12.	S 67° 36' E	133.98
13.	S 4° 57' W	102.30
14.	N 55° 06' E	162.36
15.	N 35° 18' E	112.20
16.	N 77° 22' E	73.26
17.	N 0° 00' E	92.63

**LEGEND**

- ☒ - AREA TO BE CLEARED THIS CONTRACT (480 ACRES) \*
- ▨ - FUTURE CLEARING (29.0 ACRES)
- - BLM BRASS CAP

**REVISIONS**



\* ACTUAL CLEARING AREA AND QUANTITIES TO BE DETERMINED IN FIELD BY THE ENGINEER. THE STATE RESERVES THE RIGHT TO ADD OR DELETE THE AMOUNT OF CLEARING UNDER THIS CONTRACT.

NO.	DATE	REVISIONS
1	12/3/81	CHANGED PROPERTY AND CLEARING LIMITS
2	12/15/81	ADDED WIND CONE PAD & BAR SCALE.
		DELETED VASI PADS

PLANS AND SPECIFICATIONS FOR THIS PROJECT PREPARED BY  
 TONER & NORDLING REGISTERED ENGINEERS, INC. JUNEAU, ALASKA

**STATE OF ALASKA DEPARTMENT OF TRANSPORTATION AND PUBLIC FACILITIES**  
 DIVISION OF AVIATION-DESIGN AND CONSTRUCTION

**HOONAH AIRPORT**  
 S.C. NO. 81-691-01  
 CLEARING & PROPERTY PLAN

APPROVED: *William A. Allison* CHIEF DESIGN ENGINEER  
 APPROVED: *William Koester* SOUTHEAST REGION ENGINEER

SCALE: AS NOTED	DESIGNED: C.R.N.	DRAWN: G.T.B.	SHEET 7 OF 15
CHECKED: C.R.N.	DATE: 1/15/81		

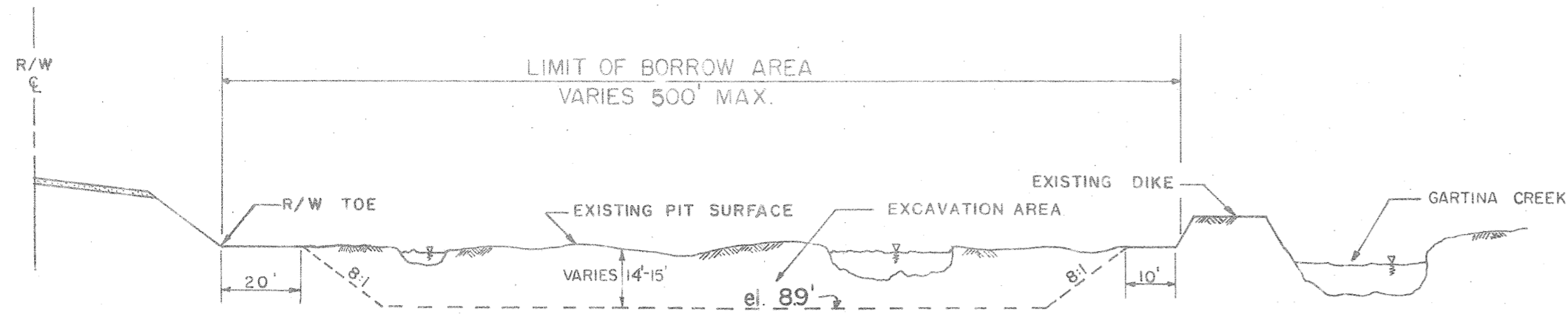

**BORROW AREA TYPICAL SECTION A-A**  
(CORP STIPULATIONS)  
(NO SCALE)

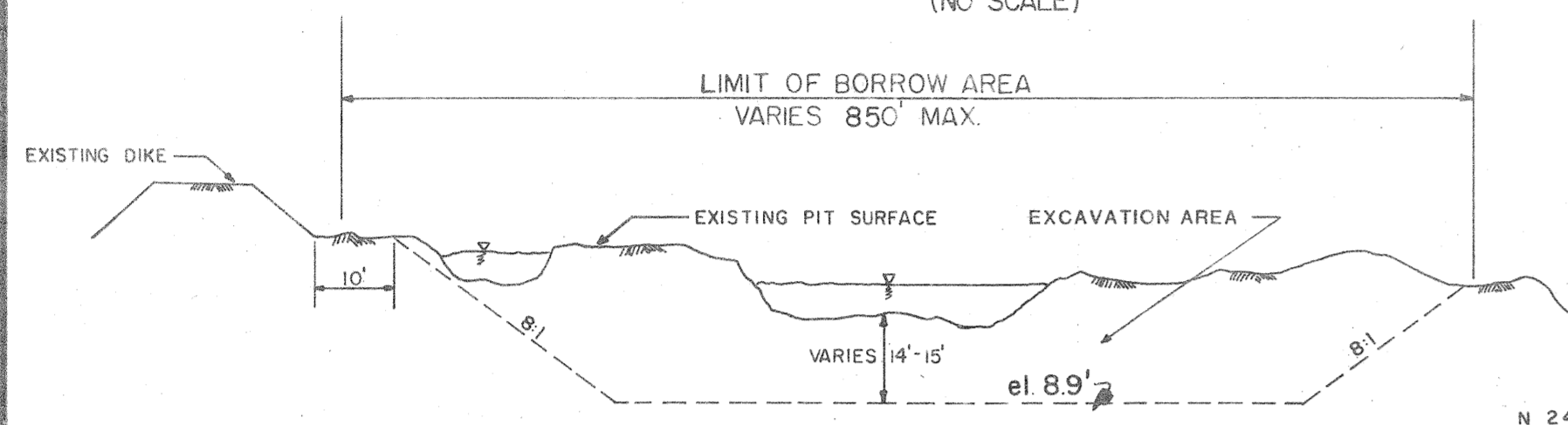

**BORROW AREA TYPICAL SECTION B-B**  
(CORP STIPULATIONS)  
(NO SCALE)

- LEGEND**
- ▽ TEST PIT
  - BORROW AREA LINE
  - PP POWER POLE
  - ⊙ BLM BRASS CAP

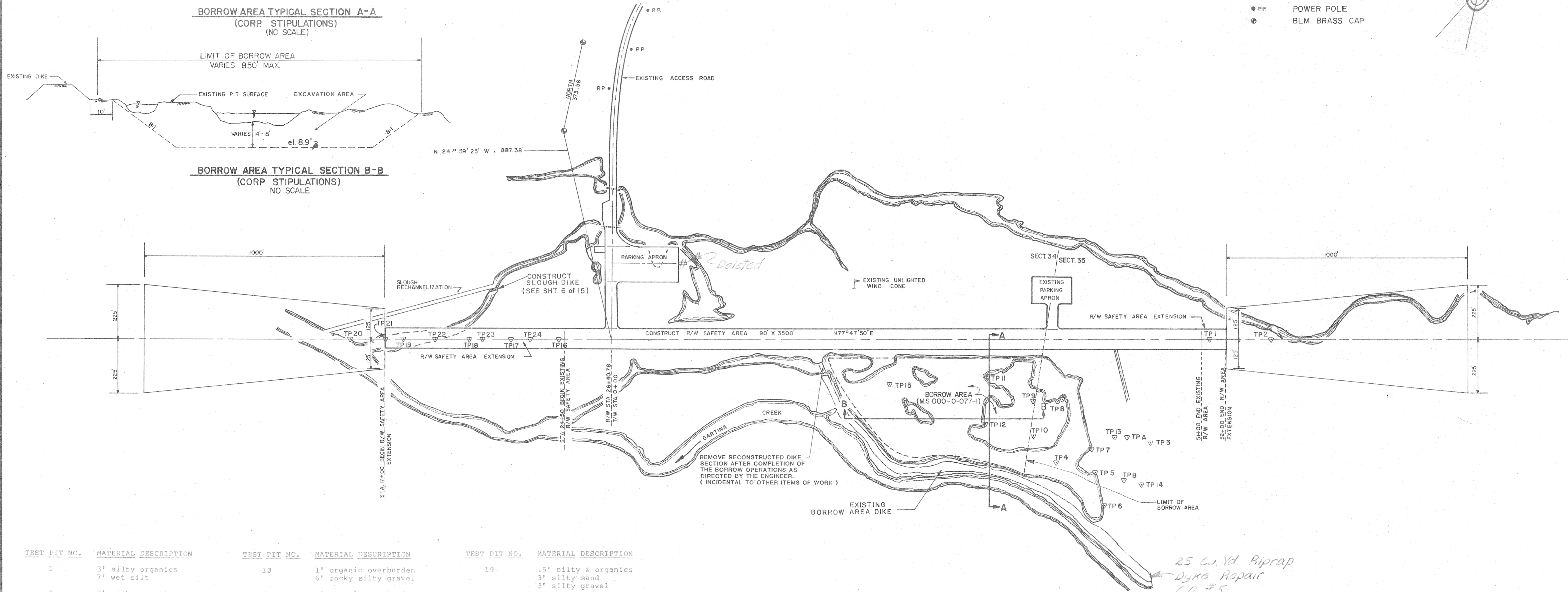
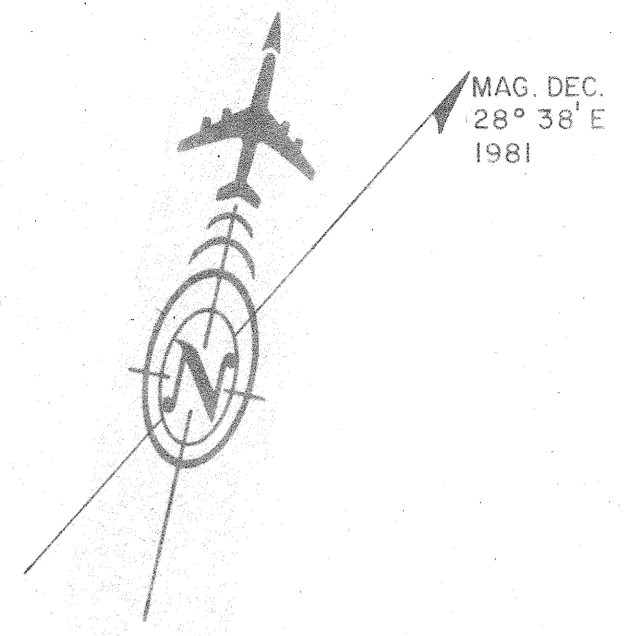

TEST PIT NO.	MATERIAL DESCRIPTION	TEST PIT NO.	MATERIAL DESCRIPTION	TEST PIT NO.	MATERIAL DESCRIPTION
1	3' silty organics 7' wet silt	10	1' organic overburden 6' rocky silty gravel	19	.5' silty & organics 3' silty sand 3' silty gravel
2	3' silty organics 8' wet silt	11	1' organic overburden 7' rocky silty gravel	20	.5' silt 3' silty sand
3	3' silt 3' silty gravel 3' soft blue clay	12	1' silty gravel 7' rocky gravel	21	.5' silt 3' silty sand
4	5' gravel	13	.5' silt 8' rocky gravel with thin silt layers	22	.5' silt 2' coarse sand
5	2' silt 4' silty gravel 7' gravel with silt pockets	14	1.5 ft. silt 7' sandy rocky gravel 1' soft blue clay 2'+ silty gravel with rocks	23	.5' organics 2.5' sandy silty gravel
6	3' silt & roots 5' silty gravel 5' gravel	15	5' silt 6' rocky silty gravel	24	.8' organics .3' gravel 2' silty sand
7	1' silty overburden 7' rocky gravel	16	3' silty sand 5' sandy gravel		
8	2' silt 4' silty rocky gravel	17	.5' silt 8' fine blue sand 2' sandy gravel		
9	2' sandy silt 6' rocky silty gravel	18	1' silt & organics 2' silty blue sand 2' silty gravel		

NOTE: Holes 1 through 18 dug with back hoe. Depth of holes within proposed borrow area limited by ground water.

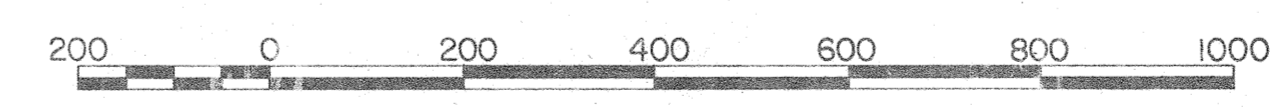

**REVISIONS**

NO.	DATE	DESCRIPTION
1	12/3/81	CHANGED PIT LIMITS
2	12/15/81	ADDED BAR SCALE, DELETED TYP GRADATION TABLE, RIPRAP TYP SECTION & NOTE
3	8/27/81	ADD RIPRAP TYPICAL SECTION & NOTE
4		DELETED

PLANS AND SPECIFICATIONS FOR THIS PROJECT  
PREPARED BY:  
TONER & NORDLING  
REGISTERED ENGINEERS, INC.  
JUNEAU, ALASKA

STATE OF ALASKA  
DEPARTMENT OF TRANSPORTATION  
AND PUBLIC FACILITIES  
DIVISION OF AVIATION-DESIGN AND CONSTRUCTION

**HOONAH AIRPORT**  
S.C. No. 81-691-01  
MINING & EXCAVATION PLAN

NO.	DATE	DESCRIPTION	DESIGNED	DRAWN	CHECKED	APPROVED
1	12/3/81	CHANGED PIT LIMITS				
2	12/15/81	ADDED BAR SCALE, DELETED TYP GRADATION TABLE, RIPRAP TYP SECTION & NOTE				
3	8/27/81	ADD RIPRAP TYPICAL SECTION & NOTE				
4		DELETED				

AS NOTED

SCALE: AS NOTED

DESIGNED: C.R.N.

DRAWN: G.T.B.

CHECKED: W.A.L.

APPROVED: *William A. Allison*  
WILLIAM A. ALLISON, P.E.  
CHIEF DESIGN ENGINEER

APPROVED: *William Koester*  
WILLIAM KOESTER, P.E.  
SOUTHEAST REGION ENGINEER

DATE: 12/15/81

SCALE: AS NOTED

SCALE: AS NOTED

SCALE: AS NOTED

SCALE: AS NOTED