





Thank you for your interest in our airport!

This permit will expire March 31, 2030. If you have any changes during this duration, please contact our office.

If you have any questions, or if we can be of further assistance to you, please call the **Tiedown Office: 907.474.2520**

FAIRBANKS INTERNATIONAL AIRPORT TIEDOWN PERMIT REGULATIONS

<https://www.akleg.gov/basis/aac.asp#17.42.600>

CURRENT STATS

We have 453 Tiedown spaces designated by the following categories:

BE (Paved Push Back w/ Power)	78
BN (Paved Push Back)	45
FP (Float Pond)	171
TE (Paved Taxi Thru w/ Power)	86
TN (Paved Taxi Thru)	9
UN (Unpaved Push Back)	19
Transient Spaces	45

FAI TIEDOWN FEES (2025)

	NONCOMMERCIAL			COMMERCIAL		
	1 Mo	6 Mos	1 Yr	1 Mo	6 Mos	1 Yr
BN (Paved Back in Non-Electrical)	\$30	\$180	\$360	\$40	\$240	\$480
TN (Paved Taxi Thru Non-Electrical)	\$45	\$270	\$540	\$55	\$330	\$660
BE (Paved Back in w/Electrical)	\$55	\$330	\$660	\$65	\$390	\$780
TE (Paved Taxi Thru w/Electrical)	\$60	\$360	\$720	\$70	\$420	\$840
UN (Unpaved Back in)	\$30	\$180	\$360	\$40	\$240	\$480
FP (Float Pond)	\$45	\$270	\$540	\$55	\$330	\$660
Second a/c FP	\$30	\$180	\$360	\$40	\$240	\$480
FP & BE (Combo)	\$70	\$420	\$840	\$80	\$480	\$960
Late Fee	\$40			\$40		
Transient Spaces	BN10A-I	BE11A-I-D	TE12A-E	TE13A-C	FP160-163 (T1-4)	
Non-Electrical		\$10/day				
Electrical		\$15/day				
Air Camping Park (14-day max stay)		\$10/day				

BUSINESS OFFICE CONTACT

There is no application fee. Tiedown fees are payable semiannually in advance on or before June 30 and December 31 each year. Fees are pro-rated, ensuring that permittees are billed fairly for the duration of rental.

If you have any questions, or if we can be of further assistance to you, please call the **Accounts Receivable Specialist: 907.474.2586**

KNOW BEFORE YOU GO!

For Additional Information: Contact FAI Operations 907-474-2552

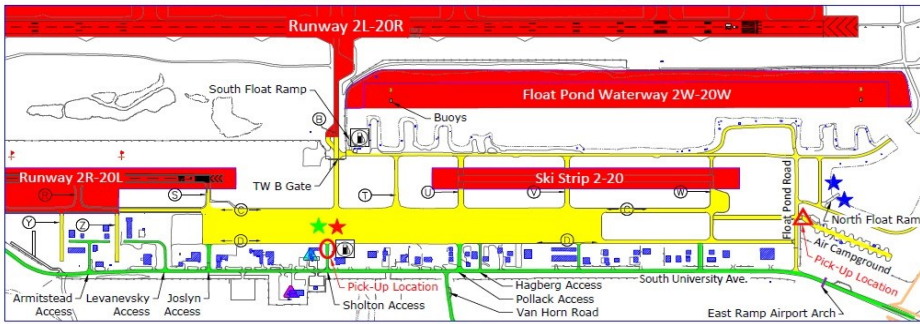

Legend

- **Tower Clearance Required** - Any access to the surfaces depicted in RED requires clearance from the tower, (Aircraft Use Only). These surfaces are marked with red hold signs and yellow hold lines painted across access points. Do not cross without tower clearance. Entering these areas without clearance will result in severe penalties and could cause an aircraft accident.
- **Aircraft Operations Area**. Use extreme caution in areas depicted in Yellow. Aircraft always have the right of way and may be behind you. Always take the most direct route to your destination. Maximum Speed Limit is 20 mph. Taxiway Delta is NOT to be used as a vehicle roadway. Except for short distances, use University Avenue.
- **Public Access Roads** are depicted in Green.
- Aircraft Fuel (Self Service)**
- FAA Control Tower**
- FAA Flight Service Station**
- Taxiway**
- Transient Aircraft Parking**
 - ★ **Non-Electric (Row 10)**
 - ★ **Electric (Rows 11-13)**
 - ★ **Float Pond (Water Spaces: T1-T4 Land Spaces: 160-163)**

KEEP AN EYE ON FAI

Report Suspicious or Unauthorized Activity

(907) 474-2530 or 911



Authorized Pick-up Locations

- △ **Air Campground** accessed via S. University Ave and Float Pond Road
- **Pilot Lounge** accessed via S. University Ave and Sholton Access

HELPFUL TIPS

Help Keep Fairbanks Airport East Ramp Looking Great!

If you have old pieces of broken or unusable equipment on your spot, remove and dispose of them properly.

If your space has an abandoned or unused vehicle permanently parked on it, relocate to another place.

If your space is overgrown, Summer is a great time to clear brush & mow. Check to see if your Tiedowns are in need of repair and reach out to the Tiedown Office for assistance.

Fuel Tank Safety Check

Perform a safety check on any tanks and hoses on your Tiedown space & make any upgrades necessary to comply with Alaska regulations.

Snow Removal

FAI Tiedown permittees may remove snow from their spaces and position it for later removal by Airport staff, provided it is kept as close as possible to the tiedown space. Snow may not be moved or positioned across adjoining Tiedown spaces, taxiways, taxi lanes, parking rows, nor in any manner that creates a hazard or blocks vehicle or aircraft access to the parking row. Snow piles must be kept as low as possible, no higher than 36".

[See Operational Order 2.4 for more info.](#)

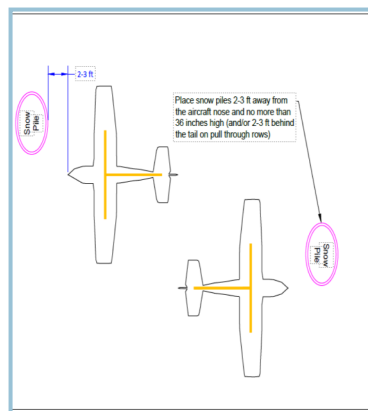

PILOTS LOUNGE

The lounge is provided for the comfort of general aviation pilots and their passengers and is located on the East Ramp near the base of the control tower. This facility has a restroom, shower, free Wi-Fi, and TV/DVD for viewing FAA safety videos.

Access is provided by contacting the **FAI Communications Center** at **907.474.2530**.



TIEDOWN BUILDING PERMITS

Only Float Pond & Gravel Tiedown Permittees are permitted to set up, or transfer, a storage shed and a fuel storage tank on their leased space. Additionally, Float Pond Permittees are permitted to build a dock.

The Tiedown Office must receive written approval to add or transfer any building or fuel tanks on leased property.

To download a Tiedown Building Permit, please visit:

<https://dot.alaska.gov/faiiap/pdfs/tiedownapp.pdf>



Report uncontrollable spills & spills in excess of 10 gallons or more to **Dispatch at 907.474.2530**.

If you discover a spill, report it to Dispatch even if you are not the person responsible for the spill.

For more information, visit: <https://dot.alaska.gov/faiiap/dept-environmental-spills.shtml>



WE ARE LOCATED IN THE MAIN PASSENGER TERMINAL

FAI ADMINISTRATIVE OFFICE LOCATED ON SECOND FLOOR

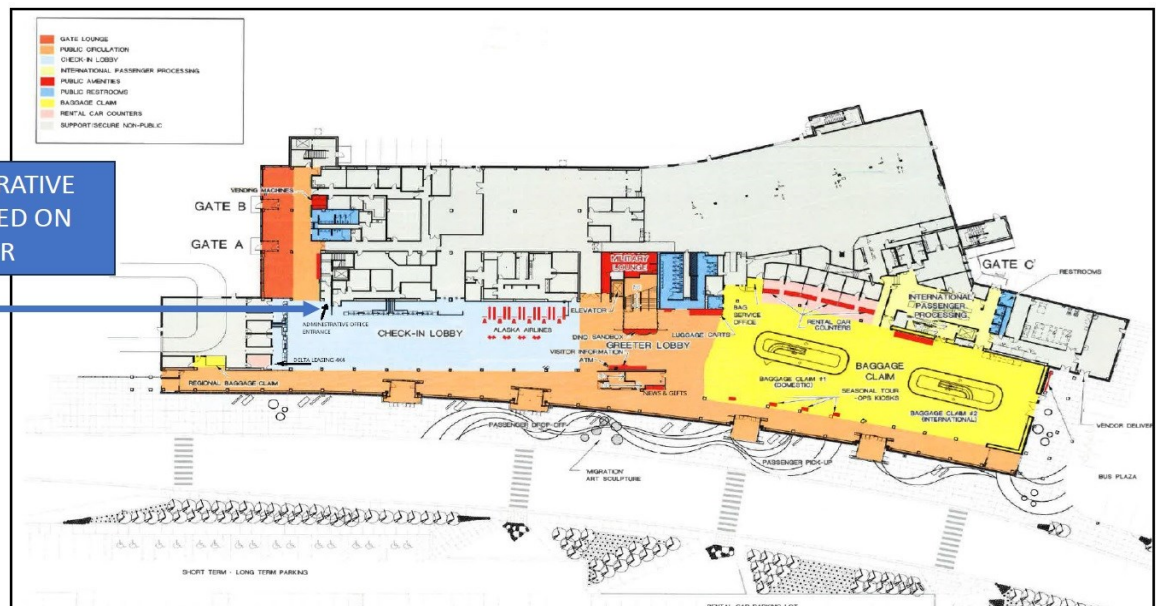

PLEASE CALL US IF YOU HAVE ANY QUESTIONS 907.474.2520