

01.04.06 TALKKEETNA SPUR ROAD



*Put in the Rain*  
ALL-WEATHER  
TRANSIT BOOK  
No. 300 F

WATER 5.07  
ROAD 12.47  
WATER 3.35  
56.16

# CONTENTS

PAGE	REFERENCE	DATE
1	INDEX	
3	PEG TEST - DL-103	2-28-01
4	PEG TEST - SDL-30	2-28-01
5-8	LEVEL LOOP - B106 $\Rightarrow$ BM 2001-6	2-28
9-10	LEVEL LOOP - BM 6 $\Rightarrow$ BM 7 START	2-28
11-17	VERT. CONTROL - BM 6 $\Rightarrow$ BM 7 FINISHED	3-1-01
18-24	" " BM 7 $\Rightarrow$ BM 8 START	3-1
25-26	" " BM 7 $\Rightarrow$ BM 8 FINISH	3-2
27-34	" " BM 8 $\Rightarrow$ BM 9 START TO FINISH	3-2
35-38	" " BM 9 $\Rightarrow$ BM 10 START	3-2
39-42	" " BM 9 $\Rightarrow$ BM 10 FINISH	3-3
43-51	" " BM 10 $\Rightarrow$ BM 11 AND FINISHED START	3-3
52-60	" " BM 11 $\Rightarrow$ BM 12 START AND FINISHED	3-4
61-62	" " L105 $\Rightarrow$ BM 12 START AND FINISHED	3-4
63-64	" " L105 $\Rightarrow$ TP60 START AND FINISHED	3-4
65	" " Q105 $\Rightarrow$ TP30 START AND FINISHED	3-4
66-71	" " BM 12 $\Rightarrow$ W105	3-5
71	" " TP62 $\Rightarrow$ TFSORO PHOTO ID	3-5
72-74	" " BM 7 $\Rightarrow$ TP25 (GPS 11)	3-5

BK6

①

P22 E-106 USCG BM

BK6

②

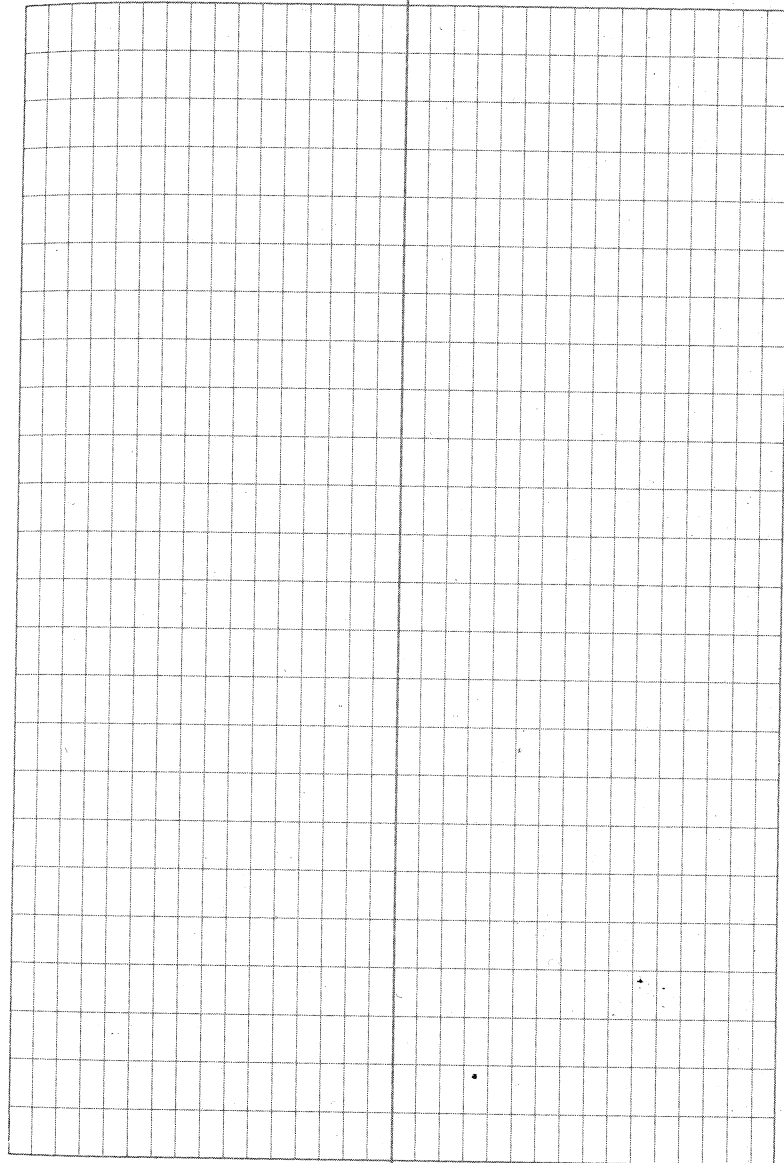

# PEG TEST

TOPCON DL 103

PT #

+

HI

-

"A" 1.454

B 1.702

DIFF 0.248

IN MIDDLE  
w/METRIC ROD

"B" 1.498

"A" 1.248

DIFF .250

@ "B"  
w/METRIC ROD

"B" 1.49<sup>66</sup>

"A" 1.2487

DIFF 0.2479

@ "B"  
w/~~METRIC~~  
FOOT ROD

"B" 1.6718

"A" 1.4239

DIFF 0.2479

@ MIDDLE  
w/FOOT ROD

2-28-01

CLOUDY, CALM,

BK6

3

CM  
PC  
KK

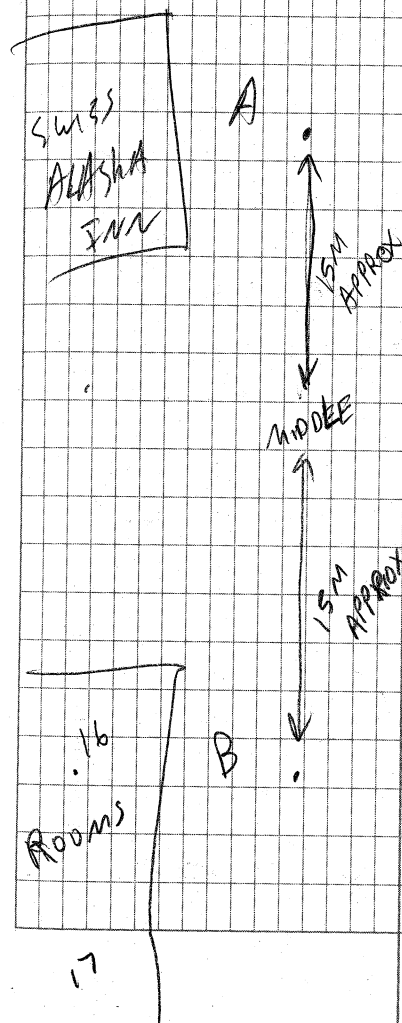

B 1.6725  
A 1.4250



PE6

TEST

SOCKIA  
SDL 30

"A" 1.4153

π @ MIDDLE

"B" 1.6629

DIFF 0.2476

"B" "A" 1.5672

π @ "B"

"A" "B" 1.3176

DIFF 0.2496

"B" 1.5673

π @ "B"

"A" 1.3179

0.2494

13197

2-28-01

BKG

④

CM  
KK

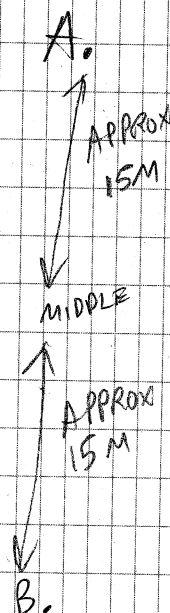

TALKEETNA  
BEGIN Loop B106  $\rightarrow$  BM 2001-6

	+	HI	-	ELEV	NAVD '29
B106				123.701	120.059
TP1	1.981				
TP1 RAND		1.7463			
	0.8028				
TP2 RAND		3.3330			
	0.4422				
TP3 TP1		<u>1.0476</u>		118.2792	114.6371
	<del>2.1367</del> 1.0476	119.3268			
TP2		2.1367	117.1901	113.548	
	0.7521	117.9422			
RAND		2.8221	115.1201		
	1.1232	116.2433			

2-28-01

BKG

(5)

PARTLY CLOUDY,

PC  
KK

PT #2 END USC&GS BM CM-IM  
 ACROSS FROM ASSEMBLY OF GOD  
 CHURCH 7 MI. SPUR RD NO CAP

NAVD 88 121.880 M  
 + 1.821  
 NAVD 29 123.701

#4

SEE Pg 8  
DO OVER

SET PK 1.3 E. OF ER W.L. (SEE Pg 8)

SET SPIKE @ EP TBM-TP2

#6

TALKEETNA  
VERTICAL CONTROL

+ H I - ELEV ADJ. NAVD 83

116.2433

TBM-TP3

1.3123

114.931

~~114.9310~~

111.2894

1.7822 116.7132

TP4  
(BM6)

1.8337

114.8795

~~114.8795~~

111.2382

2.0048 116.8843

TP5  
(TBM-TP3)

1.9525

114.9318

111.2894

1.3076 116.2394

R. 9

1.2346

115.0048

2.9161 117.9209

TP6<sub>10</sub>  
(TP2)

0.7311

~~0.7311~~

117.1898

113.548

2-28-01

BK6

(6)

CLOUDY, WIND 3-6, 33°

PC

KK

CM-3.4

#6 - PK IN WHITE LINE  
ON E. SIDE HWY - DIAG BM6

FND 82mm ALCAP BM 2001-6  
#7

8 "PK" IN EAST FOG LINE 20M N  
BM 2001-6

9

FND SPIKE @ EP TBM-TP2 WEST SIDE  
Hwy

RETURN TALKETNA  
LOOP TO B106 VERTICAL CONTROL

+ HI - ELEV ADD. NAVD 83

TP 6

(TP2)

117.1898 113.548

2.0320 119.2218

TP 7<sup>111</sup>

(TP1)

0.9428 118.2790 114.6371

3.4100 121.6890

12

0.4883 121.2007

3.1100 124.3107

13

0.4413 123.8694

1.8132 125.6826

TP 8

14

1.9803 123.701 [123.702]

→ 123.7023 120.059

BK6

7

2-28-01

P. CHURCH

K. KLEINE

C. MULLIKAN

END SPIKE @ W. SIDE SPUR HWY EP

END "PK" EAST SIDE @ FOG LINE

B106 USC & GS

(123.701)

124.787? TDS ELEV

EC = 0.0013

RUN B106 → TP 1

+ HI - ELEV NAVD '29  
ADJ.

TP 8 <sup>15</sup>

123.701 120.059

1.8888 125.5898

<sup>16</sup>

1.6526 123.9372

0.7597 124.6969

<sup>17</sup>

2.9008 121.7961

0.0843 121.8804

TP 1 <sup>18</sup>

3.6012 118.2792 114.6371

CONTINUE LEG TO  
BM 2001-6 PG 5

THIS LEG RERUN DUE TO LACK  
OF (-) MINUS RECORDED!

2-28-01

BK 6

8

B106 USC#65

SAME CREW  
PAT CHURCH  
KEN KLEINE  
CHRISTOPHER MULLIKIN

"PK" 1.3 EAST OF ER WHITE LINE

BM6  
BM7

# TALKEETNA VERTICAL CONTROL

+ HI - ELEV NAVD '29  
ADJ.

BM6

1.9860 116.8655

114.8795 111.2382

R 20

1.2005 115.6650

1.6649 117.3299

R 21

1.4450 115.8849

1.2174 117.1023

TBM-  
TP9

1.7310 115.3713 111.7286

1.0919 116.4632

TBM-TP10

2.0431 114.4201 110.7775

1.1219 115.5420

R-24

1.6352 113.9068

BK6

9

2-28-01

CLOUDY, CALM, 32°

SAME CREW

P. CHURCH

BM 2001-6

K. ALEME

C. MULLIKIN

RANDOM PT #20

" " #21

SET SPIKE W/PINK FUZZY  
#22 1.3 M OFF FOG LINE  
APPROX 5 M S. OF DRIVEWAY

SET SPIKE W/PINK FUZZY  
#23 IN FOG LINE  
APPROX 100 M S. OF TBM-TP9

BM6)  
BM7

TALKEETNA  
VERTICAL CONT.

NAVD '23

+ HI -

ELEV ADJ.

R-24

113.9068

1.6224 115.5292

R-25

1.2794 114.2498

1.6386 115.8884

TBM TP11

1.5483 114.3401 110.6989

[END OF DAY]  
(CONT. NEXT PG)

BK6

10

2-28-01

CLOUDY, CALM,

PC

KK

CM-IM.

TBM TP 11 SPIKE & CARBOR @ SP

1.4 M OUTSIDE FOG LINE

#2 25 M N. OF BACKWOODS ENTERPRISE  
APPROACH

[ELEV 115.291]



BM6  
BM7

# TALKEETNA

(CONTINUED FROM PG 10)  
+ HI - ELEV NAVD '29  
ADJ.

TBM-TP11 114.3401 110.6989  
1.3005 115.6406

TP12 3.5216 112.1190 108.4786  
C-106 1.3035 113.4225

R-28 3.3823 110.0402

0.3744 110.4146

TBM-TP13 2.8773 107.5373 103.8986

1.4105 108.9478

R-30 1.8911 107.0567

1.5902 108.6469

TBM-TP14 0.5786 108.0683  
104.4286

BK6

11

3-1-01

MOSTLY CLOUDY, CALM, 30°

PC  
KK  
CM

~~FND~~ SPIKE W/CHASER @ EP

FND BRASS CAP C-106 (112.129)

#27 IN WHITE PIPE  
WITNESS POST 0.6 m N.

1 cm Low!

#28

#29 SPIKE 6" BIRCH  
IN TREE  
W. SIDE OF ROAD

#30

#31. SSP IN TREE - BIRCH - 40 cm DIAM  
E. SIDE OF ROAD



BM 6  
BM 7

TALKEETNA

NAVD '29

+ HI - ELEV ADJ.

TBM-TP 14

104.4286

0.5790

108.0683

108.6473

R-32

1.4241 107.2232

1.5646 108.7878

TBM-TP 15

1.5504 107.2374 <sup>103.5972</sup>

1.5281 108.7655

TP 16 <sup>34</sup>

1.5041 107.2614 <sup>103.6221</sup>

1.3498 108.6112

R 35

1.6216 106.9896

1.0051 107.9947

R 36

1.7501 106.2446

BK 6

12

3-1-01

MOSTLY SUNNY, CALM, 30°

PC  
KK  
CM  
IM

#32

#33 SET SPIKE W/FOZZY 1.3 M  
OUTSIDE FOG LINE

2<sup>M</sup> N. OF APPROACH

TP 16-TBM "PK" @ EP EAST SIDE  
0.9 EAST OF WHITE ER LINE @  
CULVERT X-ING

BM6  
BM7

TAKKEETNA

+ HI - ELEV NAVD '29  
ADJ.

R 36

106.2446

1.1579 107.4025

R 37

1.4718 105.9307

1.9650 107.8957

TP 17<sup>38</sup>

1.8246 106.0711 102 A286

1.8777 107.9488

R 39

2.0169 105.9319

1.4639 107.3958

R 40

1.2374 106.1584

1.8009 107.9593

R 41

1.1116 106.8477

3.1.01

BK 6

13

RUC  
CMT  
KK

BM 2001-7

BM 6  
BM 7

# TALKEETNA

+ H1 - ELEV NAVD '29

R 41

106.8477

1.7144 108.5621

R 42

1.4443 107.1178

1.5102 108.6280

43  
(TP16)

103.6221  
1.3625 107.2655 ~~107.2655~~

1.4669 108.7324

44  
(TP15)

103.5972  
1.4928 107.2396

1.4344 108.6751

45

1.4994 107.1757

1.4675 108.6492

46  
(TP14)

0.5716 108.0716

BK6

14

3.11.01

SAME CREW

PC

KK

CM

TP 16 ~ TBM "PK" @ EP 0.9 EAST W/L  
Pg 12 (107.2614) 107.2655 This Leg

TP 15 ~ TBM SPIKE @ 1.3 EAST OF W/L  
Pg 12 (107.2374) 107.2396 This Leg

TP 14 ~ TBM SPIKE IN 40CM BIRCH  
E. SIDE HWY PG. 11 (108.0683)

BM6  
BM7

TALKEETNA

+ HI - ELEV NAVD '29  
ADJ.

46

108.074

0.5525 108.624

47

1.5089 107.1152

1.6639

48

1.2366

103.8986

(TP13)

2.9742 110.5167

49

0.2432 110.2735

2.8241 113.0946

(TP12)  
(C106)

1.4797

51

1.8598 112.1208

3.1.01

BK6

15

SAME CREW

PC

HR

CM

TP13 ~ TBM SPIKE IN BIRCH W/S HWY  
P9 11 (107.5373) 107.5425 This Leg

TP12 ~ TBM C106

P9 11 (112.1190) 112.1208 This Leg

\* 31

BM6  
(BM7)

RETURN LEG - TALKEETNA

+ 14' - ELEV NAVD '29  
ADJ.

51

108.4786

2.9369

52

(TP11)

0.6174

110.6989

1.5321 115.8724

53

1.7391 114.1333

1.1593 115.2926

54

1.2954 113.9972

1.5503

55

(TP10)

1.1299

110.7775

1.9904 116.6080

56

(TP9)

1.0394

111.7286

BK6

16

3.1.01

SAME CREW

PC

KK

CM

112.1208

TP 12 ~ TBM C106

TP 11 ~ TBM SPIKE @ EP 1.4 E. OF W/L

pg 10 (114.3401)

114.3403 <sup>THIS</sup> Leg

TP 10 ~ TBM SPIKE & CHASER IN CRACK W/L

pg 9 (114.4201)

114.4176 This Leg

TP 9 ~ TBM pg. 9 (115.3713)

115.3686

BM6  
BM7

TALKEETNA

+ HI - ELEV NAVD '29  
ADJ.

56

111.7286

2.0243

57

1.4244 115.9685

1.1108 117.0793

58

1.8709 115.2084

1.3894 116.5978

59

1.7208

111.2382

(BM6)

3-1-01

BK6

17

SAME CREW

PC

KK

CM

TP9 ~ TBM PG 9

TP 8 ~ BM 2001-6

PG 9 (114.8795)

114.8770 This Leg

0.0025 D.F.F

BM7  
BMB

TALKEETNA

+

141

-

ELEV NAVD '29  
ADJ.

TP17

106.0711 102.4286

2.4455 108.5166

R-60

0.6025 107.9141

2.6385 110.5526

R-61

0.5384 110.0142

2.6491 112.6633

TBM  
TP18

0.7235 111.9398 108.2974

1.3012 113.2410

R-63

2.1939 111.0471

0.1417 111.1888

R-64

3.2612 107.9276

3.1.01

BK6

18

MOSTLY CLOUDY, CALM, 32°

SAME CREW

P. CHURCH

BM 2001-7 pg 13

K KLEINE

C. MULLIKIN

#60

#61

#62

SET SPIKE W/FUZZY  
1.3M E. OF FOG LINE

#63

#64



BM7  
BM8

# TALKEETNA

+ HI - ELEV NAVD '29  
ADJ.

R64 107.9276

0.2214 108.1490

SPK-65 1.4181 106.7309 103.0897

1.9866 108.7175

TBM-TP19 0.7803 107.9372 104.2962

3.8813 111.8185

~~TBM-TP~~  
R-67 0.0700 111.7485

4.2231 115.9716

TBM-TP20 0.5119 115.4597 111.8187

3.6113 119.0710

R-69 0.0718 118.9932

BK6

19

3-1-01

MOSTLY CLOUDY, CALM, 32°

PC

CM

KK

#65 SET PK IN FOG LINE

APPROX 15m S. OF ANSWER CREEK SIGN

#66 SET SPIKE 1.3 M OUTSIDE FOG LINE

APPROX 60 m S. OF SPK-65

TBM-TP20

#68 SET SPIKE IN TREE

10 cm ASPEN



BM 7  
BM 8

TALKRETTNA

+

HI

-

ELEV NAVD. '29  
ADJ.

R 69

118.9932

4.3182 123.3114

R-70

0.1985 123.1129

4.2473 127.3602

R-71

0.1189 127.2413

4.4628

~~4.4628~~ 131.7041

TP21 72

0.1310 131.5731 127.9311

2.9863 134.5594

73

0.7945 133.7649

1.8269 135.5918

74

1.1548 134.4370

3-1-01

BK6

20

HAZY CLOUDY, CALM

PC  
CM  
KK

SET SPIKE & CHASER @ 1.1 E. OF W/L  
7M SO. OF APPROACH FIDDLEHEAD FERN DR.  
& DRIVEWAY EAST SIDE HWY GPS

BM7  
BM8

TALKEETNA

+ HI - ELEV NAVD'22  
ADJ.

74

134.4370

1.5974 136.0344

TP22 75

1.4744 134.5600 130.9175

1.8340 136.3940

76

1.2168 135.1772

1.2203 136.3975

77

2.1564 134.2411

1.1676 135.4087

TP23 78

1.2393 130.5273

BK6

21

3.1.01

SAME CROW

PC

CM

KK

SET SPIKE & CHASER 1.3 EAST W/L

1.4211

BM 2001-8

134.1694 This Leg

Loop to BM 2001-9 CONT'D pg 27

BM7  
BM8

# TALKEETNA

+ HI - ELEV NAVD '29  
ADJ.

TP 23<sup>78</sup>

1.1966 135.3660

TP 24<sup>79</sup>

1.5772 130.1467

2.0641 135.8529

80

0.6710 135.1819

1.2781 136.4600

81

1.7254 134.7346

1.2464 135.9810

83

1.7291 134.2519

1.1083 135.3602

84

2.0010 133.3592

BK6

22

3-1-01

SAME CREW

PC  
KK  
CM

BM 2001-B

134.1674

USCGS E106 "9.9 MI" S. TALKEETNA

END BL

25M S. OF

BM 2001-B (133.796 NGS) 133.7888 THIS  
LEG

8mm LOWER

THAN NGS

BM7  
BM8

# TALKEETNA LEVELS

+ 141 - ELEV NAVD '29  
ADJ

84 133.3592

0.8532 134.2124

+ TP21 85 2.6382 131. 127.9311

0.4138 131.9880

86 4.1347 127.8583

0.1928 128.0461

87 4.2277 123.8184

0.1869 124.0053

88 4.2545 119.7508

0.2718 120.0226

89 3.1502 116.8724

3.1.01

BK 6

23

SAME CREW

PC

CM

KK

TP 21 ~ TBM SPIKE @ CHASER 1.1 E. OF W/L

P930 (131.5731)

131.5742 THIS  
LEG

BM7  
BM8

TALKEETNA

+ HI - ELEV NAVD '29  
ADJ.

89

116.8724

0.3242 117.1966

TP20<sup>90</sup>

1.7339 115.4627  
111.8187

0.5565 116.0192

91

3.5581 112.4611

0.2460 112.7071

92

3.2993 109.4078

0.8353 110.2431

TP19<sup>93</sup>

2.3028 107.9403  
104.2962

END OF DAY 6:40P

3.1.01

BK6

24

SAME CREW

PC

CM

KK

TP30 SPIKE IN ASPEN  
PG19 (115.4597)

TP19 107.9403

TP17 106.0826

RETURN LEG 3.1.01  $\Delta$  = 1.8577

3.05.01 PG72  $\Delta$  = 1.8684

ERRATA  $\rightarrow$  0.0107

TP19 SPIKE @ 1.3 EAST OF W/L  
PG19 (107.9372)

BM7  
BM8

# TALKEETNA

+ HI - ELEV NAVD 29  
ADJ.

TP19<sup>93</sup> 107.9403 104.2962

0.3450 108.2853

R 94. 1.6523 106.633

3.2568 109.8898

93 0.2125 109.6773

4.8379 114.5152

TP25<sup>96</sup> 0.1465 114.3687 110.7215

0.2011 114.5698

97 3.6403 110.9295

2.1461 113.0756

TP18<sup>98</sup> 1.1289 111.9467 108.2974

BK 6

25

3.2.01

9.30  
10.30

RICE

GM K

TP19 SPIKE @ 1.3 EAST

K.K. 9

OF ER W/L PG 34

SNOW!

TURN UP KNOLL FOR GPS C.P.

NOTE:

(DO OVER PG 74)

From DRIVE ROD 0.7 ABOVE SNOW! TOP OF  
CUTBANK @ WEST SIDE HWY SOUTH  
END KNOLL 2M WEST TOP  
NORTH OF "ANSWER CREEK" 100M±

SPIKE & CHASER 1.3 EAST OF ER W/L  
PG 18 (111.9398)

BM7  
BM8

TALKEETNA

+ HI - ELEV NAVD '29  
ADJ.

TP18

111.9267 108.2974

1.0664 113.0131

91

2.6167 110.3964

0.5501 110.9445

100

2.4490 108.4975

0.5522 109.0447

101

2.1783 106.8714

1.2703 108.1417

TP17<sup>102</sup>

2.0591 102.4286

BK6

26

3.02.01

SNOW '8\*

SAME CREW

P. CHURCH

C. MULLIKIN

K. KLEINE

TP17 ~ BM 2001-7

PG18 (106.0711)

106.0826

12mm



BM8  
BM9

# TALKEETNA

+ HI - ELEV NAVD '29  
ADJ.

TP 23 134.1694 130.5273

1.2088 135.3782

TP 24 1.5884 133.7898 130.1480

0.7480 134.5378

R-104 3.5976 130.9402

0.2023 131.1425

R-105 3.1650 127.9775

0.5036 128.4811

TP 26 2.1594 126.3217 122.6805

0.3650 126.6867

R-107 2.8365 123.8502

3.02.01

BK 6

27

SAME CREW

PC

KK

CM

BM 2001-B

Pg 21

USCGS E106

#103 PG 22 (133.796 NGS)

#104

#105

#106 SET PK w/CHASER

3.3 FROM

WALSTEAD RD

SIGN

#107



BM 8  
BM 9

TALHEETNA

J HI - ELEV NAVD '29  
ADJ.

R 107

123.8502

0.3794 124.2296

TP 27

2.0186 122.2110

R 108

0.9910 123.2020

TP 27

1.4417 121.7603 118.1174

1.0309 122.7912

R 110

1.7325 121.0587

1.0371 122.0958

R 111

1.5179 120.5779

1.8136 122.3915

TP 28

1.1172 121.2743 117.632

BK 6

28

3-2-01

PL

CM

KK

SET SPINE w/ FUZZY 5.5 M W. E  
#109 KITTY CORNER SUNSHINE SDA CIR.  
SOUTH OF SIGN

GPS CONTROL POINT

TP 28

#112 SET MAGNAIL w/ FUZZY  
8.2 M E. AIRSTRIP AVE SIGN  
5.5 M W. E

BM8  
BM9

TALKEETNA

+ HI - ELEV NAVD '29  
ADJ.

TP28 121.2743 117.632

2.2086 123.4829

TP29 0.5572 122.9257 119.2834

1.6763 124.6020

R 114 0.8575 123.7445

2.0728 125.8173

R 115 0.8538 124.9635

1.9799 126.9434

R 116 0.9807 125.9627

1.7172 127.6799

TP30 1.2125 126.4674 122.8278

BA6

29

3-2-01

LT. SNOW, CALM, 30°

PC  
CM  
KK

#113 SPIKE IN COTTONWOOD - 50 CM  
WEST SIDE HWY

NOTE: SEE P 65 FOR  
TIE TO NGS Q105  
FROM TP30

#116

#117 SET SPIKE w/PUZZY @ EP 5M W. OF E  
APPROX 14M S. OF SHELLOW LAKE  
SIGN

BM 8  
BM 9

TALKEETNA

+ HI - ELEV NAVD '29  
ADJ.

TP 30 126.4674 122.8278

2.3336 128.8010

R 118 0.5609 128.2401

2.5820 130.8221

119. 0.7012 130.1209

2.2160 132.3369

<sup>120</sup>  
TP 31 0.9384 127.7589

BK 6

30

3-2-01

1115

SAME  
CREW

PC

CM

KK

BM 2001-9

131.3985

BM8  
BM9

TALKEETNA

+ H1 - ELEV NAVD '29  
ADJ

TP 31

127.7589

0.7382 132.1367

121.

2.6737 129.463

0.2414 129.7044

122.

2.3020 127.4024

0.9920 128.3944

7

123

TP 30

1.9269 126.4675 122.8278

0.9576 127.4251

124.

1.9627 125.462

0.8649 126.3273

125.

2.1289 124.1984

3.02.01

BK 4

31

SAME CREW

subwy

BM 2001-9

SPRINKLER CHASER @ EP 5M W. OF E  
PG 30 (126.4674)

BM8

TALKEETNA

BM9

	+	HI	-	ELEV	NAVD '29
					ADJ.

125

124.1984

0.9512 125.1496

126

1.9745 123.1757

1.1821 124.3572

TP27

1.4318 122.9254 119.2834

0.5641 123.4875

TP28

2.2156 121.2739 117.632

1.1169 122.3908

129

1.8309 120.5599

1.5738 122.1337

130

1.1343 120.9994

BK6

32

3.02.01

SAME CREW

PK

CM

KK

TP 29 SPIKE 50CM COTTONWOOD W. SIDE  
 HWY 1939 (122.9257)

MAG NAIL & CHASER @ AIRSTRIP AVE  
 PG 28 (121.2743)

BM8  
BM9

TALKEETNA

+ HI - ELEV NAVD '29  
ADJ

130

120.9994

1.7558 122.7552

132  
TP 27

0.9965 121.7587 118.1174

2.4094 124.1681

133

0.5438 123.6243

3.3681 126.9932

134  
TP 26

0.6697 126.3235 122.6805

3.2432 129.5667

135

0.5599 129.0068

3.3758 132.3806

136

0.4671 131.9135

3.02.01

BK6

33

SAME CREW

PC

CM

KK

128.7552

SIDE SHOT

- 1.6406

00-04-57A

(131)

121.109 PK

EAST EL @ CULVERT X-ING

TP 27 PG 28 SPIKE & CHASER (121.7603)

"PK" & CHASE @ WALSTEAD RD  
PG 27 (126.3217)

BM8  
↑ BM9

TALKEETNA

END LOOP

+ HI - ELEV NAVD '29  
ADJ

136

131.9135

2.6519 134.5654

TP 24<sup>137</sup>

0.7715 133.7939 130.148

1.6909 135.4848

TP 23<sup>138</sup>

1.3105 134.1743 130.5273

3P

3.02.01

BK6

34

SAME CREW

PC

CM

HK

TP 24 USC & GS E106

Pg 27 (133.7898)

TP 23 BM 2001-8

Pg. 27 (134.1694)

EC = 0.0049



BM9

BM10

TALKEETNA

BEGIN LOOP

+

HI

-

ELEV NAVD '29

ADJ.

TP 31

127.7589

1.5333

132.9318

R

139

0.5236

132.9082

3.0532

135.4614

R 140

1.0750

134.3864

2.3560

136.7424

TP 32

1.6669

135.0755 131.4371

2.2277

137.3632

R 142

1.5407

135.7625

1.9451

137.7076

TP<sup>33</sup> TBM

1.0795

136.6281

132.9885

3.02.01

BK 6

35

CLOUDY, CALM, 31°

SAME CREW

BM 2001-9 pg 30

131.3985

# 141 SET MAGNAIL w/CHASER  
1.3m OUTSIDE FOG LINE  
W. SIDE OF ROAD

TBM-TP3  
# 43 SPIKE IN TREE  
45cm BIRCH



BM 9  
BM 10

TALKEETNA

	+	HI	-	ELEV	NAVD '29 ADJ.
TBM-TP33				136.6281	132.9885
	1.2690	137.8971			
R 144			1.5585	136.3386	
	1.4942	137.8328			
TP 34			1.6924	136.1404	132.5006
	1.4286	137.5690			
R-146			1.6224	135.9466	
	0.9529	136.8995			
R-147			1.6904	135.2091	
	1.0422	136.2513			
R148			1.2693	134.9820	

BK6

36

3-2-01

CLOUDY, CALM, 30°

PC  
CM  
KK

45cm BIRCH

OVER WROTE TWICE  
LAST IS GOOD

"PK" PC  
#145. SET SPHERE 5.4 m EAST FROM  
JUBILEE/STOP SIGN  
19 m N. OF MAILBOXES  
8 m S. OF JUBILEE ST

BM 9  
BM 10

TALKEETNA

+ HI - ELEV NAVD '29  
ADJ.

R 148

134.9820

1.7126 136.6946

TP35

1.0391 135.8555 132.0173

2.0107 137.6662

R 150

0.7731 136.8931

1.6516 138.5447

TP36

~~1.2004~~ 137.3443 132.260  
1.6455 136.8992

1.2004 138.0996

TBM TP37

1.1175 136.9821 133.342

0.4700 137.4521

R 153

1.7561 135.6960

BK 6

37

3-02-01

CLOUDY, CALM, 30°

PC  
CM  
KK

#149 SET PK w/FUZZY  
1.3 m W. FOGLINE

#151 SET SPIKE 1.3 m W. FOGLINE

#152 SET SPIKE IN BIRCH - 34cm  
W. SIDE HWY

1.174

BM 9  
BM 10

TALKEETNA

+

HI

-

ELEV

NAVD 29  
ADJ.

R 153

135.6960

1.0678 136.7638

TP 38

1.8594 134.9044 131.2644

1.1445 136.0489

R 155

1.7121 134.3368

1.1468 135.4836

TP 39

2.1276 133.3560  
129.7153

2.2122 135.5682

157

1.1484 134.4198

1.5795 133.9993

158

TP 38

1.0916 134.9077

END OF DAY

BK 6

38

3-2-01

CLOUDY, CALM, 29°

PC  
CM  
KK

# 153

# 154 SET SPIKE w/FOLEY 1.3m W. POG LINE  
ACROSS FROM BLUE HOUSE ON FLATS  
IN LINE w/N. FACE OF

TP 39 BM 2001-10

Palindromic CM

SPIKE @ 1.3 WEST OF W/L

BM 9  
(BM 10)

TALKRETN A  
BEGIN RETURN LOOP - AGAIN!

+ HI - ELEV NAVD '29  
ADJ.

1 TP 39<sup>156</sup> 133.3560 129.7153

2.2263 135.5823

R<sup>159</sup> 0.9916 134.5907

1.5678 136.1585

TP 38<sup>160</sup> 1.2548 134.9037 131.2644

1.8952 136.7989

161 0.9991 135.7998

1.8508 137.6506

TP 37<sup>162</sup> 0.6695 136.9811 133.342

1.0750 138.0561

TP 36<sup>163</sup> 1.1560 136.9001 132.260

BK 6

39

3.03.01

BM 2001-10

RUC 

CM T

KK Ø

SUNNY. 0°F ±

BEAUTIFUL!

SPIKE IN BIRCH

PG 37

SPike @ 1.3 w. w/c

BM9  
BM10

TALKEETNA

+ HI - ELEV NAVD '29  
ADJ.

TP 34<sup>163</sup>

136.9001 132.260

1.6683 138.5684

164

1.6169 136.9515

0.8946 137.8461

TP 35<sup>165</sup>

2.1877 135.6584 132.0173

0.9539 136.6123

166

1.7626 134.8497

1.6114 136.4611

167

1.0477 135.4134

1.7261 137.1395

168

1.0850 136.0545

3.03.01

BK 6

40

SAME CREW

P. CHURCH

SPIKE @ EP 1.3 WEST OF W/L C. MULLIKIN

K. KLEINE

"PK" & CHASER 1.3 WEST OF W/L

FG 37 (135.6555)

BM9 BM10	TALKEETNA RETURN LOOP	HI	-	ELEV	NAVD '29 ADJ.
168				136.0545	
1.6091	137.6636				
TP 34 <sup>169</sup>		1.5235	136.1401	132.5006	
1.6183	137.7584				
170		1.8004	135.9580		
1.0875	137.0455				
TP 32 <sup>171</sup>		1.7702	135.2753		
1.4448	136.7201				
TP 32 <sup>172</sup>		1.6421	135.0780	131.4371	
1.1997	136.2777				
173		1.8422	134.4355		

3.03.01

BK6

41

SAME CREW

P.C.

KX

CM

"DK" @

P936 (136.1404)

(P935 (135.0755))

MAG NAIL & CHASER 1.3 WEST OF W/L

BM9  
BM10

TALKEETNA  
RETURN LOOP

+ HI - ELEV NAVD '29  
ADJ.

173

134.4355

1.0407 135.4162

174

2.8194 132.6568

0.6618 133.3186

TP 31<sup>175</sup>

1.9223 131.3963 127.7589

3.03.01

BK6

42

SAME CREW

RCLOV

BM2001-9

PG 35 (131.3985)

DIFF = 0.0022 M.m



BM 10 TALKEETNA  
 BM 11 BEGIN LOOP  
 + H1 - ELEV NAVD '29  
 ADJ.

TP 39<sup>116</sup>  
 1.6321 134.9881  
 129.7153

R-176  
 1.9874 133.0097  
 1.9784

1.0430 134.0527

R 177  
 1.7804 132.2723

1.1974 133.4697

TP 40  
 1.6641 131.8056 128.1626

1.4598 133.2654

TBM-TP 41  
 1.4321 131.8333 128.189

1.3206 133.1539

R 180  
 1.7322 131.4217

3.03.01

BK 6

43

MOSTLY SUNNY, LT BREEZE, 15° SAME CREW

P. CHURCH

TP 39 BM 2001-10

K. KLEINE

pg 38 133.3360

C. MULLIKIN

#176 SET PK W/FUZZY

8.6 m S. OF MAILBOXES @ SUNSHINE ST  
 W. SIDE OF RD. 1.8 W. FOG LINE

#179 SET SPIKE IN 35 cm BIRCH

W/FOR SALE SIGN

NEARLY ACROSS FROM MP 2<sup>POST</sup>

W. SIDE

BM 10

PM 11

TALKEETNA

+

HI

-

ELEV NAVD '29

ADJ

R 180

131.4217

0.7645 132.1862

TP 42

23010

129.8852

126.2457

0.9926 130.8778

R 182

1.8572

129.0206

1.4277 130.4483

R 183

1.5043

128.9440

1.3265 130.2705

TP 43

GPS

CONT.

1.6076

128.6629

125.0258

1.6134 130.2763

R 185

1.6113

128.6650

3-3-01

BK6

44

PARTLY CLOUDY, CALM, 18°

PC

CM

KK

#181 SET PK W/FUZZY 1.6 W. FOGLINE  
136 M S. OF PARTLY OVERGROWN RD.

#184 END 19mm REBAR - GPS CONTROL  
2.8 W. FOGLINE WEST SIDE Hwy

BM 10  
BM 11

TALKEETNA

+ HI - ELEV NAVD'29  
ADJ.

R 185

128.6650

1.2682 129.9332

TBM TP 44

1.2812 128.6520 125.0135

1.0732 129.7262

R 187

1.8013 127.9239

1.1231 129.6470

R 188

1.7990 127.2480

1.2007 128.4487

TP 45

1.8077 126.6410 123.004

1.2385 127.8795

R 190

1.7644 126.1151

BK6

45

3-3-01

PARTLY CLOUDY, LT BREEZE, 19°

PC

CM

KK

50CM

#186 SET SPIKE IN LASE TWIN BIRCH

N. OF ENTRY TO  
PARTLY PLOWED DRIVE

40CM  
A PIRE

WEST SIDE HWY

#189 SET PK 2.3 M E. FOG LINE

E. SIDE RD

N. SIDE OF MAC +

SALLY  
DRUNK

2.3  
E. White Line

2.3

BM10

BM11

TALKEETNA

+

HI

-

ELEV

NAVD '29

ADJ.

190

126.1151

191

1.1275 127.2426

192

1.6790 125.5636 ✓

1.2898 126.8534

1.2111

TP 46

1.3211 125.5323 121.8979

1.2111

0.7659 126.2982

193

1.5479 124.7503

1.2550 126.0053

TP 47

194

1.7751 124.2302 120.5954

1.3427 125.5729

TP 48

195

2.8985 122.6744 119.0376

3.03.01

BK6

46

SAME CREW

PC

CM

KK

NOTE: ERROR IN TDS DATA COLLECTOR  
RAW DATA FILE ~ FAKED TO CARRY OVER  
ELEV @ 191 TO 192

TBM- TP 46 SET SPIKE IN 30cm BIRCH  
WEST SIDE HWY

TP 47 16mm REBAR @ 2.1 EAST OF W/L  
NE OF SHADE TREE LN GOING WEST

TP 48 BM 2001-11

BM 10  
BM 11

# TALKEETNA RETURN LOOP

+ HI - ELEV NAVD '29

ADJ.

TP 48<sup>195</sup>

119.0376

2.9550 125.6294

196.

0.8532 124.7762

1.7779 126.5541

TP 46<sup>197</sup>

1.0188 125.5353 121.8979

4.2082 126.7435

198

1.0828 125.6607

1.6710 127.3317

199

1.0852 126.2465

1.6275 127.8740

200

1.1527 126.7213

3.03.01

BK 6

47

SAME CREW

P. GUDY. COOL

TP 48 BM 2001-11

TP 46 ~ TBM SPIKE IN 30CM BIRCH

P 9 46 125.5323

BM 10  
BM 11

TALKEETNA  
RETURN LOOP

+ HI - ELEV NAVD '29  
ADJ.

200

126.7213

1.4192 128.1405

TP 45<sup>201</sup>

1.4946 126.6459 123.004

1.8151 128.4610

203

1.1715 127.2395

1.7277 129.0172

205

1.0997 127.9175

1.7812 129.6987

TP 44<sup>204</sup>

1.0432 128.6555 125.0135

1.1601 129.8156

205

1.0739 128.7417

3.03.01

BK 6

48

SAME CREW

PC

CM

KK

"PK" @ NE Cor App. MAC & SALLY DEWY  
Pg 45 (126.6410)

SPIKE IN 50 CM TWIN BIRCH  
Pg 45 (128.6520)

BM 10  
BM 11

# TALKEETNA

	+	HI	-	ELEV	NAVD '29	ADJ.
--	---	----	---	------	----------	------

206

128.7417

1.4590 130.2007

TP 43<sup>206</sup>

1.5398 128.6669 125.0258

1.6051 130.2720

207

1.2726 128.9994

1.4241 130.4235

208

1.1340 129.2895

1.7814 131.0709

TP 42<sup>209</sup>

1.1796 129.8913 126.2457

2.2396 132.1309

210

0.8899 131.2410

3.03.01

BK6

49

SAME CREW

PC

KK

CM

TP 43 GPS C.P. 16 mm REBAR W. SIDE Hwy  
Pg 44 (128.6629)

TP 42 "PK" & CHASER 1.6 W. OF W/L  
Pg 44 (129.8852)



BM 10  
BM 11

# TALKEETNA

+ HI - ELEV NAVD '29  
ADJ

210

131.2410

1.6349 132.8759

211

1.1485 131.7274

1.3276 133.0550

TP 41 212

1.2158 131.8392 128.1890

1.3980 133.2372

TP 40 213

1.4247 131.8125 128.1626

1.7050 133.5175

214

1.1730 132.3445

1.6886 134.0331

215

1.0111 133.0220

3.03.01

BK6

50

11 SAME CREW

PC

CM

KK

TP 41 SPIKE IN 35CM BIRCH (FOR SALE)  
Pg 43 (131.9333)

TP 40 PK & CHASER @ SUNSHINE  
Pg 43 (131.8056)

BM 10  
BM 11

TALKEETNA  
CLOSE LOOP

+ HI - ELEV NAVD '29  
ADJ.

215

133.0220

1.6206 134.6426

216

1.0326 133.610

1.4741 135.0841

TP 49<sup>217</sup>

1.4581 133.6260

1.3933 135.0193

TP 39<sup>218</sup>

1.6561

129.7153

END OF DAY!

3.03.01

BK6

57

SAME CREW

PC

CM

KK

TP 49 GPS CONT. PT 16mm REBAR 22 M W.O.F  
PG 43 (133.3560) TP 39 1.6 W.O.F W/L

TP 39 TBM 2001-10

133.3632 THIS  
LEG

133.3560

$\Delta = 0.0072 \text{ M} \dots$

BM11

BM12

TACKEETNA

BEGIN LOOP

+

HI

-

ELEV NAVD' 29

ADJ

TP48

109.0376

2.4797 125.1541

R219

2.5014 122.6527

0.4583 123.1110

TP50

2.3552 120.7558 117.1196

0.7595 121.5153

221.

3.0400 118.4753

0.4107

118.8860

TP51

3.1775 115.7085 112.0759

1.3473 117.0558

222.

1.3963 115.659

3.0401

BK6

52

CLEAR, CALM, 20°

PIC CM 

TP48 BM 2001-11

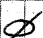
KK 

PG 46 (122.6744)

CLEAR 20°F

BEAUTIFUL!

120.256

TP 51 SET "PK &amp; CHASER" EAST SIDE Hwy

3.1809 114 E. OF ER W/L BEGIN APP

IN LINE W/ BLUE GREY T1-11 HOUSE - N. SIDE  
SOUTH OF SHADE TREE

BM11  
BM12

TALKEETNA

+ H1 - ELEV NAVD'29

223

115.6590

2.0227 117.6822

224

1.3376 116.3446

2.0054 118.350

225

1.5320 116.8180

1.7680 118.5860

226

1.9442 116.6418

1.7229 118.3647

TP52<sup>227</sup>

1.7378 116.6269 112.9908

1.0091 117.636

TP53<sup>228</sup>

1.3192 116.3168 112.6807

3.04.01

BK6

53

SAME CREW

PC

CM

KK

SET 16mm REBAR E.S. Hwy 7.5 E. OF &  
EAST OF SOUTH APP NORTHERN EXPOSURE  
@ NICHOLS ST. // GPS C.P. NORTH  
SIDE DRIVEWAY APP.

TP53 SET SPIKE IN 20cm BIRCH W. SIDE Hwy  
SW OF TP52. 25m S. OF S. APP N. EXP.

BM11

BM12

TALKEETNA

+

HI

-

ELEV NAVD'29

ADJ.

tp 53

116.3168 112.6807

1.3949 117.7117

229.

1.1048 116.6069

1.6794 118.2863

230

1.0004 117.2859

1.7316 119.0175

TP54<sup>231</sup>

1.0378 117.9797 114.3447

1.2318 119.215

233

1.2457 117.9658

0.8020 118.7678

234

1.3145 117.4533

3.04.01

BK6

54

SAME CREW

TP58 SET SPIKE IN 20CM BIRCH W. SIDE  
 HWY 25M SO. OF SOUTH APPROACH  
 "NORTHERN EXPOSURE"

TP54 SET 16mm REBAR • 2.1 E. of W/L  
 EAST OF "MOORE'S MERCANTILE" HARDWARE  
 APPROACH

BM11  
BM12

TALKEETNA

+ HI — ELEV NAVD'29

ADJ.

234

117.4533

1.3131 118.7664

TP55<sup>235</sup>

1.8154 116.9510 113.3139

1.2477 118.1987

TP56<sup>236</sup>

2.8310 115.3677 111.7332

1.6945 117.0622

3.04.01

BK6

55

SAME CREW

PC

CM

KK

SET 16mm REBAR ~ 0.2 DEEP RP 1.7 WEST OF  
7M E. OF Q SPUR HWY [TALKEETNA 14] WX SIGN  
"WEATHER INFO TUNE RADIO TO 89.5FM"

TP 56 BM 2001-12

BM11  
BM12

# TALKEETNA RETURN LOOP - BEGIN

+ HI - ELEV NAVD'29  
ADJ.

TP56

111.7332

1.6945 117.0622

<sup>237</sup>  
TP57

1.2510 115.8112

2.4991 118.3103

<sup>238</sup>  
TP55

1.3614 116.9489 113.3139

1.6739 118.6228

<sup>239</sup>

0.7670 117.8558

1.6480 119.5038

<sup>240</sup>

1.3386 118.1652

1.4415 119.6067

<sup>241</sup>  
TP54

1.6248 117.9819 114.3441

3.04.01

BK6

56

SAME CREW

PC

CM

KK

TP56 BM2001-12

TP57 SET 19mm DRIVE ROD GPS 0.3 ABN GRO  
25M EAST OF E SPUR E 15M WEST OF  
Talkeetna Alaska ~ Park Info CABIN + ANTENNA  
ROD

PG55 (116.9510)

TP54 FND 16mm REBAR

PG54 (117.9797)

TP54



BM11  
(BM12)

TALKEETNA  
RETURN LOOP

+ H1 - ELEV NAVD '29

ADJ

<sup>241</sup>  
TP 54 117.9819 114.3447

1.1546 119.1365

<sup>242</sup> 1.9404 117.1961

1.4237 118.6198

<sup>243</sup> 1.9944 116.6254

1.6245 118.2499

<sup>244</sup>  
TP 52 1.6198 116.6301 112.9908

2.0180 118.6481

<sup>245</sup> 1.8672 116.7809

1.6130 118.3939

<sup>246</sup> 1.6765 116.7174

3.04.01

BK6

57

SAME CREW

TP 54 END 16mm REBAR 2.1 EAST OF ER W/L  
EAST OF MOORE'S MERCANTILE

TP 52 16mm REBAR 7.5 EAST & EAST OF  
PG 53 (116.6269) NORTHERN EXPOSURE

BM11  
BM12

TALKEETNA  
RETURN LEG

+ HI - ELEV NAYD '29  
ADJ.

246

116.7174

1.1636 117.8810

247

1.7967 116.0843

1.3115 117.3958

248

1.8899 115.5059

1.5422 117.0481

TP51<sup>249</sup>

1.3279 115.700 112.0759

RE-RUN NEXT PAGE

250

251

3.04.01

BK6

58

SAME CREW

PC

CM

KK

TP51 "PK & CHASER

Pg 52 (115.7085) ERROR - 11mm - 12mm

BM11  
BM12

TALKEETNA  
RE-RUN PORTION

	+	HI	—	ELEV	NAVD '29 ADJ.
TP 52				116.6301	112.9908
	1.4620	118.0921			
250			0.9517	117.1404	
	1.1262	118.2666			
251			1.4099	116.8567	
	1.0100	117.8667			
252			1.6863	116.1804	
	1.0551	117.2355			
253			1.6737	115.5618	
	1.3135	116.8753			
TP 51 254			1.1595	115.7158	112.0759

3.04.01

BK6

59

SAME CREW

TP 52 pg 51 16mm REBOR 7.5 EAST of E  
EAST of <sup>SOUTH</sup> APP @ NORTHERN EXPOSURE

TP 51 "PK & CHASER" 1.4 E. of E WEST OF  
pg 52 (115.7085) N. SIDE BLU-GREY HOUSE

BM11  
BM12

TALKEETNA  
RE-RUN PORTION ✓

+

H1

—

ELEV NAVD '29  
ADJ.

TP51<sup>254</sup>

115.7158 112.0759

2.5147 118.2305

255

0.3476 117.8889

2.4717 120.3546

256

0.8497 119.5049

2.1817 121.6866

TP50<sup>257</sup>

0.9194 120.7672 117.1196

2.3624 123.1296

258

0.1738 122.9558

2.1275 125.0833

TP48<sup>259</sup>

2.4001 109.0376

3.04.01

BA6

60

SAME CREW

TP51 "PK & CHASER" 1.4 EAST OF ER W/L  
BEGIN APP. & WEST OF N. SIDE BLU. GREY HOUSE

TP50 FND "PK & CHASER" 1.5 EAST OF ER W/L  
PG 52 (120.7558) NORTH SIDE MICHELE DR.

$\Delta = 0.0088$  M

TP48 BM2001-11

pg 52 (122.6744)

122.6832 <sup>THIS</sup> Leg

L105

BM12

Tolkeetna  
Begin Leg

+

H1

-

ELEV NAVD '29  
ADJ.TP58<sup>260</sup>

108.7680

1.1215 113.5645

261.

0.2898 113.2747

1.9768 115.2515

262.

0.4881 114.7634

1.5614 116.3248

TP59<sup>263</sup>

0.9290 115.3958 111.721

1.4800 116.8758

264

0.8960 115.9778

1.0718 117.0516

TP56<sup>265</sup>1.6424 115.4092  
111.7332

3.0401

BK6

61

PC

SAME CREW

CM

KK

TP 58 BRASS DISC IN S. WEST TRIPLE  
BIRCH @ WEST OF MONTANA CREEK  
BAPTIST CHURCH 112.443 NAVD 29  
NGS "L 105"TP 59 "PK" 1.0 EAST OF W/L  
≈ 200M No. of BAPTIST CHURCH

18M SOUTH OF BLUE SIGN W/LON

Phone  
995  
trailer  
foodTP 56 BM 2001-12 0.042 mm LOWER < NGS  
pg 55 (115.3671) 115.4092 This Leg

L105  
BM12

Talkeetna  
Return Leg

+ HI - ELEV NAVD '29  
ADJ

TP 56

115.4092 111.7332

1.6215 117.0307

266

1.0576 115.9731

0.9648 116.9379

TP 59<sup>267</sup>

1.5398 115.3981 111.721

0.8136 116.2117

268

1.4222 114.7895

0.4951 115.2846

269

2.0376 113.2470

0.3928 113.6398

TP 58<sup>270</sup>

1.1948 112.4450 111.7372  
.7680

3.04.01

BK6

62

SAME CREW

BM 2001-12

this Leg = 115.4092

TP 59 "PK" 1.0 EAST OF ER W/L  
P961 (115.3958) 18M SOUTH OF BLUE SIGN  
w/ICONS Phone, gas, Trailer, food!

TP 58 BRASS DISC

P961 (112.443) NGS L 105"

112.4450<sup>this</sup> Leg

L 105

TP 60

Tolkeetna

Begin Loop TO P.I.D.

+

H1

-

ELEV NAVD 29

ADJ

TP 58

112.443 108.7680

1.2230 113.666

271

1.4045 112.2615

1.0584 113.3199

272

2.2514 111.0685

0.5993 111.6678

273

1.1860 110.4818

1.5116 111.9934

TP 60<sup>274</sup>

1.3792 110.6142 106.9387

1.0251 111.6393

275

0.9202 110.7191

BK 6

63

3.04.01

SAME CREW

MONTANA CREEK

BRASS DISC WEST OF BAPTIST CHURCH

EL 112.443 NAVD 29 NGS "L 105"

TP 60 FND "PK" IN SAW CUT OF CONCRETE @  
 SE COR BLDG SUSITNA VALLEY H.S.  
 1.6 E. OF LT POLE "PHOTO I.D. POINT"  
 WESTERLY OF MONTANA CREEK  
 BAPTIST CHURCH 250M±



L105  
 (Tp60 Tolkeetna  
 Return Leg  
 + HI — ELEV NAVD '29  
 ADJ.

275 110.7191

2.1049 112.8240

276 0.7928 112.0312

1.7442 113.7754

277 0.5041 113.2713

0.3704 113.6417

TP58 278 1.1996 112.4421 108.7680

3-04-01

BK6

64

SAME CREW

PC

CM

KK

TP 58 BRASS DISC NGS L105  
 112.443

105  
TP30

NGS Q105  
TIE TO TP30

+ H1 - ELEV NAVD '29  
ADJ

TP61<sup>279</sup>

126.138 122.4804

1.5896 127.7276

TP30<sup>286</sup>

1.2423 126.4853 122.8278

1.1800 127.6653

TP61

1.5275 126.1378 122.4804

END OF DAY

3.04.01

BK6

65

SAME CREW

126.138 NAVD 29

FND BRASS DISC NGS Q 105 1965

VSCG'S  
15M NORTH OF SHERDON LN 1.2 NW  
FROM METAL WIT POST OL

TP 30 FND SPIKE & CHASER @ EP.

P9 29 (126.4674)

BRASS DISC NGS Q 105 1965

0.017mm LOWER THAN  
NGS

BM12

W105

Takeetna

BEGIN LOOP "NORTH"

+

H1

-

ELEV NAVD'29

ADJ

TP56<sup>265</sup>

115.4092 111.7332

2.0517

800

0.7323 116.7886

1.2476 117.9762

801

2.2117 115.7645

1.2932 117.0577

802

1.7448 115.3129

1.8260 117.1389

TP62<sup>803</sup>

0.4626 116.6763 113.0029

1.1768 117.8531

804

0.5079 117.3452

3.0501

BK6

C66

BM 2001-12

115.4092 SEE pg 61

PUL  
CM T

K.K. P

+28°F Forecast  
BREEZE

47 M STRUGGLES

SPIKE

40 M

45 M

45 M

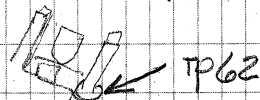
TP62 EAST SIDE OF TESORO SIGN ~ SUPPORT  
BASE

  
STEEL BASE

BM 12 ) Talkeetna  
W 105 ) "NORTH LEG"

+ HI — ELEV

804

117.3452

1.6104 118.9556

805

1.4269 117.5287

1.2990 118.8277

806

1.9413 116.8864

0.4828 117.3692

807

1.8914 115.4778

0.4205 115.8983

808

2.9200 112.9783

0.3337 113.3120

809

3.1838 110.1282

BK 6

67

3.0501

SAME CREW

PC

CM

KK

49

57

50

E. SIDE

40M

BM12  
W105

Talkeetna  
"NORTH LEG"

+ H1 - ELEV NAVD '29  
ADJ.

809

110.1282

0.2349 110.3631

810

2.7529 107.6102

1.4692 109.0794

811

0.8202 108.2592

1.0771 109.3363

TP63<sup>812</sup>

1.1576 108.1787 104.5035

1.1901 109.3688

813  
811

1.1096 108.2592

0.8475 109.1067

814  
810

1.4944 107.6123

3.05.01

BK6

68

SAME CREW

PC

CM

KK

41M

40M

106.346  
+ 1.830  
108.176 NAVD 29

+ 3mm

TP63 FND CROSS DISC<sup>20CM</sup> ORANGE-BERG

W105 20 M S. OF PARKS Hwy

2 M. N. OF EDGE "DROP OFF" 0.6 MILE  
NORTH OF TALKEETNA Spur

BM12  
W105

Talkeetna  
RETURN LEG "SOUTH"

+ HI - ELEV

814  
810

107.6123

2.7231 110.3354

815  
809

0.2036 110.1318

3.2928 113.4246

816  
808

0.4424 112.9822

2.9655 115.9477

817  
807

0.4662 115.4815

2.0712 117.5527

818  
806

0.6623 116.8904

2.1241 119.0145

819  
805

1.4811 117.5334

3.0501

BK6

69

SAME CREW

PC

CM

KK

49M

110.1282

0.668

112.9783 + 4

115.4778 + 5

116.8864 + 3

117.5287 + 4

BM12  
W105

Talkeetna  
RETURN LEG "SOUTH"

+ HI — ELEV NAVD '29  
ADJ.

819  
805

117.5334

1.5111 119.0445

820  
804

1.6946 117.3499

0.6039 117.9538

TP62 821  
803

1.2724 116.6814 113.0029

0.2907 116.9721

822  
802

1.6550 115.3171

1.7521 117.0692

823  
801

1.3006 115.7686

2.1413 117.9099

824  
800

1.1779 116.732

3.05.01

BK6

70

SAME CREW

PC

CM

KK

117.3452 +5

116.6763 +5 EAST SIDE TOP ROUND STEEL PIPE  
@ TEDRO ALASKA SIGN POST WEST OF  
PUMP BLOCK

115.3129 +4

115.7645 +3

116.7286 +3



BM12  
W 105

Talkeetna  
END RETURN LEG "SOUTH"

+ HI — ELEV

824

116.732

0.7646 117.4966

TP56<sup>832</sup>

2.0858 115.4108 111.7332

Photo I.D. @ TESORO ALASKA

TP62<sup>803</sup>

116.6763 113.0029

1.1675 117.8438

TP64<sup>824</sup>

1.5919 116.2519 112.5785

1.5443 117.7962

TP62<sup>827</sup>

1.1199 116.6763 113.0029

3.05.01

BK6

71

SAME CREW

PC  
CM  
KK

BM 2001-12

115.4092

TP62 TOP ROUND SIGN BASE EAST SIDE  
PG66 TESORO ALASKA SIGN WEST  
OF PUMP BLOCK 10 & 12

TP64 Photo I.D. POINT - "PK" @ SW COR  
CONC. PUMP BLOCK PAD - #10

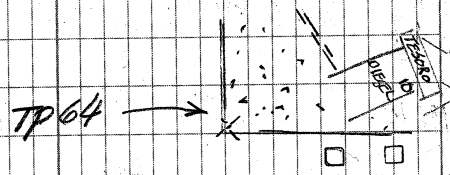

BM7

Tolkeetna

TP 25 (GPS II)

+

HI

—

ELEV NAVD '29

ADJ

TP 17

102.4286

1.9602 108.0313

828

0.6929 107.3384

2.1413 109.4797

829

0.6256 108.8541

2.0860 110.9401

830

0.6413 110.2988

1.9605 112.2593

831

0.8964 111.3629

1.8207 113.1836

TP 18

1.2444 111.9392 108.2974

3-05-01

BK6

72

SAME CREW

P. CHURCH

C. MULLIKIN

K. KLEINE

BM 2001-7

TP 18 106.0711

28M

TP 19 107.9395

TP 17 106.0711

This day

 $\Delta = 1.8684$ 

50M

52M

59M

35

31

TP 18 SPIKE @ 1.3 EAST OF ER w/L

TP 18 111.9398

BM 7

GPS (11)

Ta/Keetna

	+	HI	-	ELEV	NAVD '29
					ADJ
TP 18				111.9392	108.2974
	1.4438	113.383			
				1.8274	111.5556
	0.6042	112.1598			
				2.8654	109.2944
	0.0922	109.3866			
				2.4015	106.9851
	0.9290	107.9141			
SPK 65				1.1813	106.7328 103.0897
	1.9046	108.6374			
TP 19				0.6979	107.9395 104.2962

3.05.01

BK 6

73

SAME CREW

SPIKE @ 1.3 EAST OF ER W/C

47M

46M

"PK"

"PK" IN CRACK 15M S. OF ANSWER CR

IN W/C

PG 19 106.7309

END SPIKE &amp; CHASER 1.4

107.9378

BM7

Tp 25

= GPS 11

Tolkeetna  
RE-RUN GPS C.P. LOOP

FROM

Pg 25

+

HI

—

ELEV

NAVD '29

ADJ

834

109.2944

2.6804 111.9748

838

0.1653 111.8095

2.6807 114.4902

Tp 25

(#11)

0.0878 114.453

840

2.6417 111.8096

0.3745 112.1841

841

2.8891 109.295

3.05.01

BK6

74

SAME CREW

PK Pg 73

CATH

TP 25 19mm DRIVE ROD 0.7ABV SNOW!  
 TOP OF CUT BANK @ "WEST" SIDE Hwy  
 SOUTH END KNOLL AND NORTH OF  
 ANSWER CREEK! (#11)