

HORIZONTAL CONTROL POINTS - THIS SHEET

Point	Northing	Easting	Elevation	Description
1	211798.3655	316921.8189		Set Rbr/PC: TS PH-1
2	213132.2893	316570.0644		Set Rbr/PC: TS PH-2
3	214524.8588	316286.5197		Set Rbr/PC: TS PH-3
4	216069.3251	315892.0615		Set Rbr/PC: TS PH-4
5	217711.6178	315512.3687		Set Rbr/PC: TS PH-5
6	219147.8866	315214.5897		Set Rbr/PC: TS PH-6
101	205221.0302	319829.0610		Set Rbr/PC: TS-101
102	206111.1073	319179.2659		Set Rbr/PC: TS-102
103	207675.5750	318268.1720		Set Rbr/PC: TS-103
104	209034.2950	317534.5200		Set Rbr/PC: TS-104
105	209892.6929	317311.6327		Set Rbr/PC: TS-105
500	208449.6508	319017.6054		Fd BC: Sta Z22A
501	206580.8337	320162.6705		Set Steel Rod/BC: Sta Z22A AZ

VERTICAL CONTROL POINTS - THIS SHEET

Point	Northing	Easting	Elevation	Description
701	211226	317110	161.985	USC&GS BM E104
702	213368	316548	162.575	USC&GS BM F104
703	216100	315816	155.508	TBM PH-72.0: RR Spike in 8" Poplar
704	219108	315321	191.376	DOT BM G104 Reset 2002

NOTES:

- 1) Horizontal control points 500-509 were established by AKDOT by using networked static GPS control.
- 2) All intermediate control points (101-105, 1-52) were established by AKDOT using conventional traverse techniques with a Leica TCRA 1101plus Total Station instrument. This traverse was then constrained to the GPS control points using a least squares adjustment.
- 3) All background information shown herein was obtained from Matanuska-Susitna Borough Geographic Information System Mapping, and is for orientation purposes only.
- 4) All dimensions and coordinates shown are in U.S. Survey Feet unless otherwise noted.
- 5) This survey was completed during July-August 2002.

R. 5 W.
R. 4 W.

T. 19&20N., R 4W., S.M. AK



U.S. SURVEY FEET

DWG Path: (Drawing Path)

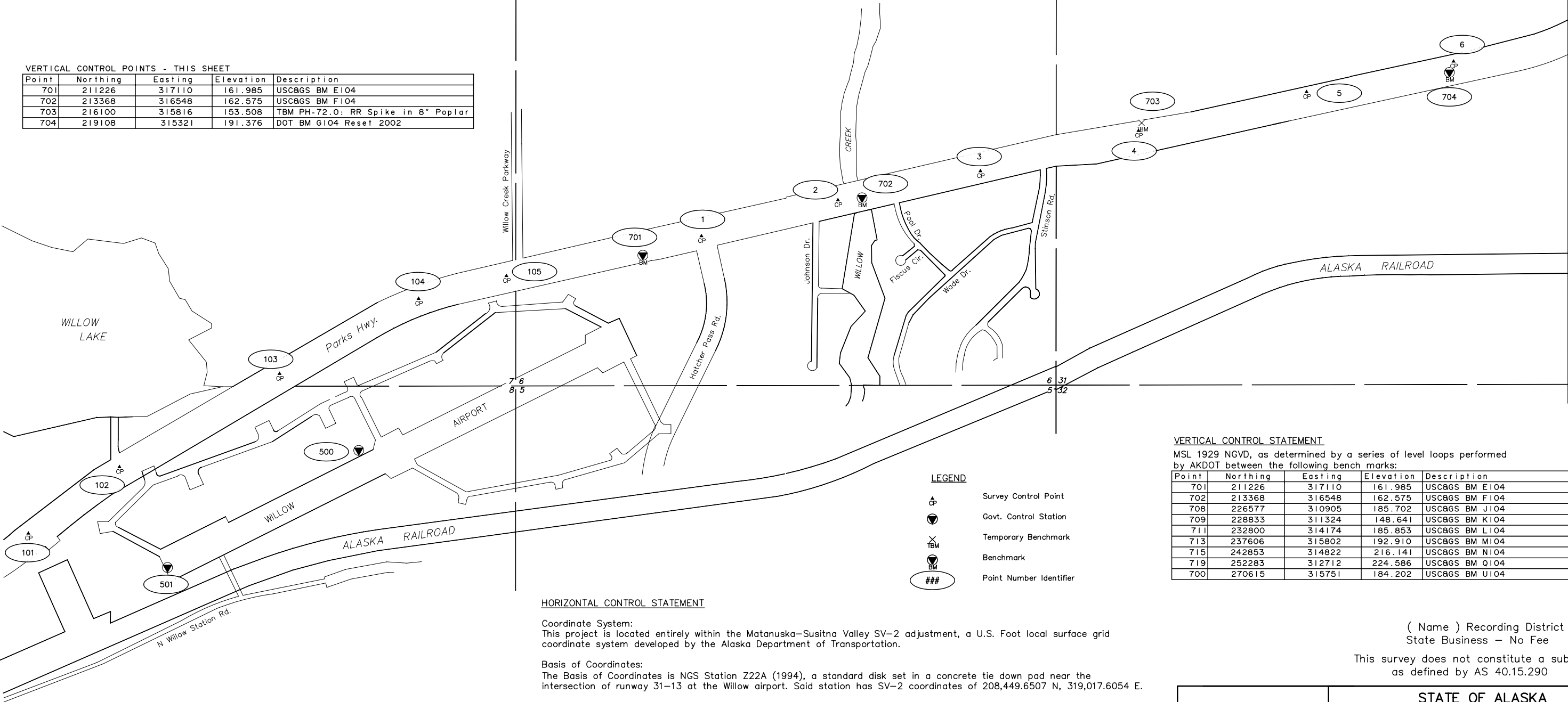

VERTICAL CONTROL STATEMENT

MSL 1929 NGVD, as determined by a series of level loops performed by AKDOT between the following bench marks:

Point	Northing	Easting	Elevation	Description
701	211226	317110	161.985	USC&GS BM E104
702	213368	316548	162.575	USC&GS BM F104
708	226577	310905	185.702	USC&GS BM J104
709	228833	311324	148.641	USC&GS BM K104
711	232800	314174	185.853	USC&GS BM L104
713	237606	315802	192.910	USC&GS BM M104
715	242853	314822	216.141	USC&GS BM N104
719	252283	312712	224.586	USC&GS BM Q104
700	270615	315751	184.202	USC&GS BM U104

LEGEND

- Survey Control Point
- Govt. Control Station
- Temporary Benchmark
- Benchmark
- Point Number Identifier

HORIZONTAL CONTROL STATEMENT

Coordinate System:
This project is located entirely within the Matanuska-Susitna Valley SV-2 adjustment, a U.S. Foot local surface grid coordinate system developed by the Alaska Department of Transportation.

Basis of Coordinates:
The Basis of Coordinates is NGS Station Z22A (1994), a standard disk set in a concrete tie down pad near the intersection of runway 31-13 at the Willow airport. Said station has SV-2 coordinates of 208,449.6507 N, 319,017.6054 E.

Basis of Bearings:
The Basis of Bearings is a local plane bearing between NGS Station Z22A (1994) and AKDOTPF Station GPS U-104 (1965). AKDOTPF Station GPS U-104 (1965), a standard NGS brass disc cemented in the Northeast curb at the Northwest end of the Kashwitna River bridge, bears N 03° 00' 29.5" W a distance of 62,251.48 U.S. Feet from NGS Station Z22A. AKDOTPF Station GPS U-104 (1965) has SV-2 coordinates of 270,615.3475 N, 315,750.7317 E.

Translation Parameters:
To convert the local coordinates to NAD83 (92) State Plane U.S. Foot coordinates, translate using +2,624,987.4039 N, +1,312,507.1407 E, and scale using 0.9998907818.

Surveyor's Certificate

I hereby certify that I am properly Registered and Licensed to practice Land Surveying in the State of Alaska, and that this drawing represents a survey made by me or under my direct supervision, and that the monuments shown hereon actually exist as described, and that all dimensions and other details are correct to the extent shown hereon.

(Surv Name) (Surv Number) (Date)

(Name) Recording District
State Business - No Fee

This survey does not constitute a subdivision
as defined by AS 40.15.290



STATE OF ALASKA
DEPARTMENT OF TRANSPORTATION
&
PUBLIC FACILITIES
Survey Control Diagram
Record Of Survey
(Federal Project No.)
(Project Name)

WITHIN T. 19 N., R. 4W. : T.20N., R. 4&5W. & T. 21N., R. 4W. S.M. AK

DRAWN	RMK	DATE	10/22/2002	SCALE	1"=500'
CHECKED	MHS	DATE	10/30/2002	SHEET	1 OF 5