

DATA SHEET

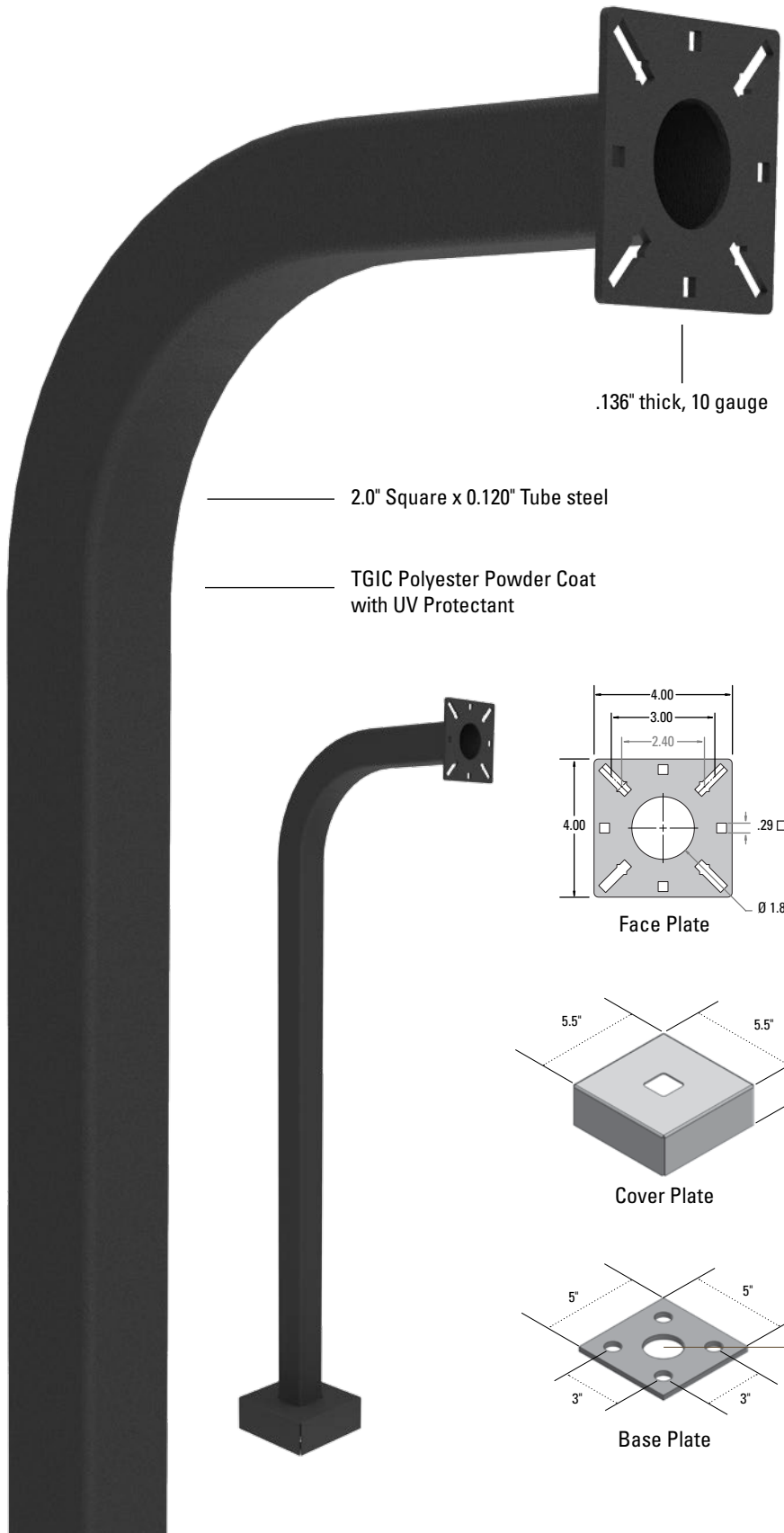

The 42-9C is the most popular pedestal amongst security installers. With thousands of installations around the world it has been widely used by numerous access control professionals who have banked on its universal dimensions to accommodate pedestrians and cars for just about any application.

- ▣ Generally in stock
- ▣ Custom heights and colors available—request a price quote

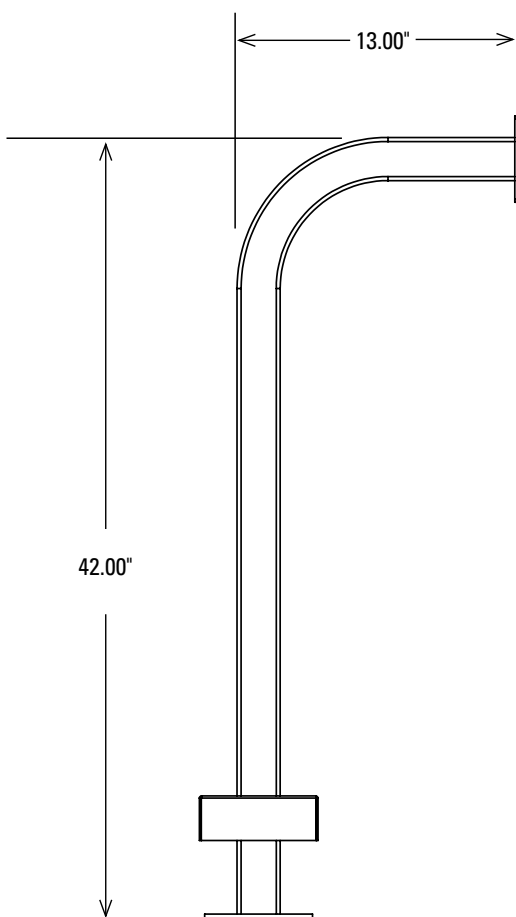

.136" thick, 10 gauge

2.0" Square x 0.120" Tube steel

TGIC Polyester Powder Coat with UV Protectant

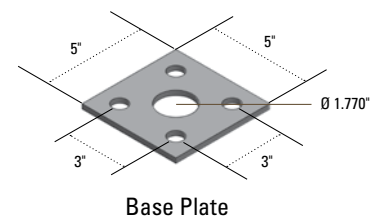
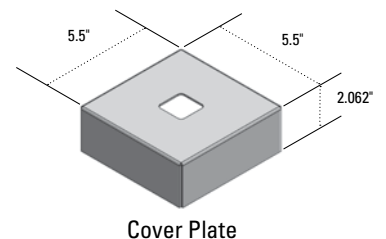
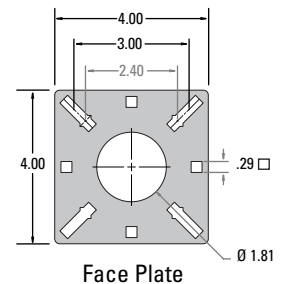

Stress Tests

Wind Speed	157 mph (Category 5 hurricane)
Wind Force	0.54 psi
Maximum Deflection or Displacement	0.04" at top edge
Maximum Stress	12,791.72 psi
Yield Strength	31,994.5 psi (strength at which the material bends permanently)

Interpretation: A "Category 5" hurricane wind begins at 157mph sustained. At this speed, the pedestal will flex slightly, allowing it to move about 0.04" at most. However, the stress encountered is not high enough to cause permanent bending. In the real world, the concrete or mounting bolts and nuts would fail first, not to mention the electronics would blow off even sooner.

Unique Features

Height:	42"
Finish:	Black Wrinkle TGIC Polyester Powdercoat — with UV Protectant
Faceplate:	4" x 4" Universal, .136 CRS (10 Gauge)
Baseplate:	5" x 5" Universal, .25 CRS
Tube:	2" x 2" Square, .120 Wall (11 Gauge)
Neck:	13", 90° Bend
Material:	Heavy Gauge Steel
Box Size:	18 lbs - Box Size: 44 x 12 x 6
Hardware:	Included: Carriage Bolts & Nuts
Color Options	■
Customization Options	Custom heights and cutouts available

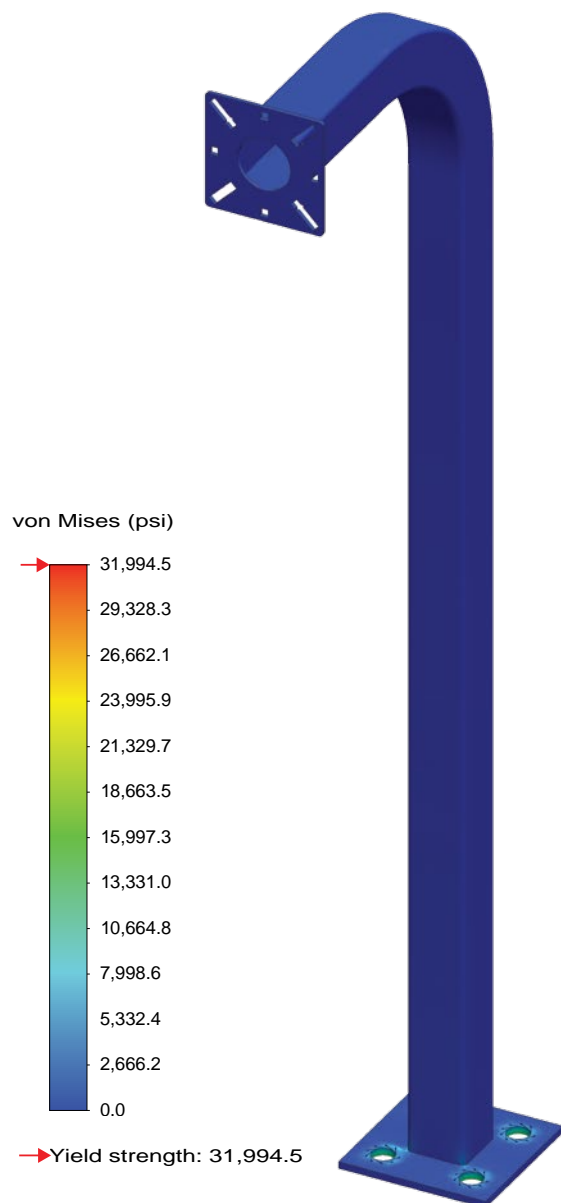

About Us

Pedestal CEO is the largest and most experienced pedestal manufacturer in the U.S. With over 100,000 installations worldwide, our mounting solutions have been designed for, and tested in, virtually every weather climate around the world. We demand the highest quality materials and the best production processes to ensure product strength, longevity, and ultimate customer satisfaction. Visit our website today for a comprehensive list of stock items or request a quote from our world class custom fabrication team.



www.PedestalCEO.com

800-660-3072

Associated Products



MC-CS-8-E
Housing



CS-4.5x6
Hood



PEDESTAL CEO

Pedestal Installation Overview

A Short overview of the various pedestal installations

PEDESTAL CEO

[mm]
in

Installation:

1. Drill hole in dry concrete
2. Insert anchor bolt
3. Place pedestal
4. Place Washers, thread nuts
5. Tighten Nuts

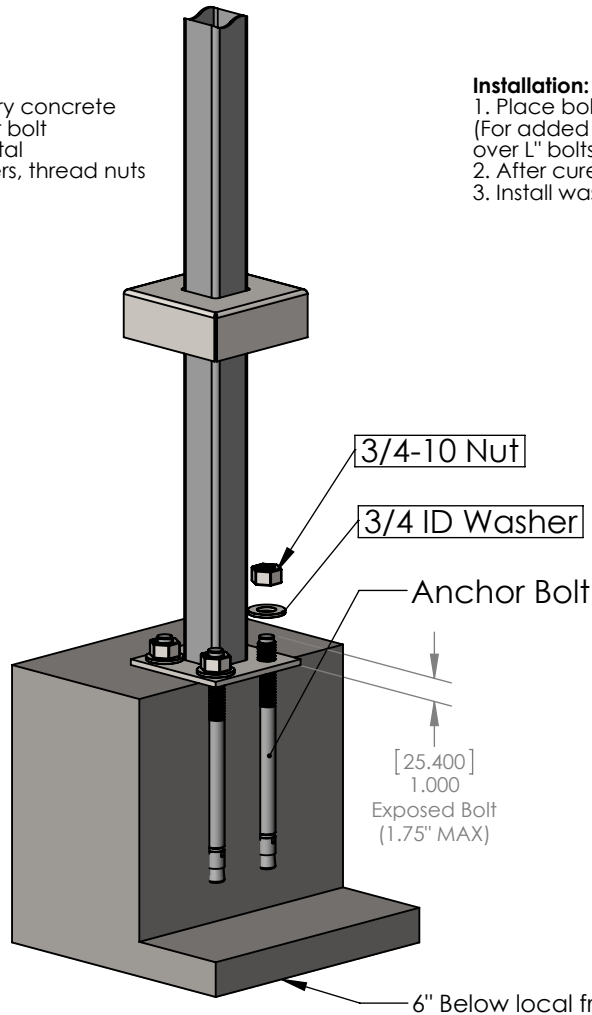

**STUD-ANCHOR-KIT
Installation**

Best for existing concrete

Installation:

1. Place bolts in wet cement
(For added strength add rebar over L" bolts)
2. After cured, place pedestal
3. Install washers and nuts

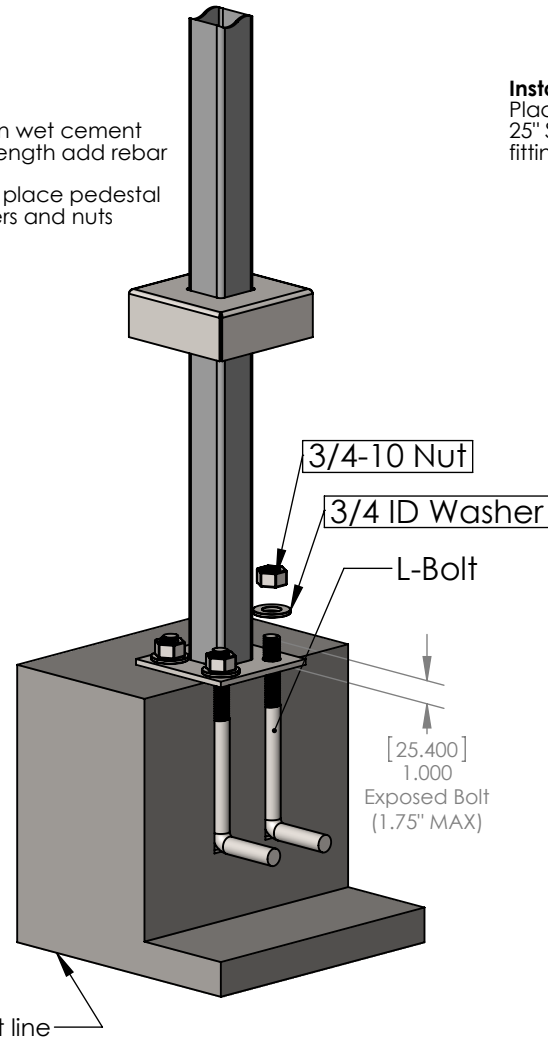

**L-BOLT-KIT
Installation**

Best for new cement

Installation:

- Place pedestal in wet cement
25" Suggested. Make sure to connect 1/2" NPTF Conduit fitting if it is to be used.

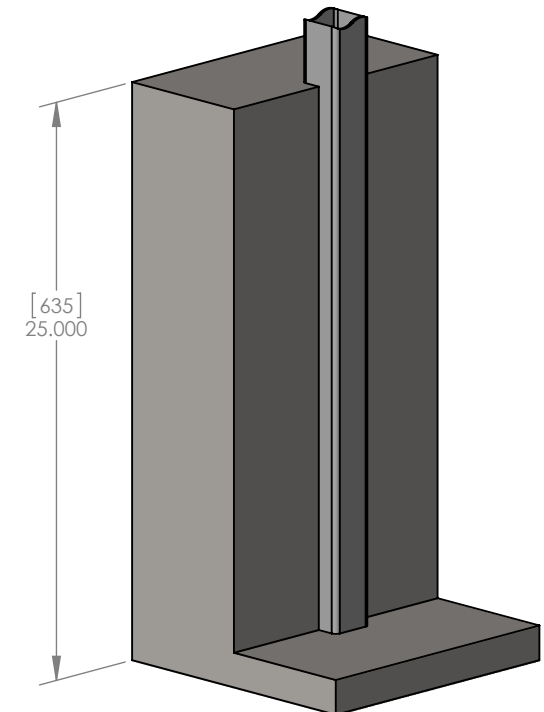

**IN-GROUND
Installation**