

LOCATION MAP

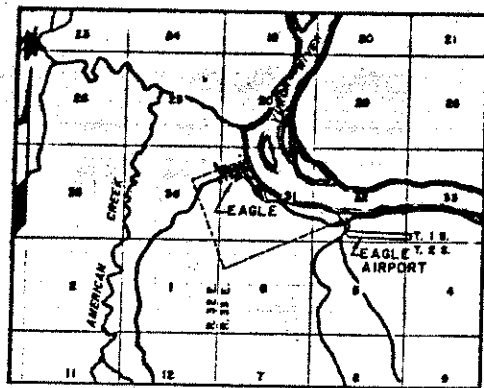

VICINITY MAP

SCALE: 1 INCH = 1 MILE
TOWNSHIP 1 SOUTH, RANGE 33 EAST
FAIRBANKS MERIDIAN, ALASKA
U.S.G.S. MAP EAGLE (D-1)

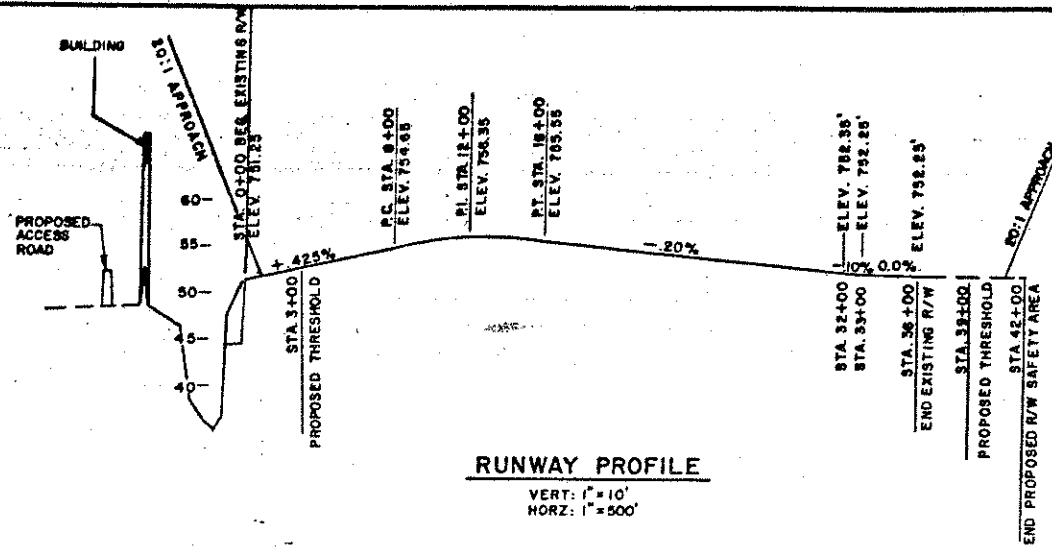

RUNWAY PROFILE

VERT: 1" = 10'
HORZ: 1" = 500'

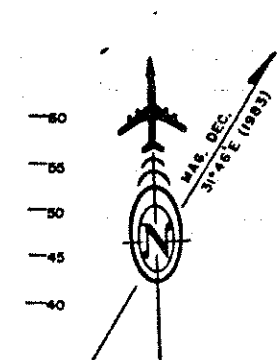

WIND DATA
PILOT REPORTS INDICATE THAT RUNWAY IS ALIGNED WITH PREVAILING WINDS.

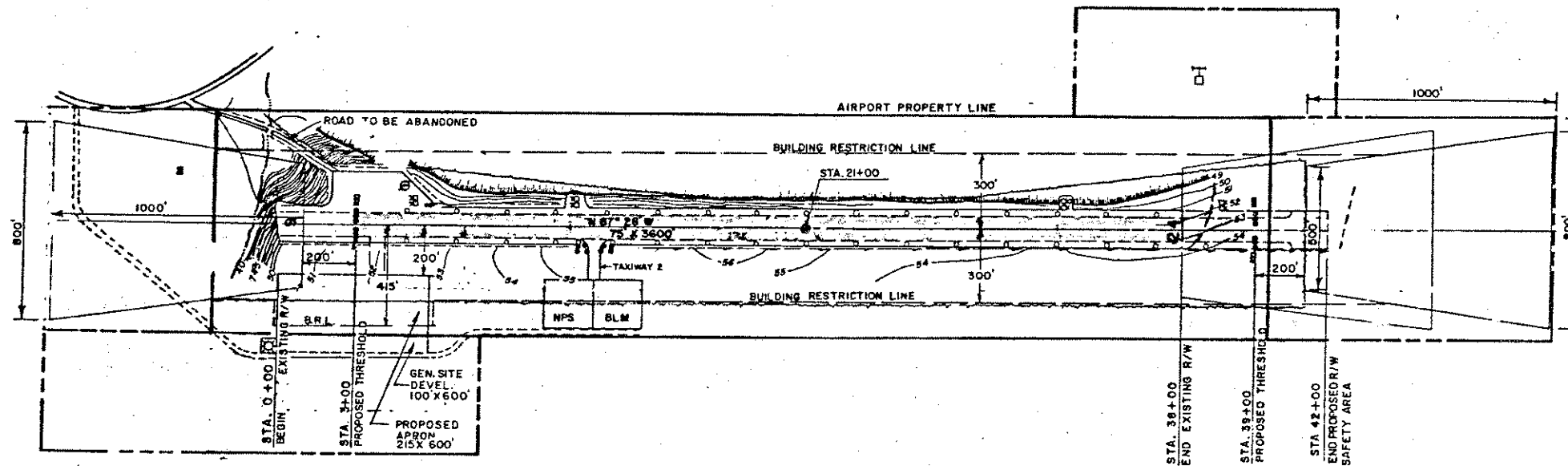

BASIC DATA TABLE RUNWAY DATA			
	RUNWAY 6/24		
	EXISTING	FUTURE	ULTIMATE
EFFECTIVE GRADIENT	0.13%	0.11%	SAME
% WIND COVERAGE	NONE AVAILABLE	NONE AVAILABLE	SAME
INSTRUMENT RUNWAY	NONE	NPI	NPI
RUNWAY SURFACE	GRAVEL	GRAVEL	GRAVEL
PAYEMENT STRENGTH	N/A	N/A	N/A
APPROACH SURFACES	20:1	20:1	20:1
RUNWAY LIGHTING	NONE	MIRL	MIRL
RUNWAY MARKING	NONE	NONE	NONE
RUNWAY DESIGNATION	6/24	6/24	6/24
RUNWAY DIMENSION	150 X 3600	78 X 3600	100 X 3600
RUNWAY SAFETY AREA	150 X 3600	150 X 4200	150 X 4200

BASIC DATA TABLE AIRPORT DATA		
	EXISTING	FUTURE
AIRPORT ELEVATION	755.83	756.53
AIRPORT REFERENCE POINT (A.R.P.) LAT. (EST)	64°46'36" N	
AIRPORT REFERENCE POINT (A.R.P.) LONG. (EST)	141°08'55" W	
TAXIWAY LIGHTING	NONE	M/TL
RAMP LIGHTING	NONE	NONE
NORMAL MAX. TEMP	73°F	73°F
AIRPORT TYPE	0 U II	0 U II
NAVIGATION AIDS	NONE	NONE
LANDING AIDS	NONE	VASI 4

LEGEND		
	EXISTING	FUTURE
PROPERTY LINE	---	---
BUILDING RESTRICTION LINE (B.R.L.)	---	---
BLUFF	---	---
DRAINAGE DITCH	---	---
AIRPORT REFERENCE POINT	⊙	⊙
WIND CONE & SEGMENTED CIRCLE	---	---
WIND CONE	---	---
ROADWAYS	---	---
GRADING LIMITS	---	---
CLEARING LIMITS	---	---
BEACON	---	---
VASI	NONE	---
THRESHOLD MARKERS	---	---
BUILDINGS	---	---
NDB	---	---
RUNWAY LIGHTS / TAXIWAY LIGHTS	NONE	---
RUNWAY THRESHOLD LIGHTS	NONE	---

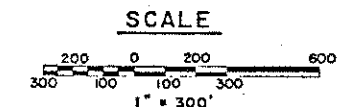

BY	DATE	REVISIONS

STATE OF ALASKA
DEPARTMENT OF TRANSPORTATION AND PUBLIC FACILITIES
NORTHERN REGION - DESIGN AND CONSTRUCTION - AVIATION

APPROVED
Daniel D. Urbach
DANIEL D. URBACH, P.E. DATE 1-23-84
CHIEF AVIATION DESIGN GROUP

EAGLE AIRPORT
AIRPORT LAYOUT PLAN

SHEET
1